

NO. OF COPIES RECEIVED	5
DISTRIBUTION	
SANTA FE	1
FILE	1
U.S.G.S.	2
LAND OFFICE	
OPERATOR	1

NEW MEXICO OIL CONSERVATION COMMISSION

RECEIVED

APR 22 1977

O. C. C.

DISTRICT OFFICE

APPLICATION FOR PERMIT TO DRILL, DEEPEN, OR PLUG BACK

30-015-22135

Form C-101
Revised 1-1-65

5A. Indicate Type of Lease
STATE <input type="checkbox"/> FEE <input checked="" type="checkbox"/>
5. State Oil & Gas Lease No.

1a. Type of Work		7. Unit Agreement Name	
b. Type of Well DRILL <input checked="" type="checkbox"/> DEEPEN <input type="checkbox"/> PLUG BACK <input type="checkbox"/> OIL WELL <input checked="" type="checkbox"/> GAS WELL <input type="checkbox"/> OTHER <input type="checkbox"/> SINGLE ZONE <input type="checkbox"/> MULTIPLE ZONE <input type="checkbox"/>		8. Farm or Lease Name Stark BG	
2. Name of Operator Yates Petroleum Corporation		9. Well No. 2	
3. Address of Operator 207 South 4th Street - Artesia, NM 88210		10. Field and Pool, or Wildcat <input checked="" type="checkbox"/> Penasco Draw (S.A.)	
4. Location of Well UNIT LETTER <u>D</u> LOCATED <u>990</u> FEET FROM THE <u>North</u> LINE AND <u>990</u> FEET FROM THE <u>West</u> LINE OF SEC. <u>25</u> TWP. <u>18S</u> RGE. <u>25E</u> NMRM		12. County Eddy	
21. Elevations (Show whether BP, RT, etc.) 3462' GR		21A. Kind & Status Plug, Bond Blanket	
21B. Drilling Contractor Byrd Drilling Company		22. Approx. Date Work will start As soon as approved	

PROPOSED CASING AND CEMENT PROGRAM

SIZE OF HOLE	SIZE OF CASING	WEIGHT PER FOOT	SETTING DEPTH	SACKS OF CEMENT	EST. TOP
15 1/2"	10-3/4"	32.75#	Approx 300'	Circulate	
9 1/2"	7"	20#	" 1100'	Circulate	
6 1/2"	4 1/2 or 5 1/2"	10.5 or 14#	" 1600'	150 sx (Circulate)	

Propose to drill a San Andres test. Approximately 300' of surface casing will be set, cement circulated, to shut off gravel and caving, and intermediate casing will be set 100 feet below the Artesian water zone and cemented to the surface. A tapered production string will be run, cemented to surface, perforated and sand frac'd for production.

Mud Program: - F.W. Gel and LCM to 1100', fresh water to total depth

BOP Program: - BOP's will be installed on 7" casing and tested. APPROVAL VALID FOR 90 DAYS UNLESS DRILLING COMMENCED,

EXPIRES 7-26-77

IN ABOVE SPACE DESCRIBE PROPOSED PROGRAM IF PROPOSAL IS TO DEEPEN OR PLUG BACK, GIVE DATA ON PRESENT PRODUCTIVE ZONE AND PROPOSED NEW PRODUCTIVE ZONE, GIVE BLOWOUT PREVENTER PROGRAM, IF ANY.

I hereby certify that the information above is true and complete to the best of my knowledge and belief.

Signed Christine C. Tomlinson Geol. Secty Date 4-21-77

(This space for State Use)

APPROVED BY W. A. Gressett CONDITIONS OF APPROVAL, IF ANY:

TITLE SUPERVISOR, DISTRICT II

Cement must be circulated to

Notify N.M.O.C.C. in sufficient time to witness cementing

APR 26 1977

surface below 10 3/4" & 7"

7"

NEW MEXICO OIL CONSERVATION COMMISSION
WELL LOCATION AND ACREAGE DEDICATION PLAT

Form C-102
Supersedes C-128
Effective 1-1-65

All distances must be from the outer boundaries of the Section.

Operator YATES PETROLEUM CORP.		Lease STARK BG		Well No. 2
Unit Letter D	Section 25	Township 18 South	Range 25 East	County Eddy
Actual Footage Location of Well: 990 feet from the North line and 990 feet from the West line				
Ground Level Elev. 3462.3	Producing Formation Yaso-San Andres	Pool Penasco Draw (Yaso, S.A.)	Dedicated Acreage: 40 Acres	

1. Outline the acreage dedicated to the subject well by colored pencil or hachure marks on the plat below.
2. If more than one lease is dedicated to the well, outline each and identify the ownership thereof (both as to working interest and royalty).
3. If more than one lease of different ownership is dedicated to the well, have the interests of all owners been consolidated by communitization, unitization, force-pooling, etc?

☐ Yes ☐ No If answer is "yes," type of consolidation _____

If answer is "no," list the owners and tract descriptions which have actually been consolidated. (Use reverse side of this form if necessary.) _____

No allowable will be assigned to the well until all interests have been consolidated (by communitization, unitization, forced-pooling, or otherwise) or until a non-standard unit, eliminating such interests, has been approved by the Commission.

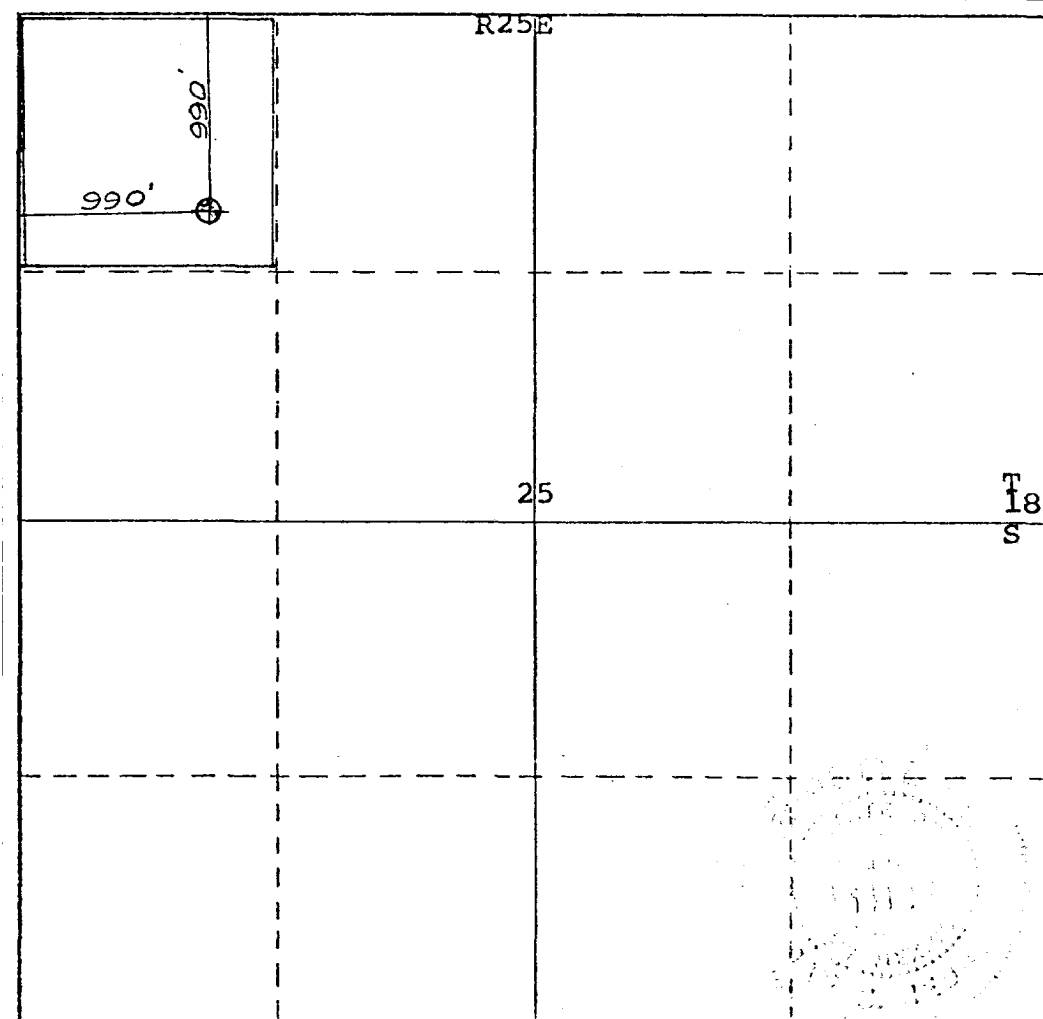

CERTIFICATION

I hereby certify that the information contained herein is true and complete to the best of my knowledge and belief.

Eddie M. Mahfood
Name

Eddie M. Mahfood

Position

Engineer

Company

Yates Petroleum Corp.

Date

4-21-77

I hereby certify that the well location shown on this plat was plotted from field notes of actual surveys made by me or under my supervision, and that the same is true and correct to the best of my knowledge and belief.

Date Surveyed

4/19/77

Registered Professional Engineer and/or Land Surveyor

Dan R. Reddy
Michael S. Costello

Certificate No.

5412
6272

0 330 660 990 1320 1650 1980 2310 2640 2000 1500 1000 500 0

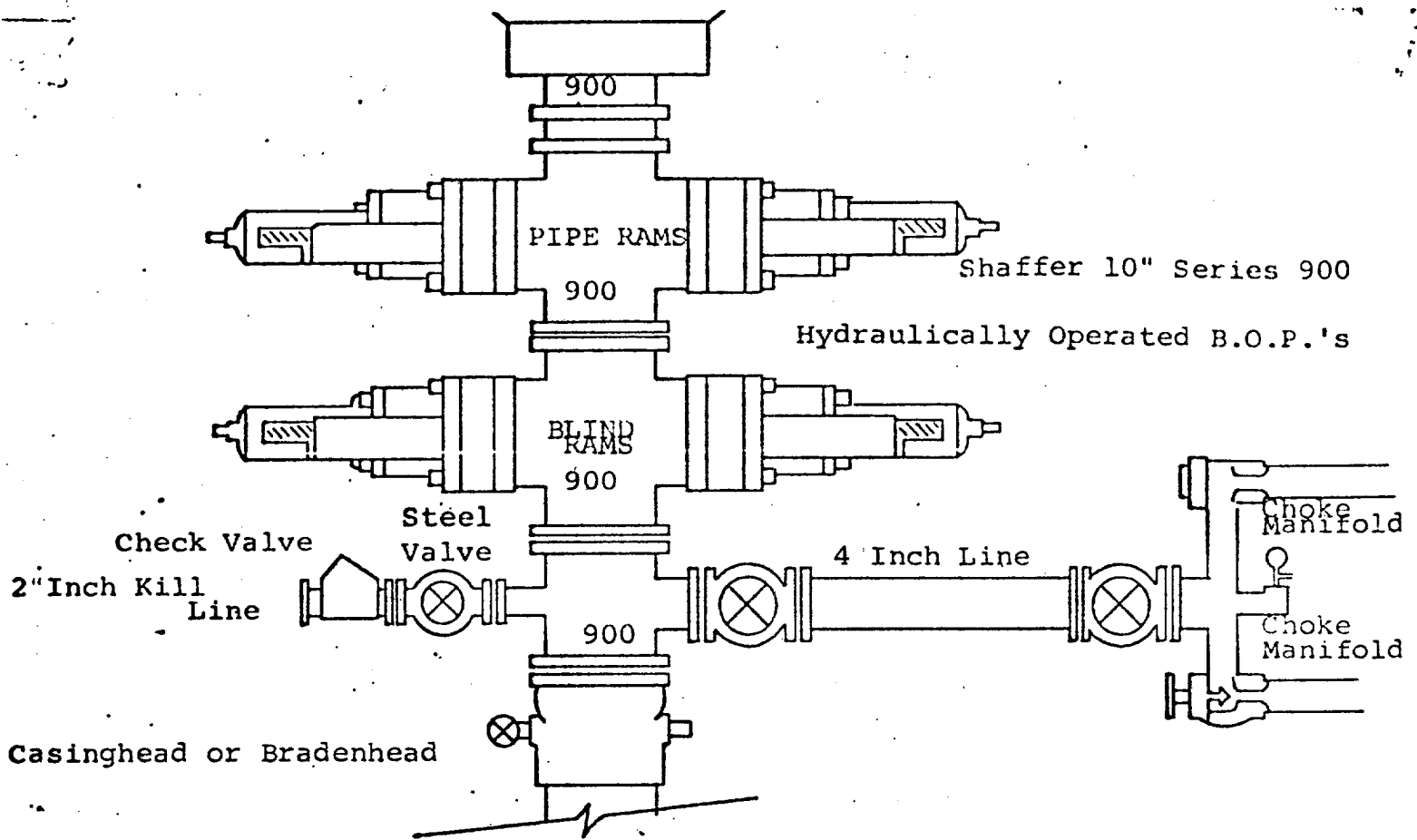

THE FOLLOWING CONSTITUTE MINIMUM BLOWOUT PREVENTER REQUIREMENTS

1. All preventers to be hydraulically operated with secondary manual controls installed prior to drilling out from under casing.
2. Choke outlet to be a minimum of 4" diameter.
3. Kill line to be of all steel construction of 2" minimum diameter.
4. All connections from operating manifolds to preventers to be all steel, hole or tube a minimum of one inch in diameter.
5. The available closing pressure shall be at least 15% in excess of that required with sufficient volume to operate the B.O.P.'s.
6. All connections to and from preventer to have a pressure rating equivalent to that of the B.O.P.'s.
7. Inside blowout preventer to be available on rig floor.
8. Operating controls located a safe distance from the rig floor.
9. Hole must be kept filled on trips below intermediate casing. Operator not responsible for blowouts resulting from not keeping hole full.
10. D. P. float must be installed and used below zone of first gas intrusion.