

NO. OF COPIES RECEIVED	12
DISTRIBUTION	
SANTA FE	1
FILE	1
U.S.G.S.	2
LAND OFFICE	1
OPERATOR	1

NEW MEXICO CONSERVATION COMMISSION

MAY 24 1977

O. C. C.
ARTESIA, OFFICE

30-015-22158

Form C-101
Revised 1-1-65

5A. Indicate Type of Lease
STATE ☒ FEE ☐

5. State Oil & Gas Lease No.

APPLICATION FOR PERMIT TO DRILL, DEEPEN, OR PLUG BACK

1a. Type of Work b. Type of Well OIL WELL <input type="checkbox"/> GAS WELL <input checked="" type="checkbox"/> OTHER <input type="checkbox"/> DEEPEN <input type="checkbox"/> PLUG BACK <input type="checkbox"/> SINGLE ZONE <input type="checkbox"/> MULTIPLE ZONE <input type="checkbox"/>		7. Unit Agreement Name
2. Name of Operator Yates Petroleum Corporation ✓		8. Farm or Lease Name 4-Dinkus & State Com
3. Address of Operator 207 South Fourth Street - Artesia, NM 88210		9. Well No. 2
4. Location of Well UNIT LETTER J LOCATED 1980 FEET FROM THE South LINE AND 1980 FEET FROM THE East LINE OF SEC. 17 TWP. 18S RGE. 25E NMPM		10. Field and Pool, or Wildcat Undesignated
21. Elevations (Show whether DT, RT, etc.) 3574' GR		12. County Eddy
21A. Kind & Status Plug, Bond Blanket	14. Proposed Depth 8850'	15A. Formation Morrow
21B. Drilling Contractor Ard Drilling Co.	20. Rotary or C.T. Rotary	22. Approx. Date Work will start May 25, 1977

23.

PROPOSED CASING AND CEMENT PROGRAM

SIZE OF HOLE	SIZE OF CASING	WEIGHT PER FOOT	SETTING DEPTH	SACKS OF CEMENT	EST. TOP
17½"	13-3/8"	48#	Approx 350'	250 sacks	Circulate
12½"	8-5/8"	24#	" 1200'	550 sacks	Circulate
7-7/8"	5½ or 4½"	15.5-17# or 10.5-11.6#	TD	250-350 sx.	

Propose to drill & test the Morrow and intermediate formations. Will set approx. 350' surface casing & circulate cement, and will set intermediate casing 100ft below the Artesian Water Zone. If commercial will run 5½" or 4½" casing and cement with about 600 ft of cement cover. Will perforate and stimulate as needed for production.

Mud Program: FW Gel & LCM to 1200', Water to 6200', Flosal-Drispak-KCL Mud to TD.

BOP Program: Hydril & BOP's on 8-5/8" casing and tested, pipe rams tested daily.

APPROVAL VALID
FOR 90 DAYS UNLESS
DRILLING COMMENCED,

Gas Acreage not dedicated.

EXPIRES 8-25-77

IN ABOVE SPACE DESCRIBE PROPOSED PROGRAM. IF PROPOSAL IS TO DEEPEN OR PLUG BACK, GIVE DATA ON PRESENT PRODUCTIVE ZONE AND PROPOSED NEW PRODUCTIVE ZONE. GIVE BLOWOUT PREVENTER PROGRAM, IF ANY.

I hereby certify that the information above is true and complete to the best of my knowledge and belief.

Signed Eddie M. Hays Title Engineer Date May 23, 1977

(This space for State Use)

APPROVED BY W. A. Gessett TITLE SUPERVISOR, DISTRICT II DATE MAY 25 1977

CONDITIONS OF APPROVAL, IF ANY:

Cement must be circulated to surface behind 13 3/8" & 8 7/8" casing

Notify N.M.O.C.C. by sufficient time to witness cementing the 8 7/8" casing

NEW MEXICO OIL CONSERVATION COMMISSION
WELL LOCATION AND ACREAGE DEDICATION PLAT

Form C-102
Supersedes C-128
Effective 1-1-65

All distances must be from the outer boundaries of the Section.

Operator: YATES PETROLEUM CORPORATION			Lease: 4 Dinkus GV State		Well No.: 2
Unit Letter: J	Section: 17	Township: 18 South	Range: 25 East	County: Eddy	
Actual Footage Location of Well: 1980 feet from the South line and 1980 feet from the East line					
Ground Level Elev.: 3574.3	Producing Formation: Morrow		Pool: Undesignated	Dedicated Acreage: 320 Acres	

1. Outline the acreage dedicated to the subject well by colored pencil or hachure marks on the plat below.
2. If more than one lease is dedicated to the well, outline each and identify the ownership thereof (both as to working interest and royalty).
3. If more than one lease of different ownership is dedicated to the well, have the interests of all owners been consolidated by communitization, unitization, force-pooling, etc?

☒ Yes ☐ No If answer is "yes," type of consolidation **Force Pooling**

If answer is "no," list the owners and tract descriptions which have actually been consolidated. (Use reverse side of this form if necessary.)

No allowable will be assigned to the well until all interests have been consolidated (by communitization, unitization, forced-pooling, or otherwise) or until a non-standard unit, eliminating such interests, has been approved by the Commission.

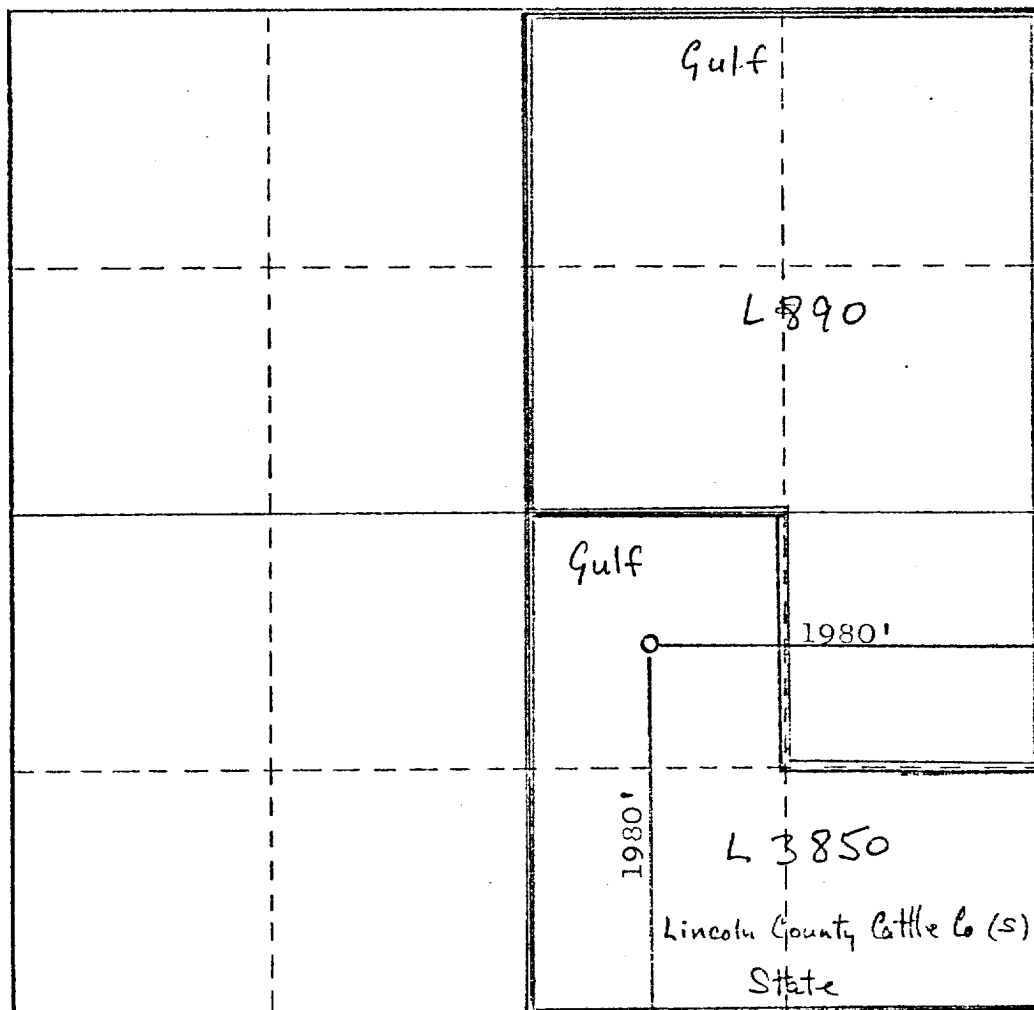

CERTIFICATION

I hereby certify that the information contained herein is true and complete to the best of my knowledge and belief.

Eddie M. Mahfood

Name
Eddie M. Mahfood
Position
Engineer
Company
Yates Petroleum Corp.
Date
May 23, 1977

I hereby certify that the well location shown on this plat was plotted from field notes of actual surveys made by me or under my supervision, and that the same is true and correct to the best of my knowledge and belief.

Date Surveyed
5/21/77
Registered Professional Engineer and/or Land Surveyor
Michael H. Smith
Certificate No.
6272

