

NO. OF COPIES RECEIVED	6
DISTRIBUTION	
SANTA FE	1
FILE	1
U.S.G.S.	2
LAND OFFICE	1
OPERATOR	1

NEW MEXICO OIL CONSERVATION COMMISSION

30-015-22174
Form C-101
Revised 1-1-65

5A. Indicate Type of Lease STATE <input checked="" type="checkbox"/> FEE <input type="checkbox"/>
5. State Oil & Gas Lease No. L-122 and L-4496
7. Unit Agreement Name
8. Farm or Lease Name Penasco Com.
9. Well No. 1
10. Field and Pool, or Wildcat Wildcat
12. County Eddy
19. Proposed Depth 9000'
19A. Formation Morrow
20. Rotary or C.T. Rotary
21. Elevations (Show whether DE, RT, etc.) 3624 gl
21A. Kind & Status Plug. Bond Current/State
21B. Drilling Contractor McVay Drilling
22. Approx. Date Work will start 6-25-77

APPLICATION FOR PERMIT TO DRILL, DEEPEN, OR PLUG BACK

1a. Type of Work DRILL <input checked="" type="checkbox"/> DEEPEN <input type="checkbox"/> PLUG BACK <input type="checkbox"/>
b. Type of Well OIL WELL <input type="checkbox"/> GAS WELL <input checked="" type="checkbox"/> OTHER <input type="checkbox"/> SINGLE ZONE <input checked="" type="checkbox"/> MULTIPLE ZONE <input type="checkbox"/>
2. Name of Operator R. C. Bennett & J. C. Ryan
3. Address of Operator P. O. Box 264, Midland, Texas 79702
4. Location of Well UNIT LETTER <u>J</u> LOCATED <u>1980</u> FEET FROM THE <u>South</u> LINE AND <u>1980</u> FEET FROM THE <u>East</u> LINE OF SEC. <u>31</u> TWP. <u>18S</u> RGE. <u>25E</u> NMPM
19. Proposed Depth 9000'
19A. Formation Morrow
20. Rotary or C.T. Rotary
21. Elevations (Show whether DE, RT, etc.) 3624 gl
21A. Kind & Status Plug. Bond Current/State
21B. Drilling Contractor McVay Drilling
22. Approx. Date Work will start 6-25-77

PROPOSED CASING AND CEMENT PROGRAM

SIZE OF HOLE	SIZE OF CASING	WEIGHT PER FOOT	SETTING DEPTH	SACKS OF CEMENT	EST. TOP
17 1/2"	13 3/8"	48# H40	300'	315 Cass C + 2%	CaCl Circ.
12 1/4"	8 5/8"	24# K55	1140'	550 Hal Lt + 2%	" Circ.
7 1/2"	4 1/2"	Various	9000	& 200 sx neat 400	cement w/2% CaCl

Blow-out Preventor Program

Size	Series or Test Pr.	Make & Model	Number
10"	5,000	Hydril	1
10"	5,000	Cameron QRC	2

APPROVAL VALID
FOR 90 DAYS UNLESS
DRILLING COMMENCED,

EXPIRES 9-8-77

Notify N.M.O.C.C. in sufficient
time to witness cementing
the 8 5/8" casing.

Cement must be circulated to
surface behind 13 3/8" & 8 5/8" casing

IN ABOVE SPACE DESCRIBE PROPOSED PROGRAM: IF PROPOSAL IS TO DEEPEN OR PLUG BACK, GIVE DATA ON PRESENT PRODUCTIVE ZONE AND PROPOSED NEW PRODUCTIVE ZONE. GIVE BLOWOUT PREVENTOR PROGRAM, IF ANY.

I hereby certify that the information above is true and complete to the best of my knowledge and belief.

Signed [Signature] Title Partner Date 6/2/77

(This space for State Use)

APPROVED BY W. A. Gressett TITLE SUPERVISOR, DISTRICT II DATE JUN 8 1977

CONDITIONS OF APPROVAL, IF ANY:
* as noted above

time to witness cementing

MEXICO OIL CONSERVATION COMMISS
WELL LOCATION AND ACREAGE DEDICATION PLAT

Form C-102
 Supersedes C-128
 Effective 1-1-55.

All distances must be from the outer boundaries of the Section.

Operator R. C. Bennett & J. C. Ryan		Lease Penasco Com		Well No. 1
Unit Letter J	Section 31	Township 18 S	Range 25 E	County Eddy
Actual Footage Location of Well: 1980 feet from the South line and 1980 feet from the East line				
Ground Level Elev: 3624	Producing Formation Morrow	Pool Wildcat	Dedicated Acreage: 320 Acres	

1. Outline the acreage dedicated to the subject well by colored pencil or hachure marks on the plat below.
2. If more than one lease is dedicated to the well, outline each and identify the ownership thereof (both as to working interest and royalty).
3. If more than one lease of different ownership is dedicated to the well, have the interests of all owners been consolidated by communitization, unitization, force-pooling, etc?

☒ Yes ☐ No If answer is "yes," type of consolidation designation of unit / communitization

If answer is "no," list the owners and tract descriptions which have actually been consolidated. (Use reverse side of this form if necessary.) _____

No allowable will be assigned to the well until all interests have been consolidated (by communitization, unitization, forced-pooling, or otherwise) or until a non-standard unit, eliminating such interests, has been approved by the Commission.

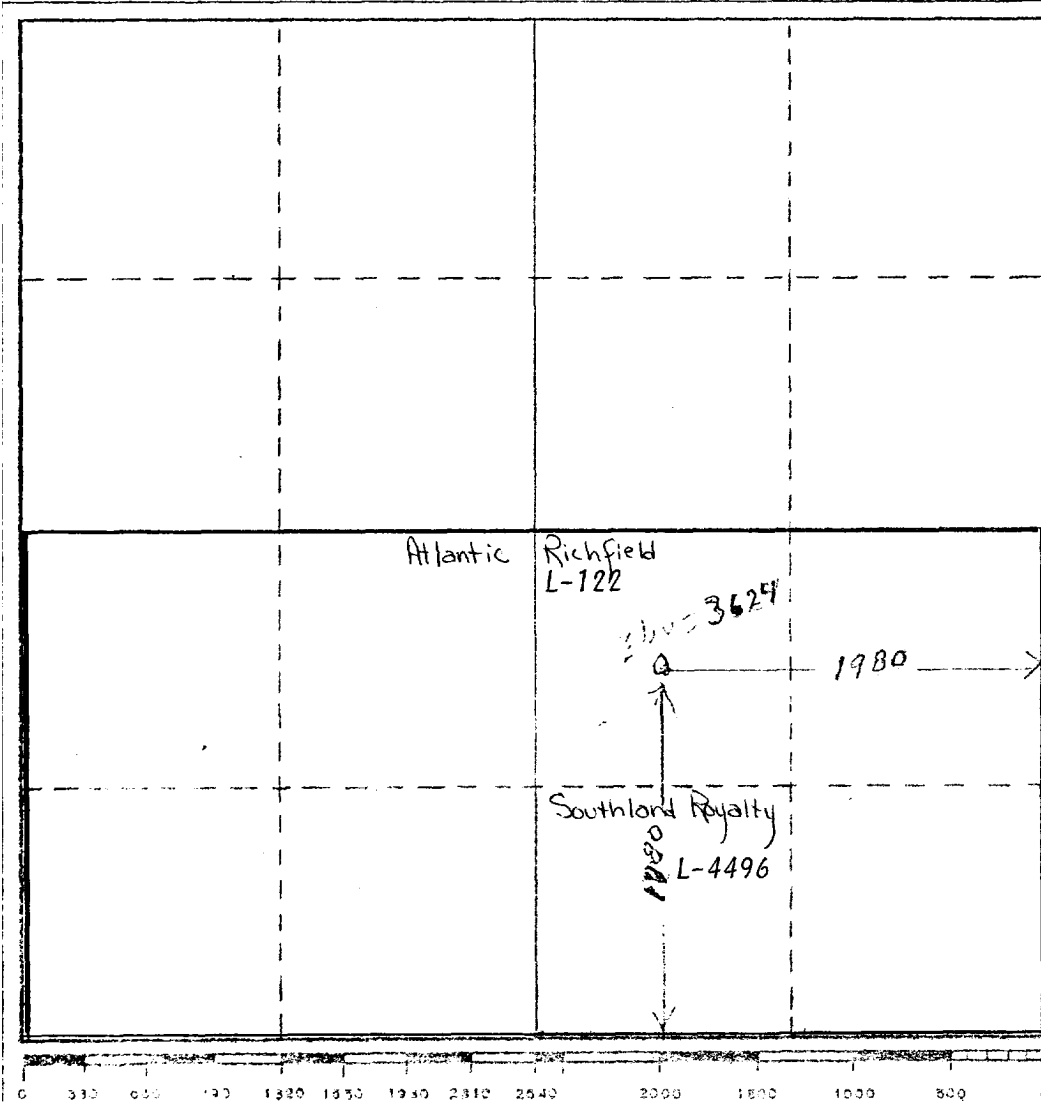

CERTIFICATION

I hereby certify that the information contained herein is true and complete to the best of my knowledge and belief.

[Signature]

Name
R. C. Bennett
 Position
Partner
 Company
R. C. Bennett & J. C. Ryan
 Date
June 2, 1977

I hereby certify that the well location shown on this plat was plotted from field notes of actual surveys made by me or under my supervision, and that the same is true and correct to the best of my knowledge and belief.

June 1, 1977
 Date Surveyed
[Signature] **John Lewis, Jr.**
 Registered Professional Engineer
 and/or Land Surveyor

N. M. 220

Certificate No.