

NO. OF COPIES RECEIVED	5
DISTRIBUTION	
SANTA FE	1
FILE	1
U.S.G.S.	2
LAND OFFICE	
OPERATOR	1

**RECEIVED**  
NEW MEXICO OIL CONSERVATION COMMISSION

**AUG 29 1977**

**O.C.C.**  
**ARTESIA, OFFICE**

30-015-22278  
Form C-101  
Revised 1-1-65

5A. Indicate Type of Lease  
STATE ☐ FEE ☒

5. State Oil & Gas Lease No.

**APPLICATION FOR PERMIT TO DRILL, DEEPEN, OR PLUG BACK**

1a. Type of Work

b. Type of Well  
OIL WELL ☒ GAS WELL ☐ OTHER ☐  
DRILL ☒ DEEPEN ☐ PLUG BACK ☐  
SINGLE ZONE ☐ MULTIPLE ZONE ☐

2. Name of Operator

**Yates Petroleum Corporation**

3. Address of Operator

**207 South 4th Street - Artesia, NM 88210**

4. Location of Well

UNIT LETTER **P** LOCATED **990** FEET FROM THE **South** LINE

AND **330** FEET FROM THE **East** LINE OF SEC. **26** TWP. **18S** RGE. **25E** NMPM

7. Unit Agreement Name

8. Farm or Lease Name

**Wilkinson "AZ"**

9. Well No.

**4**

10. Field and Pool, or Wildcat

**Penasco Draw (Yeso S.A)**

12. County

**Eddy**

19. Proposed Depth

**Approx 2500'**

19A. Formation

**Yeso S.A.**

20. Rotary or C.T.

**Rotary**

21. Elevations (Show whether DT, RT, etc.)

**3478' GR**

21A. Kind & Status Plug, Bond

**Blanket**

21B. Drilling Contractor

**Verna Drilling Co.**

22. Approx. Date Work will start

**As soon as possible**

23.

**PROPOSED CASING AND CEMENT PROGRAM**

SIZE OF HOLE	SIZE OF CASING	WEIGHT PER FOOT	SETTING DEPTH	SACKS OF CEMENT	EST. TOP
15"	10-3/4"	32.75#	Approx 320'	200 sx	Circulate
9 1/2"	7"	20#	" 1200'	500 sx	Circulate
6 1/4"	4 1/2 & 5 1/2"	9.5 & 14#	" 2500'	175 sx	Circulate

Propose to drill to 2500' and test the Yeso and San Andres formations. Approx 320' of surface casing will be set to shut off gravel and caving, and intermediate casing will be set at least 100 feet below the Artesian water zone. A tapered production string will be run and the cement will be circulated on each casing string.

**Mud Program:** - FW gel and LCM to 1200' or dry drill, FW to TD.

**BOP Program:** - BOP's will be installed in the 7" casing and tested.

**APPROVAL VALID**  
**FOR 90 DAYS UNLESS**  
**DRILLING COMMENCED,**

**EXPIRES 11-30-77**

IN ABOVE SPACE DESCRIBE PROPOSED PROGRAM; IF PROPOSAL IS TO DEEPEN OR PLUG BACK, GIVE DATA ON PROPOSED PROTECTIVE ZONE AND PROPOSED NEW PRODUCTION ZONE, GIVE BLOWOUT PREVENTER PROGRAM, IF ANY.

I hereby certify that the information above is true and complete to the best of my knowledge and belief.

Signed Eddie L. Gressett Title **Engineer**

Date **8-26-77**

(This space for State Use)

APPROVED BY W.A. Gressett TITLE **SUPERVISOR, DISTRICT II** DATE **AUG 30 1977**

CONDITIONS OF APPROVAL, IF ANY:

Cement must be circulated to surface behind 10 3/4" & 7" casing

Notify N.M.O.C.C. in sufficient time to witness cementing the 7" casing

**NEW MEXICO OIL CONSERVATION COMMISSION**  
**WELL LOCATION AND ACREAGE DEDICATION PLAT**

Form C-102  
 Supersedes C-128  
 Effective 1-1-65

All distances must be from the outer boundaries of the Section.

Operator <b>YATES PETROLEUM CORPORATION</b>			Lease <b>WILKINSON AZ</b>		Well No. <b>4</b>
Unit Letter <b>P</b>	Section <b>26</b>	Township <b>18 South</b>	Range <b>25 East</b>	County <b>Eddy</b>	
Actual Footage Location of Well: <b>990</b> feet from the <b>South</b> line and <b>330</b> feet from the <b>East</b> line					
Ground Level Elev. <b>3478</b>	Producing Formation <b>Yeso, S.A.</b>	Pool <b>Penasco Draw (Yeso, SA)</b>	Dedicated Acreage: <b>40</b> Acres		

1. Outline the acreage dedicated to the subject well by colored pencil or hachure marks on the plat below.
2. If more than one lease is dedicated to the well, outline each and identify the ownership thereof (both as to working interest and royalty).
3. If more than one lease of different ownership is dedicated to the well, have the interests of all owners been consolidated by communitization, unitization, force-pooling, etc?

☐ Yes    ☐ No    If answer is "yes," type of consolidation: \_\_\_\_\_

If answer is "no," list the owners and tract descriptions which have actually been consolidated. (Use reverse side of this form if necessary.) \_\_\_\_\_

No allowable will be assigned to the well until all interests have been consolidated (by communitization, unitization, forced-pooling, or otherwise) or until a non-standard unit, eliminating such interests, has been approved by the Commission.

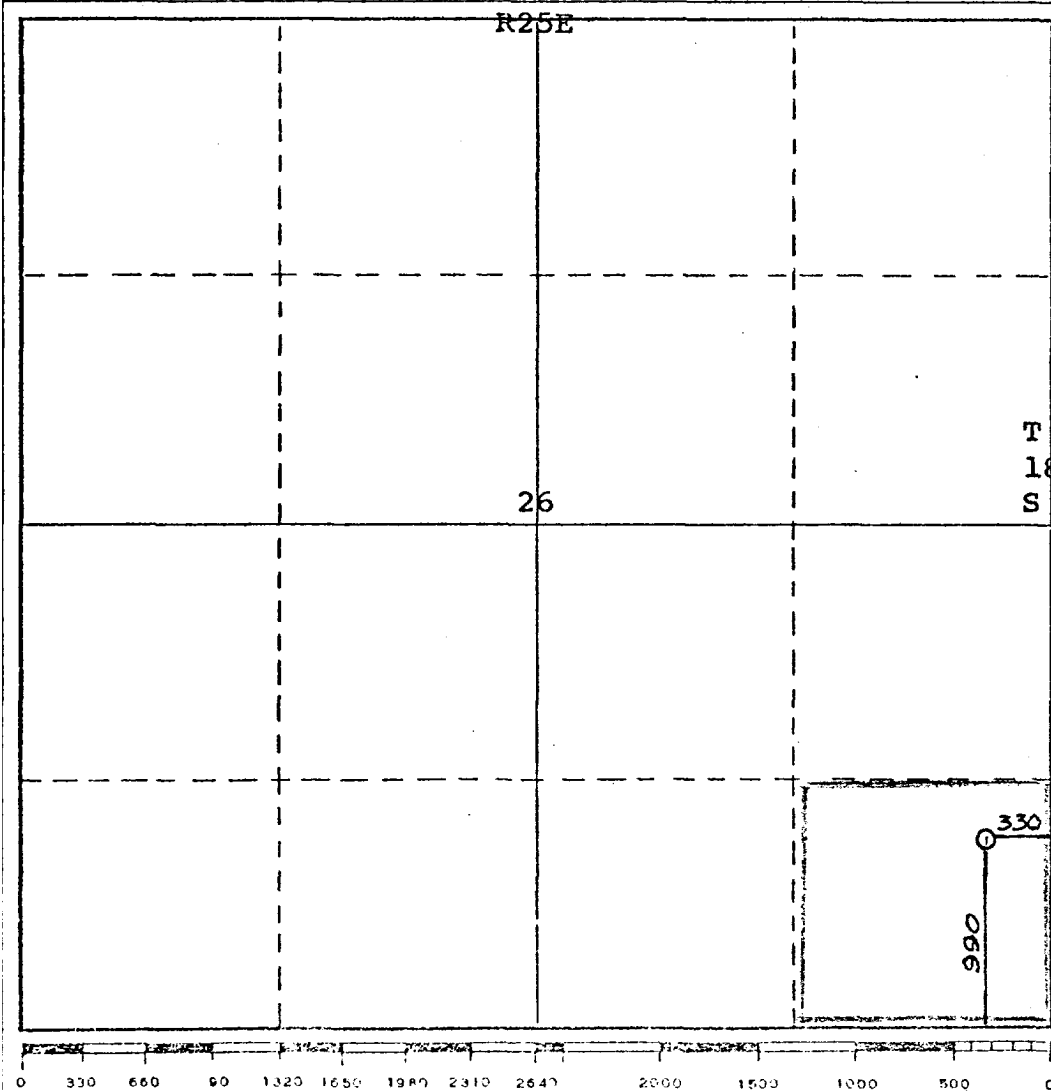

<b>CERTIFICATION</b>	
I hereby certify that the information contained herein is true and complete to the best of my knowledge and belief.	
<i>Eddie M. Mahfood</i>	
Name	<b>Eddie M. Mahfood</b>
Position	<b>Engineer</b>
Company	<b>Yates Petroleum Corp.</b>
Date	<b>8-26-77</b>
I hereby certify that the well location shown on this plat was plotted from field notes of actual surveys made by me or under my supervision, and that the same is true and correct to the best of my knowledge and belief.	
Date Surveyed	<b>8/26/77</b>
Registered Professional Engineer and/or Land Surveyor	
<i>Dan R. Reddy</i>	
Certificate No.	<b>P.E.&amp;L.S. No. 5412</b>

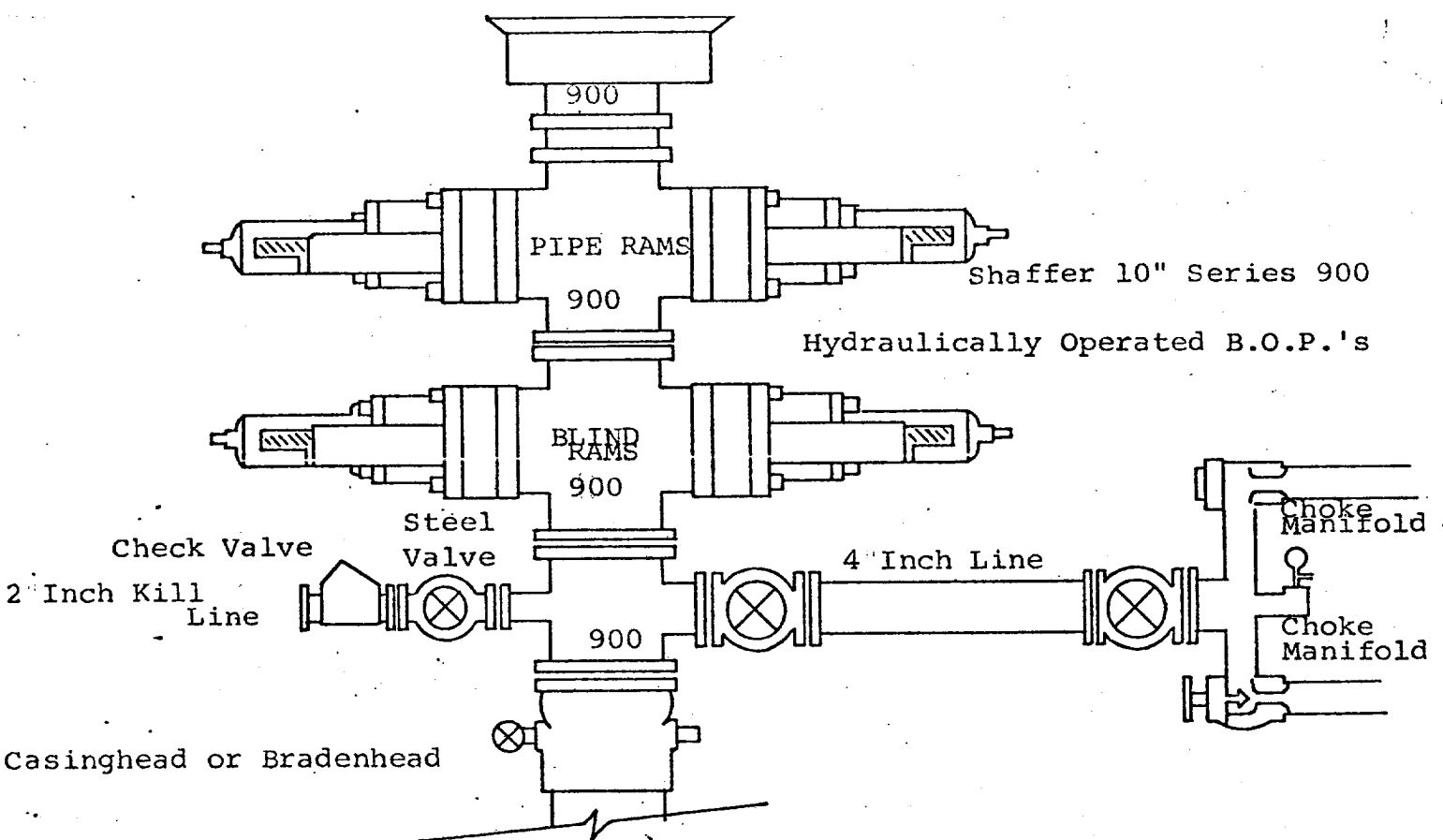

THE FOLLOWING CONSTITUTE MINIMUM BLOWOUT PREVENTER REQUIREMENTS

1. All preventers to be hydraulically operated with secondary manual controls installed prior to drilling out from under casing.
2. Choke outlet to be a minimum of 4" diameter.
3. Kill line to be of all steel construction of 2" minimum diameter.
4. All connections from operating manifolds to preventers to be all steel, hole or tube a minimum of one inch in diameter.
5. The available closing pressure shall be at least 15% in excess of that required with sufficient volume to operate the B.O.P.'s.
6. All connections to and from preventer to have a pressure rating equivalent to that of the B.O.P.'s.
7. Inside blowout preventer to be available on rig floor.
8. Operating controls located a safe distance from the rig floor.
9. Hole must be kept filled on trips below intermediate casing. Operator not responsible for blowouts resulting from not keeping hole full.
10. D. P. float must be installed and used below zone of first gas intrusion.