

| | |
|------------------------|--------------|
| NO. OF COPIES RECEIVED | |
| DISTRIBUTION | |
| SANTA FE | ✓ |
| FILE | ✓ |
| U.S.G.S. | ✓ |
| LAND OFFICE | |
| TRANSPORTER | OIL ✓ GAS |
| OPERATOR | ✓ |
| PRORATION OFFICE | |

NEW MEXICO OIL CONSERVATION COMMISSION
REQUEST FOR ALLOWABLE
AND
AUTHORIZATION TO TRANSPORT OIL AND NATURAL GAS

Form C-104
Supersedes Old C-104 and C-1.
Effective 1-1-65

RECEIVED

JUL 26 1982

I. Operator Amoco Production Company ✓
Address P. O. Box 68, Hobbs, New Mexico 88240

O. C. D.
ARTESIA, OFFICE

| | | | |
|---|-------------------------------------|---------------------------|--------------------------|
| Reason(s) for filing (Check proper box) | | Other (Please explain) | |
| New Well | <input type="checkbox"/> | Change in Transporter of: | |
| Recompletion | <input checked="" type="checkbox"/> | Oil | <input type="checkbox"/> |
| Change in Ownership | <input type="checkbox"/> | Casinghead Gas | <input type="checkbox"/> |
| | | Dry Gas | <input type="checkbox"/> |
| | | Condensate | <input type="checkbox"/> |

If change of ownership give name and address of previous owner

Request allowable to produce Wolfcamp
CASINGHEAD GAS MUST NOT BE FLARED AFTER 9-2-82 UNLESS AN EXCEPTION TO IS OBTAINED from Minerals Management Service

II. DESCRIPTION OF WELL AND LEASE

R-7158 12/8/82

| | | | | |
|-----------------|----------|--------------------------------|---------------------------------|-------------------------|
| Lease Name | Well No. | Pool Name, including Formation | Kind of Lease | Lease No. |
| Federal F-100 | 1 | Und. Wolfcamp | State, Federal or Fee Federal L | -065478-b |
| Location | | | | |
| Unit Letter | G | 1980 Feet From The | North Line and | 1650 Feet From The |
| | | | | East |
| Line of Section | 3 | Township | 18-S | Range |
| | | | | 27-E, NMPM, Eddy County |

III. DESIGNATION OF TRANSPORTER OF OIL AND NATURAL GAS

| | | |
|--|--|------|
| Name of Authorized Transporter of Oil <input checked="" type="checkbox"/> or Condensate <input type="checkbox"/> | Address (Give address to which approved copy of this form is to be sent) | |
| Permian Corporation | P. O. Box 1183, Houston, Texas | |
| Name of Authorized Transporter of Casinghead Gas <input type="checkbox"/> or Dry Gas <input type="checkbox"/> | Address (Give address to which approved copy of this form is to be sent) | |
| | | |
| If well produces oil or liquids, give location of tanks. | Unit | Sec. |
| | 6 | 3 |
| | 18-S | 27-E |
| | Is gas actually connected? <u>No</u> When | |

If this production is commingled with that from any other lease or pool, give commingling order number:

IV. COMPLETION DATA

| | | | | | | | | |
|--------------------------------------|-----------------------------|----------|-----------------|--------------|---------------------|-----------|------------|-------------|
| Designate Type of Completion - (X) | Oil Well | Gas Well | New Well | Workover | Deepen | Plug Back | Same Resv. | Diff. Resv. |
| | X | | | | | X | | |
| Date Spudded | Date Compl. Ready to Prod. | | Total Depth | F.B.T.D. | | | | |
| 11-23-79 | 7-21-82 | | 9957 | 9265 | | | | |
| Elevations (DF, RKB, RT, GR, etc.) | Name of Producing Formation | | Top Oil/Gas Pay | Tubing Depth | | | | |
| 3560.1 GL | Wolfcamp | | 7036 | 6947 | | | | |
| Perforations | Depth Casing Shoe | | | | | | | |
| 7036-7046 7089-7094 .4 inch 2 JSPF | 9957 | | | | | | | |
| TUBING, CASING, AND CEMENTING RECORD | | | | | | | | |
| HOLE SIZE | CASING & TUBING SIZE | | DEPTH SET | | SACKS CEMENT | | | |
| 17-1/2 | 13-3/8 | | 1007 | | 950 C1 C | | | |
| 12-1/4 | 8-5/8 | | 5798 | | 2928 lite, 200 C1 C | | | |
| 7-7/8 | 5-1/2 | | 9957 | | 875 lite, 270 C1 C | | | |
| | 2-3/8 | | 6947 | | | | | |

V. TEST DATA AND REQUEST FOR ALLOWABLE OIL WELL

(Test must be after recovery of total volume of load oil and must be equal to or exceed top allowable for this depth or be for full 24 hours)

| | | | |
|---------------------------------|-----------------|---|------------|
| Date First New Oil Run To Tanks | Date of Test | Producing Method (Flow, pump, gas lift, etc.) | |
| 6-24-82 | 7-20-82 | Pumping | |
| Length of Test | Tubing Pressure | Casing Pressure | Choke Size |
| 24 hr. | | | |
| Actual Prod. During Test | Oil-Bbls. | Water-Bbls. | Gas-MCF |
| 100 | 30 | 70 | 73 |

GAS WELL

| | | | |
|----------------------------------|---------------------------|---------------------------|-----------------------|
| Actual Prod. Test-MCF/D | Length of Test | Bbls. Condensate/MMCF | Gravity of Condensate |
| | | | |
| Testing Method (pilot, back pr.) | Tubing Pressure (Shut-in) | Casing Pressure (Shut-in) | Choke Size |
| | | | |

VI. CERTIFICATE OF COMPLIANCE

I hereby certify that the rules and regulations of the Oil Conservation Commission have been complied with and that the information given above is true and complete to the best of my knowledge and belief.

Mark Freeman
(Signature)

Assist. Admin. Analyst
(Title)

7-23-82
(Date)

OIL CONSERVATION COMMISSION

APPROVED AUG 3 1982, 19
BY Mark Freeman
TITLE OIL AND GAS INSPECTOR

This form is to be filed in compliance with RULE 1104.

If this is a request for allowable for a newly drilled or deepened well, this form must be accompanied by a tabulation of the deviation tests taken on the well in accordance with RULE 111.

All sections of this form must be filled out completely for allowable on new and recompleted wells.

Fill out only Sections I, II, III, and VI for changes of owner, well name or number, or transporter, or other such change of condition.

Separate Forms C-104 must be filed for each pool in multiply completed wells.

MEXICO OIL CONSERVATION COMMI.
WELL LOCATION AND ACREAGE DEDICATION PLAT

RECEIVED

Form C-102
Supersedes C-128
Effective 1-1-65

JUL 30 1982

All distances must be from the outer boundaries of the Section

| | | | | | | | |
|--|--|-----------------------------|---|-----------------------|---------------------------------------|-----------------------|--|
| Operator AMOCO Production Company | | | Lease AMOCO Fed. "F" Gas Comp | | | O. C. D. No. 1 | |
| Unit Letter G | Section 3 | Township 18 South | Range 27 East | County Eddy | | | |
| Actual Footage Location of Well: <div style="display: flex; justify-content: space-between;"> 1980 feet from the North line and 1650 feet from the East line </div> | | | | | | | |
| Ground Level Elev. 3560.1 | Producing Formation Wolfcamp | | Pool Wildcat Wolfcamp | | Dedicated Acreage: 40 Acres | | |

1. Outline the acreage dedicated to the subject well by colored pencil or hachure marks on the plat below.
2. If more than one lease is dedicated to the well, outline each and identify the ownership thereof (both as to working interest and royalty).
3. If more than one lease of different ownership is dedicated to the well, have the interests of all owners been consolidated by communitization, unitization, force-pooling, etc?

☐ Yes ☐ No If answer is "yes," type of consolidation _____

If answer is "no," list the owners and tract descriptions which have actually been consolidated. (Use reverse side of this form if necessary.) _____

No allowable will be assigned to the well until all interests have been consolidated (by communitization, unitization, forced-pooling, or otherwise) or until a non-standard unit, eliminating such interests, has been approved by the Commission.

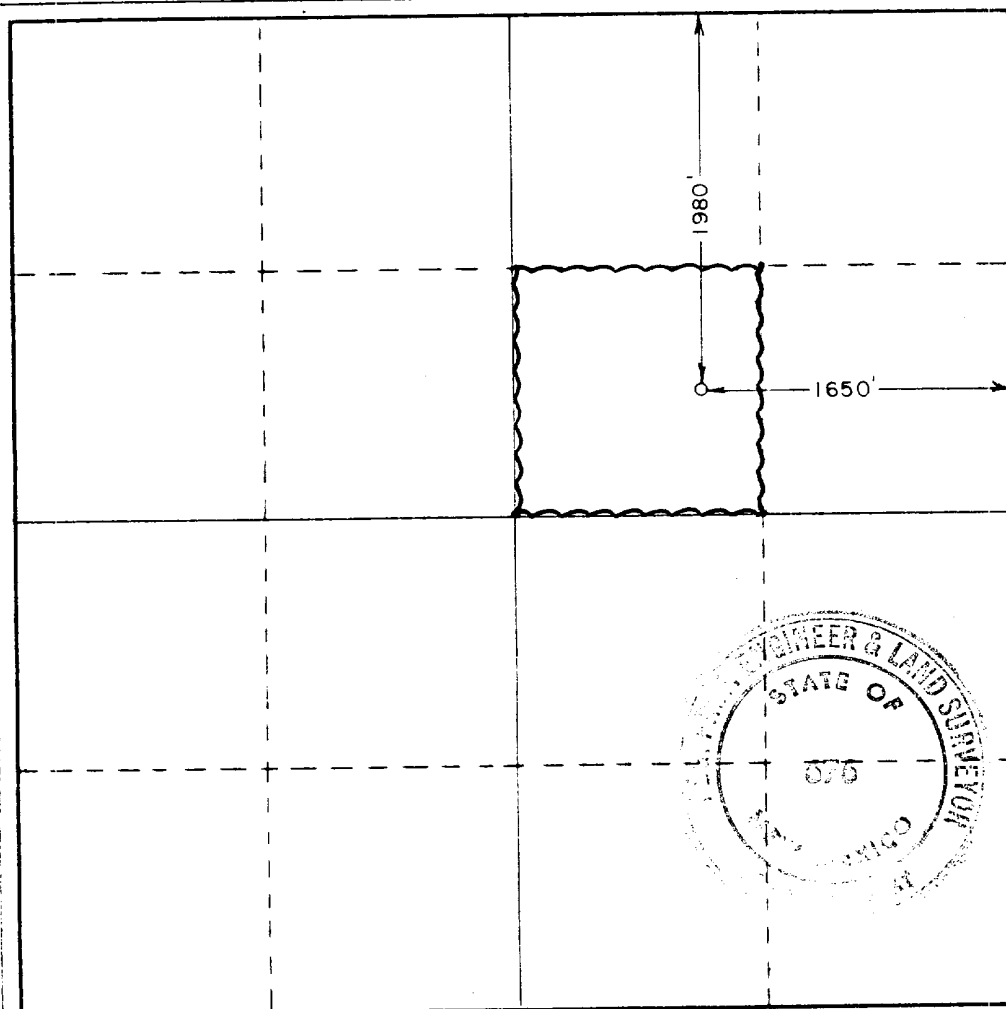

CERTIFICATION

I hereby certify that the information contained herein is true and complete to the best of my knowledge and belief.

Name Mark Freeman
 Position _____
 Asst. Admin. Analyst
 Company
Amoco Production Company
 Date
7-28-82

I hereby certify that the well location shown on this plat was plotted from field notes of actual surveys made by me or under my supervision, and that the same is true and correct to the best of my knowledge and belief.

Date Surveyed
September 15, 1977

Registered Professional Engineer
 and/or Land Surveyor

Charles W. Work
 Certificate No. **676**

0 330 660 990 1320 1650 1980 2310 2640 2000 1800 1000 800 0