

RECEIVED

NEW MEXICO OIL CONSERVATION COMMISSION

AUG 25 1978

30-015-22369

Form C-101
Revised 1-1-65

NO. OF COPIES RECEIVED	5
DISTRIBUTION	
SANTA FE	1
FILE	1
U.S.G.S.	2
LAND OFFICE	
OPERATOR	1

O. C. C.
ARTESIA, OFFICE

RE-ENTRY

APPLICATION FOR PERMIT TO DRILL, DEEPEN, OR PLUG BACK

1a. Type of Work		7. Unit Agreement Name	
b. Type of Well DRILL <input type="checkbox"/> DEEPEN <input checked="" type="checkbox"/> PLUG BACK <input type="checkbox"/>		8. Farm or Lease Name Loco Hills Welch	
c. Name of Operator Harvey E. Yates Company ✓		9. Well No. 1	
d. Address of Operator P. O. Box 1933, Roswell, N. M. 88201		10. Field and Pool, or Wildcat <i>Unit: South Empire Morano</i> Wildcat	
e. Location of Well UNIT LETTER <u>D</u> LOCATED <u>480</u> FEET FROM THE <u>North</u> LINE AND <u>500'</u> FEET FROM THE <u>West</u> LINE OF SEC. <u>9</u> TWP. <u>18S</u> RGE. <u>29E</u> NMPM		12. County Eddy	
19. Proposed Depth 11,400'		19A. Formation Morrow	
20. Rotary or C.T. Rotary			
21. Elevations (Show whether DF, RT, etc.) 3516'	21A. Kind & Status Plug. Bond \$50,000 Blanket	21B. Drilling Contractor Moranco	22. Approx. Date Work will start September 5, 1978

PROPOSED CASING AND CEMENT PROGRAM

SIZE OF HOLE	SIZE OF CASING	WEIGHT PER FOOT	SETTING DEPTH	SACKS OF CEMENT	EST. TOP
EXISTING CASING:	12 3/4"		402'	475 Sx	
	8 5/8"		2910'	1300 Sx	
PROPOSED OIL STRING:	5 1/2"	17# & 20#	11,400'	Sufficient to cover pay	

This well formerly named Depco Inc. #1 Welch "A" was plugged and abandoned 2-4-78. HEYCO proposes to re-enter well drilling out plugs to a depth of the present TD of 10,100' and continue drilling to TD of 11,400' to test Morrow formation.

BOP attachment

This acreage is not dedicated to a pipeline company.

APPROVAL VALID
FOR 90 DAYS UNLESS
DRILLING COMMENCED,EXPIRES 11-29-78

IN ABOVE SPACE DESCRIBE PROPOSED PROGRAM: IF PROPOSAL IS TO DEEPEN OR PLUG BACK, GIVE DATA ON PRESENT PRODUCTIVE ZONE AND PROPOSED NEW PRODUCTIVE ZONE. GIVE BLOWOUT PREVENTER PROGRAM, IF ANY.

I hereby certify that the information above is true and complete to the best of my knowledge and belief.

Signed Paul G. Yates Title Vice President Date August 24, 1978

(This space for State Use)

APPROVED BY W. A. Gressitt TITLE SUPERVISOR, DISTRICT II DATE AUG 29 1978

CONDITIONS OF APPROVAL, IF ANY:

N MEXICO OIL CONSERVATION COMMISS
WELL LOCATION AND ACREAGE DEDICATION PLAT

Form C-102
Supersedes C-128
Effective 1-1-65

All distances must be from the outer boundaries of the Section

Operator Harvey E. Yates Company			Lease Loco Hills Welch		Well No. 1
Unit Letter D	Section 9	Township 18 South	Range 29 East	County Eddy	
Actual Postage Location of Well:					
480	feet from the	North	line and	500	feet from the West line
Ground Level Elev. 3516'	Producing Formation Morrow		Pool S. Empire Morrow Wildcat		Dedicated Acreage: 320 Acres

1. Outline the acreage dedicated to the subject well by colored pencil or hachure marks on the plat below.
2. If more than one lease is dedicated to the well, outline each and identify the ownership thereof (both as to working interest and royalty).
3. If more than one lease of different ownership is dedicated to the well, have the interests of all owners been consolidated by communitization, unitization, force-pooling, etc?

☐ Yes ☐ No If answer is "yes," type of consolidation _____

If answer is "no," list the owners and tract descriptions which have actually been consolidated. (Use reverse side of this form if necessary.) _____

No allowable will be assigned to the well until all interests have been consolidated (by communitization, unitization, forced-pooling, or otherwise) or until a non-standard unit, eliminating such interests, has been approved by the Commission.

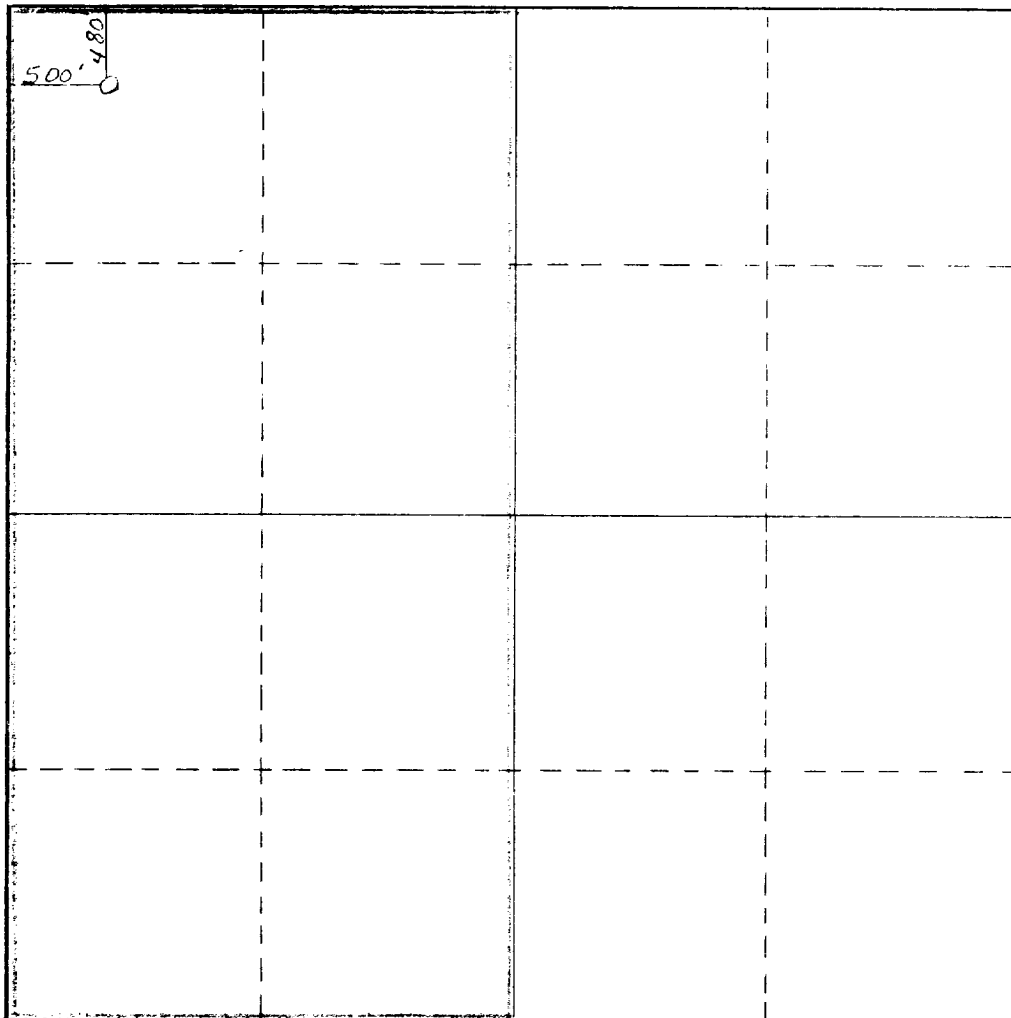

CERTIFICATION

I hereby certify that the information contained herein is true and complete to the best of my knowledge and belief.

Name: *Paul G. Yates*

Position: **Vice President**

Company: **Harvey E. Yates Company**

Date: **August 24, 1978**

I hereby certify that the well location shown on this plat was plotted from field notes of actual surveys made by me or under my supervision, and that the same is true and correct to the best of my knowledge and belief.

PLEASE SEE ORIGINAL

Date Surveyed:

SURVEY

Registered Professional Engineer and/or Land Surveyor

Certificate No.

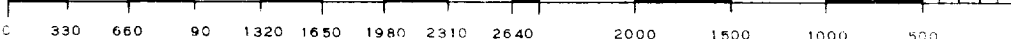

DRAWWORKS

Emsco GB-800

Drum: 1 1/4" Lebus grooved

Compound: 2-engine oil bath chain drive

Brake: Hydromatic Parkersburg 46" Double

ENGINES

Two 610-H.P. D379TA Caterpillar Diesel

DERRICK

Lee C. Moore, 131', 550,000 lb. nominal capacity

SUBSTRUCTURE

Lee C. Moore, 15' high, 550,000 lb. nominal capacity

MUD PUMPS

Pump No. 1: Emsco DB700. 700 H.P. with steel fluid end. 4 3/4" — 7 3/4" liners, 16" stroke. Compound-driven.

Pump No. 2: Emsco DA500, 500 H.P. powered by 400 H.P. D353 Caterpillar Diesel.

DRILL STRING

3000' 4-1/1" Grade E, 20 lb.

Tool Joints: 4 1/2" H-90, 6 1/4" OD,

12000' 4 1/2" Grade E, 16.60 lb.

Tool Joints: 4" H-90, 6" OD

Thirty Drilco spiral-grooved 6 1/2" OD, 2 1/4" ID. With 4" H-90 Joints.

Other sized drillpipe & drillcollars available.

BLOWOUT PREVENTERS

One Shaffer LWS Hydraulic double 10" x 1500 series. One Shaffer Spherical 10" x 1500 series. Choke manifold 4" x 1500 series flanged connections. Payne 4 valve accumulator closing unit.

MUD SYSTEM

3 — 30 x 7 1/2 x 6 steel pits, with 700 Bbl. capacity. Complete low pressure circulating system, consisting of four submerged mud guns and two counter sunk jets in each pit. System utilizes a 6x8 centrifugal pump, powered by diesel.

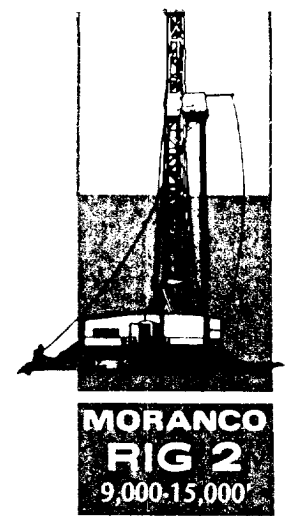

MUD HOUSE

1 — 8' x 30' Steel Storage House

COMMUNICATIONS

24-Hour direct telephone interconnection through Hobbs (A.C. 505-397-3291) or Midland - Odessa (A.C. 915-563-0562).

OTHER EQUIPMENT

BLOCKS — McKissick 350 Ton

HOOK — BJ4300 350 Ton

SWIVEL — Oilwell PC 425 Ton

LIGHT PLANTS — One 40 KW and one 20 KW AC generators, powered by diesel engines.

LIGHTS — AC fluorescent or mercury — All vapor proof.

SHALE SHAKER — Link belt, single screen.

FRESH WATER STORAGE — two 500 Bbl., horizontal tanks.

HOUSING — 1 - 8' x 36' airconditioned trailer house, with sleeping and cooking facilities.

