

NO. OF COPIES RECEIVED	
DISTRIBUTION	
SANTA FE	1
FILE	1
U.S.G.S.	2
LAND OFFICE	
OPERATOR	1

NEW MEXICO OIL CONSERVATION COMMISSION

JAN 27 1978

O. C. C.

30-015-22410

Form C-101
Revised 1-1-65

5A. Indicate Type of Lease STATE <input type="checkbox"/> FEE <input checked="" type="checkbox"/>
5. State Oil & Gas Lease No.
7. Unit Agreement Name
8. Farm or Lease Name Kindle
9. Well No. 3
10. Field and Pool, or Wildcat Dayton Grayburg
12. County Eddy
19. Proposed Depth 1150
19A. Formation Grayburg
20. Rotary or C.T. Rotary
21. Elevations (Show whether DF, RT, etc.) 3304.3 GL
21A. Kind & Status Plug. Bond Statewide
21B. Drilling Contractor Company Tools
22. Approx. Date Work will start January 28, 1978

APPLICATION FOR PERMIT TO DRILL, DEEPEN, OR PLUG BACK

1a. Type of Work DRILL <input checked="" type="checkbox"/> DEEPEN <input type="checkbox"/> PLUG BACK <input type="checkbox"/>
b. Type of Well OIL WELL <input checked="" type="checkbox"/> GAS WELL <input type="checkbox"/> OTHER <input type="checkbox"/>
2. Name of Operator C. E. LaRue and B. N. Muncy, Jr.
3. Address of Operator P. O. Box 196 Artesia, N. M. 88210
4. Location of Well UNIT LETTER B LOCATED 990 FEET FROM THE North LINE AND 2310 FEET FROM THE East LINE OF SEC. 26 TWP. 18S RGE. 26E NMPM
19. Proposed Depth 1150
19A. Formation Grayburg
20. Rotary or C.T. Rotary
21. Elevations (Show whether DF, RT, etc.) 3304.3 GL
21A. Kind & Status Plug. Bond Statewide
21B. Drilling Contractor Company Tools
22. Approx. Date Work will start January 28, 1978

PROPOSED CASING AND CEMENT PROGRAM

SIZE OF HOLE	SIZE OF CASING	WEIGHT PER FOOT	SETTING DEPTH	SACKS OF CEMENT	EST. TOP
9 7/8"	7"	23#	920	275	Circulated
6 1/2"	4 1/2"	10 1/2#	1150	100	Circulated

Adequate blow out preventer to be used.

APPROVAL VALID
FOR 90 DAYS UNLESS
DRILLING COMMENCED,
EXPIRES 4-27-78

IN ABOVE SPACE DESCRIBE PROPOSED PROGRAM; IF PROPOSAL IS TO DEEPEN OR PLUG BACK, GIVE DATA ON PRESENT PRODUCTIVE ZONE AND PROPOSED NEW PRODUCTIVE ZONE. GIVE BLOWOUT PREVENTER PROGRAM, IF ANY.

I hereby certify that the information above is true and complete to the best of my knowledge and belief.

Signed [Signature] Title Operator Date January 25, 1978
(This space for State Use)

APPROVED BY [Signature] TITLE SUPERVISOR, DISTRICT II DATE JAN 27 1978

CONDITIONS OF APPROVAL, IF ANY:

Minimum WOC time 18 hrs.

Cement must be circulated to
surface behind 7" + 4 1/2" casing

Notify N.M.O.C.C. in sufficient
time to witness cementing
the 7" casing

MEXICO OIL CONSERVATION COMMISSION
WELL LOCATION AND ACREAGE DEDICATION PLAT

Revised 1-1-65
Supersedes O-12r
Effective 1-1-65

All distances must be from the outer boundaries of the Section

Operator C E LaRue & Muncy Jr.			Lease Kindle		Well No. 3
Tract Letter B	Section 26	Township 18 South	Range 26 East	County Eddy	
Actual Well Location of Well:					
990	feet from the	North	line and	2310	feet from the East line
Ground Level Elev. 3304.3	Producing Formation Grayburg		Pool Dayton Grayburg		Dedicated Acreage: 40 Acres

- Outline the acreage dedicated to the subject well by colored pencil or hatchure marks on the plat below.
- If more than one lease is dedicated to the well, outline each and identify the ownership thereof (both as to working interest and royalty).
- If more than one lease of different ownership is dedicated to the well, have the interests of all owners been consolidated by communitization, unitization, force-pooling, etc?

☐ Yes ☐ No If answer is "yes," type of consolidation _____

If answer is "no," list the owners and tract descriptions which have actually been consolidated (Use reverse side of this form if necessary.) _____

No allowable will be assigned to the well until all interests have been consolidated (by communitization, unitization, forced-pooling, or otherwise) or until a non-standard unit, eliminating such interests, has been approved by the Commission.

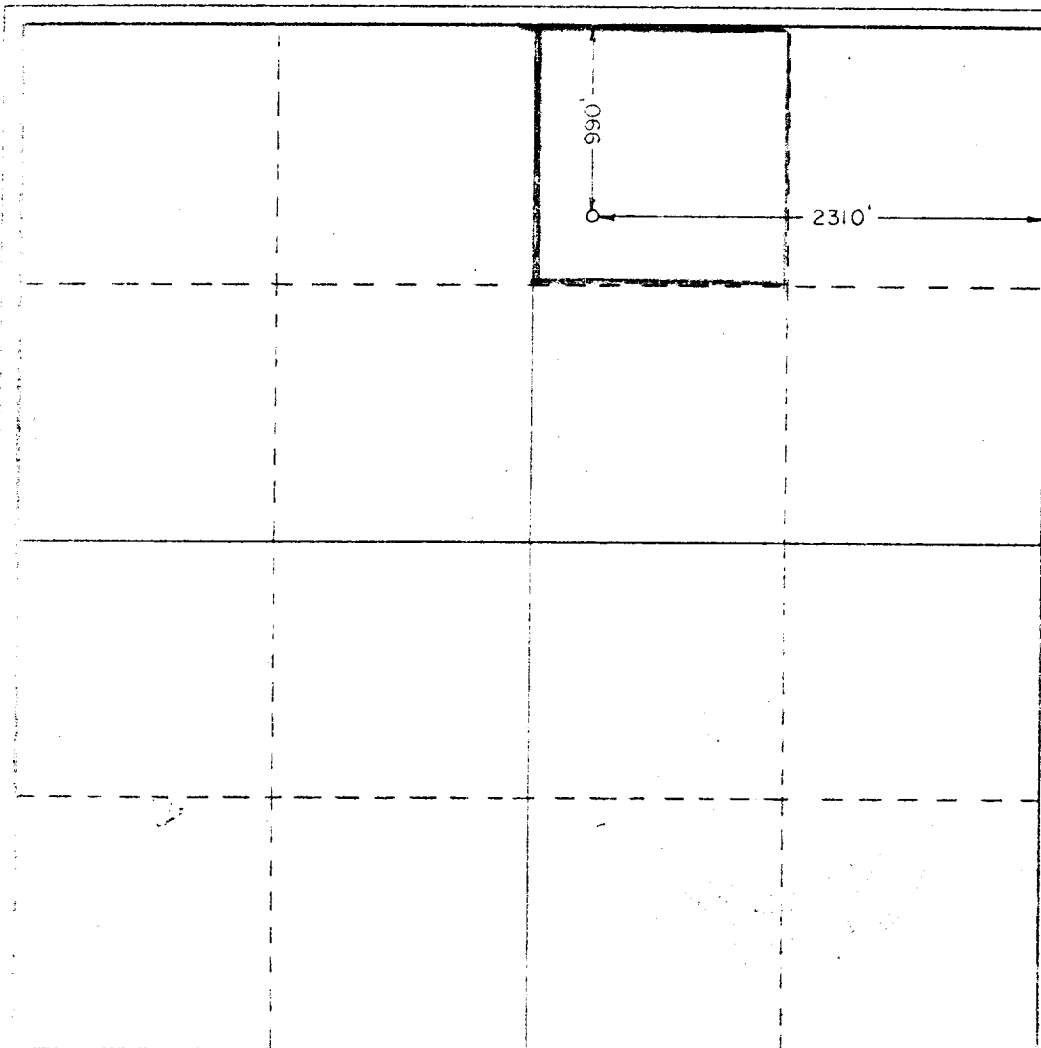

CERTIFICATION

I hereby certify that the information contained herein is true and complete to the best of my knowledge and belief.

Name *C. E. LaRue & B. N. Muncy, Jr.*
 Position *Operator*
 Company *C. E. LaRue & B. N. Muncy, Jr.*
 Date *January 26, 1978*

I hereby certify that the well location shown on this plat was plotted from field notes of actual surveys made by me or under my supervision, and that the same is true and correct to the best of my knowledge and belief.

Date Surveyed *1/20/78*

Registered Professional Engineer and/or Land Surveyor

John W. West
 Certificate No. *John W. West*

0 500 1000 1500 2000 2500 3000 3500 4000 4500 5000 5500 6000 6500 7000 7500 8000 8500 9000 9500 10000