

|                        |   |
|------------------------|---|
| NO. OF COPIES RECEIVED | 6 |
| DISTRIBUTION           |   |
| SANTA FE               | / |
| FILE                   | / |
| U.S.G.S.               | 2 |
| LAND OFFICE            | / |
| OPERATOR               | / |

**RECEIVED**  
**NEW MEXICO OIL CONSERVATION COMMISSION**  
**APR 6 1978**  
**O. C. C.**  
**ARTESIA, OFFICE**

30-015-22489  
Form C-101  
Revised 1-1-65

|  |
|--|
| 5A. Indicate Type of Lease<br>STATE <input checked="" type="checkbox"/> FEE <input type="checkbox"/> |
| 5. State Oil & Gas Lease No.<br>B-3823-1   |

**APPLICATION FOR PERMIT TO DRILL, DEEPEN, OR PLUG BACK**

|  |  |   |  |
|--|--|---|--|
| 1a. Type of Work<br>b. Type of Well<br>OIL WELL <input checked="" type="checkbox"/> GAS WELL <input type="checkbox"/> OTHER <input type="checkbox"/><br>SINGLE ZONE <input checked="" type="checkbox"/> MULTIPLE ZONE <input type="checkbox"/> |  | 2. Name of Operator<br>Atlantic Richfield Company ✓               |  |
| 3. Address of Operator<br>P. O. Box 1710, Hobbs, New Mexico 88240  |  | 7. Unit Agreement Name<br>Empire Abo Pressure Maintenance Project |  |
| 4. Location of Well<br>UNIT LETTER A LOCATED 1150 FEET FROM THE North LINE<br>AND 1270 FEET FROM THE East LINE OF SEC. 5 TWP. 18S RGE. 28E NMPM  |  | 8. Farm or Lease Name<br>Empire Abo Unit "I"                      |  |
| 5. Proposed Depth<br>6370'   |  | 9. Well No.<br>282  |  |
| 6. Formation<br>Abo Reef   |  | 10. Field and Pool, or Wildcat<br>✓ Empire Abo                    |  |
| 7. Rotary or C.T.<br>Rotary  |  | 11. County<br>Eddy  |  |
| 21. Elevations (Show whether DP, RT, etc.)<br>3655.1' GR   |  | 22. Approx. Date Work will start<br>5/15/78                       |  |
| 21A. Kind & Status Plug. Bond<br>GCA #8  |  | 21B. Drilling Contractor<br>Hondo Drlg. Co.                       |  |

**PROPOSED CASING AND CEMENT PROGRAM**

| SIZE OF HOLE | SIZE OF CASING | WEIGHT PER FOOT | SETTING DEPTH | SACKS OF CEMENT | EST. TOP     |
|--------------|----------------|-----------------|---------------|-----------------|--------------|
| 11"          | 8-5/8" OD      | 24# K-55        | 550'          | 250 sx          | Circ to surf |
| 7-7/8"       | 5-1/2" OD      | 14# K-55        | 6000'         |                 |              |
|              |                | 15.5# K-55      | 6370'         | 1205 sx         | Circ to surf |

Propose to drill an infill development well within the Empire Abo Unit area to more economically recover additional oil reserves and conserve reservoir pressure in accordance w/Unit OCC Rules & Regulations NSL-915.

Blowout Preventer Program attached.

APPROVAL VALID  
FOR 90 DAYS UNLESS  
DRILLING COMMENCED,  
EXPIRES 7-10-78

IN ABOVE SPACE DESCRIBE PROPOSED PROGRAM: IF PROPOSAL IS TO DEEPEN OR PLUG BACK, GIVE DATA ON PRESENT PRODUCTIVE ZONE AND PROPOSED NEW PRODUCTIVE ZONE. GIVE BLOWOUT PREVENTER PROGRAM, IF ANY.

I hereby certify that the information above is true and complete to the best of my knowledge and belief.

Signed W. A. Gressett Title Dist. Drlg. Supt. Date 4/4/78

(This space for State Use)

APPROVED BY W. A. Gressett TITLE SUPERVISOR, DISTRICT II DATE APR 10 1978

CONDITIONS OF APPROVAL, IF ANY:

MEXICO OIL CONSERVATION COMMISSION  
WELL LOCATION AND ACREAGE DEDICATION PLAT

Form C-102  
Supersedes C-128  
Effective 1-1-64

All distances must be from the outer boundaries of the Section

|  |  |                                     |                                      |                        |
|--|--|-------------------------------------|--------------------------------------|------------------------|
| Operator<br><b>Atlantic Richfield Co.</b>  |  | Lease<br><b>Empire Abo Unit - 1</b> |                                      | Well No.<br><b>282</b> |
| Unit Letter<br><b>A</b>  | Section<br><b>5</b>                    | Township<br><b>18 South</b>         | Range<br><b>28 East</b>              | County<br><b>Eddy</b>  |
| Actual Footage Location of Well:<br><b>1150</b> feet from the <b>North</b> line and <b>1270</b> feet from the <b>East</b> line |  |                                     |                                      |                        |
| Ground Level Elev.<br><b>3655.1</b>  | Producing Formation<br><b>Abo Reef</b> | Pool<br><b>Empire Abo</b>           | Estimated Acreage<br><b>40</b> Acres |                        |

1. Outline the acreage dedicated to the subject well by colored pencil or hatchure marks on the plat below.
2. If more than one lease is dedicated to the well, outline each and identify the ownership thereof (both as to working interest and royalty).
3. If more than one lease of different ownership is dedicated to the well, have the interests of all owners been consolidated by communitization, unitization, force-pooling, etc?

☒ Yes ☐ No If answer is "yes," type of consolidation Unitization

If answer is "no," list the owners and tract descriptions which have actually been consolidated. (Use reverse side of this form if necessary.) \_\_\_\_\_

No allowable will be assigned to the well until all interests have been consolidated (by communitization, unitization, forced-pooling, or otherwise) or until a non-standard unit, eliminating such interests, has been approved by the Commission.

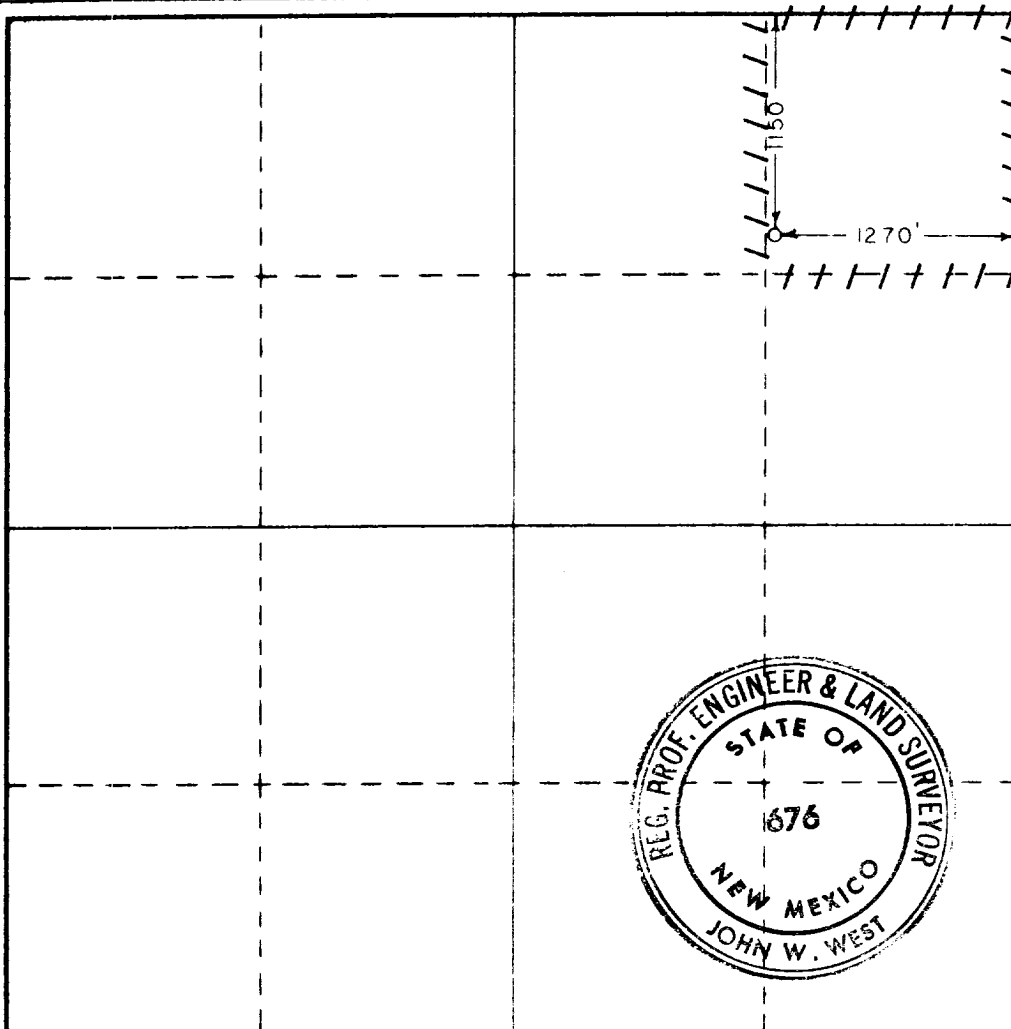

CERTIFICATION

I hereby certify that the information contained herein is true and complete to the best of my knowledge and belief.

Name

Position

**Dist. Dirg. Supt.**

Company

**Atlantic Richfield Company**

Date

**4/4/76**

I hereby certify that the well location shown on this plat was plotted from field notes of actual surveys made by me or under my supervision, and that the same is true and correct to the best of my knowledge and belief.

**December 16, 1977**

Date Surveyed

Registered Professional Engineer and/or Land Surveyor

*John W. West*

Certificate No. **John W. West 676**

**Ronald J. Eidson 3239**

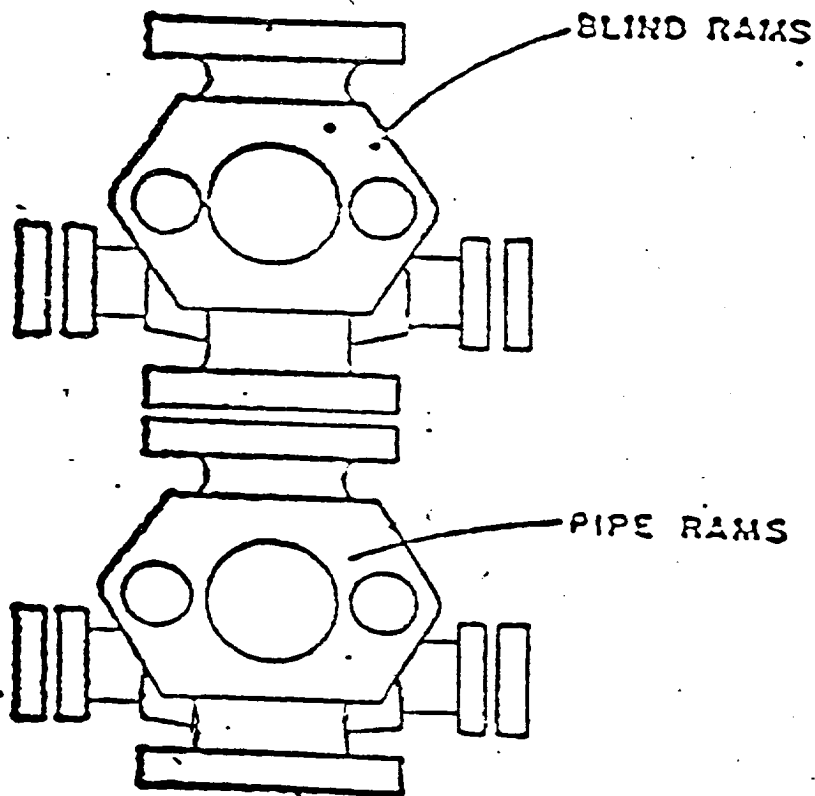

**ATLANTIC RICHFIELD COMPANY**  
**Blow Out Preventer Program**

**Lease Name** Empire Abo Unit "I"

**Well No.** 282

**Location** 1150' FNL & 1270' FEL  
Sec 5-18S-28E, Eddy County

BOP to be tested before installed on well and will be maintained in good working condition during drilling. All wellhead fittings to be of sufficient pressure to operate in a safe manner.