

NO. OF COPIES RECEIVED	6
DISTRIBUTION	
SANTA FE	/
FILE	/
U.S.G.S.	2
LAND OFFICE	/
OPERATOR	/

RECEIVED
NEW MEXICO OIL CONSERVATION COMMISSION

APR 28 1978

O. C. C.
ARTESIA, OFFICE

30-015-22527

Form C-101
Revised 1-1-65

5A. Indicate Type of Lease	
STATE <input checked="" type="checkbox"/>	FEE <input type="checkbox"/>
5. State Oil & Gas Lease No.	
B-11594-3	

APPLICATION FOR PERMIT TO DRILL, DEEPEN, OR PLUG BACK

1a. Type of Work			7. Unit Agreement Name		
b. Type of Well			Empire Abo Pressure Maintenance Project		
DRILL <input checked="" type="checkbox"/>	DEEPEN <input type="checkbox"/>	PLUG BACK <input type="checkbox"/>	8. Farm or Lease Name		
OIL WELL <input checked="" type="checkbox"/>	GAS WELL <input type="checkbox"/>	OTHER <input type="checkbox"/>	Empire Abo Unit "J"		
2. Name of Operator			9. Well No.		
Atlantic Richfield Company ✓			223		
3. Address of Operator			10. Field and Pool, or Wildcat		
P. O. Box 1710, Hobbs, New Mexico 88240			X Empire Abo		
4. Location of Well			12. County		
UNIT LETTER F	LOCATED 2630	FEET FROM THE North LINE	Eddy		
AND 1930	FEET FROM THE West	LINE OF SEC. 6 TWP. 18S RGE. 28E NMPM			
18. Proposed Depth			19A. Formation		20. Rotary or C.T.
6250'			Abo Reef		Rotary
21. Elevations (Show whether DF, RT, etc.)		21A. Kind & Status Plug. Bond	21B. Drilling Contractor		22. Approx. Date Work will start
3644.3' GR		GCA #8	Hondo Drilling Company		6/15/78

PROPOSED CASING AND CEMENT PROGRAM

SIZE OF HOLE	SIZE OF CASING	WEIGHT PER FOOT	SETTING DEPTH	SACKS OF CEMENT	EST. TOP
11"	8-5/8" OD	24# K-55	550'	250'	Circ to surf
7-7/8"	5-1/2" OD	14# K-55	6000'		
		15.5# K-55	6250'	1205'	Circ to surf

Propose to drill an infill development well within the Empire Abo Unit area to more economically recover additional oil reserves and conserve reservoir pressure in accordance with Unit OCC Rules & Regulations. NSL 915.

Blowout Preventer Program attached.

APPROVAL VALID
FOR 90 DAYS UNLESS
DRILLING COMMENCED,

EXPIRES 8-2-78

IN ABOVE SPACE DESCRIBE PROPOSED PROGRAM: IF PROPOSAL IS TO DEEPEN OR PLUG BACK, GIVE DATA ON PRESENT PRODUCTIVE ZONE AND PROPOSED NEW PRODUCTIVE ZONE. GIVE BLOWOUT PREVENTER PROGRAM, IF ANY.

I hereby certify that the information above is true and complete to the best of my knowledge and belief.

Signed [Signature] Title Dist. Drlg. Supt. Date 4/25/78

(This space for State Use)

APPROVED BY W. A. Gressett TITLE SUPERVISOR, DISTRICT DATE MAY 2 1978

CONDITIONS OF APPROVAL, IF ANY:

N MEXICO OIL CONSERVATION COMMISS
WELL LOCATION AND ACREAGE DEDICATION PLAT

Form C-102
 Supersedes C-128
 Effective 1-1-65

All distances must be from the outer boundaries of the Section

Operator Atlantic Richfield Co.			Lease Empire Abo Unit - J		Well No. 223
Unit Letter F	Section 6	Township 18 South	Range 28 East	County Eddy	
Actual Footage Location of Well: 2630 feet from the North line and 1930 feet from the West line					
Ground Level Elev. 3644.3	Producing Formation Abo Reef		Pool Empire Abo		Dedicated Acreage: 40 Acres

1. Outline the acreage dedicated to the subject well by colored pencil or hatchure marks on the plat below.
2. If more than one lease is dedicated to the well, outline each and identify the ownership thereof (both as to working interest and royalty).
3. If more than one lease of different ownership is dedicated to the well, have the interests of all owners been consolidated by communitization, unitization, force-pooling, etc?

☒ Yes ☐ No If answer is "yes," type of consolidation **Unitization**

If answer is "no," list the owners and tract descriptions which have actually been consolidated. (Use reverse side of this form if necessary.) _____

No allowable will be assigned to the well until all interests have been consolidated (by communitization, unitization, forced-pooling, or otherwise) or until a non-standard unit, eliminating such interests, has been approved by the Commission.

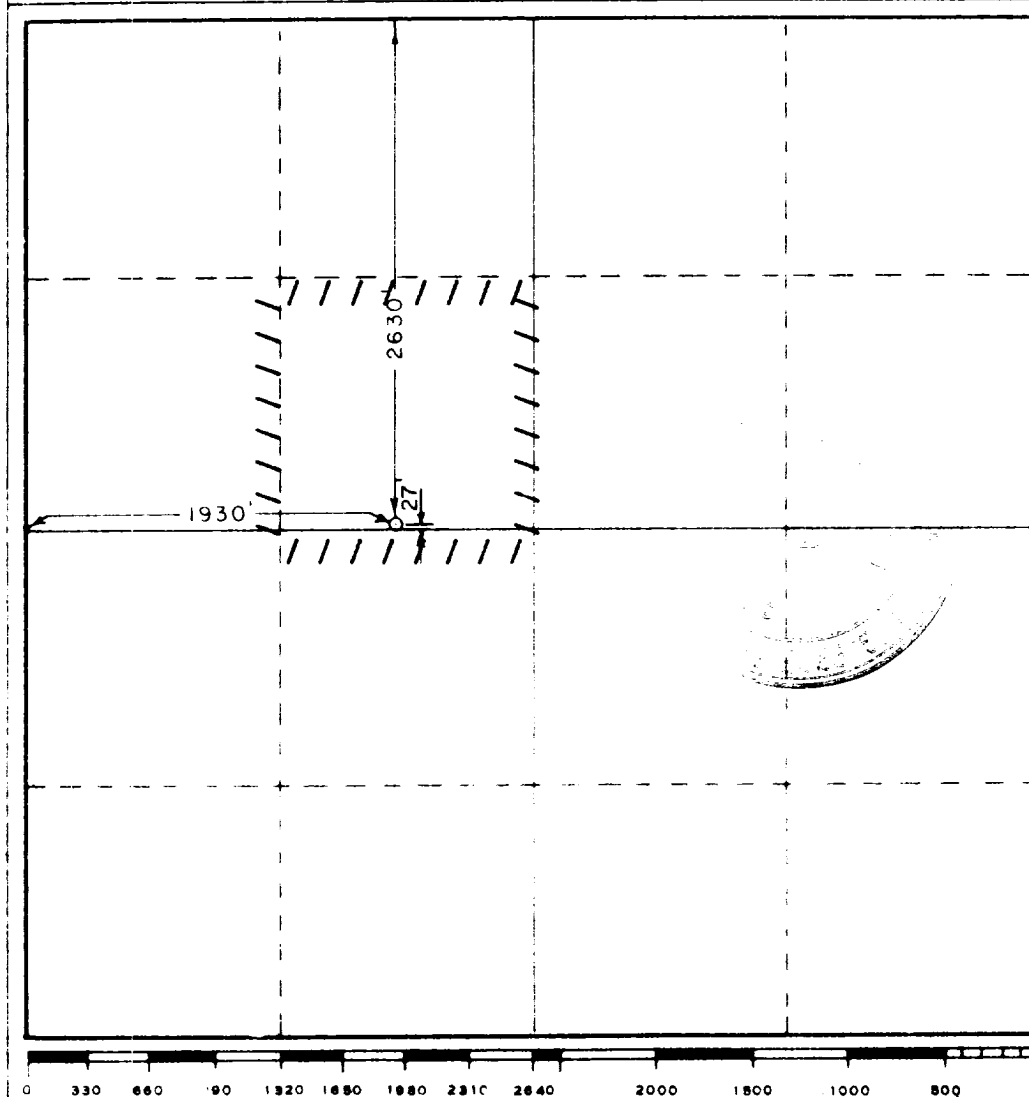

CERTIFICATION

I hereby certify that the information contained herein is true and complete to the best of my knowledge and belief.

Name _____

Position _____

Dist. Dir. Supt.

Company _____

Atlantic Richfield Company

Date _____

4/25/78

I hereby certify that the well location shown on this plat was plotted from field notes of actual surveys made by me or under my supervision, and that the same is true and correct to the best of my knowledge and belief.

December 19, 1977

Date Surveyed _____

Registered Professional Engineer
 and/or Land Surveyor

John W. Wint

Certificate No. _____

676

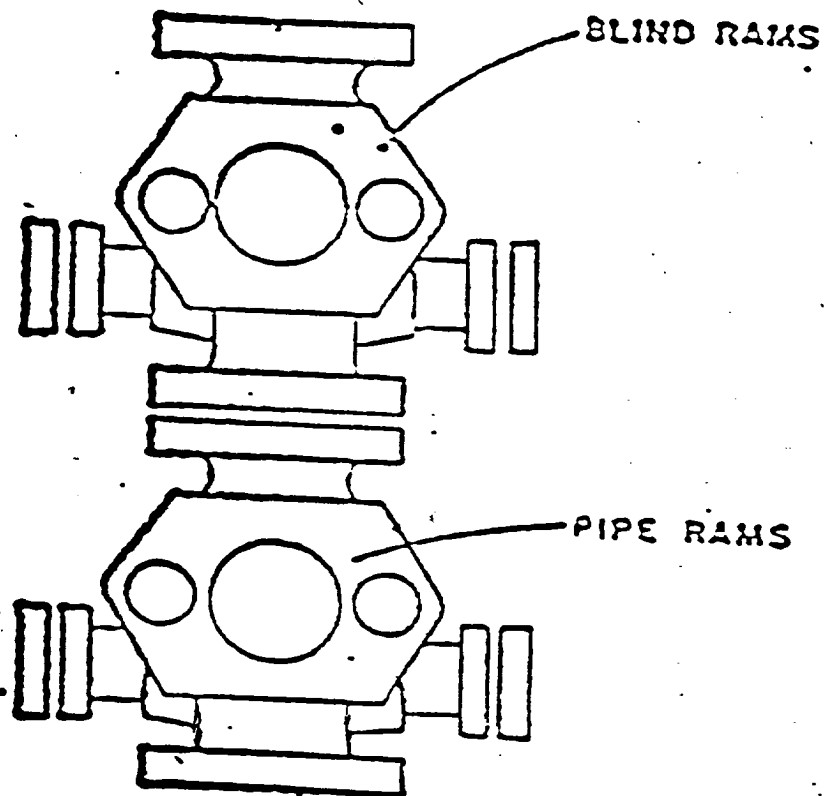

ATLANTIC RICHFIELD COMPANY
Blow Out Preventer Program

Lease Name Empire Abo Unit "J"

Well No. 223

Location 2630' FNL & 1930' FWL
Sec 6-18S-28E, Eddy County

BOP to be tested before installed on well and will be maintained in good working condition during drilling. All wellhead fittings to be of sufficient pressure to operate in a safe manner.