

NO. OF COPIES RECEIVED	6
DISTRIBUTION	
SANTA FE	1
FILE	1
U.S.G.S.	2
LAND OFFICE	1
OPERATOR	1

RECEIVED
NEW MEXICO OIL CONSERVATION COMMISSION

APR 28 1978

O. C. C.
ARTESIA, OFFICE

30-015-22528

Form C-101
Revised 1-1-65

5A. Indicate Type of Lease STATE <input checked="" type="checkbox"/> FEE <input type="checkbox"/>
5. State Oil & Gas Lease No. OG-103
7. Unit Agreement Name Empire Abo Pressure Maintenance Project
8. Farm or Lease Name Empire Abo Unit "K"
9. Well No. 232
10. Field and Pool, or Wildcat Empire Abo
12. County Eddy
19. Proposed Depth 6350
19A. Formation Abo Reef
20. Rotary or C.T. Rotary
21. Elevations (Show whether DF, RT, etc.) 3653.1' GR
21A. Kind & Status Plug. Bond GCA #8
21B. Drilling Contractor Hondo Drilling Co.
22. Approx. Date Work will start 5/15/78

APPLICATION FOR PERMIT TO DRILL, DEEPEN, OR PLUG BACK

1a. Type of Work b. Type of Well OIL WELL <input checked="" type="checkbox"/> GAS WELL <input type="checkbox"/> OTHER <input type="checkbox"/> DRILL <input checked="" type="checkbox"/> DEEPEN <input type="checkbox"/> PLUG BACK <input type="checkbox"/> SINGLE ZONE <input checked="" type="checkbox"/> MULTIPLE ZONE <input type="checkbox"/>	2. Name of Operator Atlantic Richfield Company	3. Address of Operator P. O. Box 1710, Hobbs, New Mexico 88240	4. Location of Well UNIT LETTER J LOCATED 2300 FEET FROM THE South LINE AND 1570 FEET FROM THE East LINE OF SEC. 6 TWP. 18S RGE. 28E NMPM
23.			

PROPOSED CASING AND CEMENT PROGRAM

SIZE OF HOLE	SIZE OF CASING	WEIGHT PER FOOT	SETTING DEPTH	SACKS OF CEMENT	EST. TOP
11"	8-5/8" OD	24# K-55	550'	250	Circ to surf
7-7/8"	5-1/2" OD	14# K-55	6000'		
		15.5# K-55	6350'	1205	Circ to surf

Propose to drill an infill development well within the Empire Abo Unit area to more economically recover additional oil reserves and conserve reservoir pressure in accordance with Unit OCC Rules & Regulations - NSL 915.

Blowout Preventer Program attached.

APPROVAL VALID
FOR 90 DAYS UNLESS
DRILLING COMMENCED,
EXPIRES 8-2-78

IN ABOVE SPACE DESCRIBE PROPOSED PROGRAM: IF PROPOSAL IS TO DEEPEN OR PLUG BACK, GIVE DATA ON PRESENT PRODUCTIVE ZONE AND PROPOSED NEW PRODUCTIVE ZONE, GIVE BLOWOUT PREVENTER PROGRAM, IF ANY.

I hereby certify that the information above is true and complete to the best of my knowledge and belief.

Signed W. A. Gressett Title Dist. Drlg. Supt. Date 4/25/78

(This space for State Use)

APPROVED BY W. A. Gressett TITLE SUPERVISOR, DISTRICT II DATE MAY 2 1978

CONDITIONS OF APPROVAL, IF ANY:

NEW MEXICO OIL CONSERVATION COMMISSION
WELL LOCATION AND ACREAGE DEDICATION PLAT

All distances must be from the outer boundaries of the Section

Operator Atlantic Richfield Co.			Lease Empire Abo Unit - K		Acres 232
Unit Letter J	Section 6	Township 18 South	Range 28 East	County Eddy	
Actual Footage Location of Well: 2300 feet from the South line and 1570 feet from the East line					
Ground Level Elev 3653.1	Producing Formation Abo Reef	Pool Empire Abo		Section Area 40	

1. Outline the acreage dedicated to the subject well by colored pencil or hatchure marks on the plat below.
2. If more than one lease is dedicated to the well, outline each and identify the ownership thereof (both as to working interest and royalty).
3. If more than one lease of different ownership is dedicated to the well, have the interests of all owners been consolidated by communitization, unitization, force-pooling, etc?

☒ Yes ☐ No If answer is "yes," type of consolidation Unitization

If answer is "no," list the owners and tract descriptions which have actually been consolidated (Use reverse side of this form if necessary.) _____

No allowable will be assigned to the well until all interests have been consolidated (by communitization, unitization, forced-pooling, or otherwise) or until a non-standard unit, eliminating such interests, has been approved by the Commission.

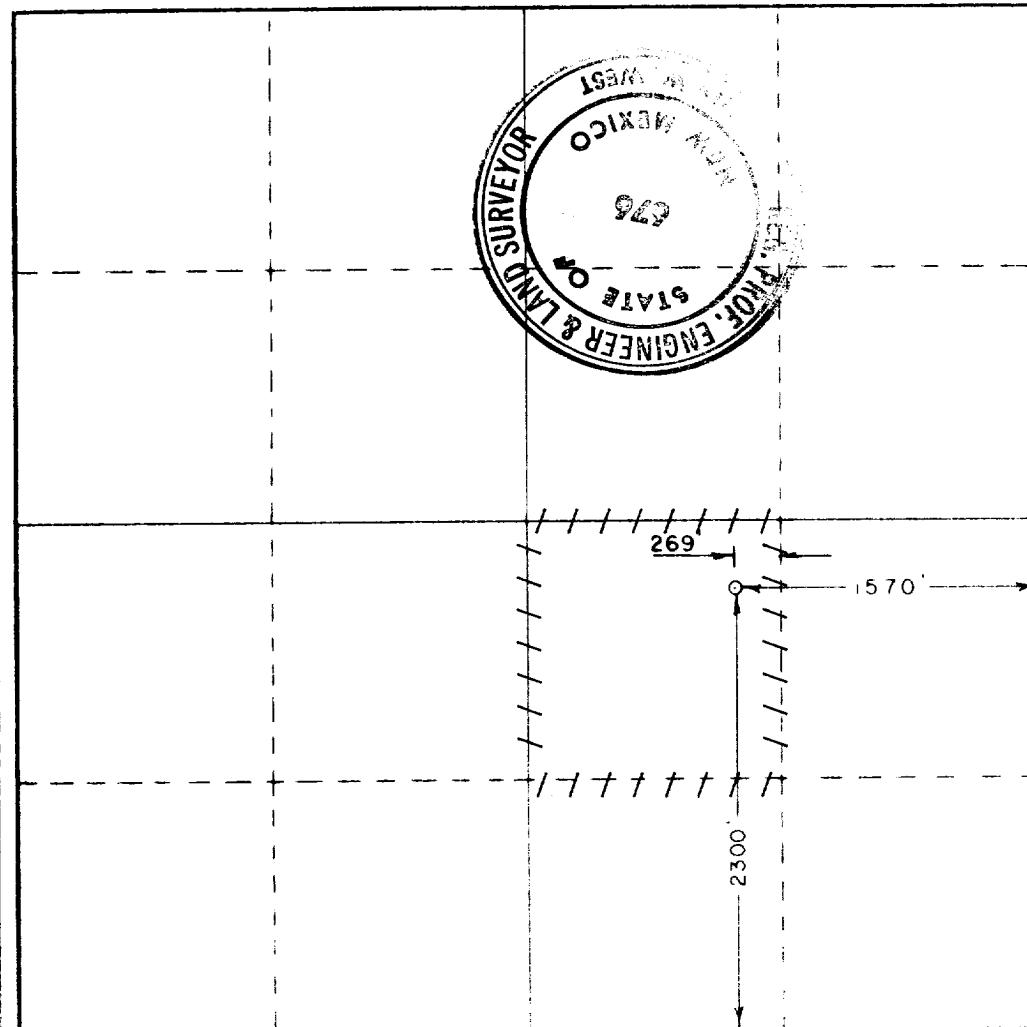

CERTIFICATION

I hereby certify that the information contained herein is true and complete to the best of my knowledge and belief

Name: [Signature]
 Position: Dist. Drlg. Supt.
 Company: Atlantic Richfield Company
 Date: 4/25/78

I hereby certify that the well location shown on this plat was plotted from field notes of actual surveys made by me or under my supervision, and that the same is true and correct to the best of my knowledge and belief

December 19, 1977

Date of Survey: _____
 By: State Engineer & Land Surveyor
[Signature]

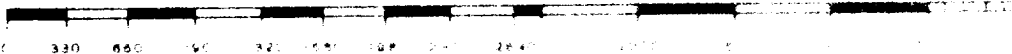

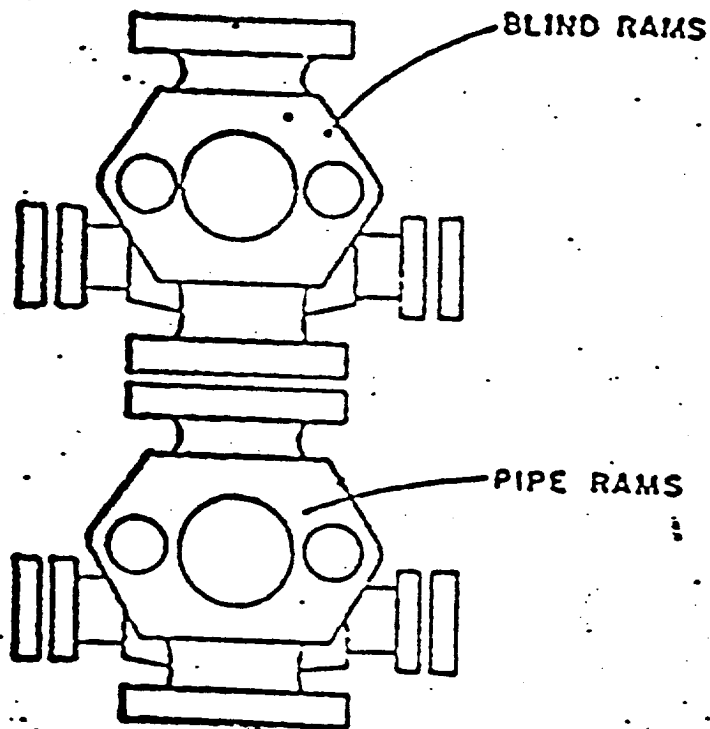

ATLANTIC RICHFIELD COMPANY
Blow Out Preventer Program

Lease Name Empire Abo Unit "K"

Well No. 232

Location 2300' FSL & 1570' FEL
Sec 6-18S-28E, Eddy County

BOP to be tested before installed on well and will be maintained in good working condition during drilling. All wellhead fittings to be of sufficient pressure to operate in a safe manner.