

NO. OF COPIES RECEIVED	6
DISTRIBUTION	
SANTA FE	/
FILE	/
U.S.G.S.	2
LAND OFFICE	/
OPERATOR	/

NEW MEXICO OIL CONSERVATION COMMISSION

RECEIVED

JUL 3 1978

30-015-22608

Form C-101
Revised 1-1-65

5A. Indicate Type of Lease	
STATE <input checked="" type="checkbox"/>	FEE <input type="checkbox"/>
5. State Oil & Gas Lease No.	
B-7244-30	
7. Unit Agreement Name	
Empire Abo Pressure	
8. Farm or Lease Name	
Maintenance Project	
8. Farm or Lease Name	
Empire Abo Unit "L"	
9. Well No.	
142	
10. Field and Pool, or Wildcat	
Empire Abo	
12. County	
Eddy	
19. Proposed Depth	
6200'	
19A. Formation	
Abo Reef	
20. Rotary or C.T.	
Rotary	
21. Elevations (Show whether DF, RT, etc.)	
3555.6' GR	
21A. Kind & Status Plug. Bond	
GCA #8	
21B. Drilling Contractor	
Hondo Drilling Co.	
22. Approx. Date Work will start	
August 14, 1978	

APPLICATION FOR PERMIT TO DRILL, DEEPEN, OR PLUG BACK

1a. Type of Work	
DRILL <input checked="" type="checkbox"/>	DEEPEN <input type="checkbox"/>
b. Type of Well	
OIL WELL <input checked="" type="checkbox"/>	GAS WELL <input type="checkbox"/>
OTHER <input type="checkbox"/>	
2. Name of Operator	
Atlantic Richfield Company	
3. Address of Operator	
P. O. Box 1710, Hobbs, New Mexico 88240	
4. Location of Well	
UNIT LETTER N	LOCATED 100 FEET FROM THE South LINE
AND 1950 FEET FROM THE West	LINE OF SEC. 2 TWP. 18S RGE. 27E NMPM
19. Proposed Depth	
6200'	
19A. Formation	
Abo Reef	
20. Rotary or C.T.	
Rotary	
21. Elevations (Show whether DF, RT, etc.)	
3555.6' GR	
21A. Kind & Status Plug. Bond	
GCA #8	
21B. Drilling Contractor	
Hondo Drilling Co.	
22. Approx. Date Work will start	
August 14, 1978	

23.

PROPOSED CASING AND CEMENT PROGRAM

SIZE OF HOLE	SIZE OF CASING	WEIGHT PER FOOT	SETTING DEPTH	SACKS OF CEMENT	EST. TOP
11"	8-5/8" OD	24# K-55	1000'	400	Circ
7-7/8"	5-1/2" OD	15.5# K-55	6200'	1250	Circ

Propose to drill an infill development well within the Empire Abo Unit Area to more economically recover additional oil reserves and conserve reservoir pressure in accordance with Unit OCC Rules & Regulations.

Blowout Preventer Program attached.

NSL-937

APPROVAL VALID
FOR 90 DAYS UNLESS
DRILLING COMMENCED,
EXPIRES 10-6-78

IN ABOVE SPACE DESCRIBE PROPOSED PROGRAM: IF PROPOSAL IS TO DEEPEN OR PLUG BACK, GIVE DATA ON PRESENT PRODUCTIVE ZONE AND PROPOSED NEW PRODUCTIVE ZONE. GIVE BLOWOUT PREVENTER PROGRAM, IF ANY.

I hereby certify that the information above is true and complete to the best of my knowledge and belief.

Signed [Signature] Title Dist. Drlg. Supt. Date 6-27-78

(This space for State Use)

APPROVED BY [Signature] TITLE SUPERVISOR, DISTRICT II DATE JUL - 6 1978

CONDITIONS OF APPROVAL, IF ANY:

Notify N.M.O.C.C. in sufficient
time to witness cementing
the 8 7/8" casing

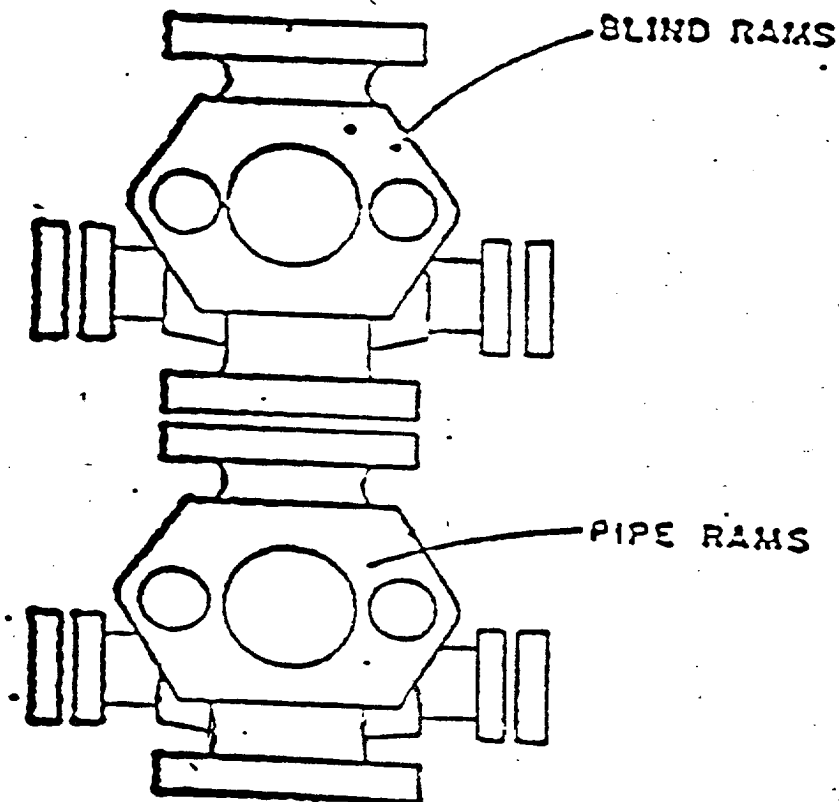

ATLANTIC RICHFIELD COMPANY
Blow Out Preventer Program

Lease Name Empire Abo Unit "L"

Well No. 142

Location 100' FSL, 1950' FWL, Sec. 2,
T18S, R27E, Eddy Co., N.M.

BOP to be tested before installed on well and will be maintained in good working condition during drilling. All wellhead fittings to be of sufficient pressure to operate in a safe manner.

MEXICO OIL CONSERVATION COMMISSION
WELL LOCATION AND ACREAGE DEDICATION PLAT

Form C-102
 Supersedes C-128
 Effective 1-1-65

All distances must be from the outer boundaries of the Section

Operator Atlantic Richfield Co.			Lease Empire Abo Unit # L		Well No. 142
Section Letter N	Section 2	Township 18 South	Range 27 East	County Eddy	
Actual Portage Location of Well: 100 feet from the South line and 1950 feet from the West line					
Ground Level Elev. 3555.6	Producing Formation Abo Reef		Pool Empire Abo		Dedicated Acreage: 40 Acres

1. Outline the acreage dedicated to the subject well by colored pencil or hatchure marks on the plat below.
2. If more than one lease is dedicated to the well, outline each and identify the ownership thereof (both as to working interest and royalty).
3. If more than one lease of different ownership is dedicated to the well, have the interests of all owners been consolidated by communitization, unitization, force-pooling, etc?

☒ Yes ☐ No If answer is "yes," type of consolidation **Unitization**

If answer is "no," list the owners and tract descriptions which have actually been consolidated. (Use reverse side of this form if necessary.) _____

No allowable will be assigned to the well until all interests have been consolidated (by communitization, unitization, forced-pooling, or otherwise) or until a non-standard unit, eliminating such interests, has been approved by the Commission.

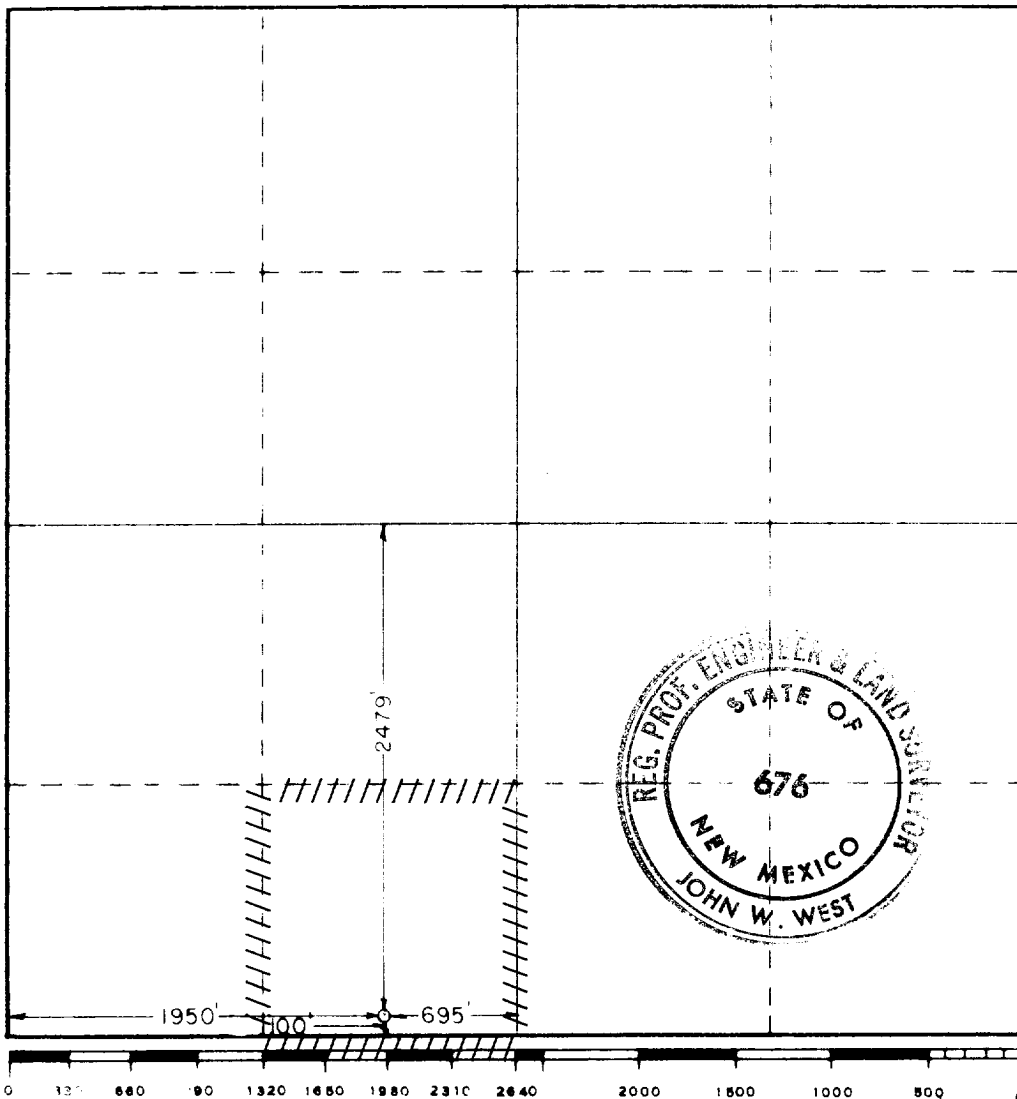

CERTIFICATION

I hereby certify that the information contained herein is true and complete to the best of my knowledge and belief

LeRoy Lane
 Name

LeRoy Lane

Position

Dist. Drlg. Supt.

Company

Atlantic Richfield Co.

Date

6-27-78

I hereby certify that the well location shown on this plat was plotted from field notes of actual surveys made by me or under my supervision, and that the same is true and correct to the best of my knowledge and belief.

March 16, 1978

Date Surveyed

Registered Professional Engineer and/or Land Surveyor

John W. West

Certificate No. **John W. West**

676

Ronald J. Eidson 3239