

100% COPY

SUBMIT IN TRIPLICATE*
(Other instructions on
reverse side)Form approved.
Budget Bureau No. 42-R1425.UNITED STATES
DEPARTMENT OF THE INTERIOR
GEOLOGICAL SURVEY

APPLICATION FOR PERMIT TO DRILL, DEEPEN, OR PLUG BACK

1a. TYPE OF WORK

DRILL ☒DEEPEN ☐PLUG BACK ☐

b. TYPE OF WELL

OIL
WELL ☒GAS
WELL ☐OTHER ☐MULTIPLE
ZONE ☐

2. NAME OF OPERATOR

Anadarko Production Company

3. ADDRESS OF OPERATOR

P. O. Box 67, Loco Hills, New Mexico 88255

4. LOCATION OF WELL (Report location clearly and in accordance with any State requirements.)*

At surface

990' FSL & 1310' FEL Sec. 8, T-18S, R-29E

At proposed prod. zone

Same

Eddy County, New Mexico

14. DISTANCE IN MILES AND DIRECTION FROM NEAREST TOWN OR POST OFFICE*

Approximately 7 miles Southwest of Loco Hills Townsite

15. DISTANCE FROM PROPOSED*

LOCATION TO NEAREST
PROPERTY OR LEASE LINE, FT.
(Also to nearest drlg. unit line, if any)

1310'

18. DISTANCE FROM PROPOSED LOCATION*

TO NEAREST WELL, DRILLING, COMPLETED,
OR APPLIED FOR, ON THIS LEASE, FT.

1476'

16. NO. OF ACRES IN LEASE

2600 3/20

19. PROPOSED DEPTH

3100

17. NO. OF ACRES ASSIGNED
TO THIS WELL

40

20. ROTARY OR CABLE TOOLS

Rotary

21. ELEVATIONS (Show whether DF, RT, GR, etc.)

3501.0 GL

22. APPROX. DATE WORK WILL START*

Oct. - Nov., 1978

23.

PROPOSED CASING AND CEMENTING PROGRAM

SIZE OF HOLE	SIZE OF CASING	WEIGHT PER FOOT	SETTING DEPTH	QUANTITY OF CEMENT
11"	7-5/8"	26.40w	350'	150 ex.
6 1/2"	4-1/2"	10.5	3100'	250 ex.

1. Rig up rotary tools.

2. Drill to approximately 350'; set & circulate or ready-mix cement surface on 7-5/8" casing. Install & test Series 900 Double Ram Hydraulic Blowout Preventor.

3. Drill to T. D., approximately 3100'; set & cement 4 1/2" casing on T. D.

4. Run cased hole logs.

5. Perforate, acidise and fracture treat.

6. Run 2-3/8" tubing, rods & bottom hole pump; install pumping equipment & place well on production.

IN ABOVE SPACE DESCRIBE PROPOSED PROGRAM: If proposal is to deepen or plug back, give data on present productive zone and proposed new productive zone. If proposal is to drill or deepen directionally, give pertinent data on subsurface locations and measured and true vertical depths. Give blowout preventer program, if any.

24.

Original Signed by Jerry E. Buckles TITLE Area Supervisor DATE June 2, 1978
SIGNED _____

(This space for Federal or State office use)

PERMIT NO. _____ APPROVAL DATE _____

APPROVED BY _____ TITLE _____ DATE _____
CONDITIONS OF APPROVAL, IF ANY:

*See Instructions On Reverse Side

Instructions

General: This form is designed for submitting proposals to perform certain well operations, as indicated, on all types of lands and leases for appropriate action by either a Federal or a State agency, or both, pursuant to applicable Federal and/or State laws and regulations. Any necessary special instructions concerning the use of this form and the number of copies to be submitted, particularly with regard to local, area, or regional procedures and practices, either are shown below or will be issued by, or may be obtained from, the local Federal and/or State office.

Item 1: If the proposal is to redrill to the same reservoir at a different subsurface location or to a new reservoir, use this form with appropriate notations. Consult applicable State or Federal regulations concerning subsequent work proposals or reports on the well.

Item 4: If there are no applicable State requirements, locations on Federal or Indian land should be described in accordance with Federal requirements. Consult local State or Federal office for specific instructions.

Item 14: Needed only when location of well cannot readily be found by road from the land or lease description. A plat, or plats, separate or on this reverse side, showing the roads to, and the surveyed location of, the well, and any other required information, should be furnished when required by Federal or State agency offices.

Items 15 and 18: If well is to be, or has been directionally drilled, give distances for subsurface location of hole in any present or objective production zone.

Item 22: Consult applicable Federal or State regulations, or appropriate officials, concerning approval of the proposal before operations are started.



NMOCC COPY
United States Department of the Interior

GEOLOGICAL SURVEY
P. O. Drawer U
Artesia, New Mexico 88210

September 5, 1978

Anadarko Production Company
Attention: Mr. Jerry E. Buckles
P. O. Box 67
Loco Hills, New Mexico 88255

Anadarko Production Company Ballard GBSA Unit - Tr. 5 - Well No. 14 990 FSL 1310 FEL Sec. 8, T18S, R29E Eddy County Lease No. LC-050906
--

Above Data Required on Well Sign

Gentlemen:

Your APPLICATION FOR PERMIT TO DRILL the above-described well to a depth of 3,100 feet to test the Grayburg formation is hereby approved subject to compliance with the OIL AND GAS OPERATING REGULATIONS (30 CFR 221) and the following conditions:

1. Drilling operations authorized are subject to compliance with the GENERAL REQUIREMENTS FOR OIL AND GAS OPERATIONS ON FEDERAL LEASES, dated July 1, 1978.
2. Prior to commencing construction of road, pad, or other associated developments, operator will provide the dirt contractor with a copy of the SURFACE USE PLAN and his approval including the GENERAL REQUIREMENTS.
3. Submit a Daily Report of Operations from spud date until the Well Completion Report (form 9-330) is filed. The progress report should be not less than 8" x 5" in size and each page should identify the well.
4. All above-ground structures and equipment shall be painted in accordance with the attached Painting Requirements. The color used should simulate sandstone brown (Federal Standard Color #595A, color 20318 or 30318).

Sincerely yours,

(Orig. Sgd.) ALBERT R. STALL

Albert R. Stall
Acting District Engineer

WELL LOCATION AND ACREAGE DESIGNATION PLAT

Supersedes G-100
Effective 1-1-70

Operator AM-DARKO PRODUCTION COMPANY		Lease Grayburg-San Andres Unit Tract 3		Well No. 14
Unit Design "2"	Section 6	Township 10 South	Range 29 East	County El Paso
Actual Postage Location of Well: 990 feet from the South line and 120 feet from the East line				
Ground Surface Elev. 3501.0	Producing Formation Grayburg-Jackson	Pool Loco Hills Queen Grayburg San Andres	Dedicated Acreage 40	

1. Outline the acreage dedicated to the subject well by colored pencil or hatchure marks on the plat below.
2. If more than one lease is dedicated to the well, outline each and identify the ownership thereof (both as to working interest and royalty).
3. If more than one lease of different ownership is dedicated to the well, have the interests of all owners been consolidated by communitization, unitization, force-pooling, etc?

RECEIVED

JUN 8 1978

**U.S. GEOLOGICAL SURVEY
ARTESIA, NEW MEXICO**

☒ Yes ☐ No If answer is "yes," type of consolidation **Unitization**

If answer is "no," list the owners and tract descriptions which have actually been consolidated. (Use reverse side of this form if necessary.)

No allowable well be assigned to the well until all interests have been consolidated (by communitization, unitization, force-pooling, or otherwise) or until a non-standard unit, eliminating such interests, has been approved by the Commission.

CERTIFICATION

I hereby certify that the information contained herein is true and complete to the best of my knowledge and belief.

Jerry E. Buckles
Name

Jerry E. Buckles

Position

Area Supervisor

Company

AM-DARKO PRODUCTION CO.

Date

May 23, 1978

I hereby certify that the well location shown on this plat was plotted from the notes of actual surveys made by me or under my supervision, and that the same is true and correct to the best of my knowledge and belief.

Date Surveyed

May 22, 1978

Registered Professional Engineer and/or Land Surveyor

Herschel L. Jones
Signature

3640

3500 3000 2500 2000 1500 1000 500 0

This data sheet is to be filled out in reference to the attached "Application for Permit to Drill" and is to be filed with the attached "Application for Permit to Drill" and is to be filed with the attached "Application for Permit to Drill".

Ballard Grayburg San Andres Unit, Tract No. 5, Well No. 14

1. Location: 990' FSL & 1310' FEL Sec. 8, T-18S, R-29E, Eddy County, New Mexico
2. Elevation: 3501.0 G. L.
3. Geological Name of Surface Formation: Triassic - Doakum (Santa Rosa)
4. Type of Drilling Tools to be Utilized: Rotary Tools
5. Proposed Drilling Depth: 3100'
6. Tops of Important Geological Markers:

T. Salt	350'	7-Rivers	1390'
B. Salt	780'	Queen	1935'
Tansill	835'	Grayburg	2260'
Yates	920'	San Andres	2675'
7. Estimated Depth of Anticipated Water, Oil or Gas:

Oil - 2480' - 2675', 2925' - 3050'
8. Casing Program:

7-5/8" - 26.40#, N-80, Cond. B
4-1/2" - 10.50#, K-55, New
9. Setting Depth of Casing:

7-5/8" - 350' - 150 sx Class H w/2% CaCL
4-1/2" - 3100' - 250 sx Class H w/.2 of 1% CFR-2, 5# Salt, 10# sand/sx
10. Specifications for Pressure Control Equipment (See Attached Schematic):

WEK Drilling Rig #3 is equipped with Shaffer Type E 10" Series 900 BOP with 4" Blind Rams, kill line and choke manifold. Koomey Hydraulic Controls and Accumulator with remote controls. When nipping up, test BOP and Choke to 1500 psi. Operate BOP equipment once a day, or as directed by Company Representative.
11. Mud Program:

Drill with Fresh Water Native Mud to within 200' of T. D. Jell will be added at this point to increase viscosity and clean hole prior to running casing.
12. Testing, Logging & Coring Program:
 - a. Testing: No drill stem tests will be made.
 - b. Coring: No coring planned.
 - c. Logging: Run Gamma Ray/Compensated Neutron Log after 4 1/2" pipe is set.
13. Potential Hazards:

None are expected. Above described BOP should take care of any blowout problems. Numerous wells have been drilled in this area without problems.
14. Anticipated Starting Date & Duration:

Plan to begin drilling operations approximately Oct. or Nov. 1978 (possibly earlier if Permits are approved promptly).
Approximately 10 days required to drill well and 2 weeks for completion.
15. Other Facets:

There is a chance that W E K Rig #2 will drill this well; it is equipped with similar Pressure Control Equipment. The rig layout might be slightly different.

Anadarko
PRODUCTION COMPANY

A
Panhandle
Eastern
Company

P. O. Box 67 • Loco Hills, New Mexico 88255 • (505) 677-2411

June 5, 1978

United States Geological Survey
P. O. Drawer U
Artesia, New Mexico 88210

Gentlemen:

Following is the "Surface Use and Operation Plan" for the drilling of Anadarko Production Company's Ballard Grayburg San Andres Unit Tract No. 5 Well No. 14 located 990' FSL & 1310' FEL Section 8, T-18S, R-29E, Eddy County, New Mexico

1. Existing Roads - A small scale map is attached (Exhibit #1). It shows the location of this well in relation to Loco Hills, New Mexico, Town-site.

A larger scale map (Exhibit #2) shows State Highway #360 and County Road #139 in blue. The existing caliche lease roads are shown in orange.

2. Planned Access Roads - An old sandy road just East of this location now exists. It was used to drill the Nos. 1 & 11 wells on this Tract #5. This road will need to be resurfaced & extended West approximately 300'. The existing road to be resurfaced is shown as a dashed green line on Exhibit #2. That portion to be built as the West extension is shown as a solid green line on Exhibit #2. There will be no fence to cut or cattle guard to set.

3. Location of Existing Wells - All existing wells on lease are indicated on enclosed map. There are no exploratory wells being drilled within a two mile radius.

4. Location of Tank Batteries, Production Facilities and Lines - There is a central tank battery located on the Ballard Unit located in the SW/4 of NW/4 of Section 8, T-18S, R-29E. All production on the Ballard Unit is piped to this central tank battery. Existing Lease Lines to central tank battery shown in solid blue; proposed line to location in dashed blue on Exhibit #2.

5. Location & Type of Water Supply - Fresh water to be used at drilling site will be supplied by I & W Trucking Company of Loco Hills and will be hauled from our Ballard Unit Water Plant and from Double Eagle Water Company taps in the Loco Hills Area.

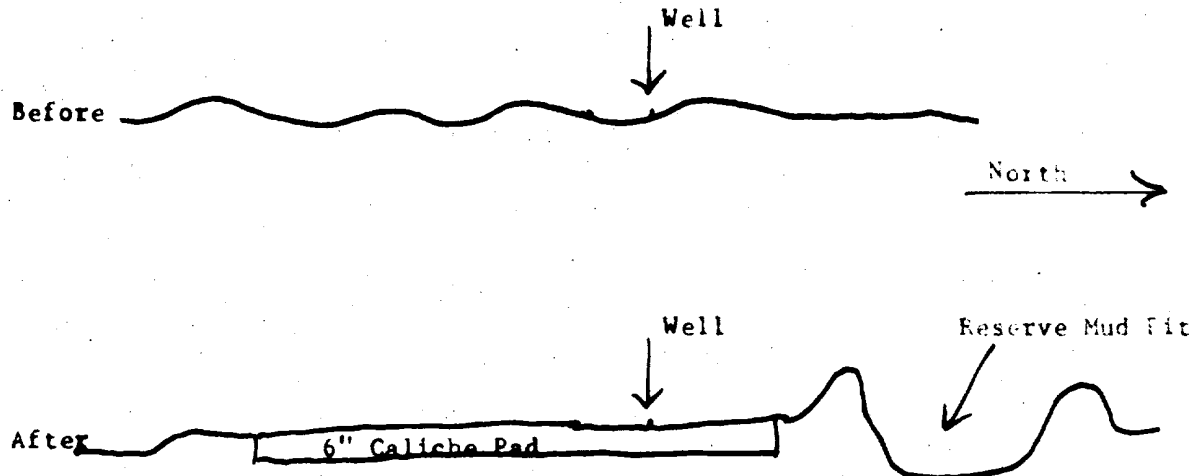
6. Source of Construction Material - Primary source of caliche will be the reserve pit area of the new drilling location. Alternate source will be an existing caliche pit (Exhibit #2 - marked in green) owned by Anadarko located in the NW/4 of Section 9, T-18S, R-29E.

7. Methods for Handling Waste Disposal - Enclosed drill site plat (Exhibit #4) indicates location of drilling pits, reserve pit and rubbish pit. After sufficient time has elapsed to allow drilling fluids to dry, all pits will be closed and leveled. The rubbish pit adjacent to drilling site will be deep enough to contain all rubbish when covered and leveled.

8. Ancillary Facilities - There are no camps or airstrips planned.

9. Well Site Layout - Well site (Exhibit #4) has been staked and is indicated by red area on enclosed maps (Exhibits #1 & #2). Drilling site is a sandy area covered by sparse native vegetation. Drilling pad will be 6" of caliche measuring 130' East, 120' West, 30' North & 110' South. Drilling pad will blend with terrain since the topography is relatively flat.

Cross Section - Before & After - is shown below:



10. Plans for Restoration of Surface - Commercial Well -

Reshaped Topography - Rubbish will be buried upon completion of drilling operations. All future trash will be removed by the individual generating same.

Caliche Pad - Caliche drilling pad will remain intact until well is abandoned.

Road - Road will remain intact as long as there are producing wells in this area.

Timetable - The well should produce for several years.

Plans for Restoration of Surface - Plugged and Abandoned Well -

Surface will be restored in accordance with all regulations in effect at the time of abandonment.

11. Other Information - Topography is generally flat, surrounded by small sand dunes.

Soil Characteristics - Unconsolidated sand.

Flora - Sparse grass and weeds.

Fauna - Rabbits, rats, mice, birds and snakes.

Other Surface Use Activities - Leased grazing land.

Surface Ownership - Federal Land.

Water Wells - None.

Lakes, Streams and Ponds - There is a rancher's water tank located approximately 1/4 mile South of this location.

Dwellings - None.

Other Facilities - None.

Archaeological Sites - None.

Historical Sites - None.

Cultural Sites - None.

12. Operator's Representative - Ozie W. Farris, Field Foreman for Adarko Production Company.

- Office Phone - 677-2411
- Home Phone - 677-3230

13. Certification - I hereby certify that I, or persons under my direct supervision, have inspected the proposed drilling site and access route; that I am familiar with the conditions which presently exist; that the statements made in this plan are, to the best of my knowledge, true and correct; and, that the work associated with the operations proposed herein will be performed by Sweatt Construction Company or Jabo Rowland Construction Company and its contractors and sub-contractors in conformity with this plan and the terms and conditions under which it is approved.

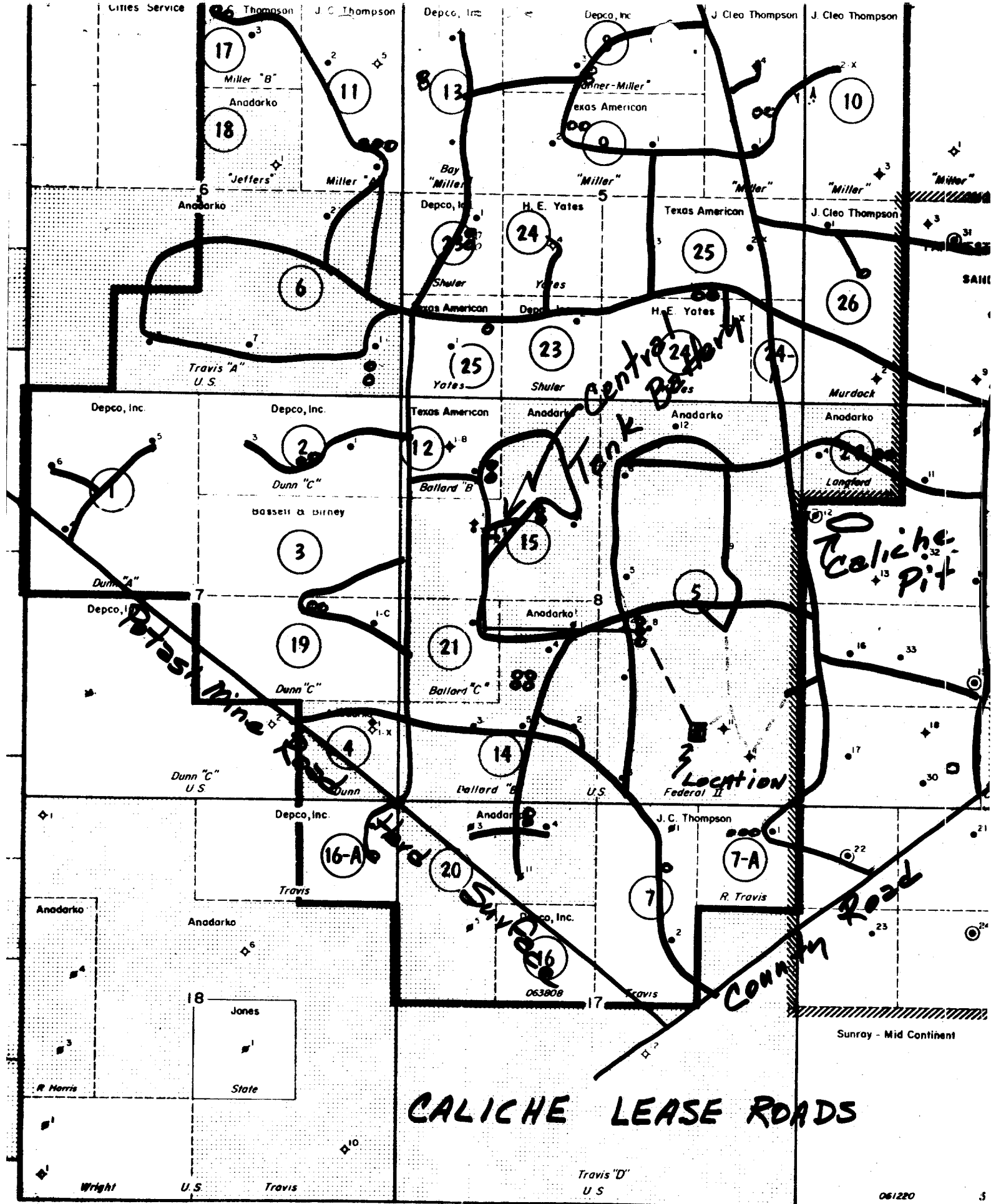
June 5, 1978
Date


Jerry E. Buckles

Area Supervisor
Title

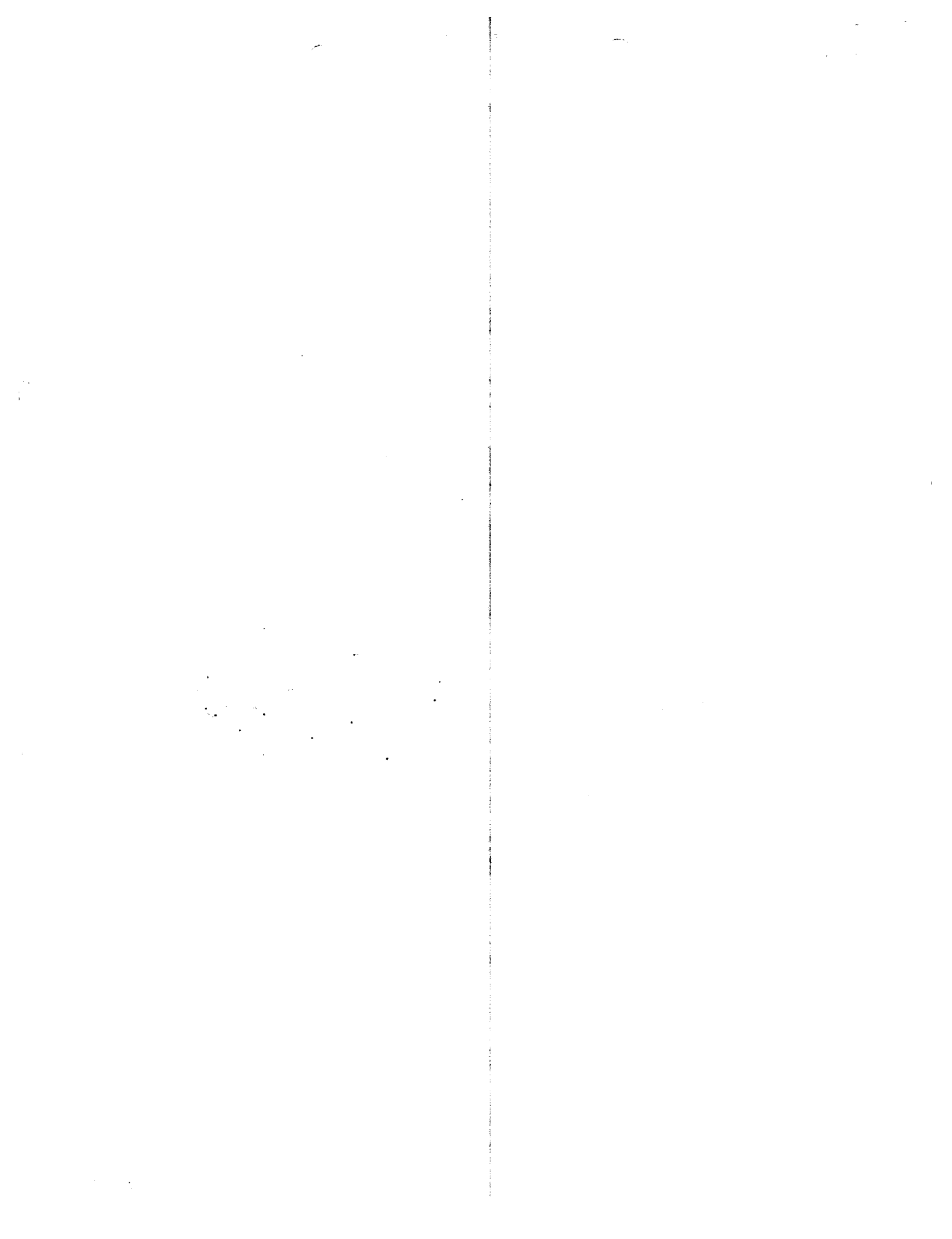


Exhibit #1

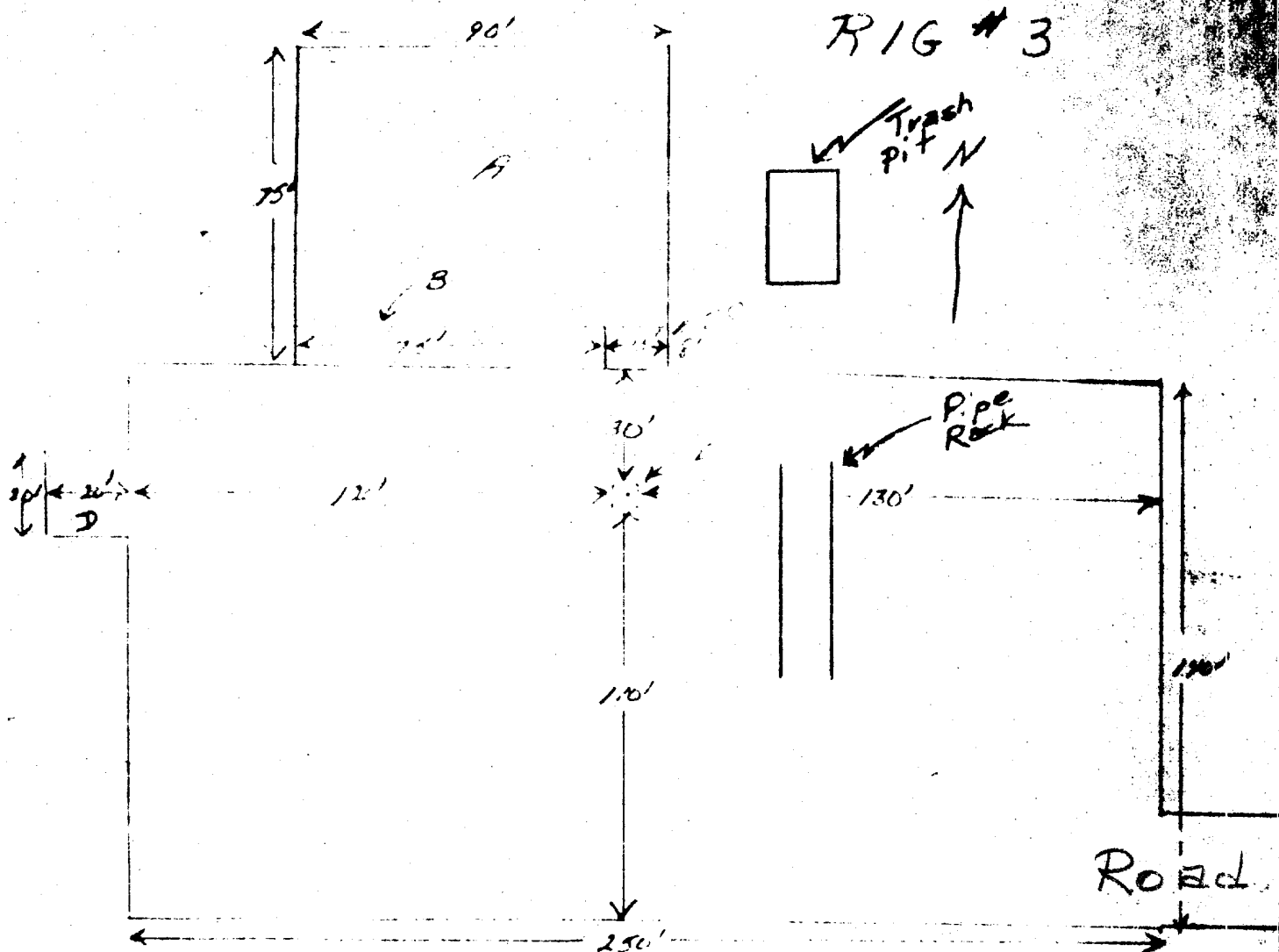


R 29 E

Exhibit # 2



PLAT FOR RIG #3



- A - RESERVE PIT D - STINGER
 B - MUD PIT E - CELLAR 5'x5'x5'
 C - SHAFT PIT

This rig equipped with Shaffer Type E 10" Series 900 BOP with 4" Blind Rams, kill line and choke manifold. Koomey Hydraulic Controls and Accumulator with remote controls.

ANADARKO PRODUCTION COMPANY
 BALLARD GRAYBURG SAN ANDRES UNIT
 Tract No. 5, Well No. 14

Exhibit

RECEIVED
JAN 11 1961
U.S. DEPARTMENT OF
THE ARMY
WASHINGTON, D.C.