

UNITED STATES  
DEPARTMENT OF THE INTERIOR

## GEOLOGICAL SURVEY

C/SF  
APPLICATION FOR PERMIT TO DRILL, DEEPEN, OR PLUG BACK

## 1a. TYPE OF WORK

DRILL ☐DEEPEN ☐PLUG BACK ☒

## b. TYPE OF WELL

OIL  
WELL ☐GAS  
WELL ☒

OTHER

SINGLE  
ZONE ☒MULTIPLE  
ZONE ☐

## 2. NAME OF OPERATOR

Yates Petroleum Corporation ✓

OCT 16 1981

## 3. ADDRESS OF OPERATOR

207 South 4th St., Artesia, NM 88210

O. C. D.

## 4. LOCATION OF WELL (Report location clearly and in accordance with any State requirement)

At surface

1980' FSL &amp; 1980' FWL, Sec. 13-18S-24E

At proposed prod. zone

## 14. DISTANCE IN MILES AND DIRECTION FROM NEAREST TOWN OR POST OFFICE\*

## 15. DISTANCE FROM PROPOSED\*

LOCATION TO NEAREST  
PROPERTY OR LEASE LINE, FT.  
(Also to nearest drg. unit line, if any)

## 16. NO. OF ACRES IN LEASE

-

17. NO. OF ACRES ASSIGNED  
TO THIS WELL

320

18. DISTANCE FROM PROPOSED LOCATION\*  
TO NEAREST WELL, DRILLING, COMPLETED,  
OR APPLIED FOR, ON THIS LEASE, FT.

## 19. PROPOSED DEPTH

-

## 20. ROTARY OR CABLE TOOLS

Pulling Unit

## 21. ELEVATIONS (Show whether DF, RT, GR, etc.)

3679' KB

## 22. APPROX. DATE WORK WILL START\*

Soon as approved

## 23.

## PROPOSED CASING AND CEMENTING PROGRAM

SIZE OF HOLE	SIZE OF CASING	WEIGHT PER FOOT	SETTING DEPTH	QUANTITY OF CEMENT
17-1/2"	13-3/8"	54.5#	320'	325
12-1/4"	8-5/8"	24#	1014'	600
7-7/8"	4-1/2"	11.6 & 10.5#	8402'	1425

Well is depleted in present Atoka perforations 8148-58'. We propose to set a CIBP at about 8120' w/ ~~50'~~ cement on top and perforate the Lower Canyon intervals 7325-35, 7443-47' and 7526-31' and to stimulate as needed for production.

CIBP shall be cased w/ 50' cement

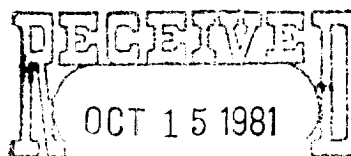
OIL & GAS  
U.S. GEOLOGICAL SURVEY  
ROSWell, NEW MEXICO

IN ABOVE SPACE DESCRIBE PROPOSED PROGRAM: If proposal is to deepen or plug back, give data on present productive zone and proposed new productive zone. If proposal is to drill or deepen directionally, give pertinent data on subsurface locations and measured and true vertical depths. Give blowout preventer program, if any.

## 24.

SIGNED

TITLE

Engineering Secretary

DATE

10-13-81

(This space for Federal or State office use)

PERMIT NO.

APPROVAL DATE

APPROVED BY

TITLE

CONDITIONS OF APPROVAL, IF ANY:

APPROVED AS AMENDED

OCT 51 1981

JAMES A. GILLHAM  
DISTRICT SUPERVISOR

\*See Instructions On Reverse Side

## OIL CONSERVATION DIVISION

STATE OF NEW MEXICO  
ENERGY AND MINERALS DEPARTMENTP. O. BOX 2088  
SANTA FE, NEW MEXICO 87501Form C-102  
Revised 10-1-78

All distances must be from the outer boundaries of the Section.

Operator <b>Yates Petroleum Corp</b>		Lense <b>Spearman KQ Federal Perm</b>		Well No. <b>1</b>	
Section Letter <b>K</b>	Section <b>13</b>	Township <b>18-S</b>	Range <b>24-E</b>	County <b>Eddy</b>	
About Footage Location of Well: <b>1980</b> feet from the <b>South</b> line and <b>1980</b> feet from the <b>West</b> line					
Ground Level Elev. <b>3667</b>	Producing Formation <b>Lower Canyon</b>		Pool <b>Penasco Draw Rome Penn</b>		Dedicated Acreage: <b>320</b> Acres

- Outline the acreage dedicated to the subject well by colored pencil or hatchure marks on the plat below.
- If more than one lense is dedicated to the well, outline each and identify the ownership thereof (both as to working interest and royalty).
- If more than one lense of different ownership is dedicated to the well, have the interests of all owners been consolidated by communitization, unitization, force-pooling, etc?

☒ Yes ☐ No If answer is "yes," type of consolidation Communitization

If answer is "no," list the owners and tract descriptions which have actually been consolidated. (Use reverse side of this form if necessary.) \_\_\_\_\_

No allowable will be assigned to the well until all interests have been consolidated (by communitization, unitization, forced-pooling, or otherwise) or until a non-standard unit, eliminating such interests, has been approved by the Division.

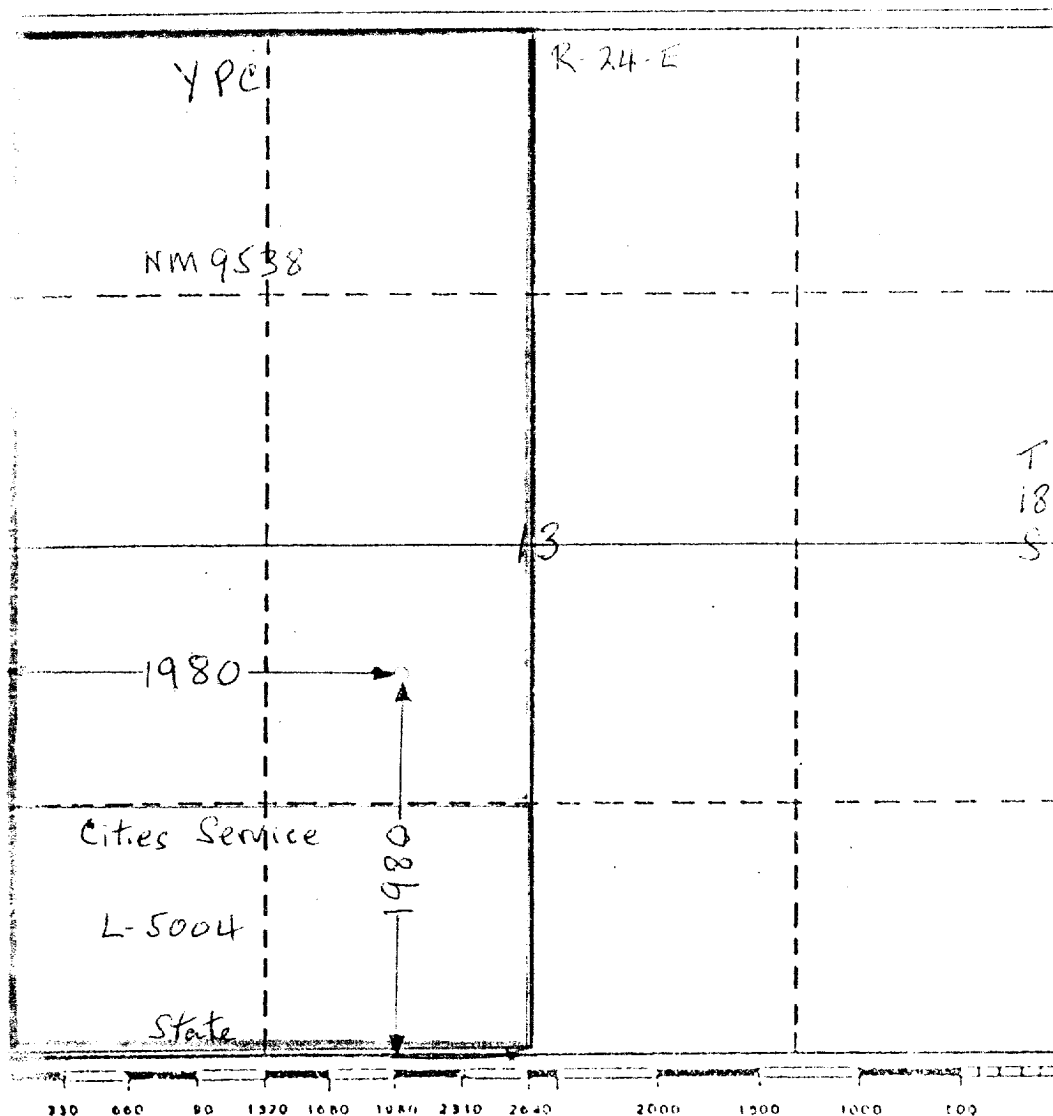

## CERTIFICATION

I hereby certify that the information contained herein is true and complete to the best of my knowledge and belief.

Eddie M. Mahfood  
Name  
Eddie M Mahfood

Position  
Engineer

Company  
Yates Petroleum Corp

Date  
10-13-81

I hereby certify that the well location shown on this plat was plotted from field notes of actual surveys made by me or under my supervision, and that the same is true and correct to the best of my knowledge and belief.

Refer to Original Plat  
Date Surveyed

Registered Professional Engineer  
or Var Land Surveyor

Certificate No.