

NO. OF COPIES RECEIVED	5
DISTRIBUTION	
SANTA FE	1
FILE	1
U.S.G.S.	2
LAND OFFICE	
OPERATOR	1

NEW MEXICO OIL CONSERVATION COMMISSION

RECEIVED

MAR 28 1979

*Amended Application* O. C. C.  
ARTESIA, OFFICE

30-015-22870  
Form C-101  
Revised 1-1-65

5A. Indicate Type of Lease	
STATE <input type="checkbox"/>	FEE <input checked="" type="checkbox"/>

5. State Oil & Gas Lease No.
------------------------------

APPLICATION FOR PERMIT TO DRILL, DEEPEN, OR PLUG BACK

1a. Type of Work		7. Unit Agreement Name	
b. Type of Well OIL WELL <input checked="" type="checkbox"/> GAS WELL <input type="checkbox"/> OTHER <input type="checkbox"/>		8. Farm or Lease Name Wright JA	
2. Name of Operator Yates Petroleum Corporation ✓		9. Well No. 4	
3. Address of Operator 207 South 4th Street - Artesia, NM 88210		10. Field and Pool, or Wildcat X Und. Dayton Abo	
4. Location of Well UNIT LETTER F LOCATED 1650 FEET FROM THE North LINE AND 1650 FEET FROM THE West LINE OF SEC. 34 TWP. 18S RGE. 26E NMPM		11. County Eddy	
21. Elevations (Show whether DF, RT, etc.) 3361'		22. Approx. Date Work will start - As soon as approved	
21A. Kind & Status Plug. Bond Blanket		21B. Drilling Contractor La Rue & Muncy	
12. Proposed Depth Possible 5700'		19A. Formation Abo	
20. Rotary or C.T. Rotary			

PROPOSED CASING AND CEMENT PROGRAM

SIZE OF HOLE	SIZE OF CASING	WEIGHT PER FOOT	SETTING DEPTH	SACKS OF CEMENT	EST. TOP
9-5/8"	7"	20#	Approx 1120'	550 sx	Circulate
6 1/4"	4 1/2"	10.5#	" TD	75 sx	

We propose to drill and test the Abo formation. Casing will be set at least 100' below the Artesian Water Zone and cemented to the surface. 4 1/2" production will be set w/500' of cement cover. If commercial, will perforate and stimulate for production.

Mud Program: FW Gel and LCM to 1120', fresh water to TD.

BOP Program: BOP's will be installed on the 7" casing and tested.

IN ABOVE SPACE DESCRIBE PROPOSED PROGRAM: IF PROPOSAL IS TO DEEPEN OR PLUG BACK, GIVE DATA ON PRESENT PRODUCTIVE ZONE AND PROPOSED NEW PRODUCTIVE ZONE. GIVE BLOWOUT PREVENTER PROGRAM, IF ANY.

I hereby certify that the information above is true and complete to the best of my knowledge and belief.

Signed Christine Tomlinson Title Geol. Secty. Date 3-27-79

(This space for State Use)

APPROVED BY W. A. Gressett TITLE SUPERVISOR, DISTRICT II DATE MAR 30 1979

CONDITIONS OF APPROVAL, IF ANY:

*additional cement behind 4 1/2"*

**NEW MEXICO OIL CONSERVATION COMMISSION**  
**WELL LOCATION AND ACREAGE DEDICATION PLAT**

Form C-102  
 Supersedes C-128  
 Effective 1-1-65

All distances must be from the outer boundaries of the Section.

Operator <b>Yates Petroleum Corporation</b>			Lease <b>Wright JA</b>		Well No. <b>4</b>
Unit Letter <b>F</b>	Section <b>34</b>	Township <b>18 South</b>	Range <b>26 East</b>	County <b>Eddy</b>	
Actual Footage Location of Well: <b>1650</b> feet from the <b>North</b> line and <b>1650</b> feet from the <b>West</b> line					
Ground Level Elev. <b>3361</b>	Producing Formation <b>Abo</b>		Pool <b>Und. Dayton Abo</b>		Dedicated Acreage: <b>40</b> Acres

1. Outline the acreage dedicated to the subject well by colored pencil or hachure marks on the plat below.
2. If more than one lease is dedicated to the well, outline each and identify the ownership thereof (both as to working interest and royalty).
3. If more than one lease of different ownership is dedicated to the well, have the interests of all owners been consolidated by communitization, unitization, force-pooling, etc?

☐ Yes    ☐ No    If answer is "yes," type of consolidation \_\_\_\_\_

If answer is "no," list the owners and tract descriptions which have actually been consolidated. (Use reverse side of this form if necessary.) \_\_\_\_\_

No allowable will be assigned to the well until all interests have been consolidated (by communitization, unitization, forced-pooling, or otherwise) or until a non-standard unit, eliminating such interests, has been approved by the Commission.

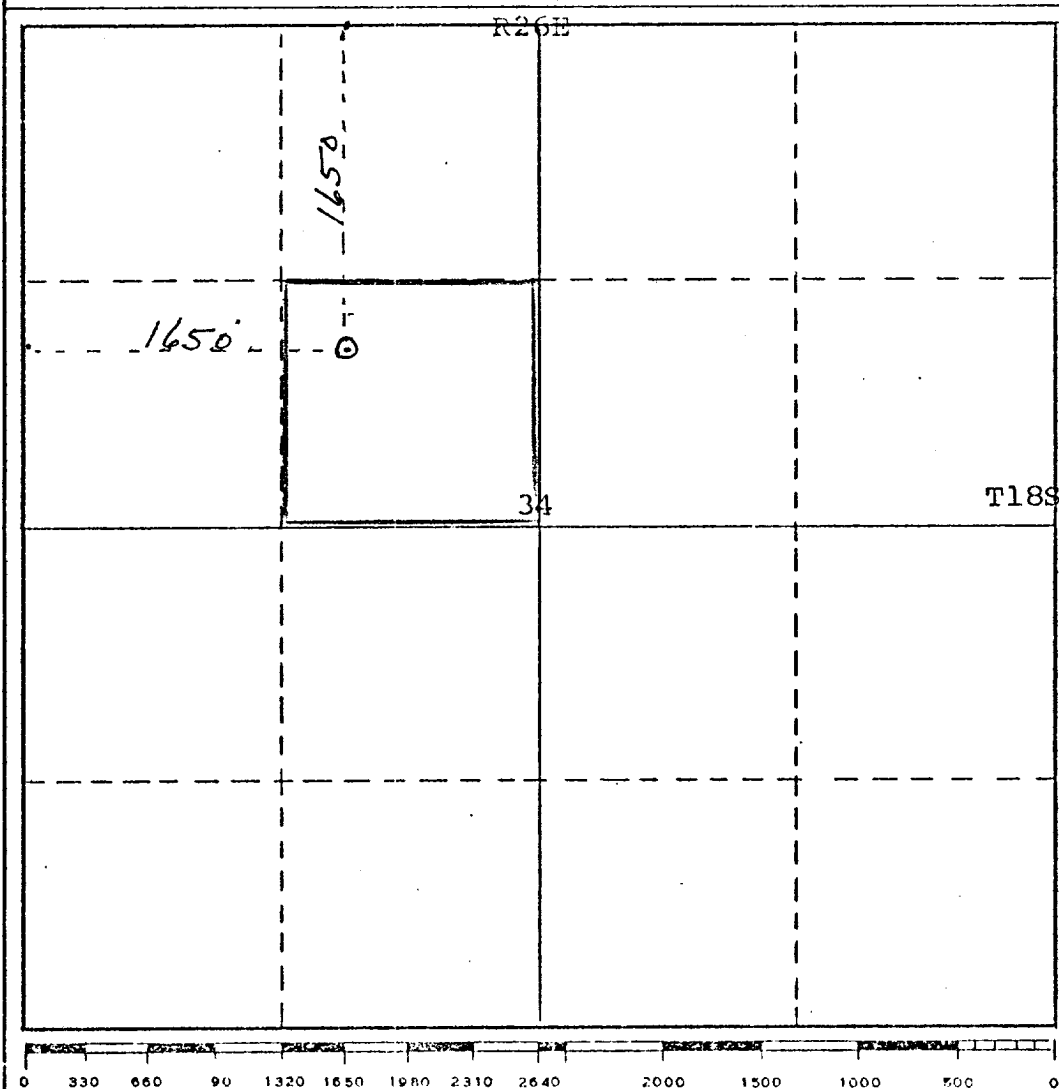

<b>CERTIFICATION</b>	
I hereby certify that the information contained herein is true and complete to the best of my knowledge and belief.	
<i>Eddie M. Mahfood et.</i> Name <b>Eddie M. Mahfood</b>	
Position <b>Engineer</b>	
Company <b>Yates Petroleum Corp.</b>	
Date <b>3-27-79</b>	
I hereby certify that the well location shown on this plat was plotted from field notes of actual surveys made by me or under my supervision, and that the same is true and correct to the best of my knowledge and belief.	
Refer to Original Plat	
Date Surveyed <b>3-8-79</b>	
Registered Professional Engineer and/or Land Surveyor	
Certificate No.	