

NO. OF COPIES RECEIVED		
DISTRIBUTION		
SANTA FE		1
FILE		1
U.S.G.S.		
LAND OFFICE		
TRANSPORTER	OIL	1
	GAS	
OPERATOR		1
PRORATION OFFICE		

NEW MEXICO OIL CONSERVATION COMMISSION  
REQUEST FOR ALLOWABLE  
AND  
AUTHORIZATION TO TRANSPORT OIL AND NATURAL GAS

Form C-104  
Supersedes Old C-104 and C-111  
Effective 1-1-65

RECEIVED  
SEP 18 1979

O. C. C.  
ARTESIA OFFICE

Operator MONSANTO COMPANY	
Address 1330 Midland NBT, Midland, Tx. 79701	
Reason(s) for filing (Check proper box)	Other (Please explain)
New Well <input checked="" type="checkbox"/>	Casinghead Gas MUST NOT BE FLARED AFTER 11-1-79 UNLESS AN EXCEPTION TO Rule 306 IS OBTAINED
Recompletion <input type="checkbox"/>	
Change in Ownership <input type="checkbox"/>	
Change in Transporter of: Oil <input type="checkbox"/> Dry Gas <input type="checkbox"/> Casinghead Gas <input type="checkbox"/> Condensate <input type="checkbox"/>	

If change of ownership give name  
and address of previous owner

Eq. # 2-340

II. DESCRIPTION OF WELL AND LEASE

Lease Name APEX STATE	Well No. 1	Pool Name, Including Formation ARTESIA QUEEN - G-S A	Kind of Lease State, Federal or Fee	State State	Lease No. L 2918
Location Unit Letter K ; 1980 Feet From The South Line and 1980 Feet From The West Line of Section 35 Township 18S Range 27E , NMPM, Eddy County					

III. DESIGNATION OF TRANSPORTER OF OIL AND NATURAL GAS

Name of Authorized Transporter of Oil <input checked="" type="checkbox"/> or Condensate <input type="checkbox"/> THE PERMIAN CORPORATION	Address (Give address to which approved copy of this form is to be sent) PO BOX 3119, Midland, Tx. 79702					
Name of Authorized Transporter of Casinghead Gas <input type="checkbox"/> or Dry Gas <input type="checkbox"/>	Address (Give address to which approved copy of this form is to be sent)					
If well produces oil or liquids, give location of tanks.	Unit K	Sec. 35	Twp. 18S	Rge. 27E	Is gas actually connected? -----	When -----

If this production is commingled with that from any other lease or pool, give commingling order number:

IV. COMPLETION DATA

Designate Type of Completion - (X)	Oil Well X	Gas Well	New Well X	Workover	Deepen	Plug Back	Same Res't.	Diff. Res't.
Date Spudded 5/19/79	Date Compl. Ready to Prod. 8/17/79	Total Depth 10,431	P.B.T.D. 2570					
Elevations (DF, RKB, RT, GR, etc.) GR 3502	Name of Producing Formation Queen	Top Oil/Gas Pay 1757	Tubing Depth 1924					
Perforations 1883-1877; 1766-1757			Depth Casing Shoe 2800					
TUBING, CASING, AND CEMENTING RECORD								
HOLE SIZE	CASING & TUBING SIZE	DEPTH SET	SACKS CEMENT					
17 1/2	13 3/8	366'	375					
12 1/4	9 5/8	2800'	1400					
9 5/8	2 7/8	1924						

V. TEST DATA AND REQUEST FOR ALLOWABLE OIL WELL (Test must be after recovery of total volume of load oil and must be equal to or exceed top allow able for this depth or be for full 24 hours)

Date First New Oil Run To Tanks 8/30/79	Date of Test 9/9/79	Producing Method (Flow, pump, gas lift, etc.) Pumping	
Length of Test 24 Hrs.	Tubing Pressure -----	Casing Pressure 15	Choke Size -----
Actual Prod. During Test	Oil-Bbls. 33	Water-Bbls. 15	Gas-MCF TSTM

GAS WELL

Actual Prod. Test-MCF/D	Length of Test	Bbls. Condensate/MMCF	Gravity of Condensate
Testing Method (pitot, back pr.)	Tubing Pressure (Shut-in)	Casing Pressure (Shut-in)	Choke Size

VI. CERTIFICATE OF COMPLIANCE

I hereby certify that the rules and regulations of the Oil Conservation Commission have been complied with and that the information given above is true and complete to the best of my knowledge and belief.

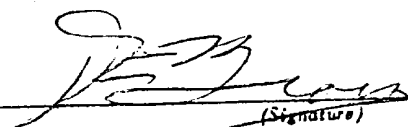
  
Regional Prod. Mgr.  
(Title)  
9/12/79  
(Date)

OIL CONSERVATION COMMISSION  
SEP 18 1979

APPROVED \_\_\_\_\_, 19\_\_\_\_  
BY   
SUPERVISOR, DISTRICT II  
TITLE \_\_\_\_\_

This form is to be filed in compliance with RULE 1104.  
If this is a request for allowable for a newly drilled or deepened well, this form must be accompanied by a tabulation of the deviate tests taken on the well in accordance with RULE 111.  
All sections of this form must be filled out completely for allowable on new and recompleted wells.  
Fill out only Sections I, II, III, and VI for changes of owner well name or number, or transporter, or other such change of condition

July  
Effect 1/79

NEW MEXICO OIL CONSERVATION COMMISSION  
LOCATION AND ACREAGE DEDICATION

All distances must be from the outer boundaries of the Section.

Operator <b>MONSANTO COMPANY</b>		Lease <b>Apex State</b>		County <b>Eddy</b>		Well No. <b>1</b>
Unit Letter <b>K</b>	Section <b>35</b>	Township <b>18 South</b>	Range <b>27 East</b>	Line <b>West</b>		Dedicated Acreage <b>200.40</b> Acres
Actual Footage Location of Well: <b>1980</b>		line and <b>South</b>		Pool <b>artesia Q-GS A</b>		feet from the
Ground Level Elev: <b>3501'</b>		Producing Formation <b>Queen</b>				

RECEIVED  
SEP 13 1979

D. E. Bro  
ARTESIA, OFFICE

1. Outline the acreage dedicated to the subject well by colored pencil or hatchure marks on the plat below.
  2. If more than one lease is dedicated to the well, outline each and identify the ownership thereof (both as to working interest and royalty).
  3. If more than one lease of different ownership is dedicated to the well, have the interests of all owners been consolidated by communitization, unitization, force-pooling, etc?  
☒ Yes ☐ No If answer is "yes," type of consolidation **communitization**
- If answer is "no," list the owners and tract descriptions which have actually been consolidated. (Use reverse this form if necessary.)  
No allowable will be assigned to the well until all interests have been consolidated (by communitization, unitization, force-pooling, or otherwise) or until a non-standard unit, eliminating such interests, has been approved by the Commission.

WORKING INTERESTS:  
Monsanto Company  
Southland Royalty  
DEPCO  
Husky  
Yates Petr.  
Yates Drilling  
Vilas P. Sheldon  
ROYALTY  
State 1/8

50.00%  
37.50%  
4.75%  
4.75%  
2.48%  
39%  
1.3%

GAS NOT DEDICATED

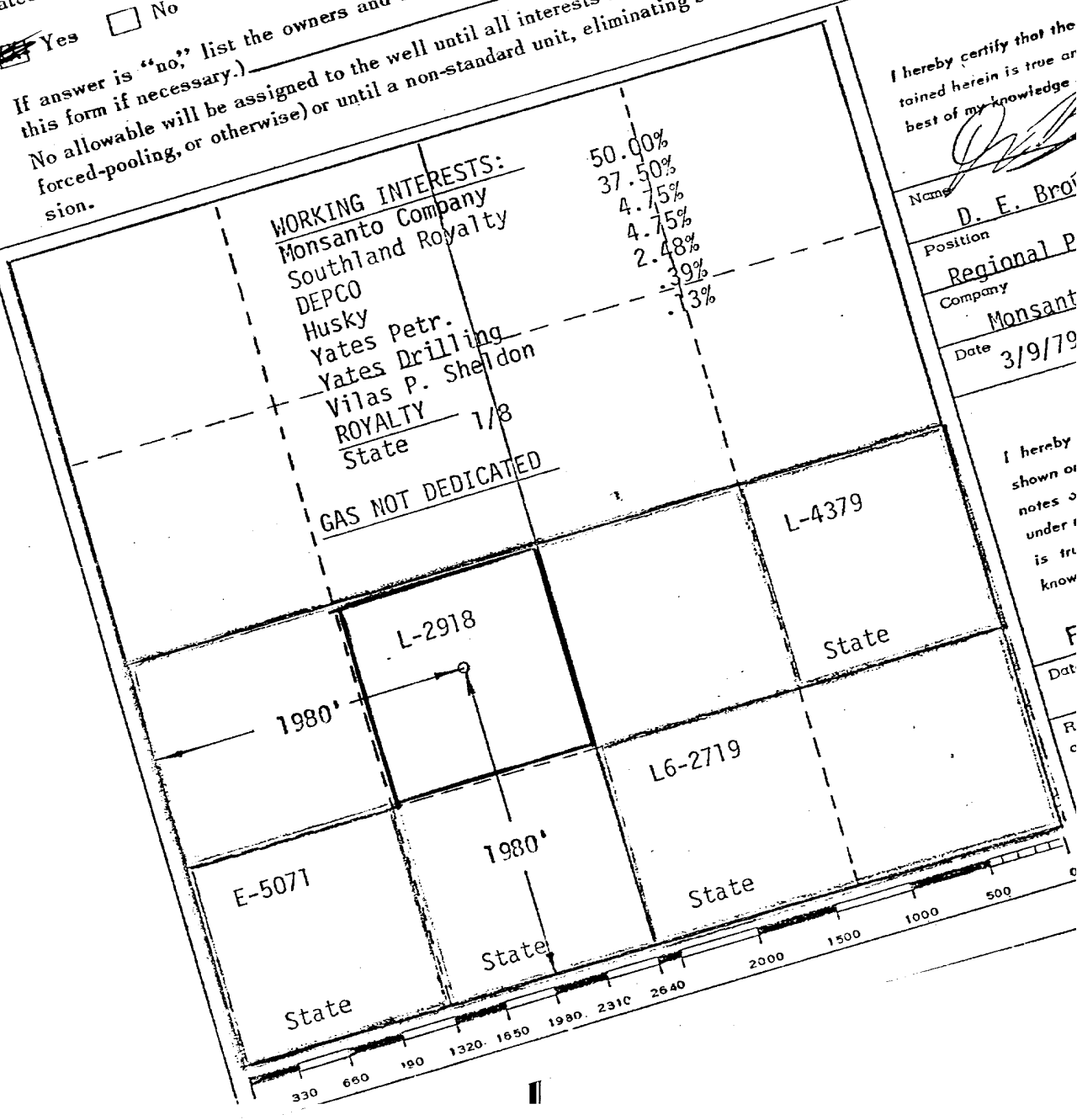

I hereby certify that the contained herein is true and best of my knowledge.

Name  
**D. E. Bro**  
Position  
**Regional P**  
Company  
**Monsant**  
Date  
**3/9/79**

I hereby shown or notes under is true know

F  
Dat

R  
c

ld  
or  
ome  
of my

en  
neer

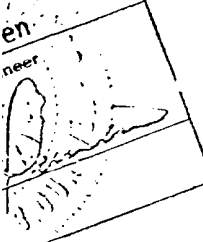

NEW MEXICO OIL CONSERVATION COMMISSION  
WE LOCATION AND ACREAGE DEDICATION AT

Form C-102  
Supersedes C-123  
Effective 1-1-65

All distances must be from the outer boundaries of the Section.

Operator <b>MONSANTO COMPANY</b>			Lease <b>Apex State</b> ✓		Well No. <b>1</b>
Unit Letter <b>K</b>	Section <b>35</b>	Township <b>18 South</b>	Range <b>27 East</b>	County <b>Eddy</b>	
Actual Footage Location of Well: <b>1980</b> feet from the <b>South</b> line and <b>1980</b> feet from the <b>West</b> line					
Ground Level Elev: <b>3501'</b>	Producing Formation <b>Quartz Monks</b>		Pool <b>artesia Q-GS A</b>	Dedicated Acreage: <b>288 4/10</b> Acres	

1. Outline the acreage dedicated to the subject well by colored pencil or hatchure marks on the plat below.
2. If more than one lease is dedicated to the well, outline each and identify the ownership thereof (both as to working interest and royalty).
3. If more than one lease of different ownership is dedicated to the well, have the interests of all owners been consolidated by communitization, unitization, force-pooling, etc?

**RECEIVED**

**SEP 13 1979**

**D. C. C.**  
**ARTESIA, OFFICE**

☒ Yes ☐ No If answer is "yes," type of consolidation communitization

If answer is "no," list the owners and tract descriptions which have actually been consolidated. (Use reverse side of this form if necessary.)  
No allowable will be assigned to the well until all interests have been consolidated (by communitization, unitization, forced-pooling, or otherwise) or until a non-standard unit, eliminating such interests, has been approved by the Commission.

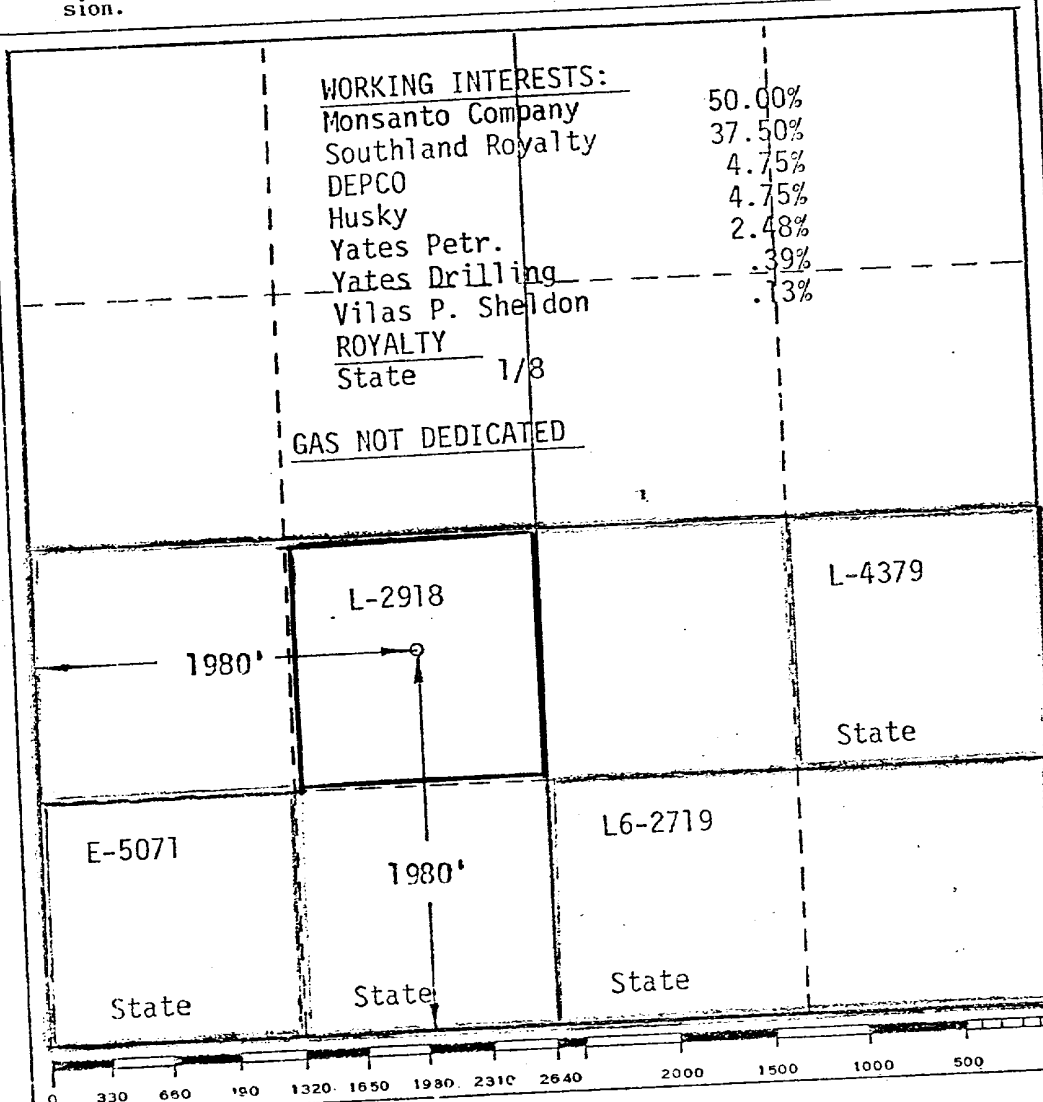

**CERTIFICATION**

I hereby certify that the information contained herein is true and complete to the best of my knowledge and belief.

Name

**D. E. Brown**

Position

**Regional Prod. Mgr.**

Company

**Monsanto Company**

Date

**3/9/79**

I hereby certify that the well location shown on this plat was plotted from field notes of actual surveys made by me or under my supervision, and that the same is true and correct to the best of my knowledge and belief.

**February 19, 1979**

Date Surveyed

**Richard B. Duniven**

Registered Professional Engineer  
and/or Land Surveyor

*Richard B. Duniven*

Certificate No.

**4882**

# Monsanto

RECEIVED

SEP 13 1979

O.C.C.  
ARTESIA, OFFICE

Monsanto Company  
1330 Midland National Bank Tower  
500 West Texas  
Midland, Texas 79701  
Phone: (915) 683-3306

September 12, 1979

New Mexico Oil Conservation Commission ✓  
PO Drawer DD  
Artesia, New Mexico 88210

RE; Apex State Com. Well No. 1 ✓  
1980' FSL & 1980' FWL  
Sec. 35, T-18S, R-27E  
Eddy County, New Mexico

Gentlemen:

The following is a tabulation of the deviation tests conducted while drilling our above captioned well, which has been completed in the Queen.

<u>Footage</u>	<u>(Deg.) Deviation from the Vertical</u>
212	1/4
366	1/2
860	3/4
1169	3/4
1642	1
2143	1
2645	1 1/4
2800	1 1/4
3100	3/4
3400	3/4
3700	3/4
4000	1 1/2
4250	1 1/4
4556	1
4950	1
5452	1 1/4
5750	1 1/4
6100	1 3/4
6593	2
7085	3/4
7660	3/4
8160	3/4
8220	3/4
8720	3/4
9097	1
9518	1 1/4
9993	1
10,430	1 1/4