

RECEIVED!

SUBMIT IN T I CATE\*

Form approved.  
Budget Bureau No. 42-R1425.UNITED STATES  
DEPARTMENT OF THE INTERIOR  
GEOLOGICAL SURVEY

30-015-23230

## APPLICATION FOR PERMIT TO DRILL, DEEPEN, OR PLUG BACK

## 1a. TYPE OF WORK

DRILL ☒DEEPEN ☐PLUG BACK ☐

## b. TYPE OF WELL

OIL  
WELL ☒GAS  
WELL ☐

OTHER

SINGLE  
ZONE ☒MULTIPLE  
ZONE ☐

## 2. NAME OF OPERATOR

WILLIAM A. &amp; EDWARD R. HUDSON

MAR 19 1980

## 3. ADDRESS OF OPERATOR

Box #198, Artesia, New Mexico 88210

O. C. D.

## 4. LOCATION OF WELL (Report location clearly and in accordance with any State requirements.)

At surface

2615' from south and 1345' from east lines of  
Section 25-17S-31E.

At proposed prod. zone

## 14. DISTANCE IN MILES AND DIRECTION FROM NEAREST TOWN OR POST OFFICE\*

5 miles SW of Maljamar, New Mexico

## 15. DISTANCE FROM PROPOSED\*

LOCATION TO NEAREST  
PROPERTY OR LEASE LINE, FT.  
(Also to nearest drig. unit line, if any)

1345'

## 16. NO. OF ACRES IN LEASE

800

17. NO. OF ACRES ASSIGNED  
TO THIS WELL

## 18. DISTANCE FROM PROPOSED LOCATION\*

TO NEAREST WELL, DRILLING, COMPLETED,  
OR APPLIED FOR, ON THIS LEASE, FT.

970'

## 19. PROPOSED DEPTH

3975'

## 20. ROTARY OR CABLE TOOLS

Rotary

## 21. ELEVATIONS (Show whether DF, RT, GR, etc.)

3876 Gr.

## 22. APPROX. DATE WORK WILL START\*

March 15, 1980

## 23.

## PROPOSED CASING AND CEMENTING PROGRAM

SIZE OF HOLE	SIZE OF CASING	WEIGHT PER FOOT	SETTING DEPTH	QUANTITY OF CEMENT
12-1/4"	8-5/8 - J-55	24#	750'	450
7-7/8"	5 1/2 - J-55	15.5#	3975'	550

It is proposed to drill this well with rotary tools to a depth of approximately 3975'. Production string will be cemented near bottom and pays will be perforated and treated with acid and frac. All casing will be new. See attachment for other data.

IN ABOVE SPACE DESCRIBE PROPOSED PROGRAM: If proposal is to deepen or plug back, give data on present productive zone and proposed new productive zone. If proposal is to drill or deepen directionally, give pertinent data on subsurface locations and measured and true vertical depths. Give blowout preventer program, if any.

24.

SIGNED



TITLE

Consultant

DATE

Jan. 17, 1980

(This space for Federal or State office use)

PERMIT NO.

APPROVAL DATE

3-18-80

APPROVED BY

TITLE

DATE

CONDITIONS OF APPROVAL, IF ANY:

\*See Instructions On Reverse Side

## Instructions

**General:** This form is designed for submitting proposals to perform certain well operations, as indicated, on all types of lands and leases for appropriate action by either a Federal or a State agency, or both, pursuant to applicable Federal and/or State laws and regulations. Any necessary special instructions concerning the use of this form and the number of copies to be submitted, particularly with regard to local, area, or regional procedures and practices, either are shown below or will be issued by, or may be obtained from, the local Federal and/or State office.

**Item 1:** If the proposal is to redrill to the same reservoir at a different subsurface location or to a new reservoir, use this form with appropriate notations. Consult applicable State or Federal regulations concerning subsequent work proposals or reports on the well.

**Item 4:** If there are no applicable State requirements, locations on Federal or Indian land should be described in accordance with Federal requirements. Consult local State or Federal office for specific instructions.

**Item 14:** Needed only when location of well cannot readily be found by road from the land or lease description. A plat, or plats, separate or on this reverse side, showing the roads to, and the surveyed location of, the well, and any other required information, should be furnished when required by Federal or State agency offices.

**Items 15 and 18:** If well is to be, or has been directionally drilled, give distances for subsurface location of hole in any present or objective production zone.

**Item 22:** Consult applicable Federal or State regulations, or appropriate officials, concerning approval of the proposal before operations are started.

**MEXICO OIL CONSERVATION COMMISSION**  
**WELL LOCATION AND ACREAGE DEDICATION PLAT**

Form C-102  
 Supersedes C-128  
 Effective 1-1-65

**REVISED!**

All distances must be from the outer boundaries of the Section

Operator <b>W.A. &amp; Ed R. Hudson</b>			Lease <b>Puckett "B"</b>		Well No. <b>28</b>
Unit Letter <b>J</b>	Section <b>25</b>	Township <b>17 South</b>	Range <b>31 East</b>	County <b>Eddy</b>	
Actual Footage Location of Well: <b>2615</b> feet from the <b>South</b> line and <b>1345</b> feet from the <b>East</b> line					
Ground Level Elev. <b>3875.8</b>	Producing Formation <b>Grayburg-San Andres</b>	Pool <b>Maljamar (G-SA)</b>		Dedicated Acreage <b>Acres</b>	

1. Outline the acreage dedicated to the subject well by colored pencil or hatchure marks on the plat below.
2. If more than one lease is dedicated to the well, outline each and identify the ownership thereof (both as to working interest and royalty).
3. If more than one lease of different ownership is dedicated to the well, have the interests of all owners been consolidated by communitization, unitization, force-pooling, etc?

☐ Yes ☐ No If answer is "yes," type of consolidation \_\_\_\_\_

If answer is "no," list the owners and tract descriptions which have actually been consolidated. (Use reverse side of this form if necessary.) \_\_\_\_\_

No allowable will be assigned to the well until all interests have been consolidated (by communitization, unitization, forced-pooling, or otherwise) or until a non-standard unit, eliminating such interests, has been approved by the Commission.

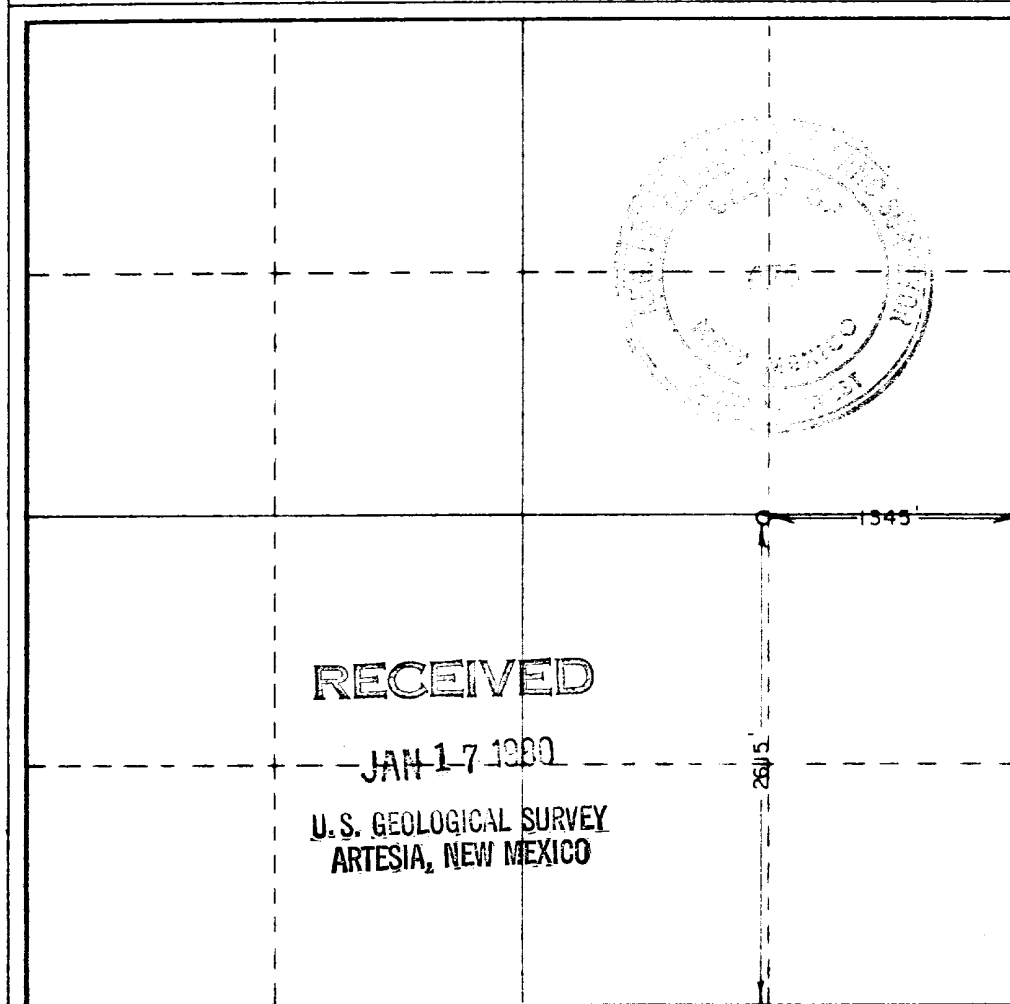

**CERTIFICATION**

I hereby certify that the information contained herein is true and complete to the best of my knowledge and belief.

Name *Ralph L. Gray*  
 Position  
 Consultant  
 Company

Date  
 January 17, 1980

I hereby certify that the well location shown on this plat was plotted from field notes of actual surveys made by me or under my supervision, and that the same is true and correct to the best of my knowledge and belief.

Date Surveyed  
 Dec. 15, 1979

Registered Professional Engineer and/or Land Surveyor

*John W. West*

Certificate No. **JOHN W. WEST 878**  
**PATRICK A. ROMERO 8463**  
**Ronald J. Eidson 3239**

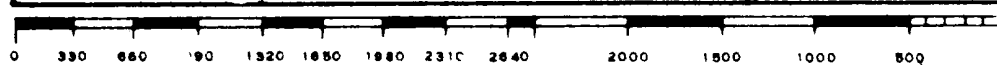



# United States Department of the Interior

GEOLOGICAL SURVEY

P. O. Drawer U  
Artesia, New Mexico 88210

RECEIVED

MAR 19 1980

O. C. D.  
ARTESIA, OFFICE

March 18, 1980

William A. & Edward R. Hudson  
P. O. Box 198  
Artesia, New Mexico 88210

Gentlemen:

WILLIAM A. & EDWARD R. HUDSON  
Puckett "B" No. 28  
2615 FSL 1345 FEL Sec. 25 T.17S R.31E  
Eddy County Lease LC 029415-B

Above Data Required on Well Sign

Your APPLICATION FOR PERMIT TO DRILL the above-described well to a depth of 3,975 feet to test the San Andres formation is hereby approved subject to compliance with the OIL AND GAS OPERATING REGULATIONS (30 CFR 221) and the following conditions:

1. Drilling operations authorized are subject to compliance with the GENERAL REQUIREMENTS FOR OIL AND GAS OPERATIONS ON FEDERAL LEASES, dated July 1, 1978.
2. Prior to commencing construction of road, pad, or other associated developments, operator will provide the dirt contractor with a copy of the SURFACE USE PLAN and this approval including the GENERAL REQUIREMENTS.
3. All access roads will be limited to a 12 foot wide driving surface, excluding turnarounds. Surface disturbance associated with road construction will be limited to 20 feet in width.
4. Submit a Daily Report of Operations from spud date until the Well Completion Report (form 9-330) is filed. The progress report should be not less than 8" x 5" in size and each page should identify the well.
5. All permanent above-ground structures and equipment shall be painted in accordance with the attached Painting Requirements. The color used should simulate Sandstone Brown (Federal Standard No. 595A, color 20318 or 30318).
6. Notify the Survey by telephone 24 hours prior to spudding well.
7. Cement behind the 8-5/8" casing must be circulated.
8. Please have anyone contacting the Survey in regard to this well to identify the well with all of the information required above for the well sign.

Sincerely yours,

George H. Stewart  
Acting District Engineer

**RALPH L. GRAY**  
PETROLEUM ENGINEERING - PRODUCTION  
CONSULTANT  
P. O. BOX 198  
ARTESIA, NEW MEXICO 88210

January 17, 1980

United States Geological Survey  
P. O. Drawer U  
Artesia, New Mexico 88210

Gentlemen:

On January 8, 1980, we transmitted an Application to Drill the William A. & Edward R. Hudson Puckett "B" well #28, and also included a surface use and operations plan.

The footage location for this well has been changed slightly and we are attaching a revised Form 9-331C showing the corrected footage, and we are also attaching revised well location plats.

The well data sheet which was attached to the original application should be attached to the revised application.

This unorthodox location was approved by the New Mexico Oil Conservation Commission Order No. R-5473.

Sincerely,

  
RALPH L. GRAY

RLG:lw

Encs.

RALPH L. GRAY  
PETROLEUM ENGINEERING - PRODUCTION  
CONSULTANT  
P. O. BOX 188  
ATLANTA, NEW MEXICO 86101

March 10, 1964

Mr. J. W. Smith  
P.O. Box 188  
Atlanta, New Mexico 86101

Dear Mr. Smith:

I have received your letter of March 10, 1964, regarding the proposed drilling of a well in the area of the Santa Fe River, New Mexico. I am sorry that I cannot give you a more definite answer at this time, but I am sure that you will understand my position.

I am sure that you will understand my position. I am sure that you will understand my position. I am sure that you will understand my position. I am sure that you will understand my position. I am sure that you will understand my position.

I am sure that you will understand my position. I am sure that you will understand my position. I am sure that you will understand my position. I am sure that you will understand my position. I am sure that you will understand my position.

I am sure that you will understand my position. I am sure that you will understand my position. I am sure that you will understand my position. I am sure that you will understand my position. I am sure that you will understand my position.

Sincerely,  
Ralph L. Gray

Enclosed for you are two copies of a letterhead memorandum from the Santa Fe River, New Mexico, dated March 10, 1964, regarding the proposed drilling of a well in the area of the Santa Fe River, New Mexico.

UNITED STATES  
DEPARTMENT OF THE INTERIOR  
GEOLOGICAL SURVEY

MAR 19 1980

## APPLICATION FOR PERMIT TO DRILL, DEEPEN, OR PLUG BACK

## 1a. TYPE OF WORK

DRILL ☒DEEPEN ☐PLUG BACK ☐

## b. TYPE OF WELL

OIL  
WELL ☒GAS  
WELL ☐

OTHER

SINGLE  
ZONE ☒MULTIPLE  
ZONE ☐

## 2. NAME OF OPERATOR

WILLIAM A. &amp; EDWARD R. HUDSON

## 3. ADDRESS OF OPERATOR

Box #198, Artesia, New Mexico 88210

## 4. LOCATION OF WELL (Report location clearly and in accordance with any State requirements.\*)

At surface

2615' from north and 1295' from east lines of

At proposed prod. zone

Sec. 25-17S-31E.

## 14. DISTANCE IN MILES AND DIRECTION FROM NEAREST TOWN OR POST OFFICE\*

5 miles SW of Maljamar, New Mexico

## 15. DISTANCE FROM PROPOSED\*

LOCATION TO NEAREST  
PROPERTY OR LEASE LINE, FT.  
(Also to nearest drlg. unit line, if any)

1295'

18. DISTANCE FROM PROPOSED LOCATION\*  
TO NEAREST WELL, DRILLING, COMPLETED,  
OR APPLIED FOR, ON THIS LEASE, FT.

970'

## 16. NO. OF ACRES IN LEASE

800

## 19. PROPOSED DEPTH

3975

17. NO. OF ACRES ASSIGNED  
TO THIS WELL

## 20. ROTARY OR CABLE TOOLS

Rotary

## 21. ELEVATIONS (Show whether DF, RT, GR, etc.)

## 22. APPROX. DATE WORK WILL START\*

March 15, 1980

## 23.

## PROPOSED CASING AND CEMENTING PROGRAM

SIZE OF HOLE	SIZE OF CASING	WEIGHT PER FOOT	SETTING DEPTH	QUANTITY OF CEMENT
12-1/4"	8-5/8-J-55	24#	750	450
7-7/8"	5 1/2 - J-55	15.5#	3975	550

It is proposed to drill this well with rotary tools to a depth of approximately 3975'. Production string will be cemented near bottom and pays will be perforated and treated with acid and frac. All casing will be new. See attachment for other data.

RECEIVED

JAN 7 1980

U.S. GEOLOGICAL SURVEY  
ARTESIA, NEW MEXICO

IN ABOVE SPACE DESCRIBE PROPOSED PROGRAM: If proposal is to deepen or plug back, give data on present productive zone and proposed new productive zone. If proposal is to drill or deepen directionally, give pertinent data on subsurface geology, proposed and true vertical depths. Give blowout preventer program, if any.

## 24.

SIGNED

*Raymond L. May*

TITLE

Consultant

DATE

Jan. 3, 1980

(This space for Federal or State office use)

PERMIT NO.

APPROVAL DATE

APPROVED BY

TITLE

DATE

CONDITIONS OF APPROVAL, IF ANY:

\*See Instructions On Reverse Side

## Instructions

**General:** This form is designed for submitting proposals to perform certain well operations, as indicated, on all types of lands and leases for appropriate action by either a Federal or a State agency, or both, pursuant to applicable Federal and/or State laws and regulations. Any necessary special instructions concerning the use of this form and the number of copies to be submitted, particularly with regard to local, area, or regional procedures and practices, either are shown below or will be issued by, or may be obtained from, the local Federal and/or State office.

**Item 1:** If the proposal is to redrill to the same reservoir at a different subsurface location or to a new reservoir, use this form with appropriate notations. Consult applicable State or Federal regulations concerning subsequent work proposals or reports on the well.

**Item 4:** If there are no applicable State requirements, locations on Federal or Indian land should be described in accordance with Federal requirements. Consult local State or Federal office for specific instructions.

**Item 14:** Needed only when location of well cannot readily be found by road from the land or lease description. A plat, or plats, separate or on this reverse side, showing the roads to, and the surveyed location of, the well, and any other required information, should be furnished when required by Federal or State agency offices.

**Items 15 and 18:** If well is to be, or has been directionally drilled, give distances for subsurface location of hole in any present or objective production zone.

**Item 22:** Consult applicable Federal or State regulations, or appropriate officials, concerning approval of the proposal before operations are started.



NEW MEXICO OIL CONSERVATION COMMISSION  
WELL LOCATION AND ACREAGE DEDICATION PLAT

Form O-10,  
Superseded O-128  
Effective 1-1-65

All distances must be from the outer boundaries of the section.

Operator <b>WA &amp; ED R. HUDSON</b>		Lessee <b>PUCKETT B</b>		Well No. <b>28</b>
Unit Letter <b>H</b>	Section <b>25</b>	Range <b>17 South</b>	Eddy	
Actual Surface Location of Well: <b>2615</b> feet from the <b>North</b> line and <b>1295</b> feet from the <b>East</b> line.				
Ground Elev. <b>3875.7</b>	Producing Formation <b>Grayburg-San Andres</b>	Pool <b>Maljamar (G-SA)</b>	Other Well Numbers	

1. Outline the acreage dedicated to the subject well by colored pencil or hatchure marks on the plat below.
2. If more than one lease is dedicated to the well, outline each and identify the ownership thereof (both as a working interest and royalty).
3. If more than one lease of different ownership is dedicated to the well, have the interests of all owners been consolidated by communitization, unitization, force-pooling, etc?

☐ Yes    ☐ No    If answer is "yes," type of consolidation \_\_\_\_\_

If answer is "no," list the owners and tract descriptions which have actually been consolidated (use reverse side of this form if necessary.) \_\_\_\_\_

No allowable will be assigned to the well until all interests have been consolidated (by communitization, unitization, forced-pooling, or otherwise) or until a non-standard unit, eliminating such interests, has been approved by the Commission.

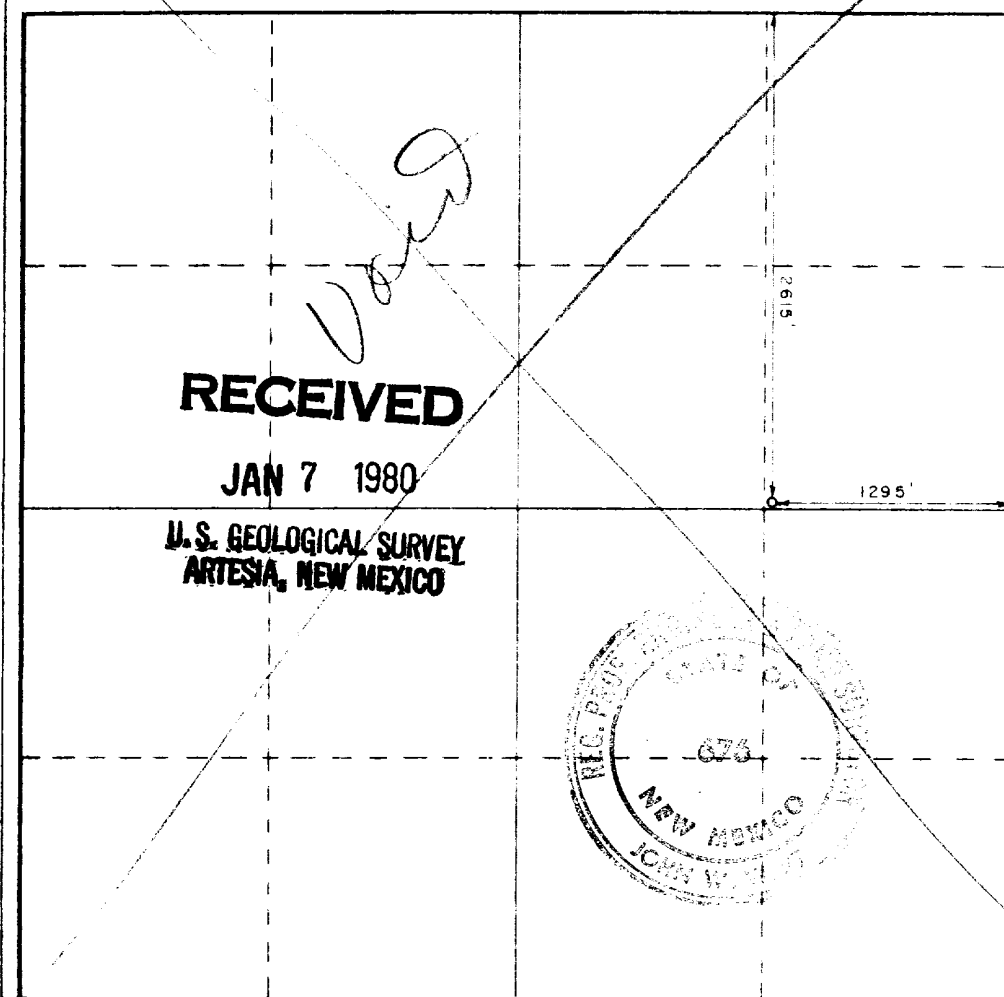

**CERTIFICATION**

I hereby certify that the information contained herein is true and complete to the best of my knowledge and belief.

Name *Ralph L. Gray*  
Position **Consultant**

Long No.

January 3, 1980

I hereby certify that the well location shown on this plat was plotted from field notes of actual surveys made by me or under my supervision, and that the same is true and correct to the best of my knowledge and belief.

Date Surveyed

**12-15-1979**

Registered Professional Engineer and Surveyor

*John W. West*

Certificate No. **John W. West 676**  
**Ronald J. Eidson 3239**

0 330 660 990 1320 1650 1980 2310 2640 2970 3300 3630 3960 4290 4620 4950 5280 5610 5940 6270 6600

ADDITIONAL DATA

PUCKETT 'B' WELL #28

1. Surface formation is recent sands and caliche.
2. Estimated tops:
  - T. Anhydrite - - 710'
  - T. Salt - - - - 830'
  - B. Salt - - - - 1900'
  - T. Red Sand - - 3000'
  - T. San Andres - 3680'.
3. It is expected that oil and gas might be encountered within the depths of 3500' to 3975'.
4. Casing (See Form 9-331C).
5. Pressure control equipment (See attached diagram).
6. No special mud will be used. Drilling will be done with water and natural mud formed by drilling red beds and shales. Before running casing, some mud of suitable qualities will be spotted.
7. Auxiliary equipment - not applicable for shallow well.
8. No tests will be made before cementing casing, and no cores will be taken. Logs will be Gamma ray-Compensated Neutron and Cement bond log.
9. No abnormal pressures or temperatures are anticipated, or special hazards.
10. It is expected drilling will be commenced about March 15, 1980, and well should be completed about April 15, 1980.

# THEORY OF THE EARTH

1. The Earth is a sphere of radius  $R$  and mass  $M$ .

2. The Earth is a sphere of radius  $R$  and mass  $M$ .

3. The Earth is a sphere of radius  $R$  and mass  $M$ .

4. The Earth is a sphere of radius  $R$  and mass  $M$ .

5. The Earth is a sphere of radius  $R$  and mass  $M$ .

6. The Earth is a sphere of radius  $R$  and mass  $M$ .

7. The Earth is a sphere of radius  $R$  and mass  $M$ .

8. The Earth is a sphere of radius  $R$  and mass  $M$ .

9. The Earth is a sphere of radius  $R$  and mass  $M$ .

10. The Earth is a sphere of radius  $R$  and mass  $M$ .

11. The Earth is a sphere of radius  $R$  and mass  $M$ .

**RALPH L. GRAY**  
PETROLEUM ENGINEERING - PRODUCTION  
CONSULTANT  
P. O. BOX 198  
ARTESIA, NEW MEXICO 88210

January 7, 1980

United States Geological Survey  
P. O. Drawer U  
Artesia, New Mexico 88210

Gentlemen:

Attached is Application to Drill the William A. & Edward R. Hudson Puckett "B" well #28. This also includes the surface Use and Operations Plan along with various maps, diagram of location, pad and equipment and a contour map of the area.

It would be appreciated if your personnel would make the archeology inspection and we will assume that this will be handled by you unless we receive further notice from you.

Please advise if any additional information is needed.

Sincerely,

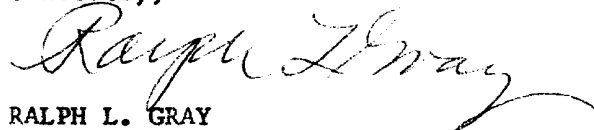
  
RALPH L. GRAY

RLG:lw

Encls.

**RECEIVED**

JAN 7 1980

U.S. GEOLOGICAL SURVEY  
ARTESIA, NEW MEXICO

0901 5 1 0012

[illegible]

1. The first step is to identify the problem or question that needs to be answered. This involves understanding the context and the specific requirements of the task.

[illegible]

24

*Journal of Management Inquiry* 18(6)

100-443689-20  
ENCLOSURE

## SURFACE USE AND OPERATIONS PLAN

WILLIAM A. & EDWARD R. HUDSON  
PUCKETT "B" WELL #28  
2615' from the north and 1295' from the east lines  
Section 25-17S-31E  
Eddy County, New Mexico  
Lease No. LC-029415-B  
(Development Well)

---

Following is the surface use and operations plan for the drilling and operation of the well.

### 1. & 2. EXISTING ROADS AND PLANNED ACCESS

Exhibit "A" shows a map of the general area. The location of the well can be reached by going west from Maljamar, New Mexico, on U.S. Highway #82 a distance of about 4-1/3 miles. Turn southeastward at cattleguard marked by a "Hudson" sign. Go about 9/10 of a mile on dirt road, then go south approximately 1/4 mile. Turn west on lease road for 1/8 mile, then turn south and go about 1-1/8 miles. Access road will go directly west from this point about 1/8 mile to location.

Exhibit "B" shows a more detailed map, scale 1" = 1,000'. This map shows wells, roads, tank batteries, camp, office, water injection plant and flow lines, including proposed flow line for this well. Access road will be constructed with bull dozer to level sandy soil and will be topped with caliche. Flow line will be buried.

### 3. LOCATION OF EXISTING WELLS

Wells are shown on both exhibits "A" and "B". On Exhibit "B", producing wells are indicated by solid dots and water injection wells are indicated by circles.

### 4. LOCATION OF EXISTING AND/OR PROPOSED FACILITIES

Proposed well location is shown on Exhibit "B" by the red circle. Fluids produced from well will go to present tank battery and new flow line connecting well into present gathering system is shown by the blue dashed line. Flow line will be buried.

### 5. LOCATION AND TYPE OF WATER SUPPLY

Water for drilling the well will be obtained from a water supply tank, located 3/4 mile to the north. A temporary line will be laid on the surface from well to tank. If supply is not adequate, another line may be laid to water injection system.

### 6. SOURCE OF CONSTRUCTION MATERIALS

Caliche for surfacing access road and location pad will be obtained from a surface pit located north of location about 700 feet. This is shown on Exhibit "B". Pit is on Federal land.

### 7. METHOD OF HANDLING WASTE DISPOSAL

A. Drill cuttings will be disposed of in drilling pits.

- B. Drilling fluids will be allowed to evaporate in the drilling pits until pits are dry.
- C. Oil produced during tests will be stored in test tanks, or stored in battery until sold.
- D. Current laws and regulations pertaining to the disposal of human waste will be complied with.
- E. Trash, waste paper, garbage and junk will be buried in separate trash pit and covered with a minimum of 24 inches of dirt. Location of trash pit is shown on Exhibit "C".
- F. All trash and debris will be buried or removed from well site within 30 days after finishing drilling and/or completion operations.

8. ANCILLARY FACILITIES

None.

9. WELLSITE LAYOUT

- A. Exhibit "C" shows the relative location and dimensions of the well pad, mud pits, reserve pit, trash pit and location of major rig components.
- B. Only minor levelling of the well site will be required.
- C. Pits will be unlined.

10. PLANS FOR RESTORATION OF THE SURFACE

- A. After completion of drilling and/or completion operations, all equipment and other material not needed for operations will be removed. Pits will be filled and location cleaned of all trash and junk to leave wellsite in as good a condition as possible.
- B. Any unguarded pits containing fluids will be fenced until they are filled.
- C. After abandonment of the well, surface restoration will be in accordance with agreement with the surface owner. Pits will be filled and location cleaned. The pit area, well pad, and all unneeded access roads will be ripped to promote revegetation. Rehabilitation should be accomplished within 90 days after abandonment.

11. OTHER INFORMATION

- A. Topography: Land surface is relatively flat with small hill areas and sand dunes.
- B. Soil: Soil is deep sand underlain by caliche.
- C. Flora and Fauna: The vegetative cover is generally sparse and consists of mesquite, yucca, shinnery oak and very little native grass. Wildlife is typical of semi-arid desert land and includes coyotes, rabbits, rodents, reptiles, dove and quail.

- D. Ponds and Streams: There are no rivers, streams, lakes or ponds in the area.
- E. Residences and Other Structures: There are personnel dwellings, office and waterflood plant in the north half of Section 24 as shown on Exhibit "B".
- F. Land Use: Grazing and hunting in season, although the principal use is production of oil.

12. OPERATOR'S REPRESENTATIVE

The field representative responsible for assuring compliance with the approved surface use and operations plan is as follows:

Mr. Dwaine Howard  
1007 West Dallas Ave.  
Artesia, New Mexico  
Home Phone: 746-9489  
Office Phone: 676-2266

13. CERTIFICATION

I hereby certify that I, or persons under my direct supervision, have inspected the proposed drillsite and access route; that I am familiar with the conditions which presently exist; that the statements made in this plan are, to the best of my knowledge true and correct, and that the work associated with the operations proposed herein will be performed by William A. & Edward R. Hudson and their contractors and sub-contractors in conformity with this plan and the terms and conditions under which it is approved.

Jan 7, 1980  
Date

Ralph L. Gray  
RALPH L. GRAY, CONSULTING ENGINEER



**RALPH L. GRAY**  
PETROLEUM ENGINEERING - PRODUCTION  
CONSULTANT  
P. O. BOX 198  
ARTESIA, NEW MEXICO 88210

January 8, 1980

United States Geological Survey  
P. O. Drawer U  
Artesia, New Mexico 88210

**RECEIVED**  
JAN 8 1980  
U.S. GEOLOGICAL SURVEY  
ARTESIA, NEW MEXICO

Gentlemen:

Our letter of January 7, 1980, transmitted an application to drill the William A. & Edward R. Hudson - Puckett "B" well #28. We would like to furnish additional information which will be a part of the Surface Use and Operations Plan.

The caliche pit which was referred to, which will furnish material for the road and location, is located in the SE/4 NE/4 of Section 25-17S-31E.

Sincerely,

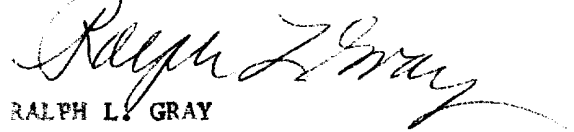
  
RALPH L. GRAY

RLG:lw

RALPH L. GRAY  
PETROLEUM ENGINEERING - PRODUCTION  
CONSULTANT  
P.O. BOX 198  
ATLANTA, NEW MEXICO 88410

RECEIVED

JAN 11 1983  
ATLANTA NEW MEXICO  
P.O. BOX 198

Enclosed for the Department of Energy, Office of  
Fossil Fuels, Washington, D.C. 20585, are two copies of  
a report titled "A Study of the Effect of Sulfur Content  
on the Performance of Diesel Engines". The report was  
prepared by the author and is being submitted for  
information and possible use in the Department's  
ongoing research on the effects of sulfur on diesel  
engine performance.

Very truly yours,  
RALPH L. GRAY  
CONSULTANT

[illegible]

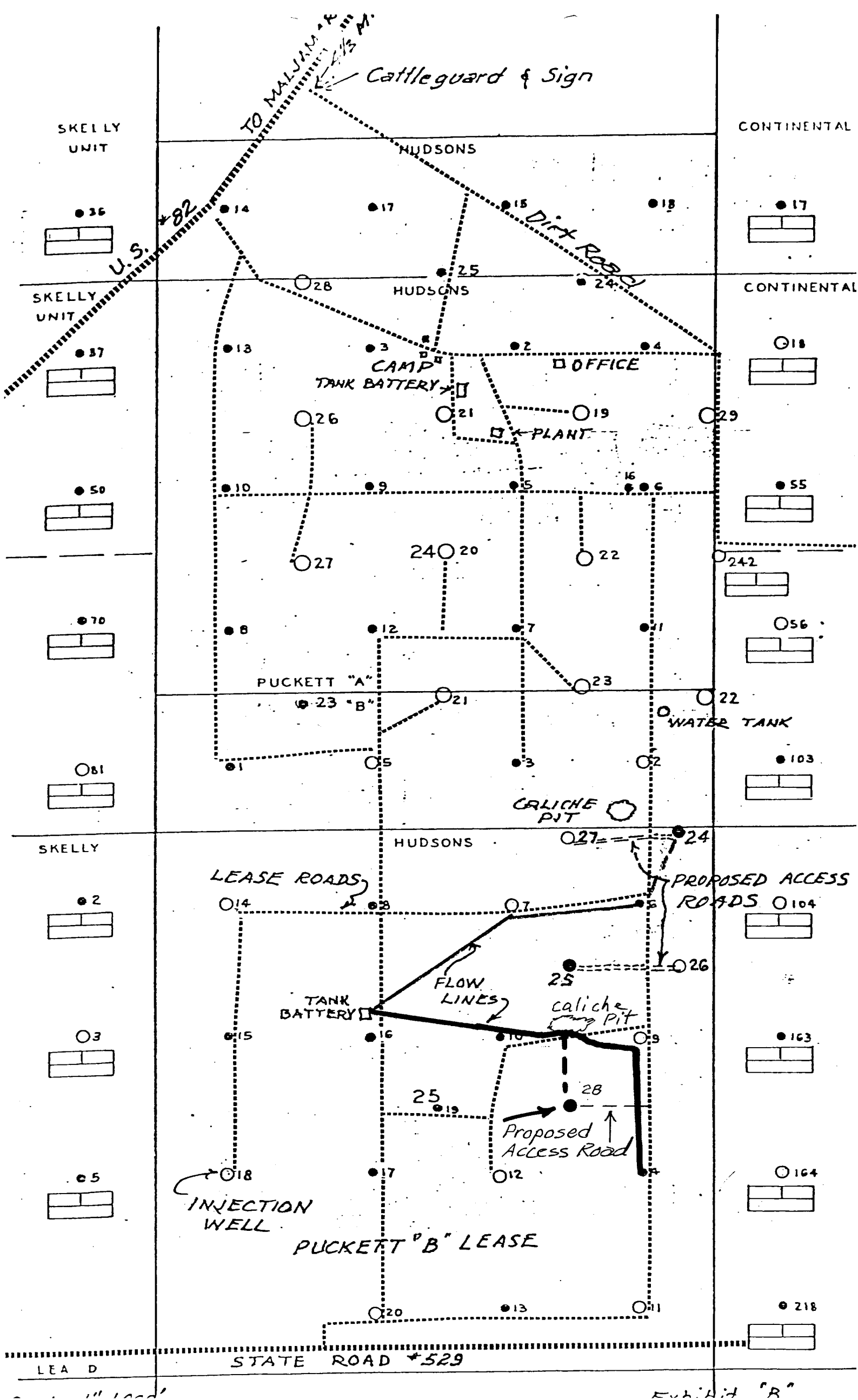

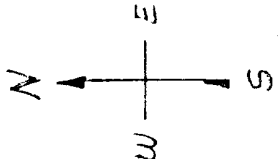

WEK DRILLING CO., INC.  
RIG #1  
LOCATION & MUD PIT SPECS.

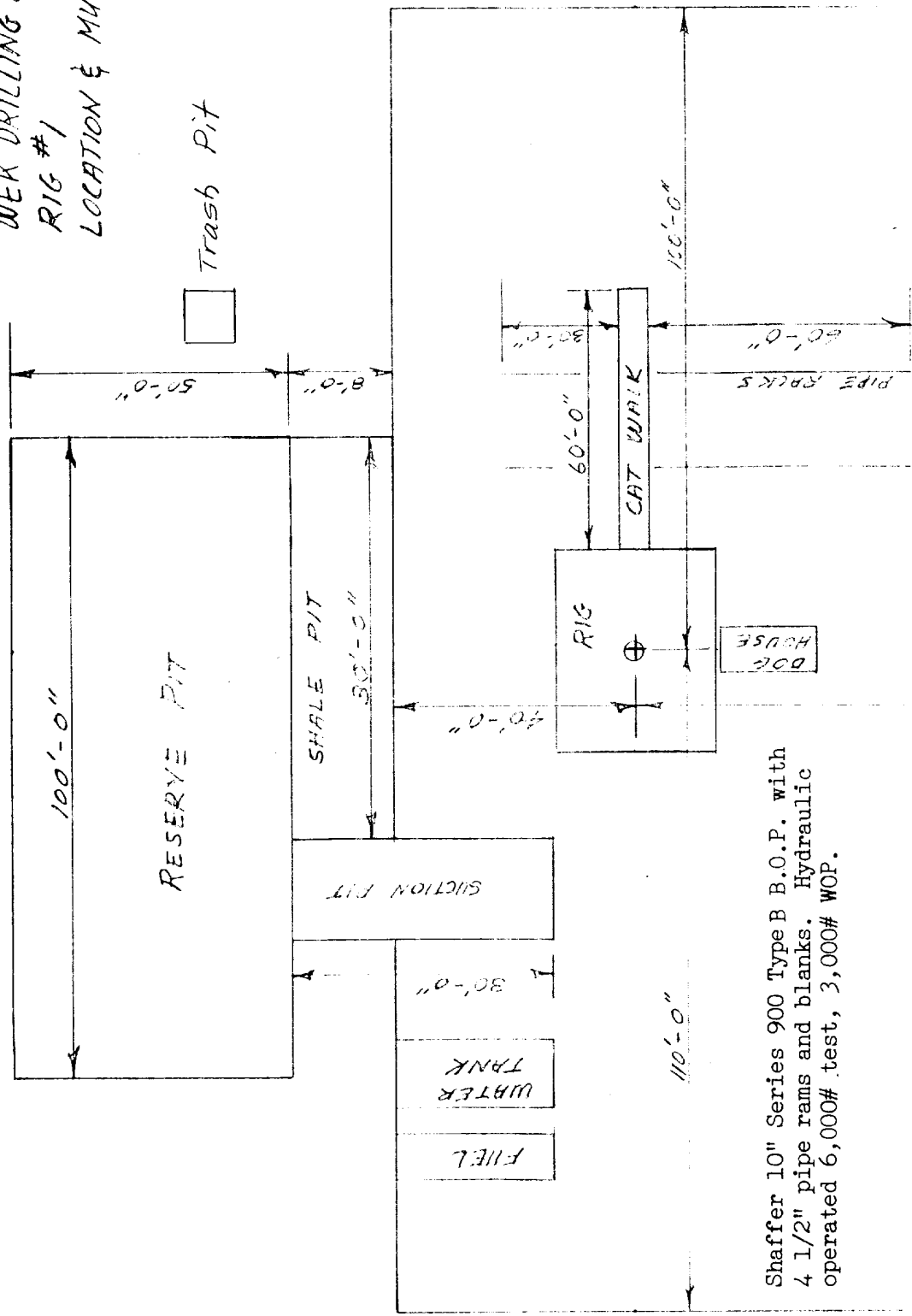

Shaffer 10" Series 900 Type B B.O.P. with  
4 1/2" pipe rams and blanks. Hydraulic  
operated 6,000# test, 3,000# WOP.

Exhibit "C"

3905

# CONTOUR MA.

3962

3912

BM

3940

13

3950

14

3908

Quarry

39140

395

15

Quarry

3880

Quarry

PIPELINE

Pumping Sta

3850

Water Intake

24

38840

38860

Water Intake

Pumping Sta

837

Quarry

3844

3848

Quarry

3877

1844

27

25

Quarry

3844

Quarry

3801

38240

Quarry

3858

Highway Well

3799

34

3800

36

3850

PIPELINE

WEK DRILLING CO., INC. - Rig 1 & 3  
**BLOWOUT PREVENTER SPECIFICATION**

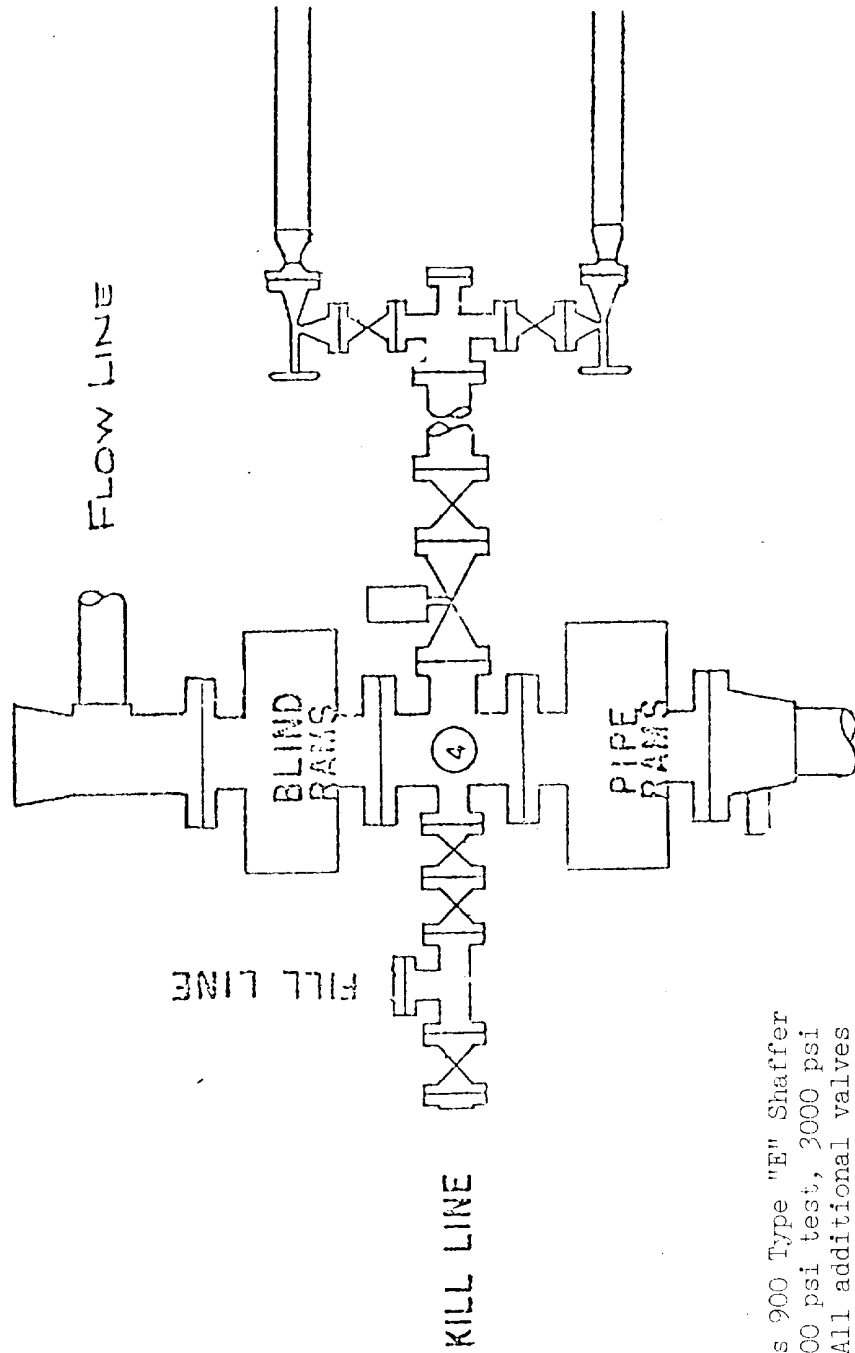

BOP's are 10" Series 900 Type "E" Shaffer Double Hydraulic 6000 psi test, 3000 psi working pressure. All additional valves & connections are the same test & working pressures.