

**NEW MEXICO OIL CONSERVATION COMMISSION
WELL LOCATION AND ACREAGE DEDICATION PLAT**

Form C-102
Supersedes C-128
Effective 1-1-65

All distances must be from the outer boundaries of the Section

Owner L. RAY DUNWOODY			Lease InterNorth State			Well No. 1		
Section Letter F	Section 32	Township 13S	Range 23E	County Eddy				
Sectional Portage Location of Well: 1980 feet from the North line and 1980 feet from the West line								
Ground Level Elev. 4000.5'	Producing Formation Morrow		Pool South Hope - Penn (Ext.)			Dedicated Acreage 320		

1. Outline the acreage dedicated to the subject well by colored pencil or hachure marks on the plat below.
2. If more than one lease is dedicated to the well, outline each and identify the ownership thereof (both as to working interest and royalty).
Only one lease involved.
3. If more than one lease of different ownership is dedicated to the well, have the interests of all owners been consolidated by communitization, unitization, force-pooling, etc?

☐ Yes ☐ No If answer is "yes" type of consolidation _____

If answer is "no," list the owners and tract descriptions which have actually been consolidated. (Use reverse side of this form if necessary.) _____

No allowable will be assigned to the well until all interests have been consolidated (by communitization, unitization, forced-pooling, or otherwise) or until a non-standard unit, eliminating such interests, has been approved by the Commission.

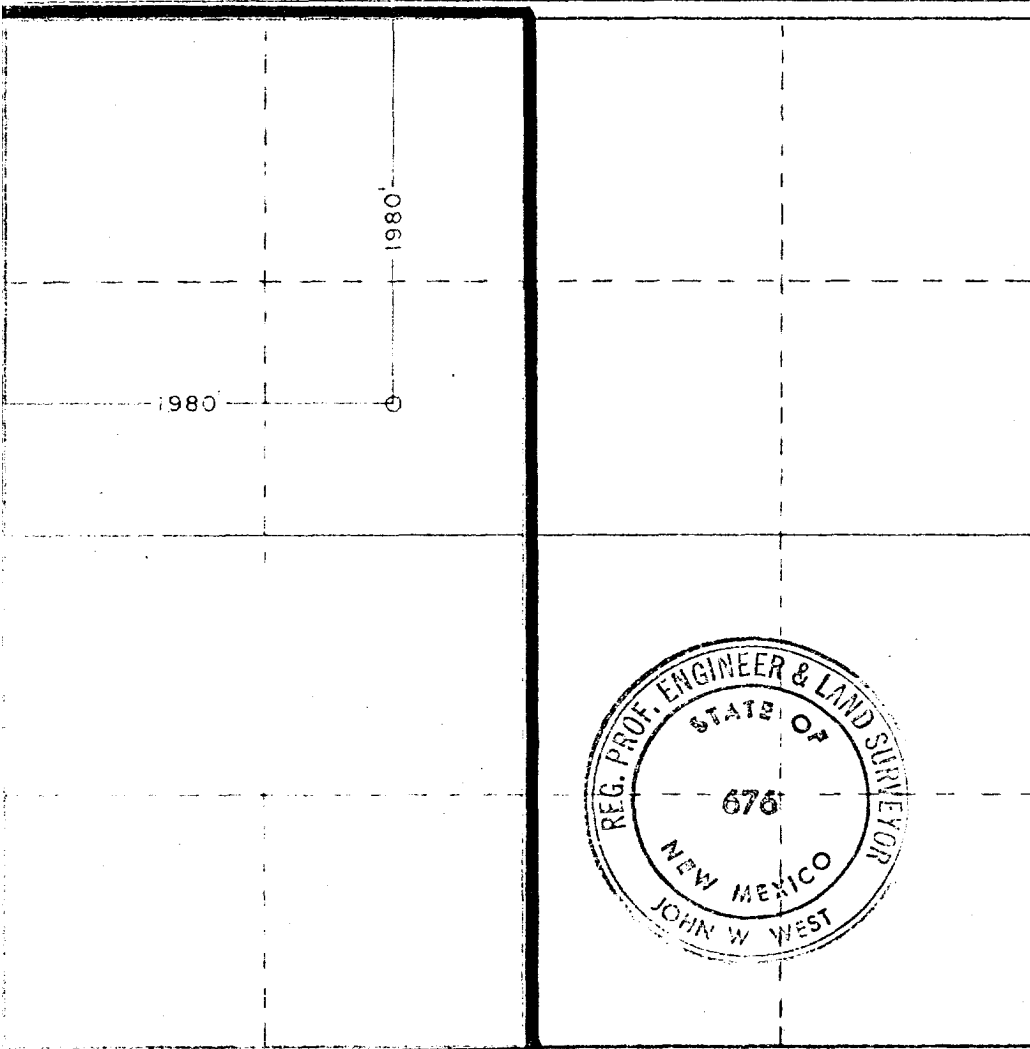

CERTIFICATION

I hereby certify that the information contained herein is true and complete to the best of my knowledge and belief.

James A. Knaut
James A. Knaut

Position
Agent

Company
L. RAY DUNWOODY

Date
12-10-80

I hereby certify that the well location shown on this plat was plotted from field notes of actual surveys made by me or under my supervision, and that the same is true and correct to the best of my knowledge and belief.

Date Surveyed
December 8, 1980

Registered Professional Engineer and Professional Land Surveyor

John W. West

Certificate No.	JOHN W. WEST	676
	PATRICK A. ROMERO	6883
	Ronald J. Eidson	3239

330 660 90 1320 1650 1980 2310 2640 2000 1500 1000 500