

UNITED STATES
DEPARTMENT OF THE INTERIOR
GEOLOGICAL SURVEY

APPLICATION FOR PERMIT TO DRILL, DEEPEN, OR PLUG BACK

1a. TYPE OF WORK

DRILL ☒DEEPEN ☐PLUG BACK ☐

b. TYPE OF WELL

OIL
WELL ☒GAS
WELL ☐

OTHER

SINGLE
ZONE ☐MULTIPLE
ZONE ☐

2. NAME OF OPERATOR

RAY WESTALL

JAN 28 1981

3. ADDRESS OF OPERATOR

P.O. BOX 4, LOCO HILLS, NEW MEXICO 88255 O. C. D.

4. LOCATION OF WELL (Report location clearly and in accordance with any State requirements)

At surface

2310 FEL 2310 FNL Letter G Sec 20, T-18S R-29E

At proposed prod. zone

5. LEASE DESIGNATION AND SERIAL NO.

LC069132 62409

6. IF INDIAN, ALLOTTEE OR TRIBE NAME

7. UNIT AGREEMENT NAME

8. FARM OR LEASE NAME

HEWITT Federal

9. WELL NO.

#1

10. FIELD AND POOL, OR WILDCAT

Loco Hills QN/GB/SA

11. SEC., T., R., M., OR BLK.
AND SURVEY OR AREA

S-20 T-18S R-29E

12. COUNTY OR PARISH

Eddy

13. STATE

N. Mex.

15. DISTANCE FROM PROPOSED*

LOCATION TO NEAREST
PROPERTY OR LEASE LINE, FT.
(Also to nearest drlg. unit line, if any)

16. NO. OF ACRES IN LEASE

120

17. NO. OF ACRES ASSIGNED
TO THIS WELL

40

18. DISTANCE FROM PROPOSED LOCATION*

TO NEAREST WELL, DRILLING, COMPLETED,
OR APPLIED FOR, ON THIS LEASE, FT.

660'

19. PROPOSED DEPTH

3,100

20. ROTARY OR CABLE TOOLS

Rotary

21. ELEVATIONS (Show whether DF, RT, GR, etc.)

3617.1

22. APPROX. DATE WORK WILL START*

2-1-80

23. PROPOSED CASING AND CEMENTING PROGRAM

SIZE OF HOLE	SIZE OF CASING	WEIGHT PER FOOT	SETTING DEPTH	QUANTITY OF CEMENT
11"	8 5/8"	24#	350'	250 SX
8"	4 1/2"	10 1/2#	3,100'	600 SX

We propose to drill and test the San Andres and Intermediate formations. Approximatels 350' of surface casing will be set to shut off gravel and cavings. 4 1/2" production casing will be run, perforated, and sand frac'd for production.

BOP PROGRAM: A 10" 900 Series Shaffer Type F Double B.O.P. will be used in drilling this well.

MUD PROGRAM: Fresh water gel to 950' and water to TD.

JAN 15 1981

U.S. GEOLOGICAL SURVEY
ARTESIA, NEW MEXICO

IN ABOVE SPACE DESCRIBE PROPOSED PROGRAM: If proposal is to deepen or plug back, give data on present productive zone and proposed new productive zone. If proposal is to drill or deepen directionally, give pertinent data on subsurface locations and measured and true vertical depths. Give blowout preventer program, if any.

24.

SIGNED

Ray Westall

TITLE

OPERATOR

DATE

1/5/80

(This space for Federal or State office use)

PERMIT NO.

APPROVAL DATE

GEO. 5311 GEORGE H. STEPHENSON

APPROVED BY

TITLE

DATE

JAN 22 1981

CONDITIONS OF APPROVAL, IF ANY:

UNITED STATES
DEPARTMENT OF THE INTERIOR
GEOLOGICAL SURVEY

APPLICATION FOR PERMIT TO DRILL, DEEPEN, OR PLUG BACK

1a. TYPE OF WORK DRILL <input checked="" type="checkbox"/> DEEPEN <input type="checkbox"/> PLUG BACK <input type="checkbox"/>			5. LEASE DESIGNATION AND SERIAL NO. LC067132 62404	
b. TYPE OF WELL OIL WELL <input checked="" type="checkbox"/> GAS WELL <input type="checkbox"/> OTHER <input type="checkbox"/>			6. IF INDIAN, ALLOTTEE OR TRIBE NAME	
2. NAME OF OPERATOR RAY WESTALL			7. UNIT AGREEMENT NAME	
3. ADDRESS OF OPERATOR P.O. BOX 4, LOCO HILLS, NEW MEXICO 88255			8. FARM OR LEASE NAME HEWITT	
4. LOCATION OF WELL (Report location clearly and in accordance with any State requirements.) At surface 2310 FEL 2310 FNL Letter G Sec 20, T-18S R-29E At proposed prod. zone			9. WELL NO. #1	
14. DISTANCE IN MILES AND DIRECTION FROM NEAREST TOWN OR POST OFFICE* 8 1/2 miles SW of Loco Hills, New Mexico			10. FIELD AND POOL, OR WILDCAT Loco Hills QN/GB/SA	
15. DISTANCE FROM PROPOSED* LOCATION TO NEAREST PROPERTY OR LEASE LINE, FT. (Also to nearest drilg. unit line, if any)		16. NO. OF ACRES IN LEASE 120		17. NO. OF ACRES ASSIGNED TO THIS WELL 40
18. DISTANCE FROM PROPOSED LOCATION* TO NEAREST WELL, DRILLING, COMPLETED, OR APPLIED FOR, ON THIS LEASE, FT. 660'		19. PROPOSED DEPTH 3,100		20. ROTARY OR CABLE TOOLS Rotary
21. ELEVATIONS (Show whether DF, RT, GR, etc.) 3617.1			22. APPROX. DATE WORK WILL START* 2-1-80	

23. PROPOSED CASING AND CEMENTING PROGRAM

SIZE OF HOLE	SIZE OF CASING	WEIGHT PER FOOT	SETTING DEPTH	QUANTITY OF CEMENT
11"	8 5/8"	24#	350'	250 SX CIRCULATE
8"	4 1/2"	10 1/2#	3,100'	600 SX CIRCULATE

We propose to drill and test the San Andres and Intermediate formations. Approximately 350' of surface casing will be set to shut off gravel and cavings. 4 1/2" production casing will be run, perforated, and sand frac'd for production.

BOP PROGRAM: A 10" 900 Series Shaffer Type F Double B.O.P. will be used in drilling this well.

MUD PROGRAM: Fresh water gel to 950' and water to TD.

IN ABOVE SPACE DESCRIBE PROPOSED PROGRAM: If proposal is to deepen or plug back, give data on present productive zone and proposed new productive zone. If proposal is to drill or deepen directionally, give pertinent data on subsurface locations and measured and true vertical depths. Give blowout preventer program, if any.

24. SIGNED Ray Westall TITLE OPERATOR DATE 1/5/80
(This space for Federal or State office use)

PERMIT NO. _____ APPROVAL DATE _____

APPROVED BY _____ TITLE _____ DATE _____

CONDITIONS OF APPROVAL, IF ANY:

**NEW MEXICO OIL CONSERVATION COMMISSION
WELL LOCATION AND ACREAGE DEDICATION PLAT**

Form C-102
Supersedes C-128
Effective 1-1-65

All distances must be from the outer boundaries of the Section.

Operator Ray Westall			Lease Hewitt Federal		Well No. 1
Unit Letter G	Section 20	Township 18S	Range 29E	County Eddy	
Actual Footage Location of Well: 2310 feet from the East line and 2310 feet from the North line					
Ground Level Elev. 3617.1	Producing Formation QN/GB/SA		Pool Loco Hills	Dedicated Acreage: 40 Acres	

1. Outline the acreage dedicated to the subject well by colored pencil or hatchure marks on the plat below.
2. If more than one lease is dedicated to the well, outline each and identify the ownership thereof (both as to working interest and royalty).
3. If more than one lease of different ownership is dedicated to the well, have the interests of all owners been consolidated by communitization, unitization, force-pooling, etc?

☐ Yes ☒ No If answer is "yes," type of consolidation _____

If answer is "no," list the owners and tract descriptions which have actually been consolidated. (Use reverse side of this form if necessary.) _____

No allowable will be assigned to the well until all interests have been consolidated (by communitization, unitization, forced-pooling, or otherwise) or until a non-standard unit, eliminating such interests, has been approved by the Commission.

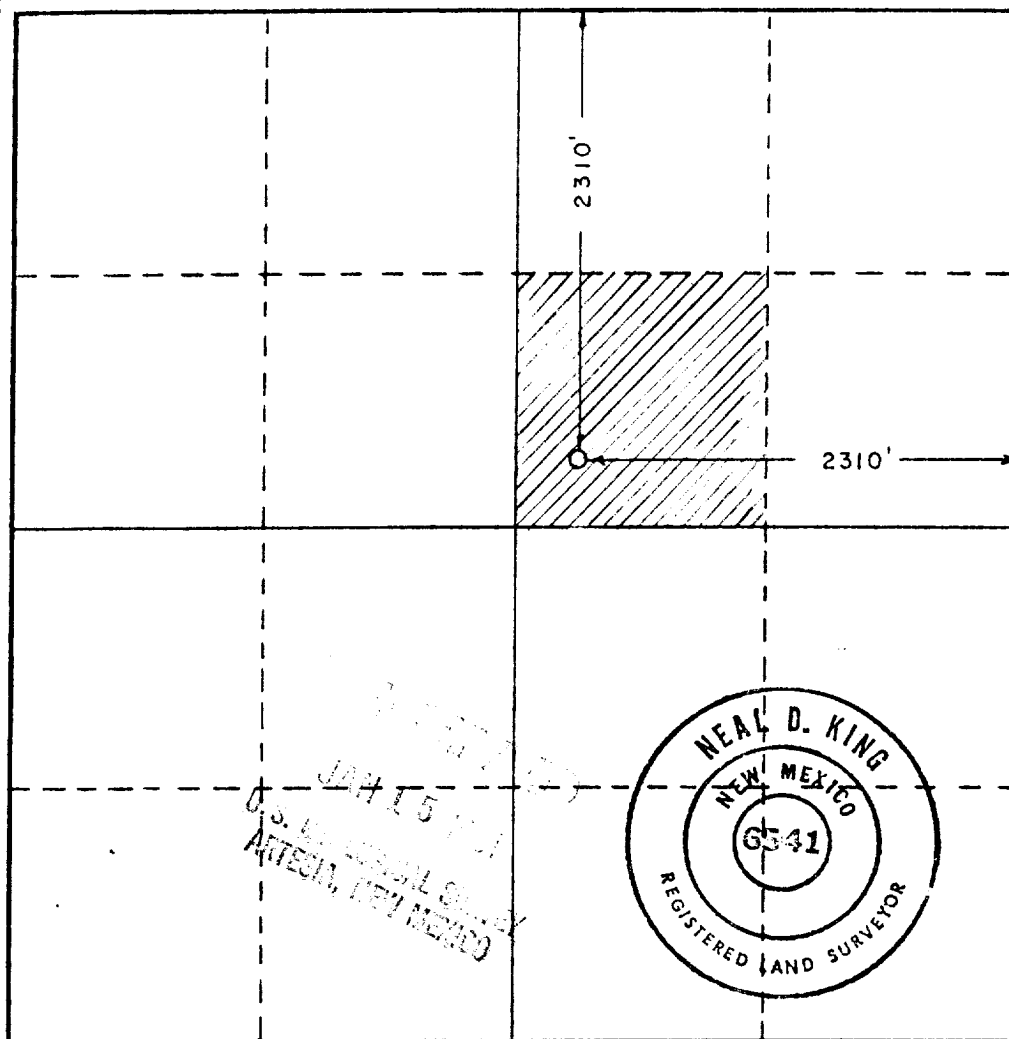

CERTIFICATION

I hereby certify that the information contained herein is true and complete to the best of my knowledge and belief.

Name

Ray Westall

Position

Operator

Company

Date

1/5/80

I hereby certify that the well location shown on this plat was plotted from field notes of actual surveys made by me or under my supervision, and that the same is true and correct to the best of my knowledge and belief.

Date Surveyed

December 22, 1980

Registered Professional Engineer
and/or Land Surveyor

Neal D. King
Certificate No. **6541**

R.L.S.

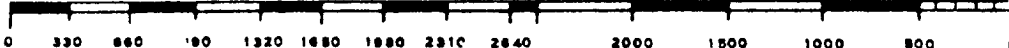

MULTI-POINT SURFACE USE AND OPERATIONS PLAN

RAY WESTALL

HEWITT FEDERAL # 1

2310 FEL, 2310 FNL

SECTION 20, T-18S, R-29E

This plan is submitted with Form 9-331C, Application for Permit to Drill, covering the above described well. The purpose of this plan is to describe the location of the proposed well, the proposed construction activities and operations plan, the magnitude of surface disturbance involved, and the procedures to be followed in rehabilitating the surface after completion of the operations, so that a complete appraisal can be made of the environmental effect associated with the operation.

1. EXISTING ROADS.

Exhibit A is a portion of a USGS topographic map showing the wells and roads in the vicinity of the proposed location. The proposed wellsite is located approximately 20 miles SSE of Artesia, New Mexico and the access route to the location is Exhibit A.

DIRECTIONS.

1. Proceed east from Artesia on Highway 82 for a distance of approximately 14 miles.
2. Turn southeast onto State Road 360 for approximately 6.0 miles. Turn south on unimproved dirt road and go 1 mile.

2. PLANNED ACCESS ROAD.

- A. The existing lease road and location will be used. Then approximately $\frac{1}{4}$ mile of road to location.

3. LOCATION OF EXISTING WELLS.

- A. Southland Royalty Company has a gas well located in the SE $\frac{1}{4}$ of Section 20 T-18S, R-29E.

RECEIVED
JUN 10 1971
U.S. DEPARTMENT OF THE INTERIOR
BUREAU OF LAND MANAGEMENT
ARTESIA, NEW MEXICO

4. LOCATION OF EXISTING/OR PROPOSED FACILITIES.

- A. There are no producing facilities on the shallow lease at the present time.
- B. In the event the well is productive, the necessary production facilities will be installed on the drilling pad. If the well is productive oil, electricity will be used to provide the necessary power. No power will be required if the well is productive gas. Electric lines will have to be installed from east side of location.

5. LOCATION AND TYPE OF WATER SUPPLY.

- A. It is planned to drill the proposed well with a fresh water system. The water will be obtained from commercial sources and will be hauled to the location by truck.

6. SOURCE OF CONSTRUCTION MATERIALS.

- A. The location is on a hill and will require a small cut which will be used for road.

7. METHODS OF HANDLING WASTE DISPOSAL.

- A. Drill cuttings will be disposed of in the reserve pit.
- B. Drilling fluids will be allowed to evaporate in the reserve pits until the pits are dry.
- C. Produced water during testing- drill pits.
- D. Oil produced during operation will be stored in tanks until sold.
- E. Current laws and regulations pertaining to the disposal of human waste will be complied with.
- F. Trash, waste paper, garbage and junk will be buried in a separate trash pit and covered with a minimum of 24 inches of dirt. All waste material will be contained to prevent scattering by the wind.
- G. All trash and debris will be buried or removed from the well-site within 30 days after finishing drilling and/or completion of operations.

8. ANCILLARY FACILITIES.

- A. None required.

9. WELLSITE LAYOUT.

A. Exhibit C shows the relative location and dimensions of the well pad, the reserve pits, etc.

B. A 400' X 400' area has been staked and flagged.

10. PLANS FOR RESTORATION OF THE SURFACE.

A. After finishing drilling and/or completion operations, all equipment and other material not needed for further operations will be removed. The location will be cleaned of all trash and junk to leave the wellsite in as aesthetically pleasing a condition as possible.

B. Unguarded pits, if any, containing fluids will be fenced until they have been filled.

C. If the proposed well is non-productive, all rehabilitation and/or vegetation requirements of the BLM and USGS will be complied with and will be accomplished as expeditiously as possible. All pits will be filled level within 90 days after abandonment.

11. OTHER INFORMATION.

A. Topography: The land surface in the vicinity of the well-site is in sand dunes. The immediate area of the wellsite is discussed above in paragraph 9B.

B. Flora and Fauna: The vegetation cover consists of prairie grass, prairie flowers, reasewood and miscellaneous desert growth. No wildlife was observed, but the wildlife in the area probably includes those typical of semi-arid desert land. The area is used for cattle grazing.

C. There are no ponds, lakes or rivers in the area.

D. There are no inhabited dwellings in the vicinity of the proposed well.

E. Surface Ownership: The wellsite is on federal surface.

F. There is no evidence of any aecheological, historical or cultural sites in the area.

12. OPERATOR'S REPRESENTATIVE.

- A. The field representative responsible for assuring compliance with the approved surface use plan is:

Ray Westall
P. O. Box 4
Loco Hills, NM 88255
(505) 677-3113 Office
677-3201 Home

13. CERTIFICATION.

I hereby certify that I, or persons under my direct supervision, have inspected the proposed drillsite and access route, that I am familiar with the conditions which presently exist; that the statements made in this plan are to the best of my knowledge, true and correct; and, that the work associated with the operations proposed herein will be performed by Ray Westall and it's subcontractors in conformity with this plan and the terms and conditions under which it is approved.

DATE

1-5-80

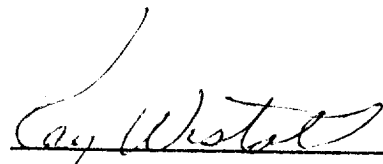
RAY WESTALL, OPERATOR

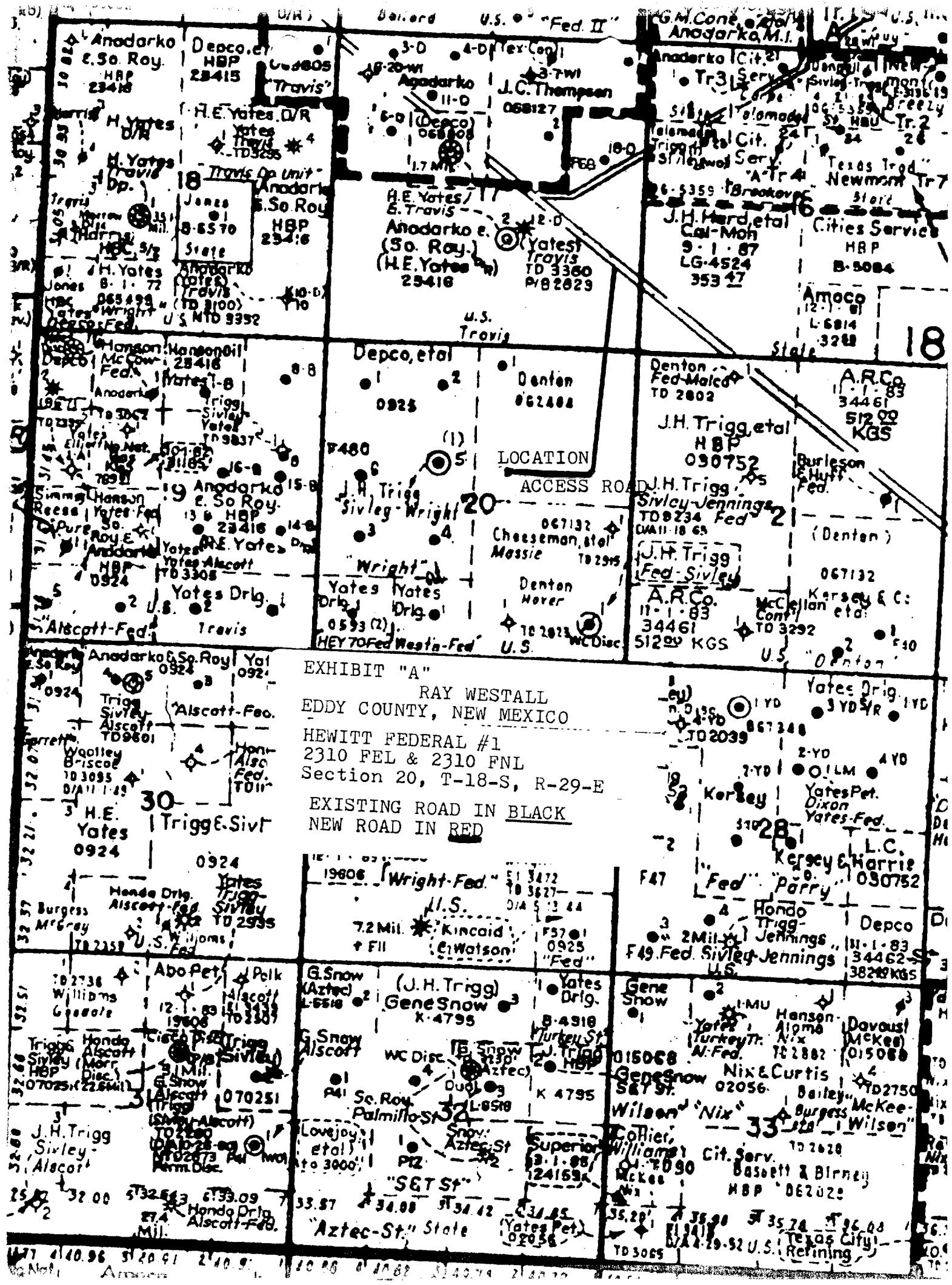

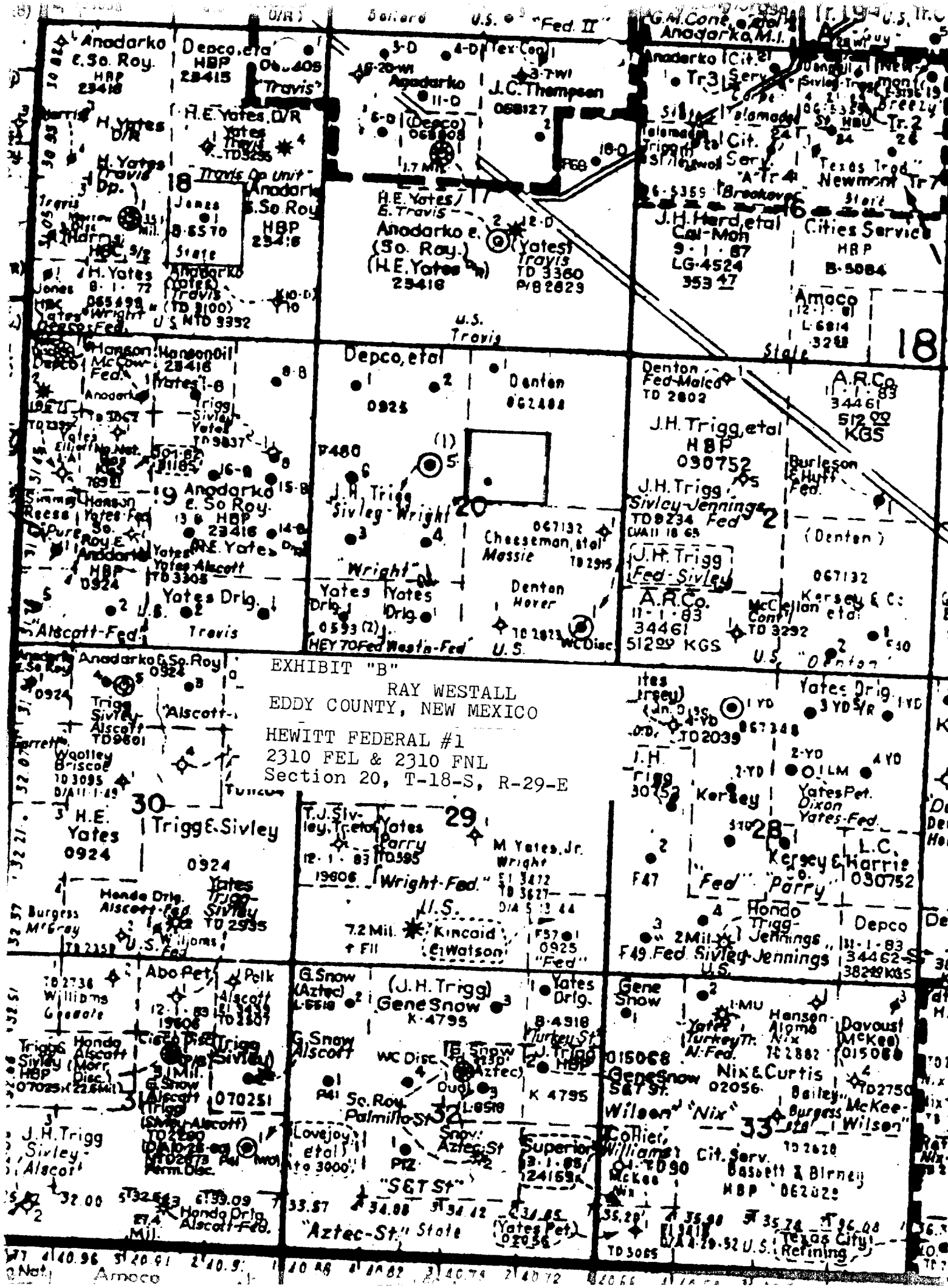

DESIGNATION OF OPERATOR

The undersigned is, on the records of the Bureau of Land Management, holder of lease

DISTRICT LAND OFFICE: Santa Fe
SERIAL NO.: LC 062404

and hereby designates

NAME: Ray Westall
BOX 4
ADDRESS: Loco Hills, New Mexico 88255

as his operator and local agent, with full authority to act in his behalf in complying with the terms of the lease and regulations applicable thereto and on whom the supervisor or his representative may serve written or oral instructions in securing compliance with the Operating Regulations with respect to (describe acreage to which this designation is applicable):

Township 18 South, Range 29 East, N.M.P.M.
Section 20: E/2NE/4, SW/4NE/4, surface to 3500 feet.
NW/4NE/4, 2570 feet to 3500 feet/

It is understood that this designation of operator does not relieve the lessee of responsibility for compliance with the terms of the lease and the Operating Regulations. It is also understood that this designation of operator does not constitute an assignment of any interest in the lease.

In case of default on the part of the designated operator, the lessee will make full and prompt compliance with all regulations, lease terms, or orders of the Secretary of the Interior or his representative.

The lessee agrees promptly to notify the supervisor of any change in the designated operator.

Charles A. Denton
Charles A. Denton

Gladys Kelly M
Gladys Kelly

11-21-1980

(Date)

G.C. Denton
G.C. Denton
Pauline F. Archer Hewitt
(Signature of lessee)
Pauline F. Archer Hewitt

Box 1252

Artesia, New Mexico 88210