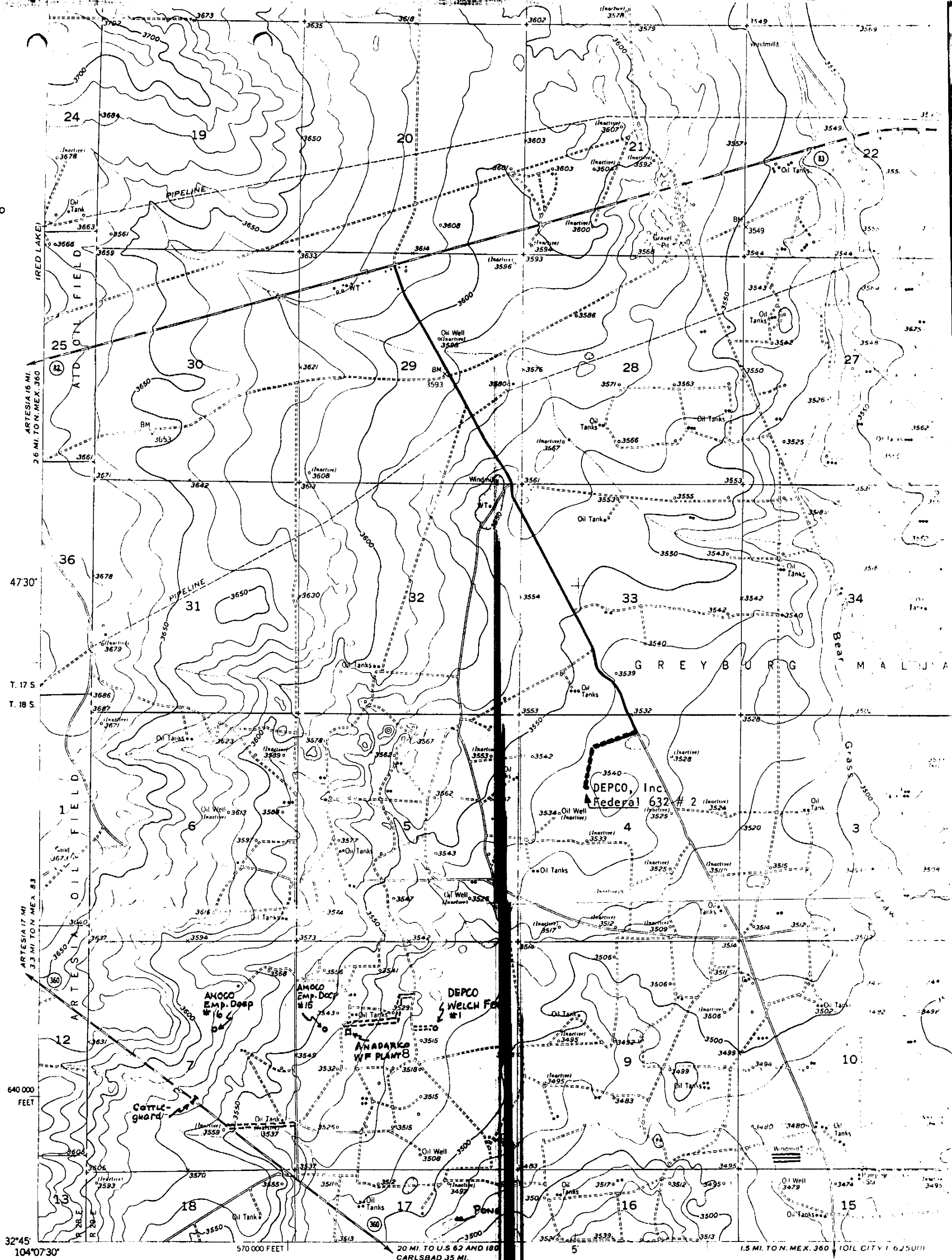

**EXHIBIT A**  
**DEPCO, Inc.**  
**Federal 632 # 2**  
**1650 FN & WL**  
**Sec. 4, T-18S, R-29E**  
**Eddy County, New Mexico**

Existing access road

Proposed access road



Mapped, edited, and published by the Geological Survey  
 Control by USGS and USC&GS

Culture and drainage in part compiled from aerial photographs  
 taken 1946. Topography by planetable surveys 1955

Polyconic projection, 1927 North American datum  
 10,000-foot grid based on New Mexico coordinate system,  
 east zone

All oil wells labeled inactive are dry, capped, or abandoned

TRUE NORTH  
 MAGNETIC NORTH  
 APPROXIMATE MEAN  
 DECLINATION, 1955

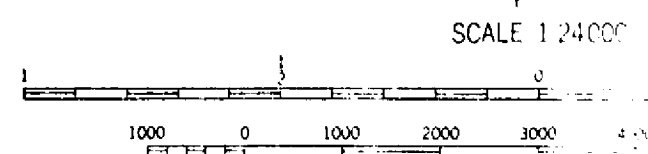

CONTOUR INTERVAL 10 FEET  
 DATUM IS MEAN SEA LEVEL

THIS MAP COMPLIES WITH NATIONAL MAP ACCURACY STANDARDS  
 FOR SALE BY U.S. GEOLOGICAL SURVEY, FEDERAL CENTER, DENVER, COLORADO  
 A FOLDER DESCRIBING TOPOGRAPHIC MAPS AND SYMBOLS IS AVAILABLE