

P. O. BOX 2088

SANTA FE, NEW MEXICO 87501 SEP 25 1981

O. C. D.
ARTESIA, OFFICE

NO. OF COPIES RECEIVED	
DISTRIBUTION	
SANTA FE	1
FILE	1
U.S.G.S.	2
LAND OFFICE	
OPERATOR	1

APPLICATION FOR PERMIT TO DRILL, DEEPEN, OR PLUG BACK

Type of Work

Type of Well DRILL ☒ DEEPEN ☐ PLUG BACK ☐
OIL WELL ☐ GAS WELL ☒ OTHER ☐ SINGLE ZONE ☐ MULTIPLE ZONE ☐

Name of Operator

Yates Petroleum Corporation

Address of Operator

207 South 4th Street, Artesia, NM 88210

Location of Well

UNIT LETTER K LOCATED 1980 FEET FROM THE South LINE

2310 FEET FROM THE West LINE OF SEC. 23 TWP. 18s RGE. 25e NADP

5A. Indicate Type of Lease

STATE ☐ FEE ☒

5. State Oil & Gas Lease No.

7. Unit Agreement Name

8. Farm or Lease Name

Connor "RR" Com

9. Well No.

1

10. Field and Pool, or Wildcat

Unders. ^{West} Atoka Morrow

12. County

Eddy

19. Proposed Depth	19A. Formation	20. Rotary or C.T.
Approx. 9000	Morrow	Rotary
21A. Kind & Status Plug. Bond	21B. Drilling Contractor	22. Approx. Date Work will start
Blanket	Landis Rig #4	ASAP

PROPOSED CASING AND CEMENT PROGRAM

SIZE OF HOLE	SIZE OF CASING	WEIGHT PER FOOT	SETTING DEPTH	SACKS OF CEMENT	EST. TOP
17 1/2"	13 3/8"	48# J-55	Approx. 400'	350	circulate
12 1/4"	8 5/8"	24# J-55	Approx. 1200'	850	circulate
7 7/8"	5 1/2" or 4 1/2"	10.5-17# K-55	TD	300	
		10.5-11.6# K-55			

Propose to drill and test the Morrow & intermediate horizons. Will set approximately 350' surface casing to shut off gravel and cavings. Will set intermediate casing 100' below Artesian Water Zone. Both strings will be circulated with cement. If commercial, will run 5 1/2" or 4 1/2" casing and cement with ' of cover.

MUD PROGRAM: Gel & LCM to 950', Water to 6700', Flosal-Drispak to TD, MW 8.9 - 9.1, Vis. 34-40, WL 12-7.

BOP PROGRAM: BOP's & hydril on 8 5/8" casing, tested daily, Yellow Jacket prior to drilling Wolfcamp.

GAS NOT DEDICATED:

APPROVAL VALID FOR 180 DAYS
PERMIT EXPIRES 3-29-82
UNLESS DRILLING UNDERWAY

BLOW SPACE DESCRIBE PROPOSED PROGRAM: IF PROPOSAL IS TO DEEPEN OR PLUG BACK, GIVE DATA ON PRESENT PRODUCTIVE ZONE AND PROPOSED NEW PRODUCTION ZONE. GIVE BLOWOUT PREVENTER PROGRAM, IF ANY.

I hereby certify that the information above is true and complete to the best of my knowledge and belief.

Shirley K. [Signature] Title Regulatory Manager Date 9-23-81
(This space for State Use)

APPROVED BY W.A. Gressett TITLE SUPERVISOR, DISTRICT II DATE SEP 29 1981

CONDITIONS OF APPROVAL, IF ANY:

Cement must be circulated to
surface behind 13 3/8" & 8 5/8" casingNotify N.M.O.C.C. in sufficient
time to witness cementing
the 8 5/8" casing

NEW MEXICO OIL CONSERVATION COMMISSION
WELL LOCATION AND ACREAGE DEDICATION PLAT

Form C-102
Supersedes C-128
Effective 1-1-65

All distances must be from the outer boundaries of the Section.

Operator YATES PETROLEUM CORPORATION		Lease Conner RR Com		Well No. 1
Unit Letter K	Section 23	Township 18 South	Range 25 East	County Eddy
Actual Footage Location of Well: 1980 feet from the South line and 2310 feet from the West line				
Ground Level Elev. 3491.	Producing Formation MORROW	Pool WEST LINDSAY AREA	Dedicated Acreage: 3.25 Acres	

1. Outline the acreage dedicated to the subject well by colored pencil or hatchure marks on the plat below.
2. If more than one lease is dedicated to the well, outline each and identify the ownership thereof (both as to working interest and royalty).
3. If more than one lease of different ownership is dedicated to the well, have the interests of all owners been consolidated by communitization, unitization, force-pooling, etc?

☒ Yes ☐ No If answer is "yes," type of consolidation COMMUNITIZATION

If answer is "no," list the owners and tract descriptions which have actually been consolidated. (Use reverse side of this form if necessary.) _____

No allowable will be assigned to the well until all interests have been consolidated (by communitization, unitization, forced-pooling, or otherwise) or until a non-standard unit, eliminating such interests, has been approved by the Commission.

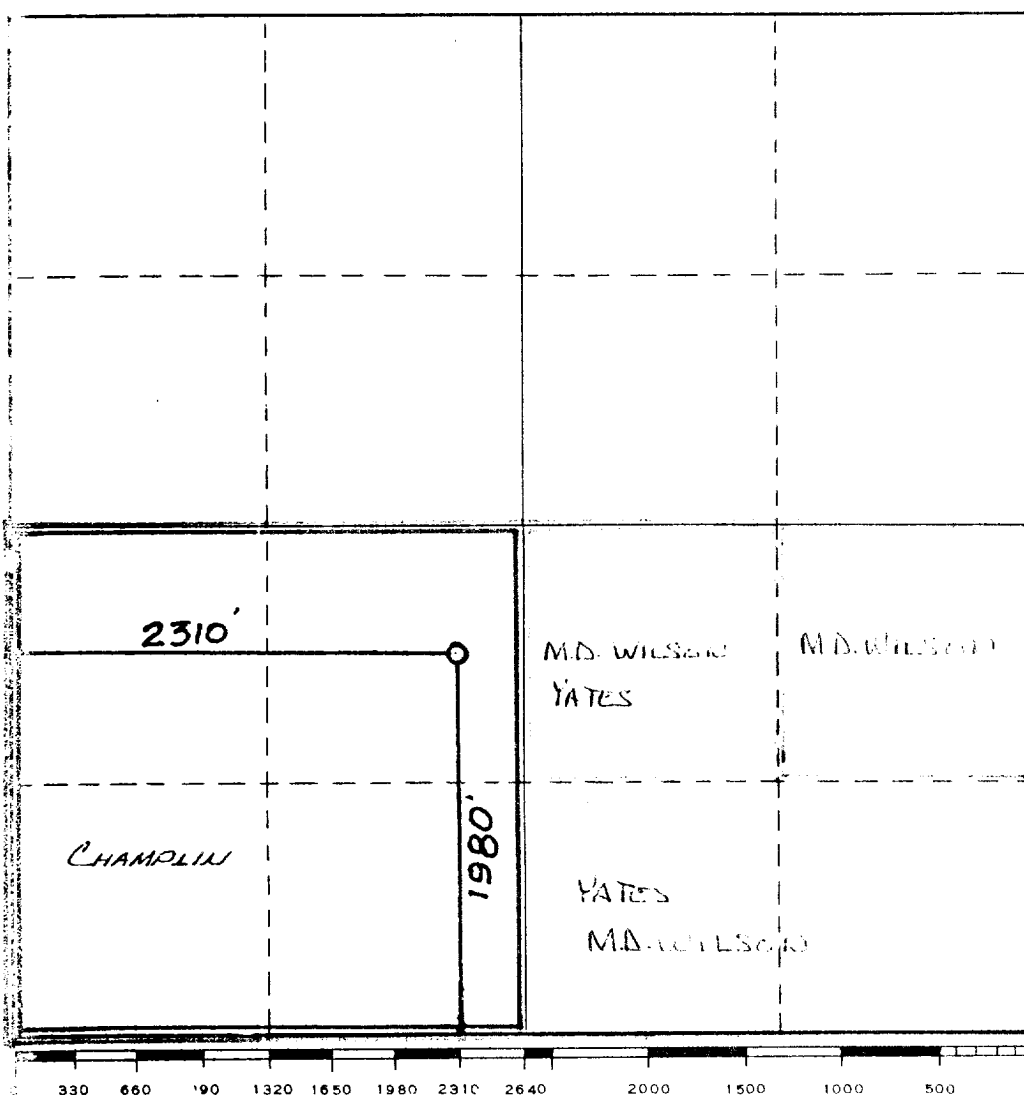

CERTIFICATION

I hereby certify that the information contained herein is true and complete to the best of my knowledge and belief.

Name
GLISERIO RODRIGUEZ
Position
REG. MGR.
Company
YATES PETROLEUM CORP.
Date
9-15-81

I hereby certify that the well location shown on this plat was plotted from field notes of actual surveys made by me or under my supervision, and that the same are correct to the best of my knowledge and belief.

Date Surveyed
September 12, 1981
Registered Professional Engineer and/or Land Surveyor

Dan R. Reddy
Certificate No.
NM PE&LS #5412

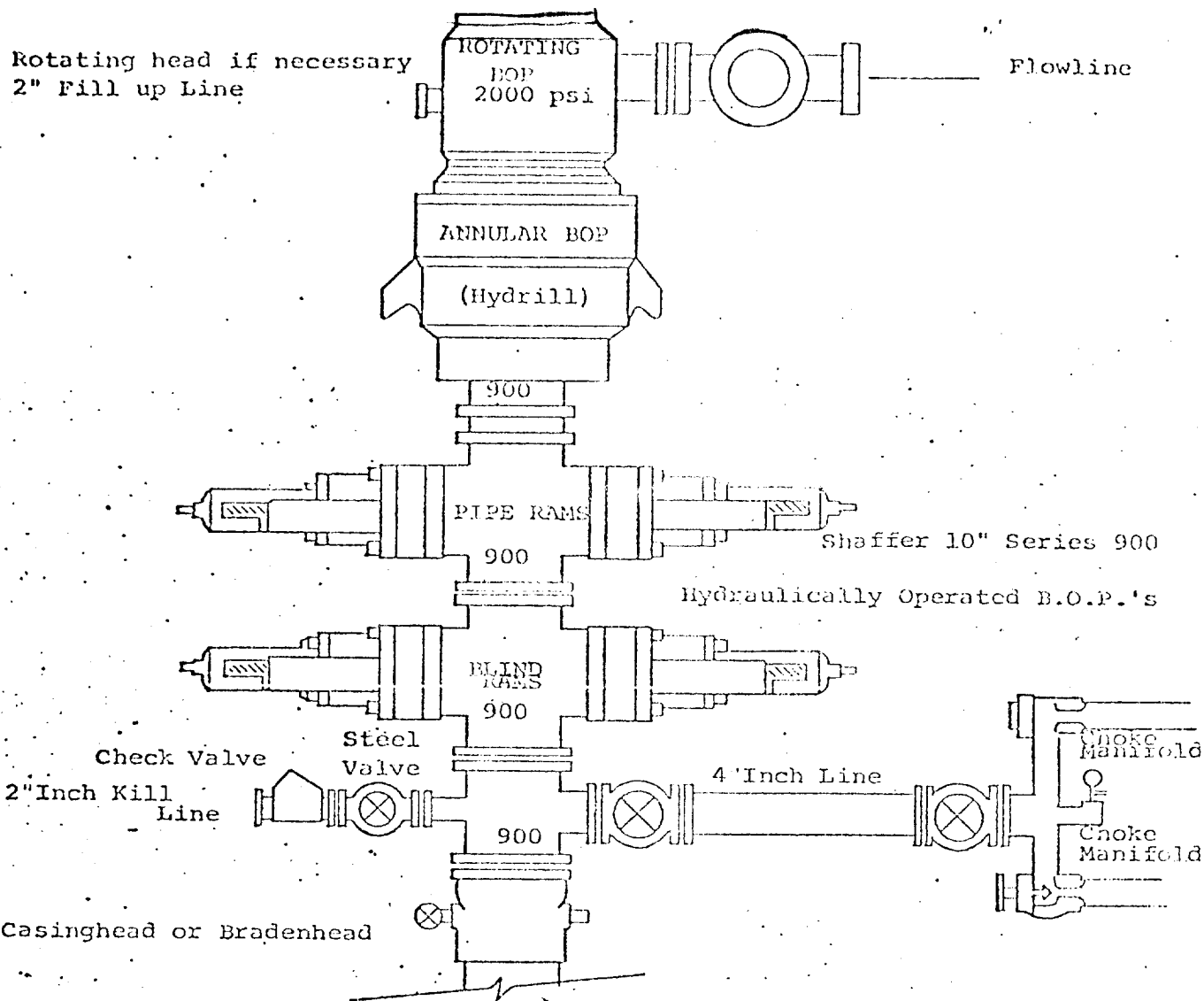

THE FOLLOWING CONSTITUTE MINIMUM BLOWOUT PREVENTER REQUIREMENTS

1. All preventers to be hydraulically operated with secondary manual controls installed prior to drilling out from under casing.
2. Choke outlet to be a minimum of 4" diameter.
3. Kill line to be of all steel construction of 2" minimum diameter.
4. All connections from operating manifolds to preventers to be all steel. hole or tube a minimum of one inch in diameter.
5. The available closing pressure shall be at least 15% in excess of that required with sufficient volume to operate the B.O.P.'s.
6. All connections to and from preventer to have a pressure rating equivalent to that of the B.O.P.'s.
7. Inside blowout preventer to be available on rig floor.
8. Operating controls located a safe distance from the rig floor.
9. Hole must be kept filled on trips below intermediate casing. Operator not responsible for blowouts resulting from not keeping hole full.
10. D. P. float must be installed and used below zone of first gas intrusion.