

MEXICO OIL CONSERVATION COMMISSION  
WELL LOCATION AND ACREAGE DEDICATION PLAT

RECEIVED BY

Form C-102  
Supersedes C-128  
Effective 1-1-65

All distances must be from the outer boundaries of the Section

SEP 02 1983

Operator <del>RAY WESTALL</del> <i>Forister &amp; Swift</i>		Lease Hewitt Federal		Well No. 2	
Unit Letter H	Section 20	Township 18 South	Range 29 East	County ARTESIA, OFFICE	

Actual Footage Location of Well: 2080 feet from the North line and 560 feet from the East line					
Ground Level Elev. 3523.	Producing Formation Yates	Pool Undesignated Travis Yates Gas Pool	Dedicated Acreage: 80 Acres		

1. Outline the acreage dedicated to the subject well by colored pencil or hachure marks on the plat below.
2. If more than one lease is dedicated to the well, outline each and identify the ownership thereof (both as to working interest and royalty).
3. If more than one lease of different ownership is dedicated to the well, have the interests of all owners been consolidated by communitization, unitization, force-pooling, etc?

☐ Yes ☒ No If answer is "yes," type of consolidation \_\_\_\_\_

If answer is "no," list the owners and tract descriptions which have actually been consolidated. (Use reverse side of this form if necessary.) \_\_\_\_\_

No allowable will be assigned to the well until all interests have been consolidated (by communitization, unitization, forced-pooling, or otherwise) or until a non-standard unit, eliminating such interests, has been approved by the Commission.

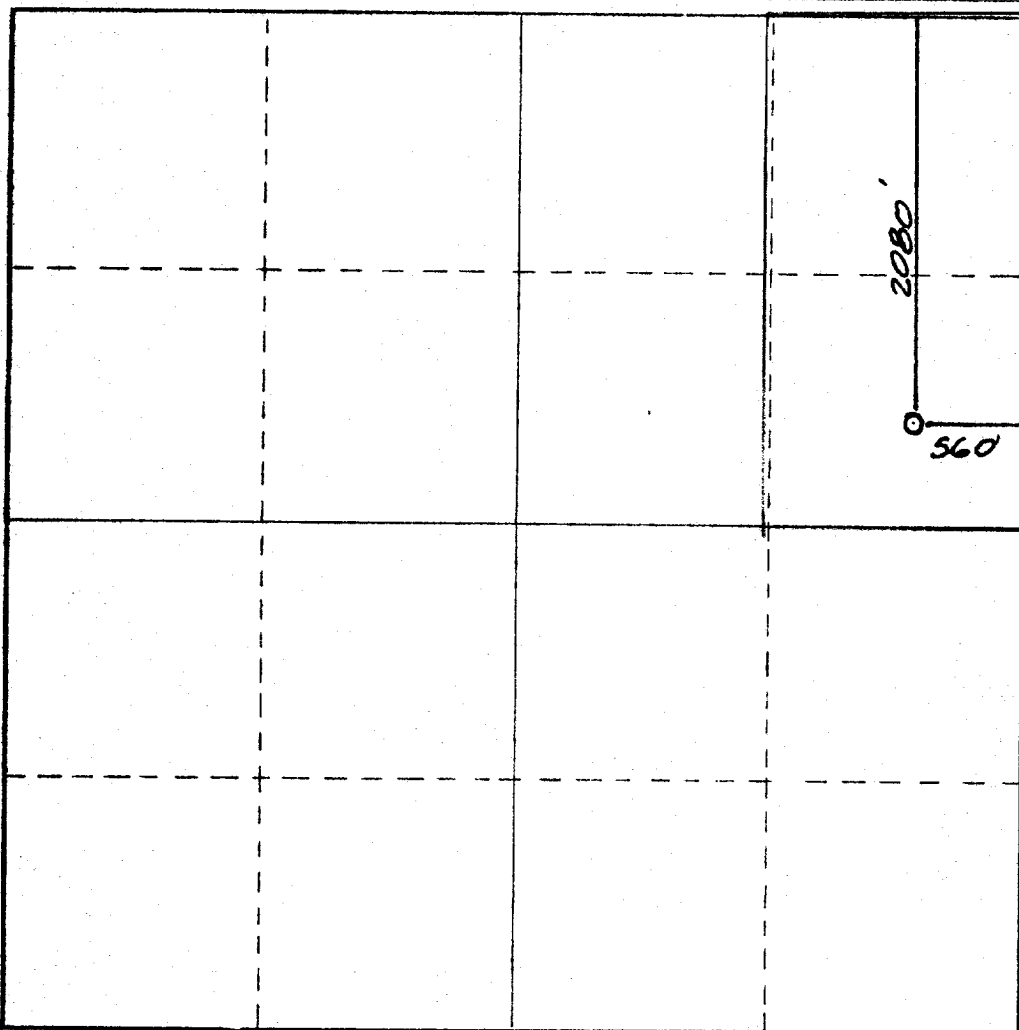

CERTIFICATION

I hereby certify that the information contained herein is true and complete to the best of my knowledge and belief.

Name <i>Ray Westall</i>
Position Operator
Company Ray Westall
Date 11-11-81

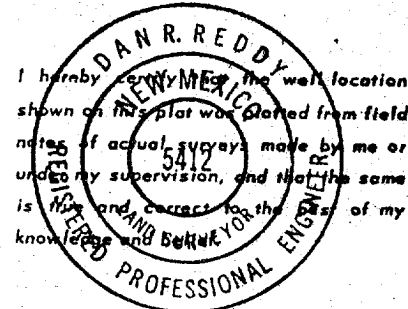

Date Surveyed November 4, 1981
Registered Professional Engineer and/or Land Surveyor <i>Dan R. Reddy</i>
Certificate No. NM PE&LS #5412

0 330 660 990 1320 1650 1980 2310 2640 2970 3300 3630 3960 4290 4620 4950 5280 5610 5940 6270 6600