

NO. OF COPIES RECEIVED	
DISTRIBUTION	
ANTA FE	
FILE	
U.S.G.S.	
LAND OFFICE	
OPERATOR	

NEW MEXICO OIL CONSERVATION COMMISSION

RECEIVED

30-015-24077

Form C-101
Revised 1-1-65

JAN 27 1982

O. C. D.
ARTESIA, OFFICE

5A. Indicate Type of Lease
STATE <input type="checkbox"/> FEE <input checked="" type="checkbox"/>

5. State Oil & Gas Lease No.

APPLICATION FOR PERMIT TO DRILL, DEEPEN, OR PLUG BACK

1a. Type of Work		2. Lease Agreement Name	
b. Type of Well DRILL <input checked="" type="checkbox"/> DEEPEN <input type="checkbox"/> PLUG BACK <input type="checkbox"/> OIL WELL <input type="checkbox"/> GAS WELL <input checked="" type="checkbox"/> OTHER <input type="checkbox"/> SINGLE ZONE <input checked="" type="checkbox"/> MULTIPLE ZONE <input type="checkbox"/>		3. Name of Lessee Name	
c. Name of Operator		4. Well No.	
Read & Stevens, Inc.		1	
d. Address of Operator		6. Field and Loc. or Section	
P.O. Box 1518, Roswell, NM 88201		1-21-22-23-24-25-26-27-28-29-30	
e. Location of Well		7. County	
UNIT LETTER F LOCATED 1980 FEET FROM THE West LINE		Eddy	
AND 1980 FEET FROM THE North LINE OF SEC. 30 TWP. 18S RGE. 27E SPM			
8. Elevations (Show whether L.P., R.P., etc.)		9A. Formation	9B. Rotary or C.T.
3279.3' GL		10,000	Morrow Rotary
21A. Kind & Status Plug, Bond	21B. Estimated Cost of Work	22. Approx. Date Work will start	
Statewide	Sierra Drilling Co.	Feb. 15, 1982	

PROPOSED CASING AND CEMENT PROGRAM

SIZE OF HOLE	SIZE OF CASING	WEIGHT PER FOOT	SETTING DEPTH	SACKS OF CEMENT	EST. TOP
17 1/2"	13 3/8"	54.5#	360'	400sx	circ.
12 1/2"	8 5/8"	24#	2000'	1000sx	circ.
7 7/8"	5 1/2"	17#	10,000'	900sx	5000'

We propose to penetrate the morrow formation at ±9800'. If a commercial zone is indicated, 5 1/2" production casing will be cemented.

Mud Program: 0-360' Spud mud w/ gel-lime slurry w/34-36 vis.

360'-2000' Fresh water mud 8.4-8.6#/gal, 28 vis.

2000'-10,000' Cut brine mud 9.2-9.6#/gal, 32-34 vis. Reduce fluid loss to 10cc @6400' increase vis to 38-40.

BOP Program: One 11" 5000psi WP Shaffer Annular BOP, one 11" 5000psi WP Type Hydraulic Double BOP, one 90-11S Melco Closing Unit-90gal capacity.

APPROVAL VALID FOR 180 DAYS

82282
OIL FIELD DRILLING UNDERWAY

6. ABOVE SPACE DESCRIBE PROPOSED PROGRAM; IF PROPOSAL IS TO DEEPEN OR PLUG BACK, GIVE DATA ON PRESENT PRODUCTIVE ZONE AND PROPOSED NEW PRODUCTION ZONE. GIVE BLOWOUT PREVENTER PROGRAM, IF ANY.

I hereby certify that the information above is true and complete to the best of my knowledge and belief.

Signed Bruce Stables Title Drilling & Production Mgr Date 1-27-82

(This space for State Use)

APPROVED BY Mike Williams OIL AND GAS INSPECTOR DATE FEB 1 1982

CONDITIONS OF APPROVAL, IF ANY:

Notify N.M.O.C.C. in sufficient

time to allow for inspection

the 8 5/8 casing

Surface hole to 13 3/8 + 8 5/8 casing

**N. MEXICO OIL CONSERVATION COMMISSION
WELL LOCATION AND ACREAGE DEDICATION PLAT**

Form C-102
Supersedes C-128
Effective 1-1-65

All distances must be from the outer boundaries of the Section.

Operator READ & STEVENS, INC.			Lease FAIR		Well No. 1
Unit Letter F	Section 30	Township 18 SOUTH	Range 27 EAST	County EDDY	
Actual Footage Location of Well: <div style="display: flex; justify-content: space-between;"> 1980 feet from the NORTH line and 1980 feet from the WEST line </div>					
Ground Level Elev. 3279.3	Producing Formation Morrow	Pool <i>Red Lake Run</i>		Dedicated Acreage: 321.44 Acres	

1. Outline the acreage dedicated to the subject well by colored pencil or hatchure marks on the plat below.
2. If more than one lease is dedicated to the well, outline each and identify the ownership thereof (both as to working interest and royalty).
3. If more than one lease of different ownership is dedicated to the well, have the interests of all owners been consolidated by communitization, unitization, force-pooling, etc?

☒ Yes ☐ No If answer is "yes," type of consolidation Communitization

If answer is "no," list the owners and tract descriptions which have actually been consolidated. (Use reverse side of this form if necessary.) _____

No allowable will be assigned to the well until all interests have been consolidated (by communitization, unitization, forced-pooling, or otherwise) or until a non-standard unit, eliminating such interests, has been approved by the Commission.

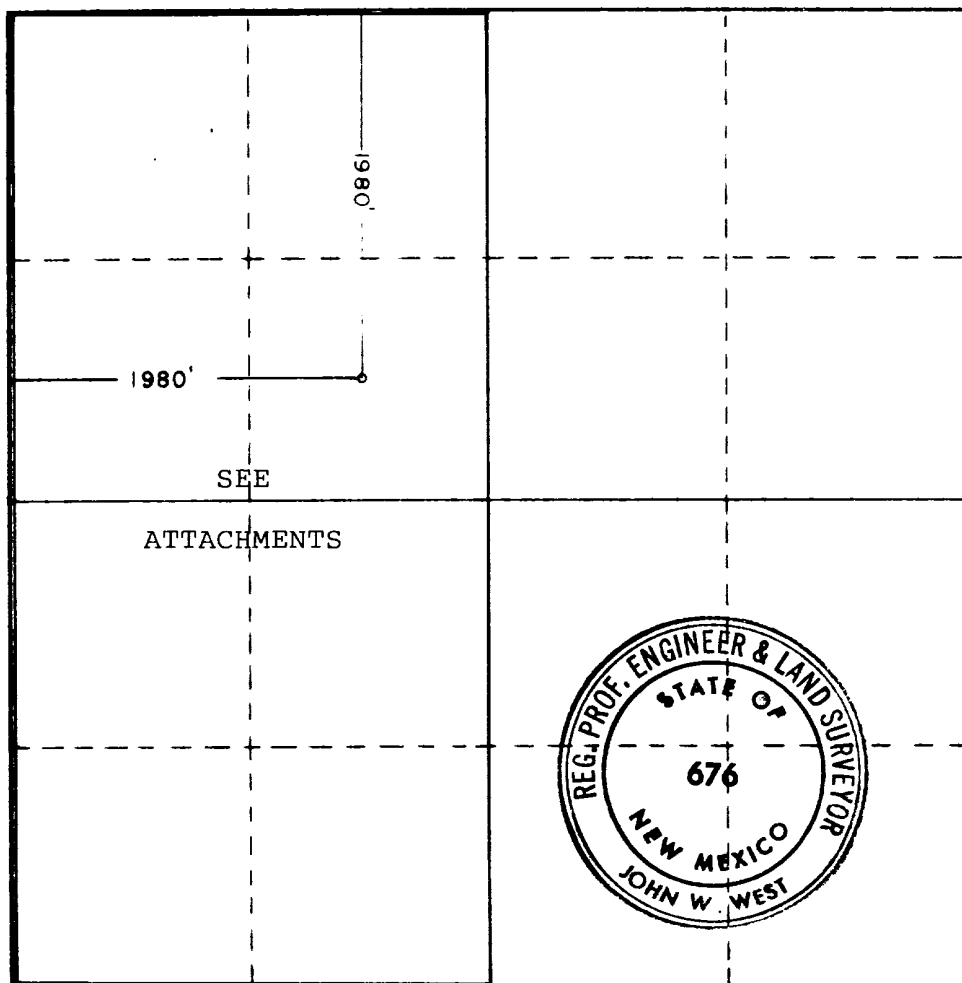

CERTIFICATION

I hereby certify that the information contained herein is true and complete to the best of my knowledge and belief.

Susie Russell

Name

Susie Russell

Position

Authorized Agent

Company

Read & Stevens, Inc.

Date

January 27, 1982

I hereby certify that the well location shown on this plat was plotted from field notes of actual surveys made by me or under my supervision, and that the same is true and correct to the best of my knowledge and belief.

Date Surveyed

1-6-82

Registered Professional Engineer and/or Land Surveyor

John W. West

Certificate No. **JOHN W. WEST 676**
PATRICK A. ROMERO 6863
Barbara J. Sidans 7278

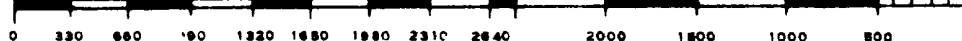

I. TITLE:

Tract A: Township 18 South, Range 27 East, NMPM

Section 30: Lots 1 & 2, less a tract of land
in Lot 2 described as follows:

Beginning at the southeast corner of the SW $\frac{1}{4}$ NW $\frac{1}{4}$ of
Sec. 30, T-18-S, R-27-E, NMPM; thence North 89 degrees
50' West 202.3 feet on subdivision line to pipe number
124; thence North 44 degrees 47' East 287 feet to pipe
number 125; thence South 1' West 204 feet on subdivision
line to the point of beginning, containing .24 acres;

Containing a total of 80.52 acres, more or less.

A. Surface:

Essie Nix. All

B. Minerals:

Lease No.

Fair Oil, Ltd. Unleased. 1/2

Wilton Harold Fair &
James Walton Fair,
Trustees under the
Last Will & Testament
of Mattie Fair, dec. Unleased. 1/2

C. Oil and Gas Leasehold Estate:

All interest unleased.

D. Working Interest:

All interest unleased.

Tract B: Township 18 South, Range 27 East, NMPM (NM-A 28506)

Section 30: E $\frac{1}{2}$ SW $\frac{1}{4}$; and a tract of land in
Lot 2 described as follows:

*Beginning at the Southeast corner of the SW $\frac{1}{4}$ NW $\frac{1}{4}$ of
Sec. 30, T-18-S, R-27-E, NMPM; thence North 89 degrees
50' West 202.3 feet on subdivision line to pipe number
124; thence North 44 degrees 47' East 287 feet to
pipe number 125; thence South 1' West 204 feet on
subdivision line to the point of beginning,
containing .24 acres; and

*A tract of land in the SE $\frac{1}{4}$ NW $\frac{1}{4}$ described as follows:

Beginning at the center of Sec. 30, T-18-S, R-27-E,
NMPM; thence North 89 degrees 50' West 1,318.9 feet
to the Southwest corner of the SE $\frac{1}{4}$ NW $\frac{1}{4}$ of said
section; thence North 1' East 204 feet on subdivision
line to pipe number 125; thence North 44 degrees 47'
East 79.7 feet to pipe number 126; thence North 61
degrees 48' East 553 feet to pipe number 127; thence
South 89 degrees 50' East 776.5 feet to pipe number
128; thence South 522 feet on subdivision line to
point of beginning, containing 13.89 acres; and

*Lot 4, and a tract of land in Lot 3 described as follows:

Beginning at the Southwest corner of the NW $\frac{1}{4}$ SW $\frac{1}{4}$ of
Sec. 30, T-18-S, R-27-E, NMPM; thence North 2 degrees
West 802.3 feet on section line between Sec. 25,
T-18-S, R-26-E, NMPM, and Sec. 30, T-18-S, R-27-E,
NMPM, to pipe number 123; thence North 64 degrees
59' East 1,232.6 feet to pipe number 124; thence
South 89 degrees 50' East on subdivision line
202.3 feet to the Northeast corner of NW $\frac{1}{4}$ SW $\frac{1}{4}$ of said
Sec. 30; thence South 1' West 1,324.1 feet on
subdivision line to the Southeast corner of the
NW $\frac{1}{4}$ SW $\frac{1}{4}$ of said Sec. 30; thence North 89 degrees 53'
West 1,318.3 feet on subdivision line to the point
of beginning, containing 73.51 acres, more or less;

Containing a total of 167.64 acres, more or less.

* -- There is no chain of title into the United States for these tracts. See Paragraph 2 and Requirement 1 of the Exceptions hereof.

A. Surface:

United States. All

B. Minerals (Subject to Oil & Gas Lease NM-A 28506):
Lease No.

United States. 1 . . . All

C. Oil and Gas Leasehold Estate:

United States.12500000 RI

Flag-Redfern Oil Company87500000 WI
1.00000000

D. Record Title to United States Oil and Gas Lease NM-A 28506:

Flag-Redfern Oil Company All

E. Working Interest:

Flag-Redfern Oil Company 100%

Tract C: Township 18 South, Range 27 East, NMPM

Section 30: A tract of land in Lot 3
described as follows:

Beginning at the Southwest corner of the NW $\frac{1}{4}$ SW $\frac{1}{4}$ of Sec. 30, T-18-S, R-27-E, NMPM; thence North 2 degrees West 802.3 feet on section line between Sec. 25, T-18-S, T-26-E, NMPM, and Sec. 30, T-18-S, R-27-E, NMPM, to pipe number 123; thence North 64 degrees 59 minutes East 1,232.6 feet to pipe number 124; thence South 89 degrees 50 minutes East on subdivision line 202.3 feet to the Northeast corner of the NW $\frac{1}{4}$ SW $\frac{1}{4}$ of said Sec. 30; thence South 1 minute West 1,324.1 feet on subdivision line to the Southeast corner of the NW $\frac{1}{4}$ SW $\frac{1}{4}$ of said Sec. 30; thence North 89 degrees 53 minutes West 1,318.3 feet on subdivision line to the point of beginning, containing 7.17 acres, more or less.

A. Surface:

Essie Nix All

B. Minerals:

Lease No.

Essie Nix Unleased . . 1/2

Ralph Nix Unleased . . 1/4

Martin Yates, III Unleased . . 1/4

C. Oil and Gas Leasehold Estate:

All interest unleased.

D. Working Interest:

All interest unleased.

Tract D: Township 18 South, Range 27 East, NMPM

Section 30: Fairchild Farm Lands Tracts
422, 423 & 424, less a tract
of land described as follows:

Beginning at the center of Sec. 30, T-18-S, R-27-E, NMPM; thence North 89 degrees 50 minutes West 1,318.9 feet to the Southwest corner of the SE $\frac{1}{4}$ NW $\frac{1}{4}$ of said section; thence North 1 minute East 204 feet on subdivision line to pipe number 125; thence North 44 degrees 47 minutes East 79.7 feet to pipe number 126; thence North 61 degrees 48 minutes East 553 feet to pipe number 127; thence South 89 degrees 50 minutes East 776.5 feet to pipe number 128; thence South 522 feet on subdivision line to point of beginning, containing 13.89 acres; and Fairchild Farm Lands Tracts 428 and 429;

Containing a total of approximately 14.670 acres, more or less.

A. Surface:

Featherstone Development Corp. . . . All

B. Minerals:

Lease No.

Featherstone Dev. Corp. Unleased. . All

C. Oil and Gas Leasehold Estate:

All interest unleased.

D. Working Interest:

All interest unleased.

Tract E: Township 18 South, Range 27 East, NMPM

Section 30: Fairchild Farm Lands Tract 418,

Containing approximately 5.714 acres, more or less.

A. Surface:

Roy E. Thompson and wife
Elizabeth A. All

B. Minerals (Subject to Oil & Gas Lease):

Lease No.

Roy E. Thompson and wife
Elizabeth A. 2 . . All

C. Oil and Gas Leasehold Estate:

Roy E. Thompson and wife	
Elizabeth A.18750000 RI
Mark D. Wilson81250000 WI
	1.00000000

D. Working Interest:

Mark D. Wilson	100%
--------------------------	------

Tract F: Township 18 South, Range 27 East, NMPM

Section 30: Fairchild Farm Lands Tracts 425 & 426,

Containing approximately 11,428 acres, more or less.

A. Surface:

Heirs and/or devisees of L.C. Heydrick and wife Ida M. Heydrick, who appear to be Jim C. Heydrick, Clyde Jacobs, George Tucker, Mary Budd and husband E.G. Budd; and Y.C. Lee, a widower . . 1/2

Heirs and/or devisees of J.S. Bridwell and wife Thora, who appear to be C.C. Tinsley, Herbert B. Story and Ralph Sterling Bridwell, Co-Trustees of Joseph Bridwell Hood Trust No. 2, Jefferson Frank Hood, Jr., Trust No. 2, Sharon Thora Hood Trust No. 2, Kandy Kay King Trust No. 2, Bonnie Lynn Bowdle Trust No. 2, Alison Gale Bowdle Trust No. 2, Brian Lee Bowdle Trust No. 2, Josephine B. Riley Trust, Margaret B. Bowdle Trust, and J.S. Bridwell Special Trust; and C.J. Tinsley, Herbert B. Story, and The First Wichita National Bank of Wichita Falls, Independent Co-Executors of the Estate and Trustees U/W Margaret B. Bowdle, deceased 1/2

B. Minerals (Subject to Oil and Gas Leases):

Lease No.

Jim C. Heydrick et al.	3	1/2
C.G. Tinsley et al	4	1/2

C. Oil and Gas Leasehold Estate:

Jim C. Heydrick et al	
1/2 x .187509375000 RI
C.G. Tinsley et al	
1/2 x .187509375000 RI
Mark D. Wilson81250000 WI
	1.00000000

D. Working Interest:

Mark D. Wilson 100%

Tract G: Township 18 South, Range 27 East, NMPM

Section 30: Fairchild Farm Lands Tracts 419 & 420,

Containing 11.428 acres, more or less.

A. Surface:

Sava Vuicich 1/6

Violet Fanelli 1/6

Vern M. Vuicich 1/6

Christina Vuicich 1/6

Pauline Stilinovich 1/6

Heirs and/or devisees of
Chris J. Vuicich, deceased,
who appears to be
Clifford Vuicich 1/6

B. Minerals (Subject to Oil and Gas Leases):

Lease No.

Sava Vuicich 5 . . . 1/6

Violet Fanelli 8 . . . 1/6

Vern M. Vuicich 8 . . . 1/6

Christina Vuicich 6 . . . 1/6

Pauline Stilinovich 8 . . . 1/6

Heirs and/or devisees of
Chris J. Vuicich,
who appears to be
Clifford Vuicich 7 . . . 1/6

C. Oil and Gas Leasehold Estate:

Sava Vuicich
1/6 x .187503125000 RI

Violet Fanelli
1/6 x .187503125000 RI

Vern M. Vuicich
1/6 x .187503125000 RI

Christina Vuicich
1/6 x .187503125000 RI

Pauline Stilinovich
1/6 x .187503125000 RI

Heirs and/or devisees of
Chris J. Vuicich

C. (continued):

Mark D. Wilson	.81250000	WI
	1.00000000	

D. Working Interest:

Mark D. Wilson	100%
----------------	------

Tract H: Township 18 South, Range 27 East, NMPM

Section 30: Fairchild Farm Lands Tract 430,

Containing 5.714 acres, more or less.

A. Surface:

Helen Grace Marchant.	All
-----------------------	-----

B. Minerals (Subject to Oil and Gas Lease):

Lease No.

Helen Grace Marchant.	9	All
-----------------------	---	-----

C. Oil and Gas Leasehold Estate:

Helen Grace Marchant.	.18750000	RI
Mark D. Wilson	.81250000	RI
	1.00000000	

D. Working Interest:

Mark D. Wilson	100%
----------------	------

Tract I: Township 18 South, Range 27 East, NMPM

Section 30: Fairchild Farm Lands Tract 421,

Containing 5.714 acres, more or less.

A. Surface:

Rachel Bryan	All
--------------	-----

B. Minerals (Subject to Oil and Gas Lease):

Lease No.

Rachel Bryan	10	All
--------------	----	-----

C. Oil and Gas Leasehold Estate:

Rachel Bryan	.18750000	RI
Mark D. Wilson	.81250000	WI
	1.00000000	

D. Working Interest:

Mark D. Wilson	100%
----------------	------

Tract J: Township 18 South, Range 27 East, NMPM

Section 30: Fairchild Farm Lands Tract 417,

Containing approximately 5.714 acres, more or less.

A. Surface:

Undetermined - See Exception to Title below.

B. Minerals (Partially Subject to Oil and Gas Leases):

Lease No.

Addie Swearingen	20 . . .	1/2
Florence Swearingen for Life, Remainder to Arthur D. Lunblade, George A. Lunblade, Marvin L. Lunblade & Helen Anderson	28 . . .	1/32
Ruby Rogers	27 . . .	1/64
Marion L. Swearingen. . . .	30 . . .	1/64
Pauline R. Swearingen . . .	Unleased. . .	1/64
Homer A. Swearingen	Unleased. . .	3/64
Helen Joyce Hargrave. . . .	Unleased. . .	1/16
First National Bank of Topeka, Trustee for Julie J. Bristline U/A dated 4/28/80	35 . . .	1/96
Vera Hadsell	21 . . .	1/96
Howard Swearingen	24 . . .	1/96
Anna Pauline Swearingen . . .	25 . . .	1/96
Glen Swearingen	23 . . .	1/96
Sheryl S. Collins & husband Craig	13,22 . . .	2/192
Flora Jane Hopkins	Unleased. . .	1/80
Stella P. Herrell	31 . . .	1/80
Birdie F. Coryell	34 . . .	1/80
Gleason Brown	Unleased. . .	1/80
Robert A. Brown	Unleased. . .	1/80
Georgia B. Lafferty	32 . . .	1/64
Louise M. Richardson. . . .	38 . . .	1/64
Ernest L. Redford	40 . . .	1/64

B. (continued):

	<u>Lease No.</u>	
Edna Mae Watt . . .	16 . .	1/64
Charlene Watson . . .	33 . .	1/48
Mayme White . . .	39 . .	1/48
Harrie L. Perry, Jr. . .	29 . .	1/48
Virginia Collier . . .	12 . .	1/80
Elizabeth Major . . .	19 . .	1/80
Robert Collier . . .	Unleased. .	1/80
Nelson Collier . . .	Unleased. .	1/80
James A. Collier . . .	26 . .	1/80

C. Oil and Gas Leasehold Estate:

Addie Swearingen 1/2 x .2187510937500 RI
Florence Swearingen for Life, Remainder to Arthur D. Lunblade, George A. Lunblade, Marvin L. Lunblade & Helen Anderson 1/32 x .2187500683595 RI
Ruby Rogers 1/64 x .2187500341797 RI
Marion L. Swearingen 1/64 x .2187500341797 RI
Pauline R. Swearingen 1/64 x 8/801562500 UMI
Homer A. Swearingen 3/64 x 8/804687500 UMI
Helen Joyce Hargrave 1/16 x 8/806250000 UMI
First National Bank of Topeka, Trustee for Julie J. Bristline U/A dated April 28, 1980 1/96 x .2187500227864 RI
Vera Hadsell 1/96 x .2187500227864 RI
Howard Swearingen 1/96 x .2187500227864 RI
Anna Pauline Swearingen 1/96 x .2187500227864 RI
Glen Swearingen 1/96 x .2187500227864 RI

C. (continued):

Sheryl S. Collins & husband Craig (1/192 x .1875) + (1/192 x .21875)	.00211588 RI
Flora Jane Hopkins 1/80 x 8/8	.01250000 UMI
Stella P. Herrell 1/80 x .21875	.00273438 RI
Birdie F. Coryell 1/80 x .21875	.00273438 RI
Gleason Brown 1/80 x 8/8	.01250000 UMI
Robert A. Brown 1/80 x 8/8	.01250000 UMI
Georgia B. Lafferty 1/64 x .21875	.00341797 RI
Louise M. Richardson 1/64 x .21875	.00341797 RI
Ernest L. Redford 1/64 x .1875	.00292969 RI
Edna Mae Watt 1/64 x .1875	.00292969 RI
Charlene Watson 1/48 x .21875	.00455729 RI
Mayme White 1/48 x .21875	.00455729 RI
Harrie L. Perry, Jr. 1/48 x .21875	.00455729 RI
Virginia Collier 1/80 x .1875	.00234375 RI
Elizabeth Major 1/80 x .1875	.00234375 RI
Robert Collier 1/80 x 8/8	.01250000 UMI
Nelson Collier 1/80 x 8/8	.01250000 UMI
James A. Collier 1/80 x .21875	.00273438 RI
Mark D. Wilson (1/192 + 1/64 + 2/80) x .025	.00114583 ORI
Depco, Inc. ((1/192 + 1/64 + 2/80) x .8125) - .00114583	.03609377 WI
Ricky D. Raindl 1/64 x .8125	.01269531 WI

C. (continued):

Read & Stevens, Inc.
 (1/2 + 1/32 + 4/64 + 5/96 +
 1/192 + 3/80 + 3/48) x .78125 .58675129 WI
 1.00000000

UMI - Unleased Mineral Interest.

D. Working Interest:

Depco, Inc.	4.583333%
Ricky D. Raindl	1.562500%
Read & Stevens, Inc.	75.104167%
Pauline R. Swearingen	1.562500%*
Homer A. Swearingen	4.687500%*
Helen Joyce Hargrave.	6.250000%*
Flora Jane Hopkins	1.250000%*
Gleason Brown	1.250000%*
Robert A. Brown	1.250000%*
Robert Collier	1.250000%*
Nelson A. Collier	<u>1.250000%*</u>
	100.000000%

* - Unleased Mineral Interest.

Tract K: Township 18 South, Range 27 East, NMPM

Section 30: Fairchild Farm Lands Tract 427,

Containing approximately 5.714 acres, more or less.

A. Surface:

Undetermined - See Exception to Title below

B. Minerals (Partially Subject to Oil and Gas Leases):

Lease No.

Addie Swearingen	20 . . .	1/2
Florence Swearingen for Life, Remainder to Arthur D. Lunblade, George A. Lunblade, Marvin L. Lunblade & Helen Anderson	28 . . .	1/32
Ruby Rogers	27 . . .	1/64
Marion L. Swearingen. . .	30 . . .	1/64
Pauline R. Swearingen . .	15 . . .	1/64

B. (continued):

	<u>Lease No.</u>	
Homer A. Swearingen . . .	15	3/64
Helen Joyce Hargrave. . .	Unleased.	1/16
First National Bank of Topeka, Trustee for Julie J. Bristline U/A dated April 28, 1980	Unleased.	1/96
Vera Hadsell . . .	21	1/96
Howard Swearingen . . .	24	1/96
Anna Pauline Swearingen	25	1/96
Glen Swearingen . . .	23	1/96
Sheryl S. Collins & husband Craig . . .	22	2/192
Flora Jane Hopkins . . .	Unleased.	1/80
Stella P. Herrell . . .	36	1/80
Birdie F. Coryell . . .	14	1/80
Gleason Brown . . .	Unleased.	1/80
Robert A. Brown . . .	Unleased.	1/80
Georgia B. Lafferty . . .	11	1/64
Louise M. Richardson. . .	17	1/64
Ernest L. Redford . . .	18	1/64
Edna Mae Watt . . .	16	1/64
Charlene Watson . . .	Unleased.	1/48
Mayme White . . .	39	1/48
Harrie L. Perry, Jr. . .	37	1/48
Virginia Collier . . .	12	1/80
Elizabeth Major . . .	19	1/80
Robert Collier . . .	Unleased.	1/80
Nelson Collier . . .	Unleased.	1/80
James A. Collier . . .	26	1/80

C. Oil and Gas Leasehold Estate:

Addie Swearingen 1/2 x .2187510937500 RI
Florence Swearingen for Life, Remainder to Arthur D. Lunblade, George A. Lunblade, Marvin L. Lunblade & Helen Anderson 1/32 x .2187500683590 RI

Ruby Rogers 1/64 x .2187500341797 RI
Marion L. Swearingen 1/64 x .2187500341797 RI
Pauline R. Swearingen 1/64 x .187500292969 RI
Homer A. Swearingen 3/64 x .187500878906 RI
Helen Joyce Hargrave 1/16 x 8/806250000 UMI
First National Bank of Topeka, Trustee for Julie J. Bristline U/A dated April 28, 1980 1/96 x 8/801041667 UMI
Vera Hadsell 1/96 x .2187500227865 RI
Howard Swearingen 1/96 x .2187500227865 RI
Anna Pauline Swearingen 1/96 x .2187500227865 RI
Glen Swearingen 1/96 x .2187500227865 RI
Sheryl S. Collins & husband Craig 2/192 x .2187500227865 RI
Flora Jane Hopkins 1/80 x 8/801250000 UMI
Stella P. Herrell 1/80 x .2187500273438 RI
Birdie F. Coryell 1/80 x .187500234375 RI
Gleason Brown 1/80 x 8/801250000 UMI
Robert A. Brown 1/80 x 8/801250000 UMI
Georgia B. Lafferty 1/64 x .187500292969 RI
Louise M. Richardson 1/64 x .187500292969 RI
Ernest L. Redford 1/64 x .187500292969 RI
Edna Mae Watt 1/64 x .187500292969 RI
Charlene Watson 1/48 x 8/802083333 UMI

Mayme White	
1/48 x .2187500455729 RI
Harrie L. Perry, Jr.	
1/48 x .2187500455729 RI
Virginia Collier	
1/80 x .187500234375 RI
Elizabeth Major	
1/80 x .187500234375 RI
Robert Collier	
1/80 x 8/801250000 UMI
Nelson Collier	
1/80 x 8/801250000 UMI
James A. Collier	
1/80 x .2187500273438 RI
Mark D. Wilson	
(3/80 + 8/64) x .02500406250 ORI
Depco, Inc.	
[(3/80 + 8/64) x .8125] - .0040625012796875 WI
Read & Stevens, Inc.	
(1/2 + 1/32 + 2/64 + 4/96 + 2/192 + 2/48 +	
2/80) x .7812553222656 WI
	<u>1.00000000</u>

UMI - Unleased Mineral Interest

D. Working Interest:

Depco, Inc.	16.250000%
Read & Stevens, Inc.	68.125000%
Helen Joyce Hargrave	6.250000%*
First National Bank of Topeka, Trustee	
for Julie J. Bristline U/A dated April	
28, 1980	1.041667%*
Flora Jane Hopkins	1.250000%*
Gleason Brown	1.250000%*
Robert A. Brown	1.250000%*
Charlene Watson	2.083333%*
Robert Collier	1.250000%*
Nelson Collier	1.250000%*
	<u>100.000000%</u>

* Unleased Mineral Interest

1 40.39	<div>429</div> <div>(H)</div>	<div>417</div> <div>(J)</div>
2 40.37	<div>429</div> <div>(D)</div>	<div>418</div> <div>(E)</div>
	<div>428</div> <div>(K)</div>	<div>419</div> <div>(G)</div>
	<div>427</div> <div>(K)</div>	<div>420</div> <div>(G)</div>
	<div>426</div> <div>(F)</div>	<div>421</div> <div>(I)</div>
	<div>425</div> <div>(D)</div>	<div>422</div> <div>(D)</div>
3 40.35	<div>424</div> <div>(D)</div>	<div>423</div> <div>(D)</div>
4 40.33	<div>(B)</div>	