

30-18-27

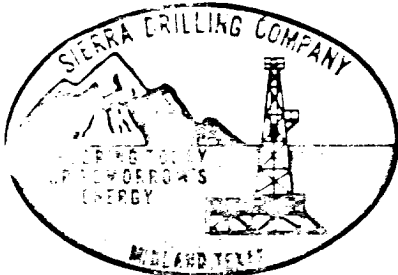

Donald L. Wallace
President

SIERRA DRILLING COMPANY

P. O. Box 2681

Midland, Texas 79702

(915) 563-3477

RECEIVED

SEP 30 1982

O. C. D.
ARTESIA, OFFICE

September 24, 1982

Read & Stevens, Inc.
P. O. Box 1518
Roswell, NM 88201

Re: Fair , No. 1

Gentlemen:

The following is a Deviation Survey of the above referenced well located in Eddy County, New Mexico.

500' - $3\frac{1}{4}^{\circ}$	7164' - $2\frac{1}{2}^{\circ}$
1808' - $2\frac{1}{2}^{\circ}$	7510' - $2\frac{1}{2}^{\circ}$
2200' - 2°	7823' - 2°
3200' - 2°	7917' - $2\frac{1}{2}^{\circ}$
3707' - 2°	7979' - $2\frac{1}{2}^{\circ}$
4545' - 2°	8289' - $2\frac{1}{2}^{\circ}$
4807' - $3\frac{1}{2}^{\circ}$	8602' - $1\frac{1}{4}^{\circ}$
4870' - $3\frac{1}{2}^{\circ}$	8916' - $1\frac{1}{4}^{\circ}$
5090' - $3\frac{1}{2}^{\circ}$	9196' - 1°
5621' - $3\frac{1}{4}^{\circ}$	9242' - No Picture
5903' - $2-3\frac{1}{4}''$	9282' - $1\frac{1}{2}^{\circ}$
6150' - 2°	9466' - No Picture
6914' - 2	9664' - $1\frac{1}{2}^{\circ}$

Sincerely,

SIERRA DRILLING COMPANY

Ray Talley

Ray Talley
Controller

STATE OF TEXAS)
COUNTY OF MIDLAND)

The foregoing was acknowledged before me this 24th day of September, 1982.



Milly Wilson
Notary Public, State of Texas
My Commission Expires 12/23/85

Milly Wilson
Notary Public

NEW MEXICO OIL CONSERVATION COM STON
WELL LOCATION AND ACREAGE DEDICATION PLAT

Form C-102
Supersedes C-128
Effective 1-4-65

All distances must be from the outer boundaries of the Section

Operator READ & STEVENS, INC.			Lease FAIR		Well No. 1
Section Letter F	Section 30	Township 18 SOUTH	Range 27 EAST	County EDDY	
Actual Footage Location of Well: 1980 feet from the NORTH line and 1980 feet from the WEST line					
Ground Level Elev. 3279.3	Producing Formation Yeso		Pool Wildcat Yeso	Dedicated Acreage: 40 Acres	

1. Outline the acreage dedicated to the subject well by colored pencil or hatchure marks on the plat below.
2. If more than one lease is dedicated to the well, outline each and identify the ownership thereof (both as to working interest and royalty).
3. If more than one lease of different ownership is dedicated to the well, have the interests of all owners been consolidated by communitization, unitization, force-pooling, etc?

☒ Yes ☐ No If answer is "yes," type of consolidation Communitization

If answer is "no," list the owners and tract descriptions which have actually been consolidated. (Use reverse side of this form if necessary.)

No allowable will be assigned to the well until all interests have been consolidated (by communitization, unitization, forced-pooling, or otherwise) or until a non-standard unit, eliminating such interests, has been approved by the Commission.

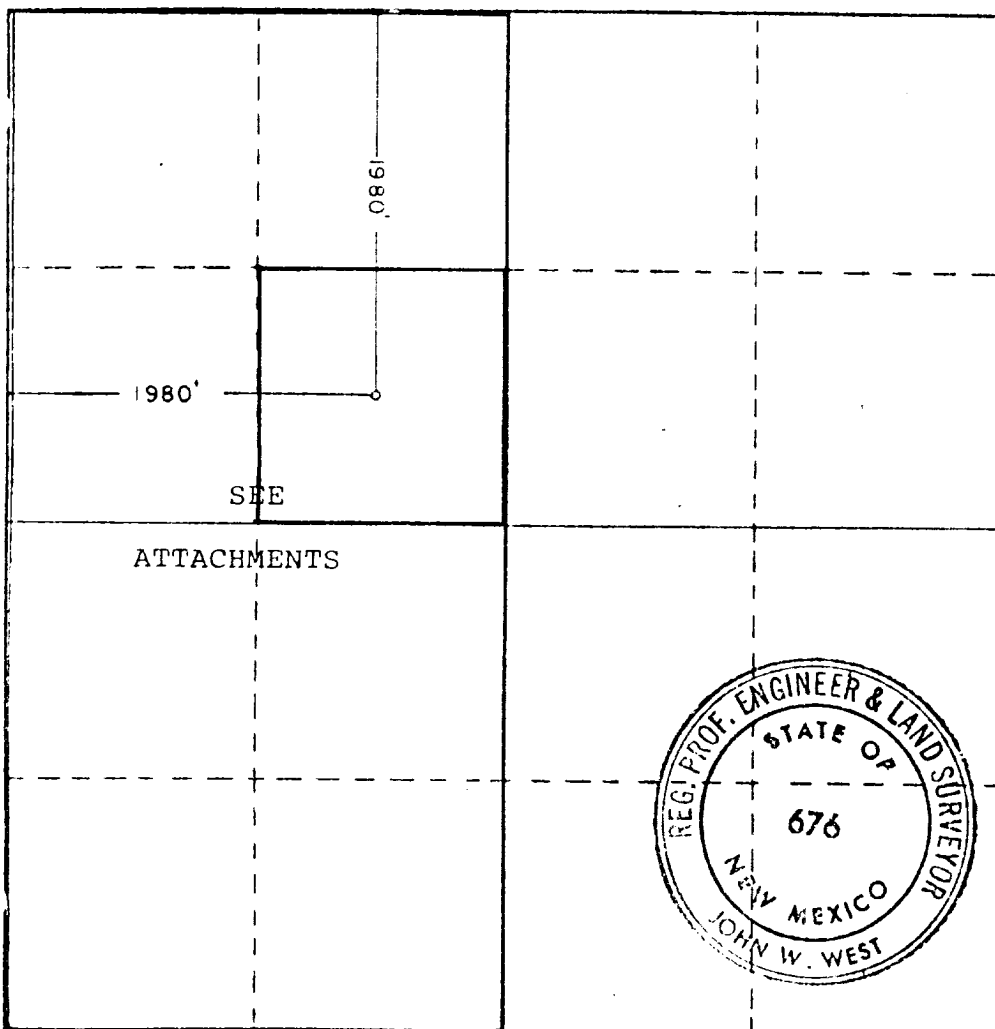

CERTIFICATION

I hereby certify that the information contained herein is true and complete to the best of my knowledge and belief.

Susie Russell

Name

Susie Russell

Position

Authorized Agent

Company

Read & Stevens, Inc.

Date

January 27, 1982

I hereby certify that the well location shown on this plat was plotted from field notes of actual surveys made by me or under my supervision, and that the same is true and correct to the best of my knowledge and belief.

Date Surveyed

1-6-82

Registered Professional Engineer and/or Land Surveyor

John W. West

Certificate No. **JOHN W. WEST 676**
PATRICK A. ROMERO 6663
Ronald J. Fiddan 6270

