

All distances must be from the outer boundaries of the Section.

Operator Depco, Inc.		Lease Federal 384		Well No. #1
Well Letter B	Section 4	Township 18 South	Range 29 East	County Eddy County
Actual Postage Location of Well:				
990 feet from the North line and		2300 feet from the East line		
Ground Level Elev. 3530	Producing Formation Grayburg	Pool Loco Hills(Q., Gbr., S.A.)	Dedicated Acreage: 40 Acres	

1. Outline the acreage dedicated to the subject well by colored pencil or hatchure marks on the plat below.
2. If more than one lease is dedicated to the well, outline each and identify the ownership thereof (both as to working interest and royalty).
3. If more than one lease of different ownership is dedicated to the well, have the interests of all owners been consolidated by communitization, unitization, force-pooling, etc?

☐ Yes ☐ No If answer is "yes," type of consolidation _____

If answer is "no," list the owners and tract descriptions which have actually been consolidated. (Use reverse side of this form if necessary.) _____

No allowable will be assigned to the well until all interests have been consolidated (by communitization, unitization, forced-pooling, or otherwise) or until a non-standard unit, eliminating such interests, has been approved by the Division.

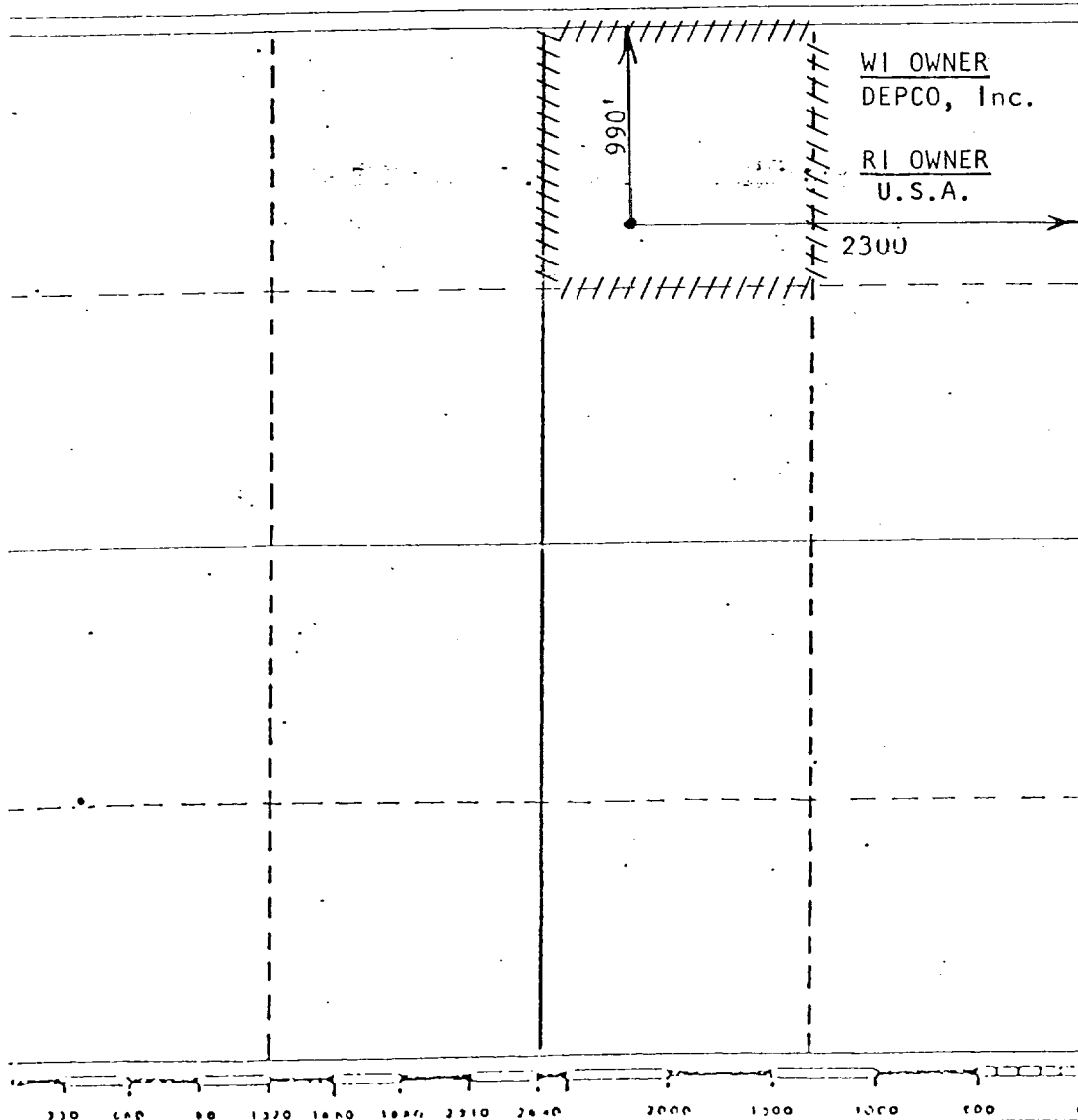

CERTIFICATION

I hereby certify that the information contained herein is true and complete to the best of my knowledge and belief.

R.L. Denney

Name

R.L. Denney

Position

Chief Production Clerk

Company

DEPCO, Inc.

Date

1-12-82

I hereby certify that the well location shown on this plat was plotted from field notes of actual surveys made by me or under my supervision, and that the same is true and correct to the best of my knowledge and belief.

JOHN D. JAQUESS

Date Surveyed NEW MEXICO
December 22, 1981

Professional Engineer
and Surveyor
JOHN D. JAQUESS P.E. & L.S.

Certificate No. 6290