

All distances must be from the outer boundaries of the Section.

Operator YATES PETROLEUM CORPORATION			Lease Benson Deep Federal ET Com		Well No. AUG 29 '881
Unit Letter B	Section 33	Township 18 South	Range 30 East	County Eddy	
Actual Footage Location of Well: 660 feet from the North line and 1980 feet from the East line					ARTESIA, OFFICE
Ground Level Elev. 3484.7'	Producing Formation Bone Springs	Pool South Leo Bone Springs		Dedicated Acreage: 40 Acres	

1. Outline the acreage dedicated to the subject well by colored pencil or hachure marks on the plat below.
2. If more than one lease is dedicated to the well, outline each and identify the ownership thereof (both as to working interest and royalty).
3. If more than one lease of different ownership is dedicated to the well, have the interests of all owners been consolidated by communitization, unitization, force-pooling, etc?

☐ Yes ☒ No If answer is "yes," type of consolidation _____

If answer is "no," list the owners and tract descriptions which have actually been consolidated. (Use reverse side of this form if necessary.) _____

No allowable will be assigned to the well until all interests have been consolidated (by communitization, unitization, forced-pooling, or otherwise) or until a non-standard unit, eliminating such interests, has been approved by the Division.

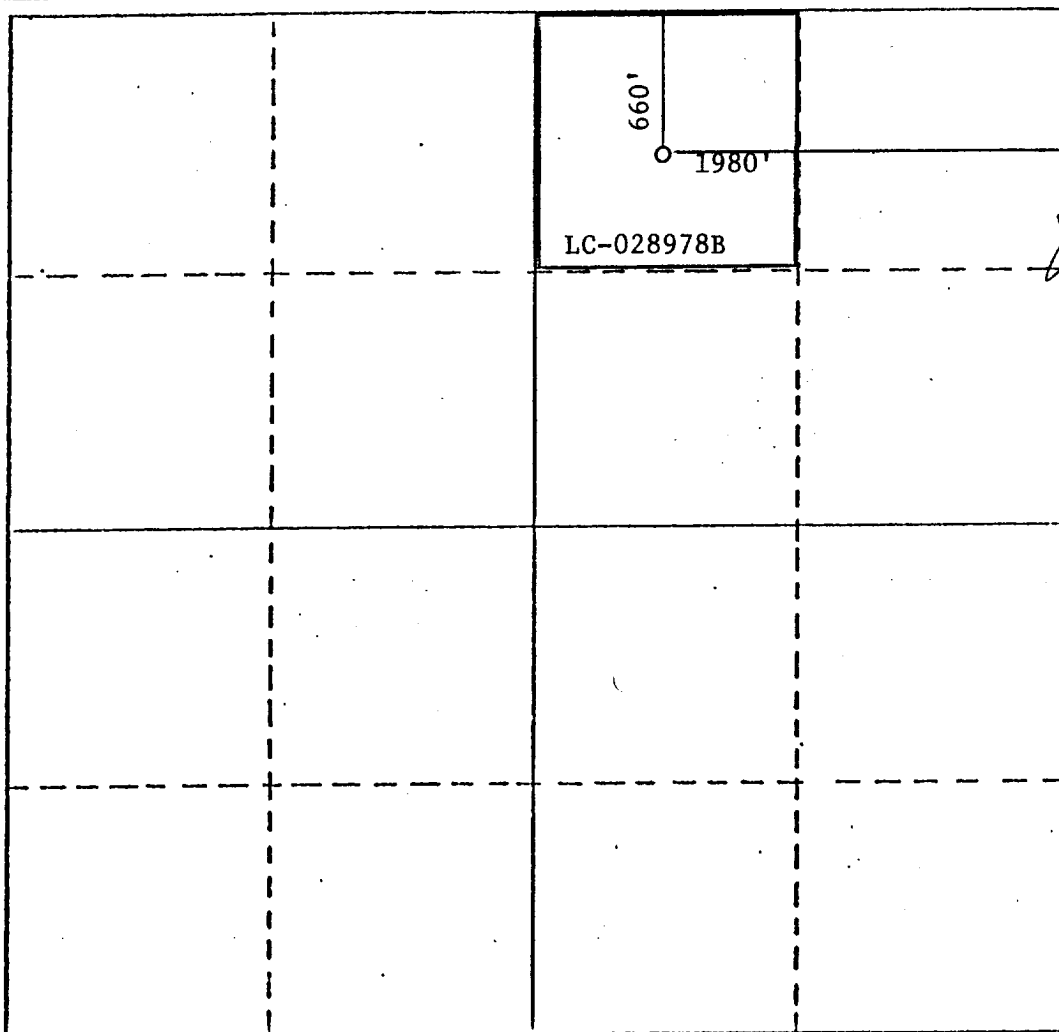

CERTIFICATION

I hereby certify that the information contained herein is true and complete to the best of my knowledge and belief.

Juanita Goodlett
Name

Juanita Goodlett

Position
Production Supervisor

Company
Yates Petroleum Corporation

Date
8-24-88

I hereby certify that the well location shown on this plat was plotted from field notes of actual surveys made by me or under my supervision, and that the same is true and correct to the best of my knowledge and belief.

Refer to original plat
Date Surveyed dated 10/14/82

Registered Professional Engineer
and/or Land Surveyor

Certificate No.

