

UNITED STATES  
DEPARTMENT OF THE INTERIOR  
BUREAU OF LAND MANAGEMENT

SUBMIT IN ~~REVERSE~~ SIDE  
(Other instructions on reverse side)

Form approved.  
Budget Bureau No. 1004-0136  
Expires August 31, 1985

JAN 22 1992

O. C. D.

APPLICATION FOR PERMIT TO DRILL, DEEPEN, OR PLUG BACK

1a. TYPE OF WORK

DRILL ☐

DEEPEN ☐

PLUG BACK ☐

b. TYPE OF WELL

OIL WELL ☐

GAS WELL ☒

OTHER RECOMPLETION

SINGLE ZONE ☐

MULTIPLE ZONE ☐

2. NAME OF OPERATOR

YATES PETROLEUM CORPORATION

3. ADDRESS OF OPERATOR

105 South 4th St., Artesia, NM 88210

4. LOCATION OF WELL (Report location clearly and in accordance with any State requirements.)\*

At surface 660' FNL & 1980' FEL, Sec. 33-18S-30E

At proposed prod. zone

API #30-015-24330

14. DISTANCE IN MILES AND DIRECTION FROM NEAREST TOWN OR POST OFFICE\*

15. DISTANCE FROM PROPOSED\*

LOCATION TO NEAREST  
PROPERTY OR LEASE LINE, FT.  
(Also to nearest drig. unit line, if any)

18. DISTANCE FROM PROPOSED LOCATION\*

TO NEAREST WELL, DRILLING, COMPLETED,  
OR APPLIED FOR, ON THIS LEASE, FT.

21. ELEVATIONS (Show whether DF, RT, GR, etc.)

3484.7' GR

23. ~~PROPOSED~~ CASING AND CEMENTING PROGRAM

SIZE OF HOLE	SIZE OF CASING	WEIGHT PER FOOT	SETTING DEPTH	QUANTITY OF CEMENT
17 1/2"	13-3/8"	48#	498'	500 sx (in place)
12 1/4"	8-5/8"	23 & 24#	3546'	4050 sx (in place)
7-7/8"	5-1/2"	20 & 17#	12055'	500 sx (in place)

Well completed in Bone Springs perfs 8318-8440' and are non-commercial. Propose to test Atoka, Strawn and possibly Wolfcamp to obtain commercial production. RBP set @ 10700' w/20' sand on top. Propose to TOH with all equipment. Run bit and scraper to  $\pm$  10600' and POH. RIH w/cement retainer and set above perfs 8318-8440'. Squeeze perfs 8318-8440'. Drill out squeeze and cement. POH. RIH w/retrieving tool and circulate sand off RBP @ 10700'. Pull RBP. (Strawn perfs 10801-10808' open below RBP.) Perforate Atoka 11394-11408' and 11422-11428'. Acidize perfs w/2500 gals 7 1/2% acid. Flow/swab test well. If commercial, will retrieve RBP and produce with Morrow. If production is non-commercial, will move RBP to  $\pm$  11050'. Perforate Strawn 10970-10990'. Acidize Strawn perfs w/1500 gals 15% acid. Swab Strawn zone - if commercial production is obtained, move packer above perfs 10801-10808'. Swab perfs together and test. Will produce, if commercial. If non-commercial, move tools, set RBP 10000'. Perforate Wolfcamp 9574-9946'. Acidize perfs 9574-9946' w/6500 gals 15% acid (3 stages). Swab/test zone. Wolfcamp recompletion will depend on test results.

IN ABOVE SPACE DESCRIBE PROPOSED PROGRAM: If proposal is to deepen or plug back, give data on present productive zone and proposed new productive zone. If proposal is to drill or deepen directionally, give pertinent data on subsurface locations and measured and true vertical depths. Give blowout preventer program, if any.

24.

SIGNATURE

TITLE Production Supervisor

DATE 1-2-92

(This space for Federal or State office use)

PERMIT NO.

APPROVAL DATE

APPROVED BY

TITLE

DATE

CONDITIONS OF APPROVAL, IF ANY:

\*See Instructions On Reverse Side



Submit to Appropriate  
District Office  
State Lease - 4 copies  
Fee Lease - 3 copies

State of New Mexico  
Bureau of Geology, Minerals and Natural Resources Department

Form C-102  
Revised 1-1-89

# OIL CONSERVATION DIVISION

P.O. Box 2088  
Santa Fe, New Mexico 87504-2088

## DISTRICT I

P.O. Box 1980, Hobbs, NM 88240

## DISTRICT II

P.O. Drawer DD, Artesia, NM 88210

## DISTRICT III

1000 Rio Brazos Rd., Aztec, NM 87410

## WELL LOCATION AND ACREAGE DEDICATION PLAT

All Distances must be from the outer boundaries of the section

Operator YATES PETROLEUM CORPORATION			Lease Benson Deep Federal ET Com		Well No. 1
Unit Letter B	Section 33	Township 18-S	Range 30-E	County Eddy	
Actual Footage Location of Well: 660 feet from the North line and 1980 feet from the East line					
Ground level Elev. 3484.7'	Producing Formation Atoka/Strawn/Wolfcamp		Pool Undesignated	Dedicated Acreage: 320 Acres	

1. Outline the acreage dedicated to the subject well by colored pencil or hatchure marks on the plat below.

2. If more than one lease is dedicated to the well, outline each and identify the ownership thereof (both as to working interest and royalty).

3. If more than one lease of different ownership is dedicated to the well, have the interest of all owners been consolidated by communitization, unitization, force-pooling, etc.?

☒ Yes

☐ No

If answer is "yes" type of consolidation Communitized

If answer is "no" list the owners and tract descriptions which have actually been consolidated. (Use reverse side of this form if necessary.)

No allowable will be assigned to the well until all interests have been consolidated (by communitization, unitization, forced-pooling, or otherwise) or until a non-standard unit, eliminating such interest, has been approved by the Division.

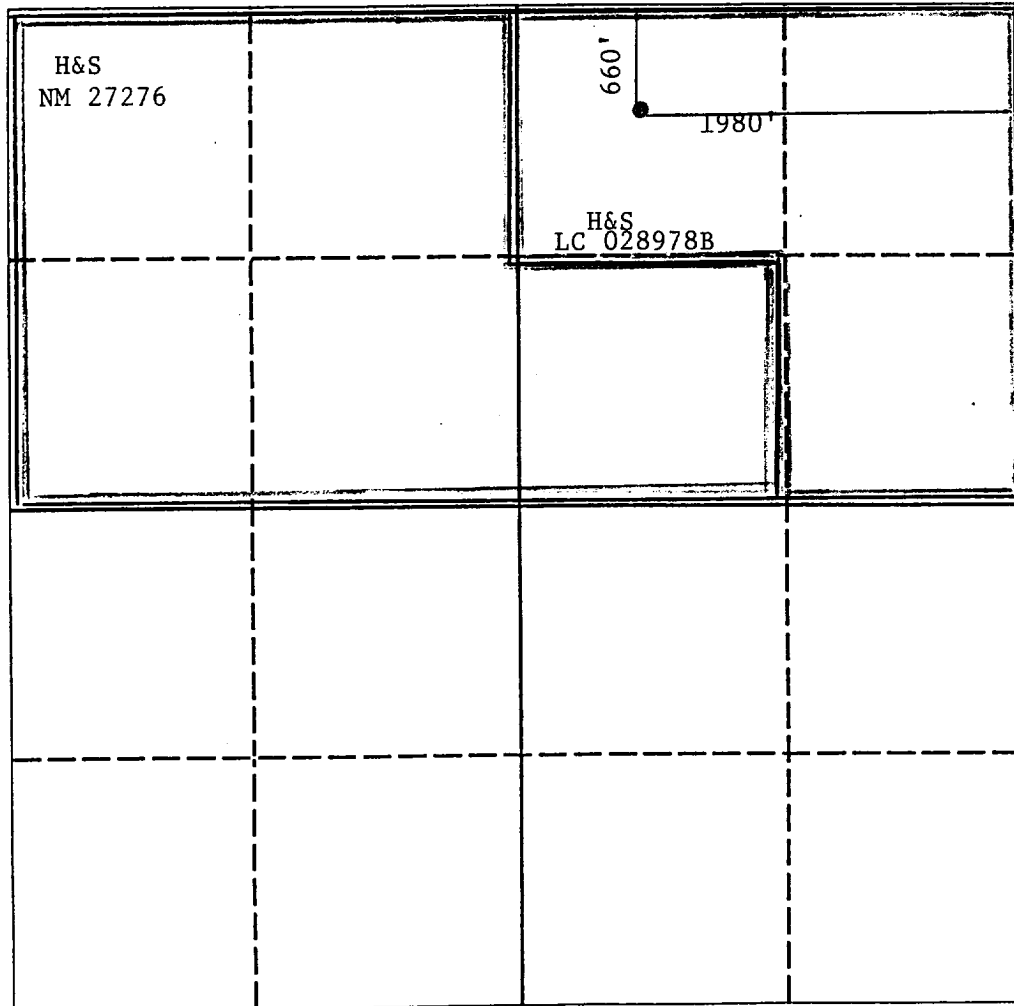

### OPERATOR CERTIFICATION

I hereby certify that the information contained herein is true and complete to the best of my knowledge and belief.

Signature

Printed Name

JUANITA GOODLETT

Position

PRODUCTION SUPERVISOR

Company

YATES PETROLEUM CORPORATION

Date

1-2-92

### SURVEYOR CERTIFICATION

I hereby certify that the well location shown on this plat was plotted from field notes of actual surveys made by me or under my supervision, and that the same is true and correct to the best of my knowledge and belief.

Date Surveyed

Refer to original plat

Signature & Seal of dated 10-14-82  
Professional Surveyor

Certificate No.

0 330 660 990 1320 1650 1980 2310 2640 2000 1500 1000 500 0

