

STATE OF NEW MEXICO
ENERGY AND MINERALS DEPARTMENT

SANTA FE, NEW MEXICO 87.

AMENDED REPORT

All distances must be from the outer boundaries of the Section.

Operator Collier Energy, Inc.			Lease Gilmore		Well No. # 2
Unit Letter N	Section 17	Township 18 South	Range 28 East	County Eddy	
Actual Postage Location of Well: 405 330 feet from the South line and 2310 feet from the West line					
Ground Level Elev. 3607	Producing Formation Queen Gr. San Andres		Pool Artesia Queen GR SA		Dedicated Acreage: 40 Acres

1. Outline the acreage dedicated to the subject well by colored pencil or hachure marks on the plat below.

2. If more than one lease is dedicated to the well, outline each and identify the ownership thereof (both as to working interest and royalty).

3. If more than one lease of different ownership is dedicated to the well, have the interests of all owners been consolidated by communitization, unitization, force-pooling, etc?

☐ Yes ☐ No If answer is "yes," type of consolidation _____

If answer is "no," list the owners and tract descriptions which have actually been consolidated. (Use reverse side of this form if necessary.) _____

No allowable will be assigned to the well until all interests have been consolidated (by communitization, unitization, forced-pooling, or otherwise) or until a non-standard unit, eliminating such interests, has been approved by the Division.

Sec. 17, T.18 S., R.28 E., N.M.P.M.

2310

Moved location 75' to the North.

405'
330'

CERTIFICATION

I hereby certify that the information contained herein is true and complete to the best of my knowledge and belief.

*Cheri Monk*Name
Cheri MonkPosition
SecretaryCompany
Collier Energy, Inc.Date
October 31, 1983

I hereby certify that the well location shown on this plat was plotted from field notes of actual surveys made by me or under my supervision, and that the same is true and correct to the best of my knowledge and belief.

Date Survey
June 11, 1983Notarized Professional Engineer and/or Surveyor
John D. Jaquess, P.E. & L.S.

Certificate No.

6290

NEW MEXICO OIL CONSERVATION COMMISSION

Form C-101
Revised 1-1-65

RECEIVED

JUN 14 1983

O.C.D.

APPLICATION FOR PERMIT TO DRILL, DEEPEN, OR PLUG BACK

ARTESIA, OFFICE

5A. Indicate Type of Lease

STATE ☒FEE ☐

5. State Oil & Gas Lease No.

L-3852

7. Unit Agreement Name

8. Farm or Lease Name

Gilmore State

9. Well No.

#2

10. Field and Pool, or Wildcat

Artesia Queen GR SA

12. County

Eddy

19. Proposed Depth

3000'

19A. Formation

San Andres

20. Rotary or C.T.

Rotary

21. Elevations (Show whether DF, RT, etc.)

3607

21A. Kind & Status Plug. Bond

Statewide

21B. Drilling Contractor

Collier Drilling

22. Approx. Date Work will start

June 15, 1983

23.

PROPOSED CASING AND CEMENT PROGRAM

SIZE OF HOLE	SIZE OF CASING	WEIGHT PER FOOT	SETTING DEPTH	SACKS OF CEMENT	EST. TOP
10 3/4"	8 5/8"	24#	500'	350 sxs	Surface
7 7/8"	5 1/2"	15.5#	3000'	500 sxs	Surface

Plan to spud June 15, 1983, Artesia Queen Grayburg San Andrest test with 10 3/4" bit. Set 500' of 8 5/8", 24# casing, cement to surface with 350 sxs of Class "C" neat. Drill out with 7 7/8" bit with 10# brine to proposed depth of 3000'. If commercial shows are present, 5 1/2", 15.5# casing will be set with 500 sxs Class "C" neat and circulate to surface. If dry hole proper plugs will be set as prescribed by NM OCD.

BOP:

Rig 10 - 10" Manual 3000# Shaffer

or Rig 12 - 10" 5000# SS Cameron Series 1500 - with Koomey 2 stage Accumulator.

APPROVAL VALID FOR 180 DAYS

PERMIT EXPIRES 12-15-83

UNLESS DRILLING UNDERWAY

IN ABOVE SPACE DESCRIBE PROPOSED PROGRAM: IF PROPOSAL IS TO DEEPEN OR PLUG BACK, GIVE DATA ON PRESENT PRODUCTIVE ZONE AND PROPOSED NEW PRODUCTIVE ZONE. GIVE BLOWOUT PREVENTER PROGRAM, IF ANY.

I hereby certify that the information above is true and complete to the best of my knowledge and belief.

Signed Wanda J. Judd Title Production Clerk Date June 14, 1983

(This space for State Use)

APPROVED BY Wanda J. Judd TITLE OIL AND GAS INSPECTORDATE JUN 15 1983

CONDITIONS OF APPROVAL, IF ANY:

All distances must be from the outer boundaries of the Section.

Operator Collier Energy, Inc.			Lease Gilmore State		Well No. # 2
Unit Letter N	Section 17	Township 18 South	Range 28 East	County Eddy	
Actual Postage Location of Well: 330 feet from the South line and 2310 feet from the West line					
Ground Level Elev. 3607	Producing Formation San Andres		Pool Artesia Queen GR SA		Dedicated Acres 40

1. Outline the acreage dedicated to the subject well by colored pencil or hachure marks on the plat below.
2. If more than one lease is dedicated to the well, outline each and identify the ownership thereof (both as to working interest and royalty).
3. If more than one lease of different ownership is dedicated to the well, have the interests of all owners been consolidated by communitization, unitization, force-pooling, etc?

☐ Yes ☐ No If answer is "yes," type of consolidation _____

If answer is "no," list the owners and tract descriptions which have actually been consolidated. (Use reverse side of this form if necessary.) _____

No allowable will be assigned to the well until all interests have been consolidated (by communitization, unitization, forced-pooling, or otherwise) or until a non-standard unit, eliminating such interests, has been approved by the Division.

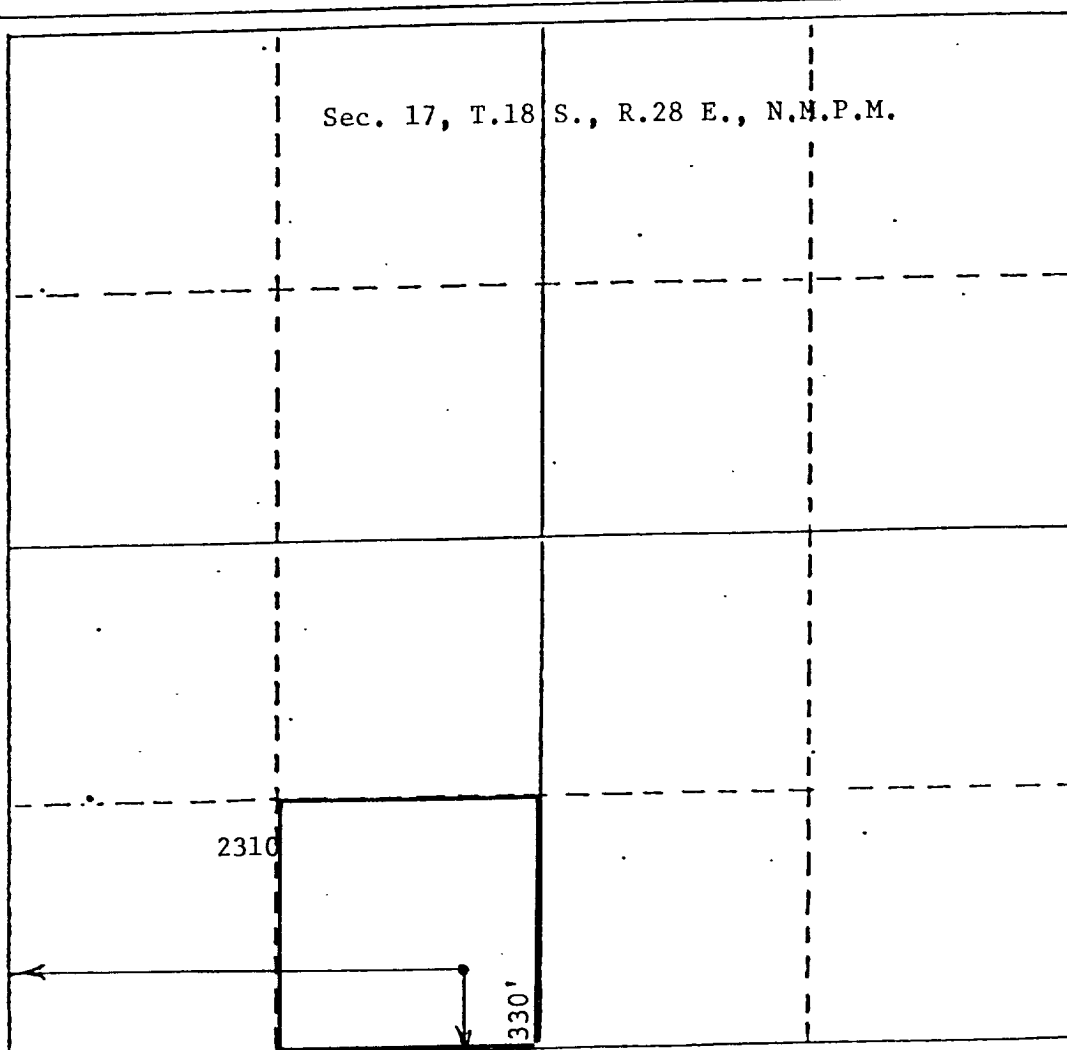

CERTIFICATION

I hereby certify that the information contained herein is true and complete to the best of my knowledge and belief.

Name
Dianna J. J.
Position
Production Clerk
Company
Collier Energy, Inc.
Date
June 14, 1983

I hereby certify that the well location shown on this plat was plotted from field notes of actual surveys made by me or under my supervision, and that the same is true and correct to the best of my knowledge and belief.

Date Surveyed
June 11, 1983
Registered Professional Engineer and/or Land Surveyor
Harold Kersey, PE & LS

Certificate No.
802