

5. NO. OF COPIES RECEIVED	
DISTRIBUTION	
SANTA FE	<input checked="" type="checkbox"/>
FILE	<input checked="" type="checkbox"/>
U.S.G.S.	<input checked="" type="checkbox"/>
LAND OFFICE	<input checked="" type="checkbox"/>
OPERATOR	<input checked="" type="checkbox"/>

RECEIVED BY
OCT 03 1983
O. C. D.
ARTESIA, OFFICE

5A. Indicate Type of Lease
STATE <input type="checkbox"/> FEDERAL <input checked="" type="checkbox"/>
5. State Oil & Gas Lease No.

## APPLICATION FOR PERMIT TO DRILL, DEEPEN, OR PLUG BACK

a. Type of Work		7. Unit Agreement Name	
b. Type of Well DRILL <input checked="" type="checkbox"/> DEEPEN <input type="checkbox"/> PLUG BACK <input type="checkbox"/> OIL WELL <input checked="" type="checkbox"/> GAS WELL <input type="checkbox"/> OTHER <input type="checkbox"/> SINGLE ZONE <input type="checkbox"/> MULTIPLE ZONE <input type="checkbox"/>		8. Farm or Lease Name Dowell "MV"	
c. Name of Operator Yates Petroleum Corporation		9. Well No. 1	
d. Address of Operator 207 S. 4th, Artesia, New Mexico 88210		10. Field and Pool or Wildcat Unds. Atoka*Yeso	
e. Location of Well UNIT LETTER <u>0</u> LOCATED <u>660</u> FEET FROM THE <u>South</u> LINE AND <u>1650</u> FEET FROM THE <u>East</u> LINE OF SEC. <u>33</u> TWP. <u>18S</u> RGE. <u>26E</u> NMPM		11. County Eddy	
12. Elevations (Show whether DF, RT, etc.) 3367' GL		13. Proposed Depth 3100'	14. Formation Yeso
21A. Kind & Status Plug. Bond Blanket		21B. Drilling Contractor not determined	20. Rotary or C.T. Rotary
22. Approx. Date Work will start ASAP			

## PROPOSED CASING AND CEMENT PROGRAM

SIZE OF HOLE	SIZE OF CASING	WEIGHT PER FOOT	SETTING DEPTH	SACKS OF CEMENT	EST. TOP
9 1/2"	7"	20#	appr. 1120'	550 sx	circulate
6 1/4"	4 1/2"	10.5#	TD	300 sx	

Propose to drill and test the Yeso and intermediate formations. Casing will be set at least 100' below the Artesian Water Zone and 4 1/2" production string will be set at TD, all casing circulated to the surface. Will perforate and stimulate as needed for production.

MUD PROGRAM: FW gel to 1120, fresh water to TD.

BOP PROGRAM: BOP's will be installed on the 7" casing and tested daily for operational.

APPROVAL VALID FOR 180 DAYS  
PERMIT EXPIRES 4-6-84  
UNLESS DRILLING UNDERWAY

ABOVE SPACE DESCRIBE PROPOSED PROGRAM: IF PROPOSAL IS TO DEEPEN OR PLUG BACK, GIVE DATA ON PRESENT PRODUCTIVE ZONE AND PROPOSED NEW PRODUCTION ZONE. GIVE BLOWOUT PREVENTER PROGRAM, IF ANY.

I hereby certify that the information above is true and complete to the best of my knowledge and belief.

Signed John Beaudry Title Regulatory Agent Date 9/29/83

(This space for State Use)

PROVED BY Mr. Nathan TITLE OIL AND GAS INSPECTOR DATE OCT 6 1983

CONDITIONS OF APPROVAL, IF ANY:

Notify N.M.O.C.G. in sufficient  
time to witness cementing

the 7 casing

NEW MEXICO OIL CONSERVATION COMMISSION  
WELL LOCATION AND ACREAGE DEDICATION PLAT

Form C-102  
Supersedes C-128  
Effective 1-1-65

All distances must be from the outer boundaries of the Section.

Operator <b>YATES PETROLEUM CORPORATION</b>			Lease <b>Dowell MV</b>		Well No. <b>1</b>
Unit Letter <b>O</b>	Section <b>33</b>	Township <b>18 South</b>	Range <b>26 East</b>	County <b>Eddy</b>	
Actual Footage Location of Well: <b>660</b> feet from the <b>South</b> line and <b>1650</b> feet from the <b>East</b> line					
Ground Level Elev. <b>3367.</b>	Producing Formation <b>YESO</b>		Pool <b>Und. Atoka - Yeso</b>	Dedicated Acreage: <b>40</b> Acres	

1. Outline the acreage dedicated to the subject well by colored pencil or hachure marks on the plat below.
2. If more than one lease is dedicated to the well, outline each and identify the ownership thereof (both as to working interest and royalty).
3. If more than one lease of different ownership is dedicated to the well, have the interests of all owners been consolidated by communitization, unitization, force-pooling, etc?

☐ Yes    ☐ No    If answer is "yes," type of consolidation \_\_\_\_\_

If answer is "no," list the owners and tract descriptions which have actually been consolidated. (Use reverse side of this form if necessary.) \_\_\_\_\_

No allowable will be assigned to the well until all interests have been consolidated (by communitization, unitization, forced-pooling, or otherwise) or until a non-standard unit, eliminating such interests, has been approved by the Commission.

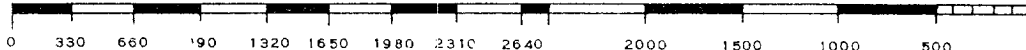
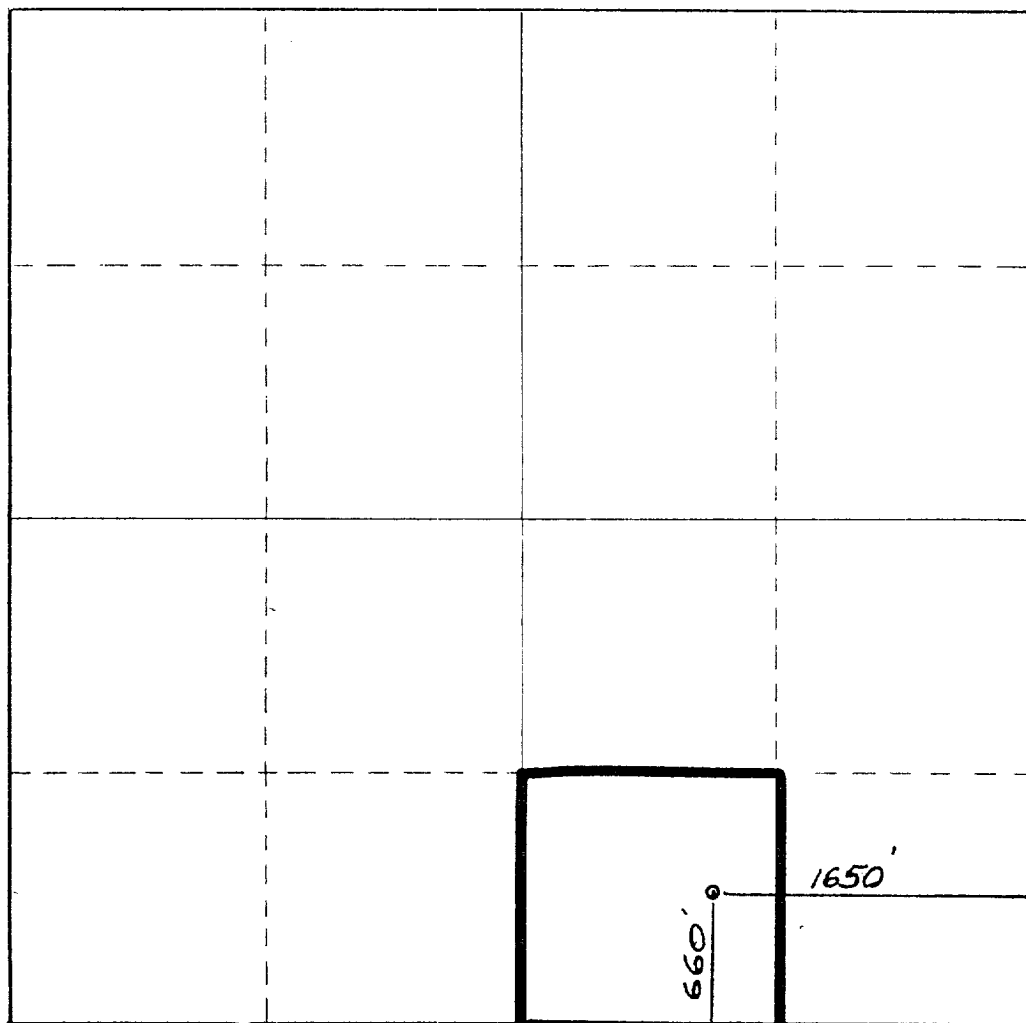

CERTIFICATION

I hereby certify that the information contained herein is true and complete to the best of my knowledge and belief.

*Ken Beardemphl*  
Name

Ken Beardemphl

Position

Regulatory Agent

Company

Yates Petroleum Corp.

Date

9/29/83

I hereby certify that the well location shown on this plat was plotted from field notes of actual surveys made by me or under my supervision and that the same is true and correct to the best of my knowledge and belief.

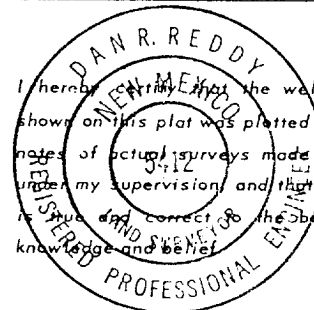

Date Surveyed

September 28, 1983

Registered Professional Engineer  
and/or Land Surveyor

*Dan R. Reddy*  
Certificate No.

NM PE&LS #5412

# EXHIBIT B

## BDP DIAGRAM

RATED 3000<sup>#</sup>

