

STATE OF NEW MEXICO
ENERGY AND MINERALS DEPARTMENT

OIL CONSERVATION DIVISION

P. O. BOX 2088

SANTA FE, NEW MEXICO 87501

UCT 11 1983

Form C-102
Revised 10-1-78

All distances must be from the outer boundaries of the Section.

Operator Ralph Nix Oil Inc.		Lease Fedell		O. C. D. ARTESIA, OFFICE		Well No. #3
Unit Letter A	Section 35	Township 18 S.	Range 26 E.	County Eddy		
Actual Footage Location of Well:						
330 feet from the North line and		990 feet from the East line				
Ground Level Elev. 3289	Producing Formation GLORIETA/YESO		Pool ATOKA	Dedicated Acreage: 40 Acres		

1. Outline the acreage dedicated to the subject well by colored pencil or hatchure marks on the plat below.
2. If more than one lease is dedicated to the well, outline each and identify the ownership thereof (both as to working interest and royalty).
3. If more than one lease of different ownership is dedicated to the well, have the interests of all owners been consolidated by communitization, unitization, force-pooling, etc?

☐ Yes ☐ No If answer is "yes," type of consolidation _____

If answer is "no," list the owners and tract descriptions which have actually been consolidated. (Use reverse side of this form if necessary.) _____

No allowable will be assigned to the well until all interests have been consolidated (by communitization, unitization, forced-pooling, or otherwise) or until a non-standard unit, eliminating such interests, has been approved by the Division.

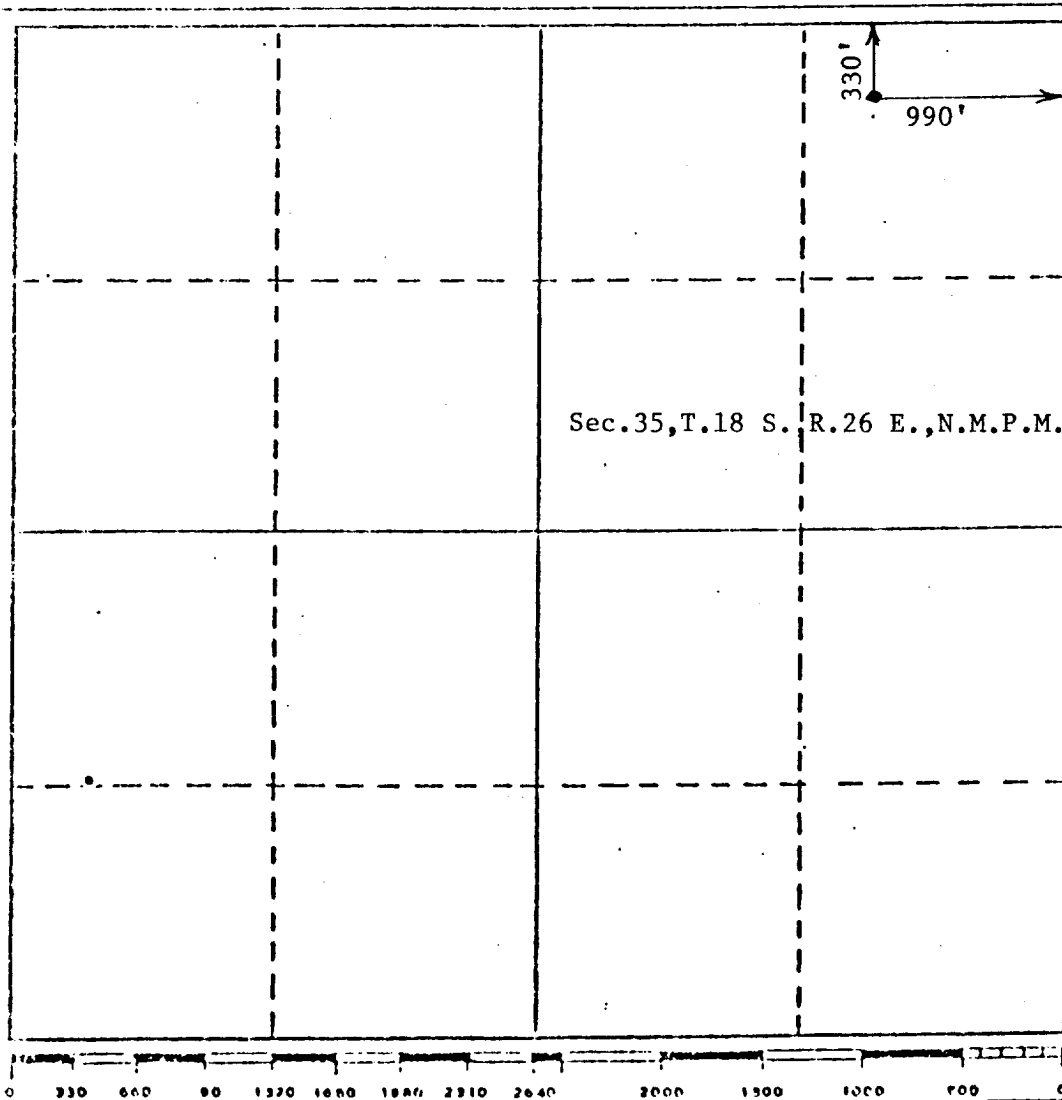

CERTIFICATION

I hereby certify that the information contained herein is true and complete to the best of my knowledge and belief.

Name
RALPH NIX JR.
Position
Company
RALPH NIX
Date
10-11-83

I hereby certify that the well location shown on this plat was plotted from field notes of actual surveys made by me or under my supervision, and that the same is true and correct to the best of my knowledge and belief.

Date Surveyed
JOHN D. JAQUES
NEW MEXICO
Registered Professional Engineer
and/or Land Surveyor
John D. Jaques
Certificate No. 6290
P.E. & L.S.