

NO. OF COPIES RECEIVED	
DISTRIBUTION	
SANTA FE	<input checked="" type="checkbox"/>
FILE	<input checked="" type="checkbox"/>
U.S.G.S.	<input checked="" type="checkbox"/>
LAND OFFICE	<input checked="" type="checkbox"/>
OPERATOR	<input checked="" type="checkbox"/>

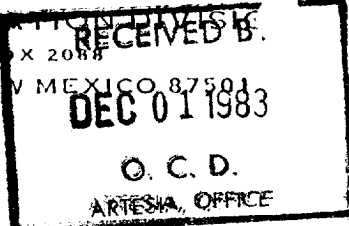

5A. Indicate Type of Lease
STATE <input type="checkbox"/> FEE <input checked="" type="checkbox"/>
5. State Oil & Gas Lease No.
7. Unit Agreement Name
8. Farm or Lease Name
Bonnie "YM"
9. Well No.
1
10. Field and Pool, or Wildcat
Penasco Draw / <del>Yeso</del> / <del>SA</del>
12. County
Eddy

## APPLICATION FOR PERMIT TO DRILL, DEEPEN, OR PLUG BACK

a. Type of Work	DRILL <input checked="" type="checkbox"/> DEEPEN <input type="checkbox"/> PLUG BACK <input type="checkbox"/>
b. Type of Well	OIL WELL <input checked="" type="checkbox"/> GAS WELL <input type="checkbox"/> OTHER <input type="checkbox"/> SINGLE ZONE <input type="checkbox"/> MULTIPLE ZONE <input type="checkbox"/>
c. Name of Operator	Yates Petroleum Corporation
d. Address of Operator	207 S. 4th, Artesia, New Mexico 88210
e. Location of Well	UNIT LETTER N LOCATED 990 FEET FROM THE South LINE 2310 FEET FROM THE West LINE OF SEC. 26 TWP. 18S RGE. 25E NMPM
19. Proposed Depth	3250'
19A. Formation	Yeso/San Andres Rotary
19B. Drilling Contractor	L&M #2
20. History or C.T.	ASAP
21A. Kind & Status Plug. Bond	Blanket
21B. Approx. Date Work will start	ASAP

## PROPOSED CASING AND CEMENT PROGRAM

SIZE OF HOLE	SIZE OF CASING	WEIGHT PER FOOT	SETTING DEPTH	SACKS OF CEMENT	EST. TOP
14 3/4"	10 3/4"	32# J-55	400'	250 sx	circ
9 1/2"	7"	20# J-55	1120'	500 sx	circ
6 1/4"	4 1/2"	9.5# J-55	TD	175 sx	circ

Propose to drill and test the Yeso and San Andres formations. Approximately 400' of surface casing will be set to shut off gravel and caving, and intermediate casing will be set at least 100' below the Artesian Water Zone. A tapered production string will be run and the cement will be circulated on each casing string.

MUD PROGRAM: FW gel/LCM to 1200', or dry drill, FW to TD.

BOP PROGRAM: BOP's will be installed and tested daily.

APPROVAL VALID FOR 180 DAYS  
PERMIT EXPIRES 6-1-84  
UNLESS DRILLING UNDERWAY

ABOVE SPACE DESCRIBE PROPOSED PROGRAM; IF PROPOSAL IS TO DEEPEN OR PLUG BACK, GIVE DATA ON PRESENT PRODUCTIVE ZONE AND PROPOSED NEW PRODUCTION ZONE. GIVE BLOWOUT PREVENTER PROGRAM, IF ANY.

I hereby certify that the information above is true and complete to the best of my knowledge and belief.

Signed Cy Cowan Title Regulatory Agent Date 11/30/83  
(This space for State Use)

APPROVED BY Mike Walker TITLE OIL AND GAS INSPECTOR DATE DEC 01 1983  
CONDITIONS OF APPROVAL, IF ANY:

Notify N.M.O.C.C. in sufficient  
time to witness cementing  
the 7 casing

**W MEXICO OIL CONSERVATION COMMISSION  
WELL LOCATION AND ACREAGE DEDICATION PLAT**

Form C-102  
Supersedes C-128  
Effective 1-1-65

All distances must be from the outer boundaries of the Section.

Operator <b>YATES PETROLEUM CORPORATION</b>			Lease <b>Bonnie "YM"</b>		Well No. <b>1</b>
Unit Letter <b>N</b>	Section <b>26</b>	Township <b>18 South</b>	Range <b>25 East</b>	County <b>Eddy</b>	
Actual Footage Location of Well: <b>990</b> feet from the <b>South</b> line and <b>2310</b> feet from the <b>West</b> line					
Ground Level Elev. <b>3486' GL</b>	Producing Formation <b>YESO SA</b>	Pool <b>SA-Yates Assoc. Penasco Draw (YESO SA)</b>	Dedicated Acreage: <b>40</b> Acres		

1. Outline the acreage dedicated to the subject well by colored pencil or hachure marks on the plat below.
2. If more than one lease is dedicated to the well, outline each and identify the ownership thereof (both as to working interest and royalty).
3. If more than one lease of different ownership is dedicated to the well, have the interests of all owners been consolidated by communitization, unitization, force-pooling, etc?

☐ Yes ☒ No If answer is "yes," type of consolidation \_\_\_\_\_

If answer is "no," list the owners and tract descriptions which have actually been consolidated. (Use reverse side of this form if necessary.) \_\_\_\_\_

No allowable will be assigned to the well until all interests have been consolidated (by communitization, unitization, forced-pooling, or otherwise) or until a non-standard unit, eliminating such interests, has been approved by the Commission.

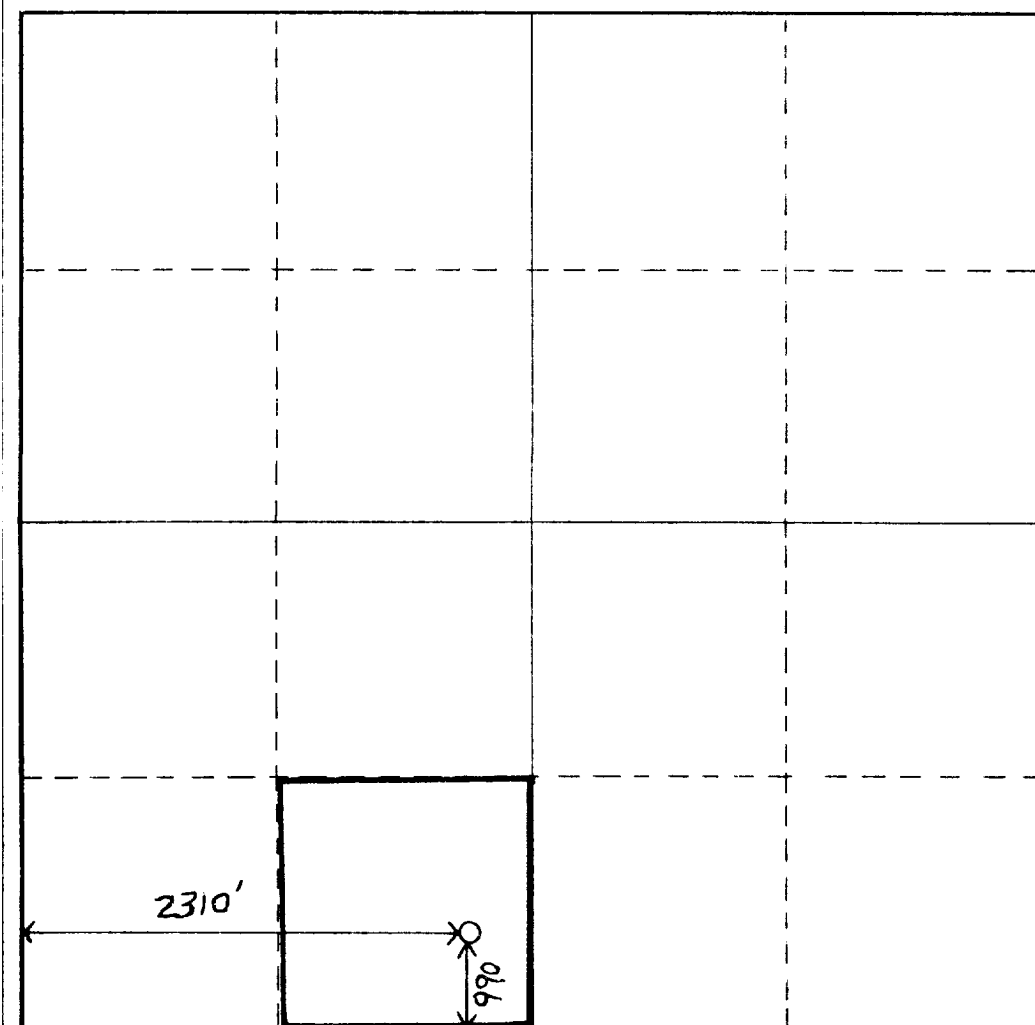

**CERTIFICATION**

*I hereby certify that the information contained herein is true and complete to the best of my knowledge and belief.*

*Cy Cowan*

Name	<b>Cy Cowan</b>
Position	<b>Regulatory Agent</b>
Company	<b>Yates Petroleum Corp.</b>
Date	<b>12/1/83</b>

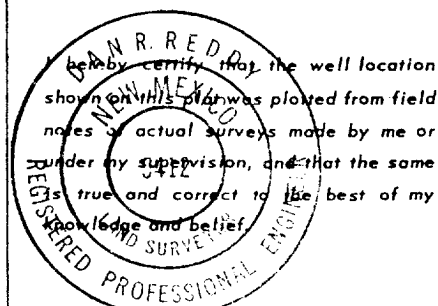

Date Surveyed  
**November 28, 1983**

Registered Professional Engineer  
and/or Land Surveyor

*Dan R. Reddy*

Certificate No.  
**NM PE&LS #5412**

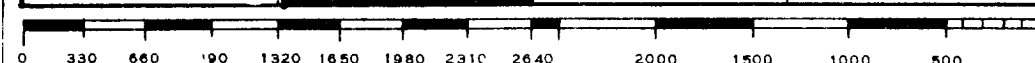

# EXHIBIT B

## BDP DIAGRAM

RATED 3000<sup>#</sup>

