

DISTRIBUTION
SANTA FE
FILE
U.S.G.S.
LAND OFFICE
OPERATOR

NEW MEXICO OIL CONSERVATION COMMISSION
FEB 06 1984
O. C. D.
ARTESIA, OFFICE

Form O-1010-7
Revised 1-1-75
5A. Indicate Type of Lease
STATE [X]
5. State Oil & Gas Lease No.
OG-103

APPLICATION FOR PERMIT TO DRILL, DEEPEN, OR PLUG BACK

1a. Type of Work
b. Type of Well
2. Name of Operator
3. Address of Operator
4. Location of Well
19. Proposed Depth
20. Rotary or C.T.

7. Unit Agreement Name
8. Farm or Lease Name
9. Well No.
10. Field and Pool, or Wildcat
12. County

Table with 6 columns: SIZE OF HOLE, SIZE OF CASING, WEIGHT PER FOOT, SETTING DEPTH, SACKS OF CEMENT, EST. TOP. Contains data for 12 1/4" and 7 7/8" hole sizes.

Plan to spud an Artesia San Andres well on Feb. 21, 1984 with 12 1/4" bit. Set 450' of 8 5/8" surface 24# casing, with 350 sxs Class "C" neat. Drill out with 7 7/8" bit with 10# brine to proposed depth of 2500'.

APPROVAL VALID FOR 180 DAYS
PERMIT EXPIRES 5-13-84
UNLESS DRILLING UNDERWAY

BOP:
Rig 12: 10", 5000# SS Cameron series 1500 - with Koomey 2 stage accumulator

IN ABOVE SPACE DESCRIBE PROPOSED PROGRAM: IF PROPOSAL IS TO DEEPEN OR PLUG BACK, GIVE DATA ON PRESENT PRODUCTIVE ZONE AND PROPOSED NEW PRO-
DUCTIVE ZONE. GIVE BLOWOUT PREVENTER PROGRAM, IF ANY.

I hereby certify that the information above is true and complete to the best of my knowledge and belief.
Signed: [Signature] Title: Production Clerk Date: Feb. 2, 1984

APPROVED BY: [Signature] TITLE: OIL AND GAS INSPECTOR DATE: FEB 13 1984
CONDITIONS OF APPROVAL, IF ANY:
Post & P.D.
10-14-84
2-17-84

OIL CONSERVATION DIVISION

STATE OF NEW MEXICO
ENERGY AND MINERALS DEPARTMENTP. O. BOX 2088
SANTA FE, NEW MEXICO 87501Form C-102
Revised 10-1-71

All distances must be from the outer boundaries of the Section.

Operator Santa Rita Exploration			Lease Sun State			Well No. #1		
Unit Letter A	Section 7	Township 18 South	Range 28 East	County Eddy				
Actual Footage Location of Well: 990 feet from the North line and 430 feet from the East line								
Ground Level Elev. 3624	Producing Formation San Andres		Pool Artesia O-GR-SA		Dedicated Acreage 40 Acres			

1. Outline the acreage dedicated to the subject well by colored pencil or hatchure marks on the plat below.
2. If more than one lease is dedicated to the well, outline each and identify the ownership thereof (both as to working interest and royalty).
3. If more than one lease of different ownership is dedicated to the well, have the interests of all owners been consolidated by communitization, unitization, force-pooling, etc?

☐ Yes ☐ No If answer is "yes;" type of consolidation _____

If answer is "no," list the owners and tract descriptions which have actually been consolidated. (Use reverse side of this form if necessary.) _____

No allowable will be assigned to the well until all interests have been consolidated (by communitization, unitization, forced-pooling, or otherwise) or until a non-standard unit, eliminating such interests, has been approved by the Division

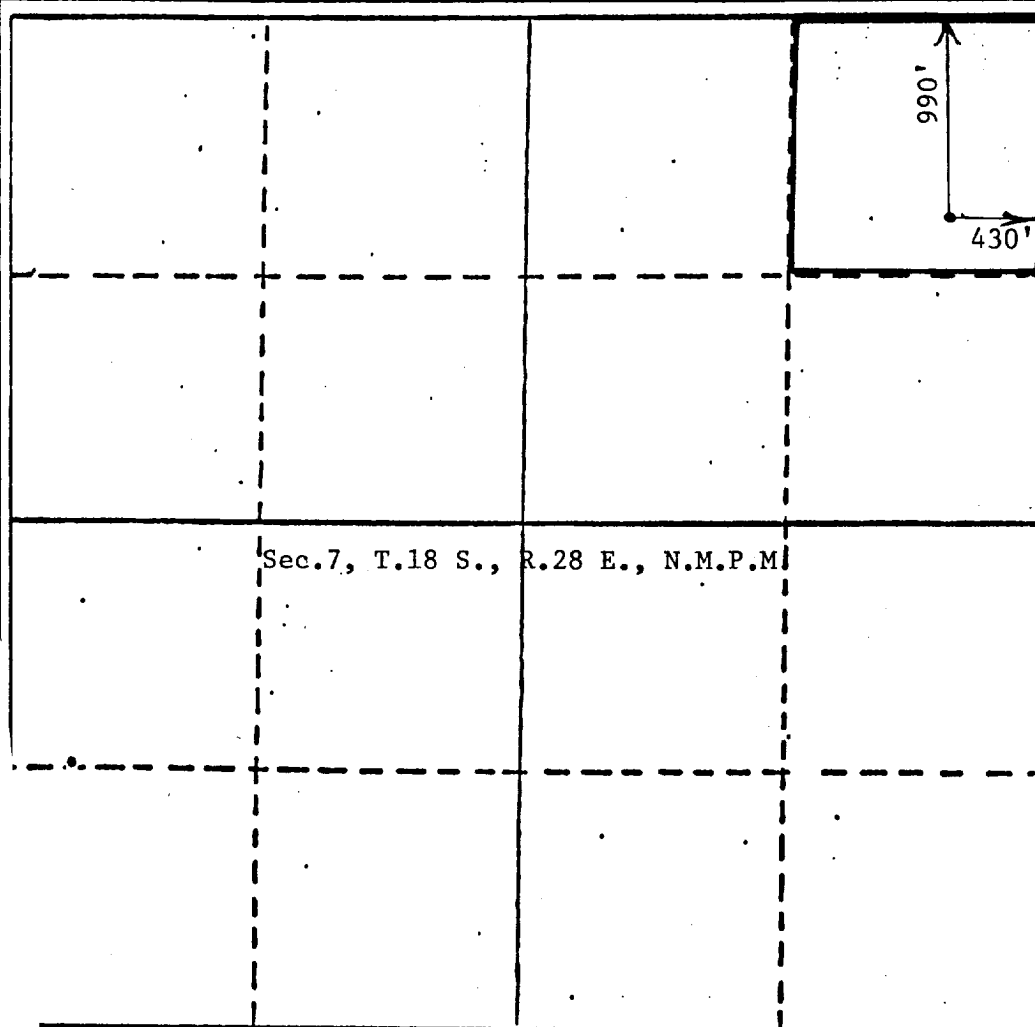

CERTIFICATION

I hereby certify that the information contained herein is true and complete to the best of my knowledge and belief.

Name

Vickie Teel

Position

Production Clerk

Company

Collier Energy, Inc.

Date

February 2, 1984

I hereby certify that the well location shown on this plat was plotted from field notes of actual surveys made by me or under my supervision, and that the same is true and correct to the best of my knowledge and belief.

Date Sworn

January 19, 1984

Registered Professional Engineer
and/or Land Surveyor

JOHN L. JACQUES L.S.

Certificate No. 6290 PROFESSIONAL ENGINEER