

NO. OF COPIES RECEIVED	
DISTRIBUTION	
SANTA FE	<input checked="" type="checkbox"/>
FILE	<input checked="" type="checkbox"/>
U.S.G.S.	<input checked="" type="checkbox"/>
LAND OFFICE	<input checked="" type="checkbox"/>
OPERATOR	<input checked="" type="checkbox"/>

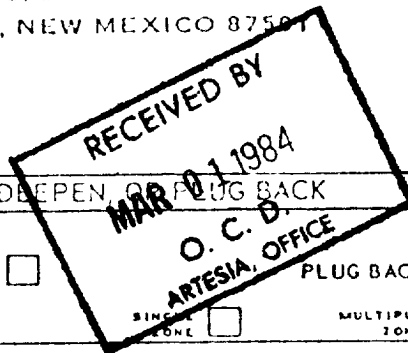

5A. Indicate Type of Lease STATE <input checked="" type="checkbox"/> FEE <input type="checkbox"/>
5. State Oil & Gas Lease No. B-8814
7. Unit Agreement Name
8. Farm or Lease Name Vaquero
9. Well No. 1
10. Field and Pool, or Wildcat Artesia-B-G-SA
12. County Eddy

APPLICATION FOR PERMIT TO DRILL, DEEPEN, OR PLUG BACK

Type of Work  
Type of Well  
OIL WELL ☒ GAS WELL ☐ OTHER ☐

DRILL ☒ DEEPEN ☐ PLUG BACK ☐

NAME OF OPERATOR  
Casa Petroleum, Inc.

Address of Operator  
105 North 6th. Street Artesia, New Mexico 88210

Location of Well  
UNIT LETTER P LOCATED 990 FEET FROM THE South LINE  
990 FEET FROM THE East LINE OF SEC. 2 TWP. 18 RGE. 28 NMPM

19. Proposed Depth 3500	19A. Formation San Andres	20. History or C.T. Rotary
21A. Kind & Status Plug. Bond 1 well	21B. Drilling Contractor Salazar Bro. Drilling Co.	22. Approx. Date Work will start 3/1/84

Elevations (Show whether DE, RI, etc.)  
3652.4 GR

PROPOSED CASING AND CEMENT PROGRAM

SIZE OF HOLE	SIZE OF CASING	WEIGHT PER FOOT	SETTING DEPTH	SACKS OF CEMENT	EST. TOP
12 1/4	8 5/8	23#	350	300 circ	
7 7/8	4 1/2	9.50#	3500	300 SKS	

Propose to drill 12 1/4 hole to 350', set 8 5/8 23# casing and circulate cement WOC 18 hours and PSI test BOP to 1000# 30 minutes then drill 7 7/8 hole to approximate depth of 3500'. Run CNL and DLL if Productive. Run 4 1/2, 9.50# J55 and cement with 300 sks class C. Completion to be determined upon log evaluation.

APPROVAL VALID FOR 180 DAYS  
PERMIT EXPIRES 9-1-84  
UNLESS DRILLING UNDERWAY  
Post A to B  
PD-1 with Book  
3-2-84

ABOVE SPACE DESCRIBE PROPOSED PROGRAM: IF PROPOSAL IS TO DEEPEN OR PLUG BACK, GIVE DATA ON PRESENT PRODUCTIVE ZONE AND PROPOSED NEW PRODUCTION ZONE. GIVE BLOWOUT PREVENTER PROGRAM, IF ANY.

I hereby certify that the information above is true and complete to the best of my knowledge and belief.

By Raymond C. [Signature] Title President Date 3/1/84

(This space for State Use)

PROVED BY Raymond C. [Signature] TITLE Geologist DATE 3/1/84  
CONDITIONS OF APPROVAL, IF ANY:

**NEW MEXICO OIL CONSERVATION COMMISSION  
WELL LOCATION AND ACREAGE DEDICATION PLAT**

Form C-102  
Supersedes C-128  
Effective 1-1-65

All distances must be from the outer boundaries of the Section.

Operator <b>CASA PETROLEUM, INC.</b>		Lease <b>VACQUERO</b>		Well No. <b>1</b>
Unit Letter <b>P</b>	Section <b>2</b>	Township <b>18S</b>	Range <b>28E</b>	County <b>EDDY</b>
Actual Footage Location of Well:				
<b>990</b>	feet from the	<b>SOUTH</b>	line and	<b>990</b> feet from the <b>EAST</b> line
Ground Level Elev. <b>3652.4</b>	Producing Formation <b>SA</b>		Pool <b>Art-B-G-SA</b>	Dedicated Acreage: <b>40</b> Acres

1. Outline the acreage dedicated to the subject well by colored pencil or hachure marks on the plat below.
2. If more than one lease is dedicated to the well, outline each and identify the ownership thereof (both as to working interest and royalty).
3. If more than one lease of different ownership is dedicated to the well, have the interests of all owners been consolidated by communitization, unitization, force-pooling, etc?

☐ Yes    ☐ No    If answer is "yes," type of consolidation \_\_\_\_\_

If answer is "no," list the owners and tract descriptions which have actually been consolidated. (Use reverse side of this form if necessary.) \_\_\_\_\_

No allowable will be assigned to the well until all interests have been consolidated (by communitization, unitization, forced-pooling, or otherwise) or until a non-standard unit, eliminating such interests, has been approved by the Commission.

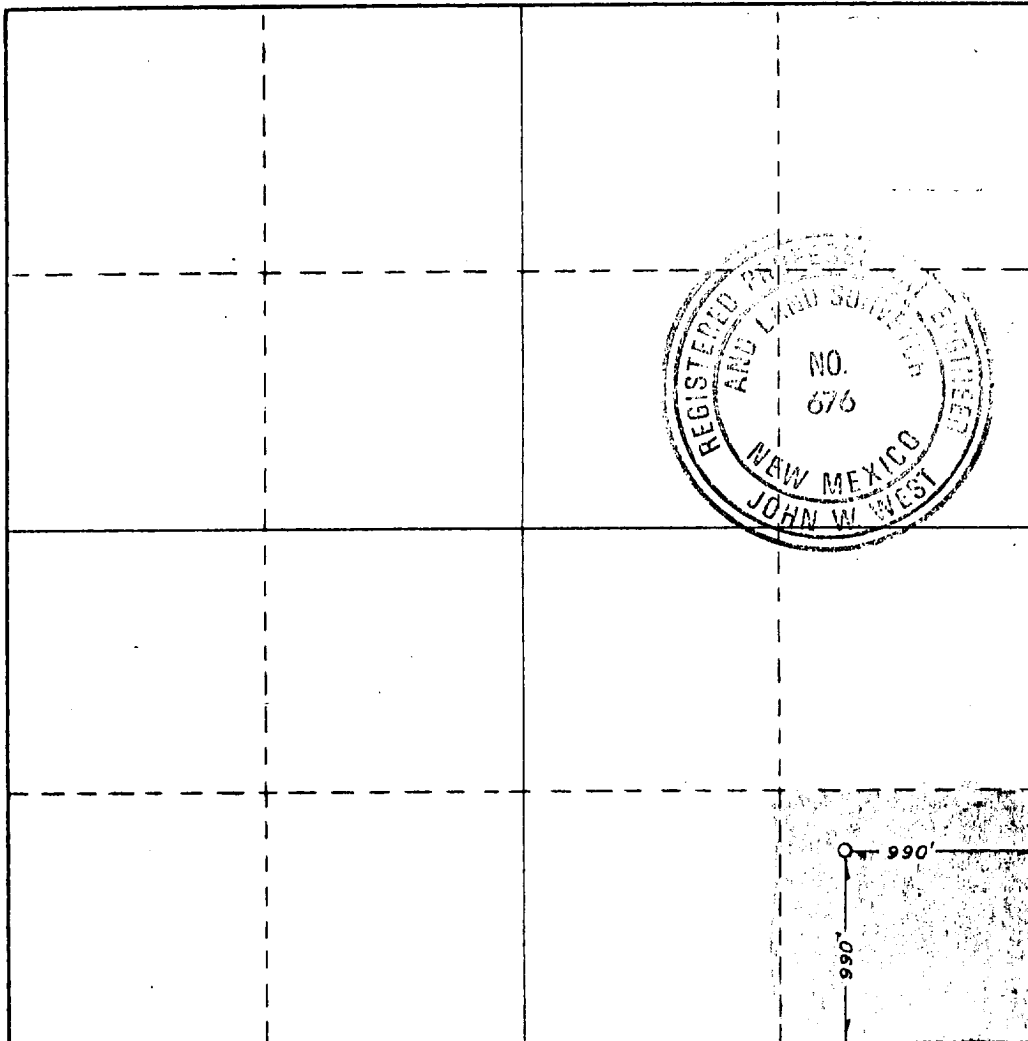

**CERTIFICATION**

I hereby certify that the information contained herein is true and complete to the best of my knowledge and belief.

*Ken C. Kan*  
Name

*President*  
Position

*Casa Petroleum, Inc.*  
Company

*March 1, 1984*  
Date

I hereby certify that the well location shown on this plat was plotted from field notes of actual surveys made by me or under my supervision, and that the same is true and correct to the best of my knowledge and belief.

Date Surveyed  
**2/28/84**

Registered Professional Engineer and/or Land Surveyor

*John W. West*