

NO. OF COPIES RECEIVED	
DISTRIBUTION	
SANTA FE	<input checked="" type="checkbox"/>
FILE	<input checked="" type="checkbox"/>
U.S.G.S.	<input checked="" type="checkbox"/>
LAND OFFICE	<input checked="" type="checkbox"/>
OPERATOR	<input checked="" type="checkbox"/>

NEW MEXICO OIL CONSERVATION COMMISSION

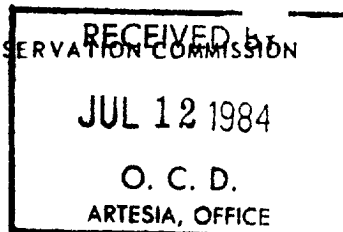

Form C-101
Revised 1-1-83
30-015-24925

5A. Indicate Type of Lease
STATE ☒ FEE ☐
5. State Oil & Gas Lease No.
B-11539

APPLICATION FOR PERMIT TO DRILL, DEEPEN, OR PLUG BACK

1a. Type of Work

b. Type of Well

DRILL ☒

DEEPEN ☐

PLUG BACK ☐

OIL WELL ☒ GAS WELL ☐ OTHER ☐

SINGLE ZONE ☐

MULTIPLE ZONE ☐

2. Name of Operator

Arlen Dickson

3. Address of Operator

P.O. Box 50160, Midland, Texas 79710

4. Location of Well

UNIT LETTER G LOCATED 1650 FEET FROM THE East LINE

AND 1650 FEET FROM THE North LINE OF SEC. 9 TWP. 18-S REG. 28-E NMPM

7. Unit Agreement Name

8. Farm or Lease Name

Humble

9. Well No.

#1

10. Field and Pool, or Wildcat
Artesia Queen GR-SA

12. County

Eddy

19. Proposed Depth

2650'

19A. Formation

San Andres

20. Rotary or C.T.

Rotary

1. Elevations (Show whether DF, RT, etc.)

3638' GL

21A. Kind & Status Plug. Bond

Blanket 5/10/84

21B. Drilling Contractor

Salazar Bros. Drilling

22. Approx. Date Work will start

July 20, 1984

PROPOSED CASING AND CEMENT PROGRAM

SIZE OF HOLE	SIZE OF CASING	WEIGHT PER FOOT	SETTING DEPTH	SACKS OF CEMENT	EST. TOP
12 1/4	8 5/8	24#	350'	350 sxs	Surface
7 7/8	4 1/2	10.5#	2650'	650 sxs	Surface

Plan to spud an Artesia San Andres well on July 20, 1984 with a 12 1/4" bit by Salazar Bros. Drilling Company and drill to 350' and set 350' of 8 5/8" 24# surface casing and cement with 350 sxs of Class "C" neat.

Then continue to drill to a proposed depth of 2650' with a 7 7/8" bit. If commercial shows are present, run 4 1/2" 10.5# casing and set 650 sxs of Class "C" neat and circulate to surface.

If dry hole proper plugs will be set as prescribed by NM OCD. APPROVAL VALID FOR 180 DAYS PERMIT EXPIRES 1-16-85 UNLESS DRILLING UNDERWAY

BOP:

Rig 14: 10", 5000# SS Cameron series 1500 - with Koomey 2 stage accumulator.

LEAVE SPACE DESCRIBE PROPOSED PROGRAM; IF PROPOSAL IS TO DEEPEN OR PLUG BACK, GIVE DATA ON PRESENT PRODUCTIVE ZONE AND PROPOSED NEW PRODUCTION ZONE. GIVE BLOWOUT PREVENTER PROGRAM, IF ANY.

herby certify that the information above is true and complete to the best of my knowledge and belief.

ed Marlys Reynolds Title Consultant Date 7/9/84
(This space for State Use)

PROVED BY MAH Hoffman TITLE OIL AND GAS INSPECTOR DATE JUL 16 1984
DITIONS OF APPROVAL, IF ANY:

Post FD-1
7-20-84
HIE + BK

All distances must be from the outer boundaries of the Section.

Operator <i>Holman</i> Dickson Petroleum			Lease Humble State		Well No. #1
Unit Letter G	Section 9	Township 18 South	Range 28 East	County Eddy	
Actual Well Location of Well: 1650 feet from the North line and 1650 feet from the East line					
Ground Level Elev. 3638	Producing Formation <i>San Andres</i>		Pool <i>Art - Q - G - SA</i>	Dedicated Acreage 48 Acres	

- Outline the acreage dedicated to the subject well by colored pencil or hatchure marks on the plat below.
- If more than one lease is dedicated to the well, outline each and identify the ownership thereof (both as to working interest and royalty).
- If more than one lease of different ownership is dedicated to the well, have the interests of all owners been consolidated by communitization, unitization, force-pooling, etc?

☐ Yes ☐ No If answer is "yes," type of consolidation _____

If answer is "no," list the owners and tract descriptions which have actually been consolidated. (Use reverse side of this form if necessary.) _____

No allowable will be assigned to the well until all interests have been consolidated (by communitization, unitization, forced-pooling, or otherwise) or until a non-standard unit, eliminating such interests, has been approved by the Division

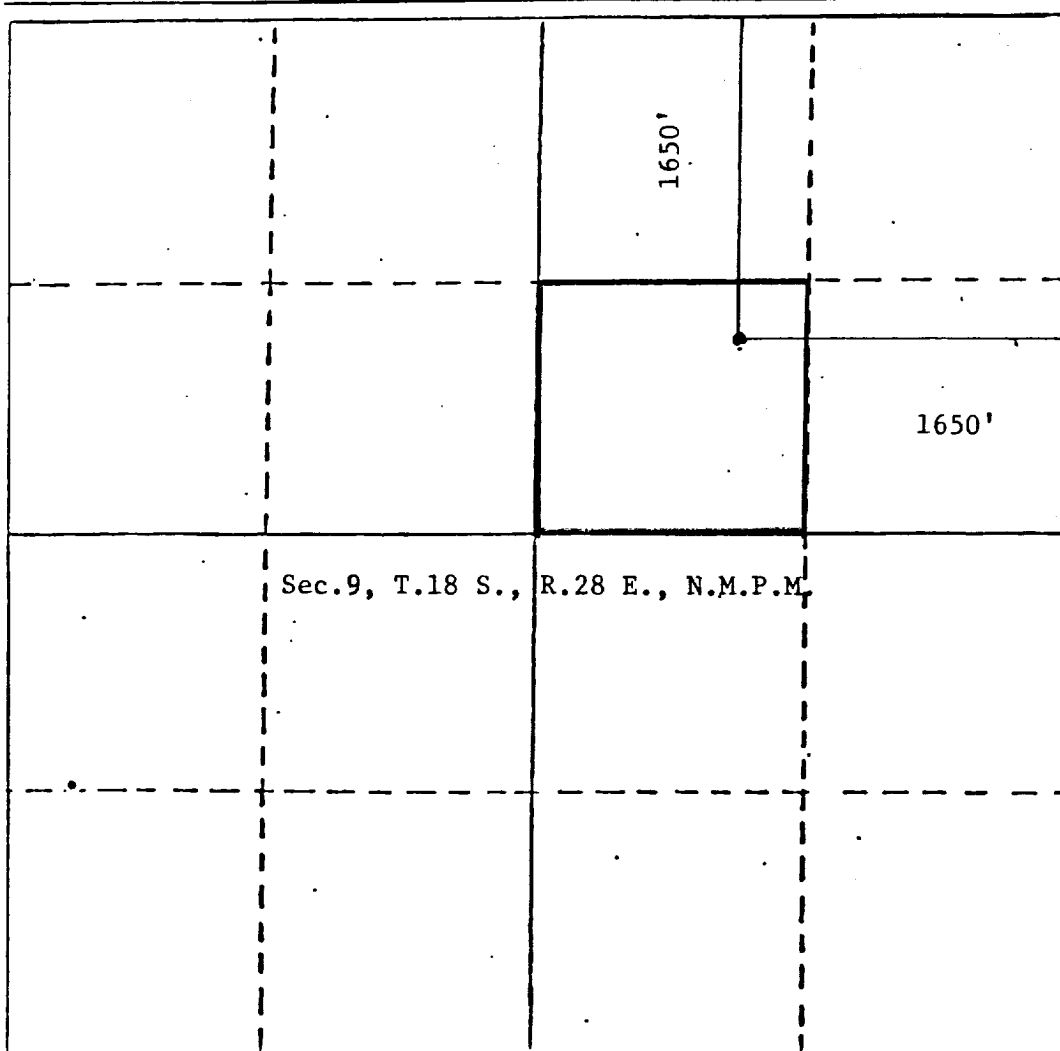

CERTIFICATION

I hereby certify that the information contained herein is true and complete to the best of my knowledge and belief.

Name
Marlys Reynolds
Position
Consultant
Company
Dickson Petroleum
Date
7/9/ 84

I hereby certify that the well location shown on this plat was plotted from field notes of actual surveys made by me or under my supervision, and that the same is true and correct to the best of my knowledge and belief.

Date Surveyed
July 3, 1984
Registered Professional Engineer and/or Land Surveyor
JOHN D. JAQUESS
861122, Jaquess, J.E. & L.S.
Certificate No. 6298