

OIL CONSERVATION DIVISION

P O BOX 2088

Form C-132
Revised 5-10-81STATE OF NEW MEXICO
ENERGY AND MINERALS DEPARTMENT

SANTA FE, NEW MEXICO 87501

APPLICATION FOR WELLHEAD
PRICE CEILING CATEGORY DETERMINATION

5A. Indicate Type of Lease

STATE ☒ FEE ☐

5. State Oil & Gas Lease No.

B-11539

7. Unit Agreement Name

8. Farm or Lease Name

Humble

9. Well No.

1

10. Field and Pool, or Wildcat
Artesia-Queen GR-SA

12. County

Eddy

RECEIVED BY

SEP 13 1984

O. C. D.
ARTESIA, OFFICE

1. FOR DIVISION USE ONLY:

DATE COMPLETE APPLICATION FILED

DATE DETERMINATION MADE

WAS APPLICATION CONTESTED? YES NO

NAME(S) OF INTERVENOR(S), IF ANY:

2. Name of Operator

Arlen Dickson

3. Address of Operator

P.O. Box 50160, Midland, Texas 79710

4. Location of Well

UNIT LETTER G LOCATED 1650 FEET FROM THE East LINE

AND 1650 FEET FROM THE North LINE OF SEC. 9 TWP. 18S RGE. 28S NMPM

11. Name and Address of Purchaser(s)

Phillips Petroleum Company, 4001 Penbrook, Odessa, Texas 79762

WELL CATEGORY INFORMATION

Check appropriate box for category sought and information submitted.

1. Category(ies) Sought (By NGPA Section No.) 103

2. All Applications must contain:

- ☒ a. C-101 APPLICATION FOR PERMIT TO DRILL, DEEPEN OR PLUG BACK
☒ b. C-105 WELL COMPLETION OR RECOMPLETION REPORT
☐ c. DIRECTIONAL DRILLING SURVEY, IF REQUIRED UNDER RULE 111
☒ d. AFFIDAVITS OF MAILING OR DELIVERY

3. In addition to the above, all applications must contain the items required by the applicable rule of the Division's "Special Rules for Applications For Wellhead Price Ceiling Category Determinations" as follows:

A. NEW NATURAL GAS UNDER SEC. 102(c)(1)(B) (using 2.5 Mile or 1000 Feet Deeper Test)

☐ All items required by Rule 14(1) and/or Rule 14(2)

B. NEW NATURAL GAS UNDER SEC. 102(c)(1)(C) (new onshore reservoir)

☐ All items required by Rule 15

C. NEW ONSHORE PRODUCTION WELL

☒ All items required by Rule 16A or Rule 16B

D. DEEP, HIGH-COST NATURAL GAS, TIGHT FORMATION NATURAL GAS, AND PRODUCTION ENHANCEMENT NATURAL GAS

☐ All items required by Rule 17(1), Rule 17(2) or Rule 17(3), or Rule 17(4)

E. STRIPPER WELL NATURAL GAS

☐ All items required by Rule 18HEREBY CERTIFY THAT THE INFORMATION CONTAINED
HEREIN IS TRUE AND COMPLETE TO THE BEST OF MY
KNOWLEDGE AND BELIEF.

Arlen Dickson

NAME OF APPLICANT (Type or Print)

SIGNATURE OF APPLICANT

Title President of Dickson Petroleum, Inc.

Date September 12, 1984

FOR DIVISION USE ONLY

☐ Approved☐ DisapprovedThe information contained herein includes all
of the information required to be filed by the
applicant under Subpart B of Part 274 of the
FERC regulations.

EXAMINED

All distances must be from the outer boundaries of the Section.

Operator Dickson Petroleum			Lease Humble State		Well No. #1
Unit Letter G	Section 9	Township 18 South	Range 28 East	County Eddy	
Actual Footage Location of Well: 1650 feet from the North line and 1650 feet from the East line					
Ground Level Elev. 3638	Producing Formation		Paul		Dedicated Acreage: Acres

1. Outline the acreage dedicated to the subject well by colored pencil or hatchure marks on the plat below.
2. If more than one lease is dedicated to the well, outline each and identify the ownership thereof (both as to working interest and royalty).
3. If more than one lease of different ownership is dedicated to the well, have the interests of all owners been consolidated by communitization, unitization, force-pooling, etc?

☐ Yes ☐ No If answer is "yes," type of consolidation _____

If answer is "no," list the owners and tract descriptions which have actually been consolidated. (Use reverse side of this form if necessary.) _____

No allowable will be assigned to the well until all interests have been consolidated (by communitization, unitization, force-pooling, or otherwise) or until a non-standard unit, eliminating such interests, has been approved by the Division

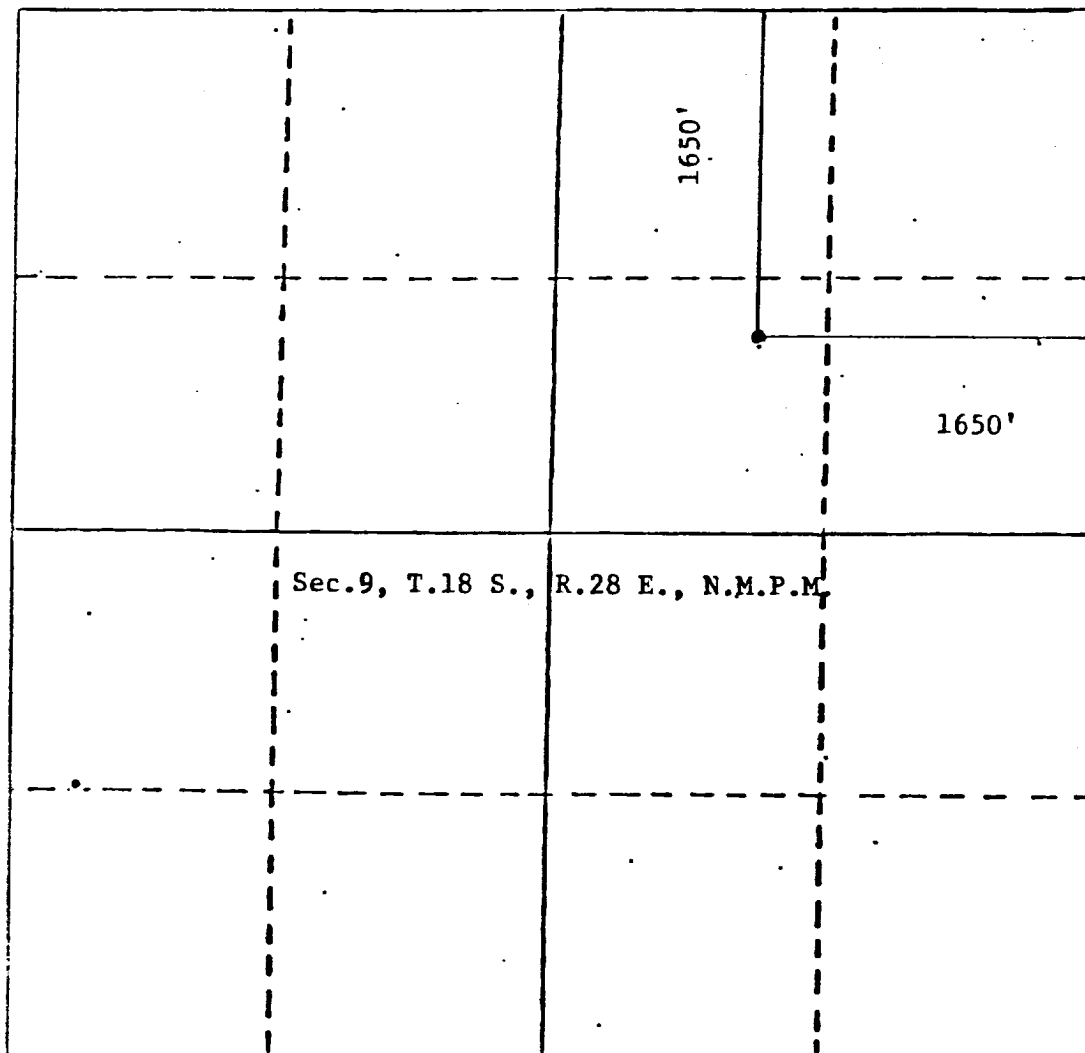

CERTIFICATION

I hereby certify that the information contained herein is true and complete to the best of my knowledge and belief.

Name **Marlys Reynolds**
Position **Consultant**
Company **Dickson Petroleum**
Date **7/9/ 84**

I hereby certify that the well location shown on this plat was plotted from field notes of actual surveys made by me or under my supervision, and that the same is true and correct to the best of my knowledge and belief.

Date Surveyed **July 3, 1984**
Registered Professional Engineer and/or Land Surveyor
JOHN D. JACQUES
6290
Professional Engineer and Land Surveyor
State of New Mexico
Certificate No. **6290**