

NO. OF COPIES RECEIVED	
DISTRIBUTION	
SANTA FE	<input checked="" type="checkbox"/>
FILE	<input checked="" type="checkbox"/>
U.S.G.S.	<input checked="" type="checkbox"/>
LAND OFFICE	<input checked="" type="checkbox"/>
OPERATOR	<input checked="" type="checkbox"/>

NEW MEXICO OIL CONSERVATION COMMISSION

**RECEIVED BY**  
**JUL 12 1984**  
**O. C. D.**  
**ARTESIA, OFFICE**

Form C-10  
Revised 1-1-83

5A. Indicate Type of Lease	
STATE <input checked="" type="checkbox"/>	FEE <input type="checkbox"/>
5. State Oil & Gas Lease No.	
B-11539	

# APPLICATION FOR PERMIT TO DRILL, DEEPEN, OR PLUG BACK

1a. Type of Work

b. Type of Well

DRILL ☒

DEEPEN ☐

PLUG BACK ☐

OIL WELL ☒

GAS WELL ☐

OTHER

SINGLE ZONE ☐

MULTIPLE ZONE ☐

2. Name of Operator

Arlen Dickson

3. Address of Operator

P.O. Box 50160, Midland, Texas 79710

4. Location of Well

UNIT LETTER M LOCATED 330 FEET FROM THE South LINE

AND 990 FEET FROM THE West LINE OF SEC. 9 TWP. 18-S RGE. 28-E NUPM

7. Unit Agreement Name

8. Farm or Lease Name

Exxon

9. Well No.

#2

10. Field and Pool, or Willcat

Artesia Queen GR-SA

12. County

Eddy

1. Elevations (Show whether DF, RT, etc.)

3624' BL

21A. Kind &amp; Status Plug. Bond

Blanket 5/10/84

19. Proposed Depth

2650'

19A. Formation

San Andres

20. Rotary or C.T.

Rotary

21B. Drilling Contractor

Salazar Bros. Drilling

22. Approx. Date Work will start

July 20, 1984

## PROPOSED CASING AND CEMENT PROGRAM

SIZE OF HOLE	SIZE OF CASING	WEIGHT PER FOOT	SETTING DEPTH	SACKS OF CEMENT	EST. TOP
12 1/4	8 5/8	24#	350'	350 sxs	Surface
7 7/8	4 1/2	10.5#	2650'	650 sxs	Surface

Plan to spud an Artesia San Andres well on July 20, 1984 with a 12 1/4" bit by Salazar Bros. Drilling Company and drill to 350' and set 350' of 8 5/8" 24# surface casing and cement with 350 sxs of Class "C" neat.

Then continue to drill to a proposed depth of 2650' with a 7 7/8" bit. If commercial shows are present, run 4 1/2" 10.5# casing and set 650 sxs of Class "C" neat and circulate to surface.

If dry hole proper plugs will be set as prescribed by NM O.C.D. APPROVAL VALID FOR 180 DAYS PERMIT EXPIRES 1-16-85 UNLESS DRILLING UNDERWAY

BOP:

Rig 14: 10", 5000# SS Cameron series 1500 - with Koomey 2 stage accumulator.

ABOVE SPACE DESCRIBE PROPOSED PROGRAM: IF PROPOSAL IS TO DEEPEN OR PLUG BACK, GIVE DATA ON PRESENT PRODUCTIVE ZONE AND PROPOSED NEW PRODUCTION ZONE. GIVE BLOWOUT PREVENTER PROGRAM, IF ANY.

I hereby certify that the information above is true and complete to the best of my knowledge and belief.

by Marlyse Reynolds Title Consultant Date July 9, 1984  
(This space for State Use)

APPROVED BY Mr. Williams TITLE OIL AND GAS INSPECTOR DATE JUL 16 1984  
CONDITIONS OF APPROVAL, IF ANY:

Post FD-1  
7-20-84  
APC + BK

All distances must be from the outer boundaries of the Section.

Operator <i>Arden</i> <b>Dickson Petroleum</b>			Lease <b>Exxon</b>		Well No. <b>#2</b>
Unit Letter <b>M</b>	Section <b>9</b>	Township <b>18 South</b>	Range <b>28 East</b>	County <b>Eddy</b>	
Actual Postage Location of Well: 330 feet from the South line and 990 feet from the West line					
Ground Level Elev. <b>3624</b>	Producing Formation <i>San Andres</i>		Pool <i>Art. - 2 - G - 24</i>		Dedicated Acreage <b>40</b> Acres

1. Outline the acreage dedicated to the subject well by colored pencil or hatchure marks on the plat below.
2. If more than one lease is dedicated to the well, outline each and identify the ownership thereof (both as to working interest and royalty).
3. If more than one lease of different ownership is dedicated to the well, have the interests of all owners been consolidated by communitization, unitization, force-pooling, etc?

☐ Yes ☐ No If answer is "yes," type of consolidation \_\_\_\_\_

If answer is "no," list the owners and tract descriptions which have actually been consolidated. (Use reverse side of this form if necessary.) \_\_\_\_\_

No allowable will be assigned to the well until all interests have been consolidated (by communitization, unitization, forced-pooling, or otherwise) or until a non-standard unit, eliminating such interests, has been approved by the Division

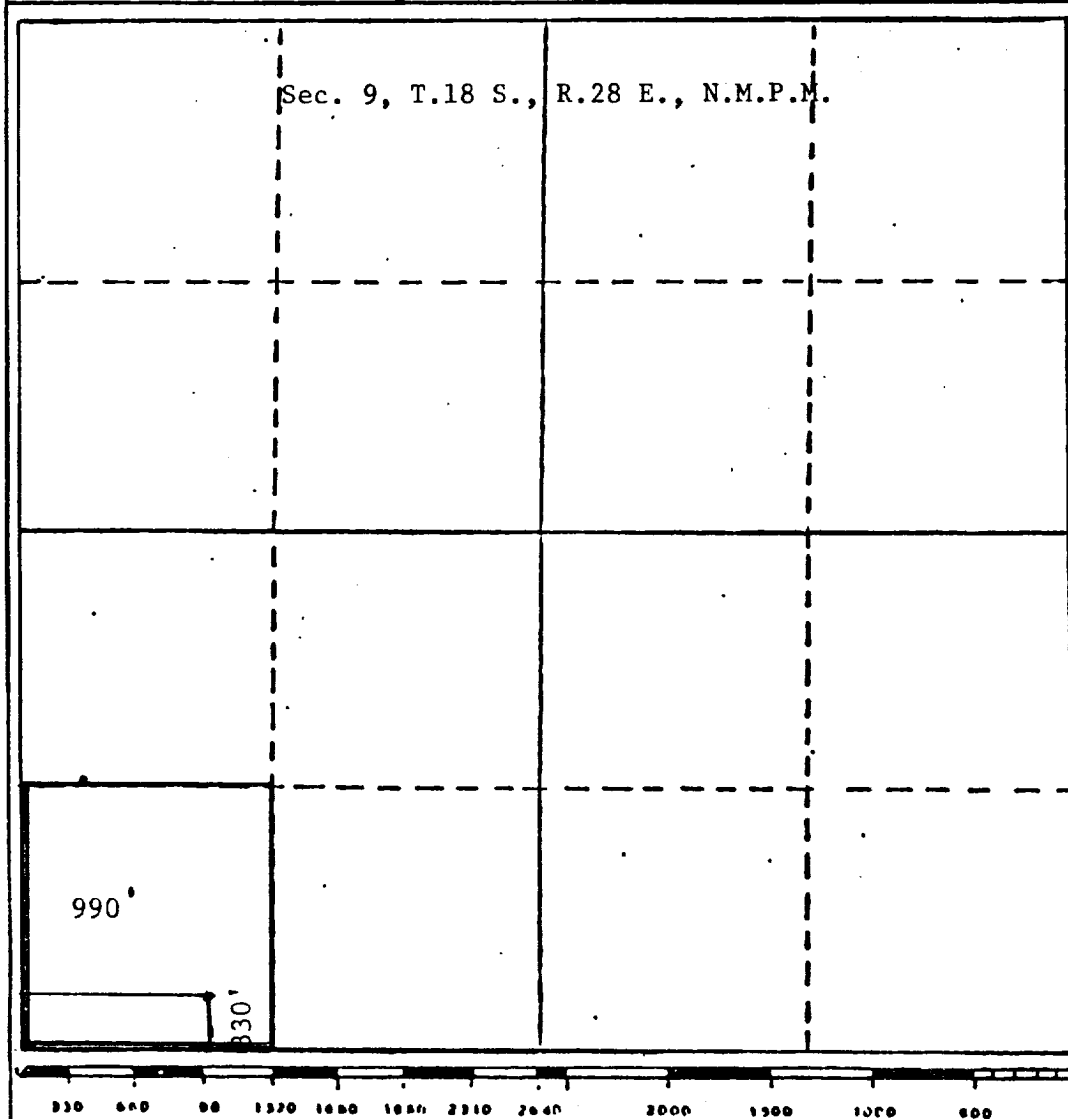

**CERTIFICATION**

I hereby certify that the information contained herein is true and complete to the best of my knowledge and belief.

Name *Marlys Reynolds*  
Position **Consultant**  
Company **Dickson Petroleum**  
Date **7/9/84**

I hereby certify that the well location shown on this plat was plotted from field notes of actual surveys made by me or under my supervision, and that the same is true and correct to the best of my knowledge and belief.

**JOHN D. JAQUES**  
NEW MEXICO  
July 3, 1984  
Registered Professional Engineer and Land Surveyor  
No. 6298  
E. & L. S.  
Certificate No. 6298