

NO. OF COPIES RECEIVED	
DISTRIBUTION	
SANTA FE	<input checked="" type="checkbox"/>
FILE	<input checked="" type="checkbox"/>
U.S.G.S.	<input checked="" type="checkbox"/>
LAND OFFICE	<input checked="" type="checkbox"/>
OPERATOR	<input checked="" type="checkbox"/>

NEW MEXICO OIL CONSERVATION COMMISSION

RECEIVED BY

SEP 07 1984

O. C. D.
ARTESIA, OFFICE

Form C-101

Revised 1-1-65

20-015-25002

5A. Indicate Type of Lease

STATE ☒

FEE ☐

5. State Oil & Gas Lease No.

E - 1645

APPLICATION FOR PERMIT TO DRILL, DEEPEN, OR PLUG BACK

1a. Type of Work		7. Unit Agreement Name	
b. Type of Well OIL WELL <input checked="" type="checkbox"/> GAS WELL <input type="checkbox"/> OTHER <input type="checkbox"/>		8. Farm or Lease Name New Mexico "AF" State	
2. Name of Operator Anadarko Production Company		9. Well No. 1	
3. Address of Operator P. O. Drawer 130, Artesia, New Mexico 88210		10. Field and Pool, or Wildcat Loco Hills-Queen-G-SA	
4. Location of Well UNIT LETTER <u>P</u> LOCATED <u>660</u> FEET FROM THE <u>South</u> LINE AND <u>660</u> FEET FROM THE <u>East</u> LINE OF SEC. <u>1</u> TWP. <u>18S</u> RGE. <u>28E</u> NMPM		12. County Eddy	
19. Proposed Depth 2800		19A. Formation Grayburg	
20. Rotary or C.T. Rotary		21. Elevation (Show whether D.F., R.T., etc.) 3665.2' GL	
21A. Kind & Status Plug. Bond Blanket		21B. Drilling Contractor W E K Drilling Co.	
22. Approx. Date Work will start Sept. 20, 1984			

23.

PROPOSED CASING AND CEMENT PROGRAM

SIZE OF HOLE	SIZE OF CASING	WEIGHT PER FOOT	SETTING DEPTH	SACKS OF CEMENT	EST. TOP
12-1/4"	8-5/8"	24.04	325'	250	Circulated
7-7/8"	5-1/2"	15.54	2800	800	Circulated

1. Rig up rotary tools.
2. Drill 12-1/4" hole to approx. 325'; set & circulate or ready-mix cement to surface on 8-5/8" casing. Install and test Series 900 Double Ram Hydraulic Blowout Preventor.
3. Drill 7-7/8" hole to T D (approx. 2800'); run open hole logs.
4. Set & circulate cement on 5-1/2" casing from T D to surface.
5. Perforate, acidize and fracture treat.
6. Run 2-3/8" tubing, rods and bottomhole pump; install pumping equipment and place well on production.

APPROVAL VALID FOR 180 DAYS
PERMIT EXPIRES 3-11-85
UNLESS DRILLING UNDERWAY

IN ABOVE SPACE DESCRIBE PROPOSED PROGRAM; IF PROPOSAL IS TO DEEPEN OR PLUG BACK, GIVE DATA ON PRESENT PRODUCTIVE ZONE AND PROPOSED NEW PRODUCTIVE ZONE, GIVE BLOWOUT PREVENTER PROGRAM, IF ANY.

I hereby certify that the information above is true and complete to the best of my knowledge and belief.

Signed Truman D. Jones Title Field Foreman Date Sept. 6, 1984

(This space for State Use)

APPROVED BY M. H. Walker TITLE OIL AND GAS INSPECTOR DATE SEP 10 1984

CONDITIONS OF APPROVAL, IF ANY:

NEW MEXICO OIL CONSERVATION COMMISSION
WELL LOCATION AND ACREAGE DEDICATION PLAT

Form C-102
Supersedes C-128
Effective 1-1-65

All distances must be from the outer boundaries of the Section.

Operator ANADARKO PRODUCTION			Lease State "AF"		Well No. 1
Unit Letter "p"	Section 1	Township 18 South	Range 28 East	County Eddy	
Actual Footage Location of Well: 660 feet from the South line and 660 feet from the East line					
Ground Level Elev. 3665.2	Producing Formation Grayburg		Pool Loco Hills Queen-Grayburg San Andres	Dedicated Acreage: 40 Acres	

1. Outline the acreage dedicated to the subject well by colored pencil or hachure marks on the plat below.
2. If more than one lease is dedicated to the well, outline each and identify the ownership thereof (both as to working interest and royalty).
3. If more than one lease of different ownership is dedicated to the well, have the interests of all owners been consolidated by communitization, unitization, force-pooling, etc?

☐ Yes ☐ No If answer is "yes," type of consolidation _____

If answer is "no," list the owners and tract descriptions which have actually been consolidated. (Use reverse side of this form if necessary.) _____

No allowable will be assigned to the well until all interests have been consolidated (by communitization, unitization, forced-pooling, or otherwise) or until a non-standard unit, eliminating such interests, has been approved by the Commission.

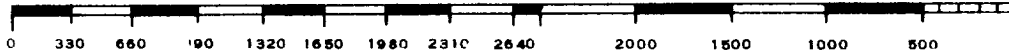
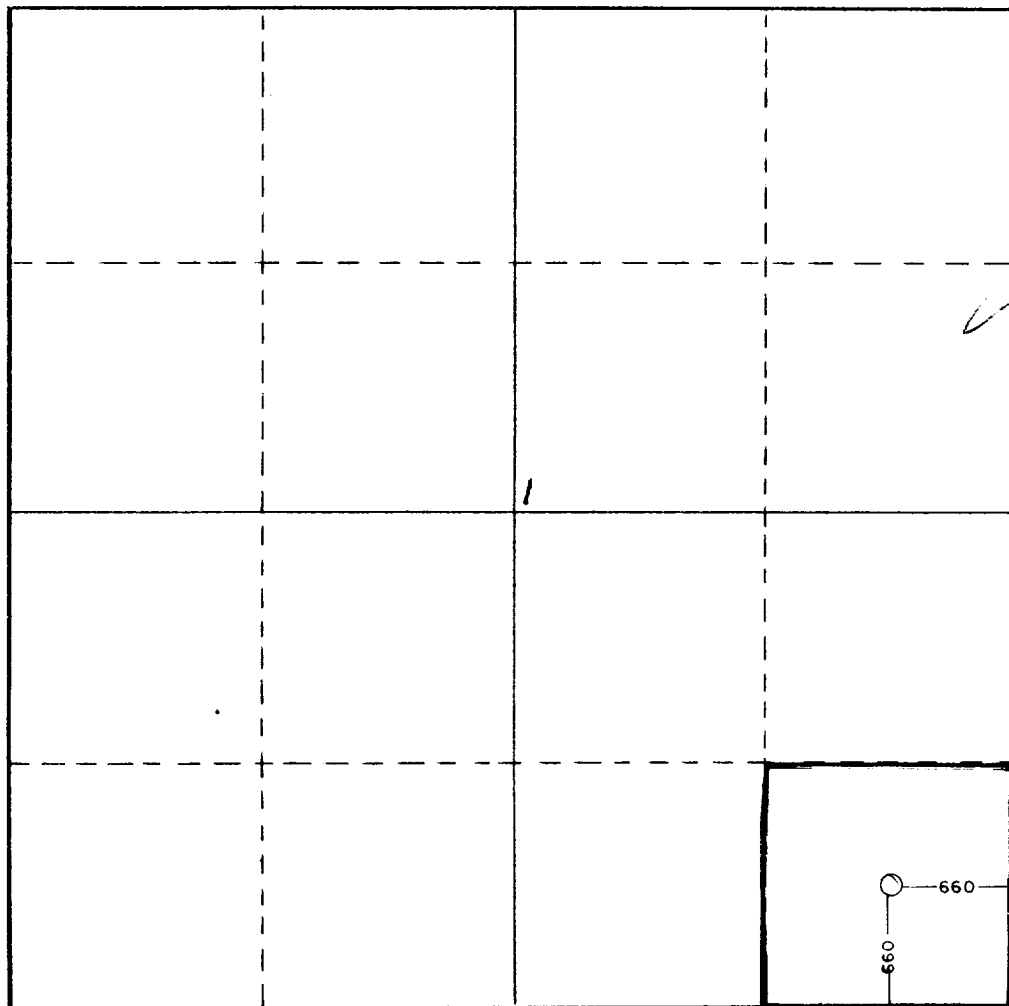

CERTIFICATION

I hereby certify that the information contained herein is true and complete to the best of my knowledge and belief.

Name **Jerry E. Buckles**

Position **Area Supervisor**

Company **Anadarko Production Company**

Date **September 6, 1984**

I hereby certify that the well location shown on this plat was plotted from field notes of actual surveys made by me or under my supervision, and that the same is true and correct to the best of my knowledge and belief.

Date Survey **September 6, 1984**

Registered Professional Engineer and/or Land Surveyor

Certificate No. **3640**

