

NO. OF COPIES RECEIVED	
DISTRIBUTION	
SANTA FE	<input checked="" type="checkbox"/>
FILE	<input checked="" type="checkbox"/>
U.S.G.S.	<input checked="" type="checkbox"/>
LAND OFFICE	<input checked="" type="checkbox"/>
OPERATOR	<input checked="" type="checkbox"/>

RECEIVED
OCT 10 1984
O. C. D.
ARTESIA, OFFICE

5A. Indicate Type of Lease
STATE ☒ FEE ☐
5. State Oil & Gas Lease No.
V-409

APPLICATION FOR PERMIT TO DRILL, DEEPEN, OR PLUG BACK

1a. Type of Work b. Type of Well OIL WELL <input checked="" type="checkbox"/> GAS WELL <input type="checkbox"/> OTHER <input type="checkbox"/> SINGLE ZONE <input checked="" type="checkbox"/> MULTIPLE ZONE <input type="checkbox"/>				7. Unit Agreement Name	
2. Name of Operator Santa Rita Exploration Corporation ✓				8. Farm or Lease Name Phoenix State	
3. Address of Operator P.O. Box 798, Artesia, New Mexico 88210				9. Well No. #1	
4. Location of Well UNIT LETTER <u>D</u> LOCATED <u>330</u> FEET FROM THE <u>North</u> LINE AND <u>990</u> FEET FROM THE <u>West</u> LINE OF SEC. <u>36</u> TWP. <u>17S</u> RGE. <u>31E</u> NMPM				10. Field and Pool, or Wildcat Maljamar Gr. S.A.	
				12. County Eddy	
19. Proposed Depth 4500'		19A. Formation San Andres		20. Rotary or C.T. Rotary	
21. Elevations (Show whether DF, RT, etc.) 3825'		21A. Kind & Status Plug. Bond Statewide		22. Approx. Date Work will start October 25, 1984	

23. PROPOSED CASING AND CEMENT PROGRAM

SIZE OF HOLE	SIZE OF CASING	WEIGHT PER FOOT	SETTING DEPTH	SACKS OF CEMENT	EST. TOP
12 1/4"	8 5/8"	24# API	1000' - 900'	500	Surface
7 7/8"	5 1/2"	15.5# J-55	4500'	800	Surface

Plan to spud a Maljamar Grayburg San Andres well October 25, 1984 with 12 1/4" bit. Set 1000' of 8 5/8" surface 24# casing, with 500 Sxs. Class C Neat. Will drill out with 7 7/8" bit to proposed depth of 4500'. If commercial shows are present, 5 1/2", 15.5# J-55 casing will be set with 800 Sxs. of Class C Neat cement and circulate to surface. If dry hole, proper plugs will be set as required by NM OCD.

BOP: Shaffer 900 Double 10" 3000#.

APPROVAL VALID FOR 180 DAYS
PERMIT EXPIRES 4-12-85
UNLESS DRILLING UNDERWAY

IN ABOVE SPACE DESCRIBE PROPOSED PROGRAM; IF PROPOSAL IS TO DEEPEN OR PLUG BACK, GIVE DATA ON PRESENT PRODUCTIVE ZONE AND PROPOSED NEW PRODUCTIVE ZONE. GIVE BLOWOUT PREVENTER PROGRAM, IF ANY.

I hereby certify that the information above is true and complete to the best of my knowledge and belief.

Signed Cheri E. Monk Title Secretary Date October 10, 1984

(This space for State Use)

Original Signed By
Mike Williams
Oil & Gas Inspector

OCT 15 1984

APPROVED BY _____ DATE _____

CONDITIONS OF APPROVAL, IF ANY:

Distances must be from the outer boundaries of 1 section.

Applicant Santa Rita Exploration		Lease Phoenix State		Well No. #1
Well Lessee D	Section 36	Township 17 S	Range 31 E	County Eddy
Actual Well Location of Well				
330	feet from the FNL	line and 990	feet from the FEL	line
Proposed Level Elev. 3827'	Producing Formation San Andres	Paul Maljamar Grayburg San Andres	Dedicated Acreage 40	Acres

1. Outline the acreage dedicated to the subject well by colored pencil or hatchure marks on the plat below.
 2. If more than one lease is dedicated to the well, outline each and identify the ownership thereof (both as to working interest and royalty).
 3. If more than one lease of different ownership is dedicated to the well, have the interests of all owners been consolidated by communitization, unitization, force-pooling, etc?
- ☐ Yes ☐ No If answer is "yes," type of consolidation _____
- If answer is "no," list the owners and tract descriptions which have actually been consolidated. (Use reverse side of this form if necessary.) _____
- No allowable will be assigned to the well until all interests have been consolidated (by communitization, unitization, forced-pooling, or otherwise) or until a non-standard unit, eliminating such interests, has been approved by the Division

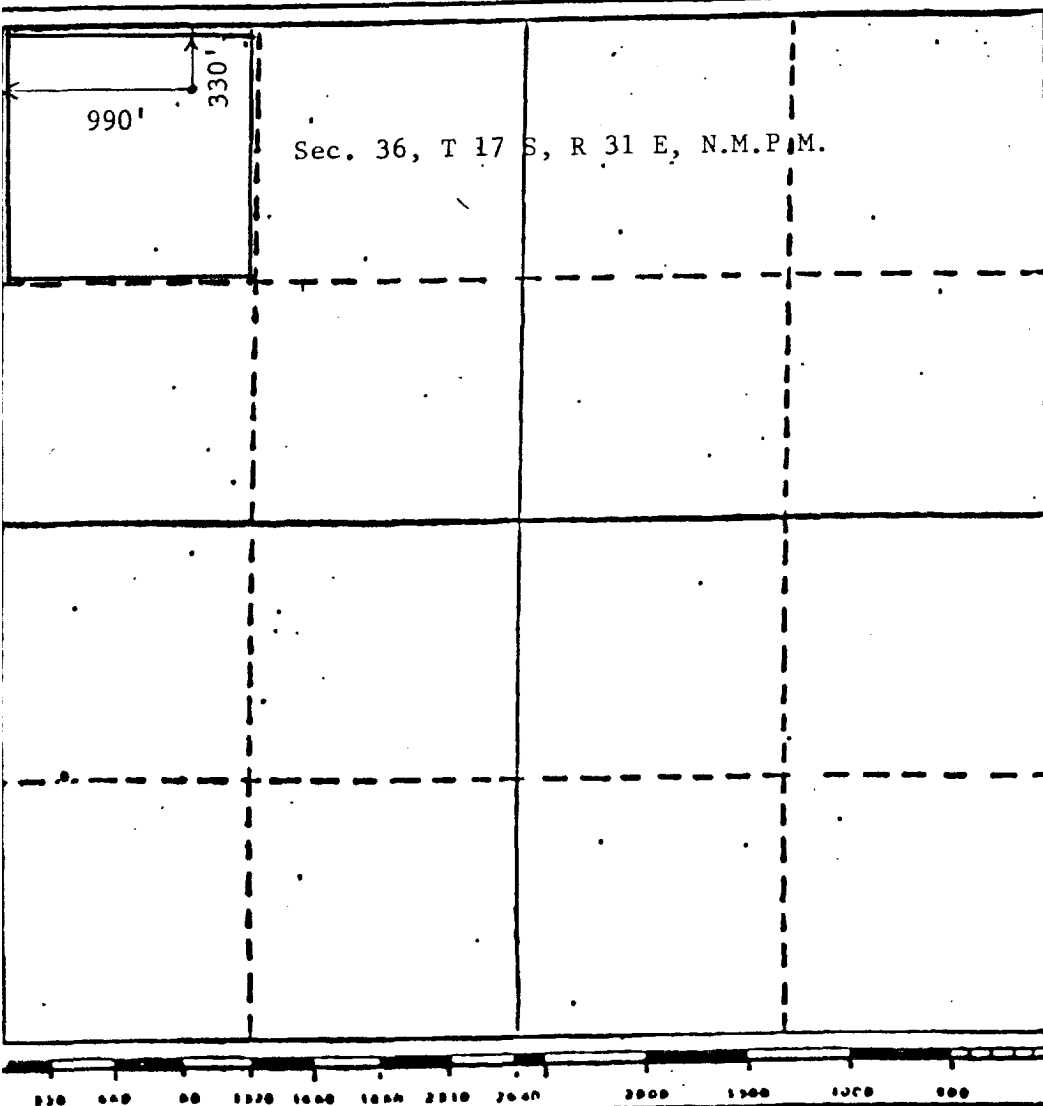

CERTIFICATION	
I hereby certify that the information contained herein is true and complete to the best of my knowledge and belief.	
<i>Cheri A. Monk</i>	
Name	Cheri A. Monk
Position	Secretary
Company	Santa Rita Exploration
Date	October 10, 1984
I hereby certify that the well location shown on this plat was plotted from field notes of actual surveys made by me or under my supervision, and that the same is true and correct to the best of my knowledge and belief.	
Date Signed	October 10, 1984
Registered Professional Engineer and/or Land Surveyor	
<i>John D. Jaquess</i>	
Certification No. 6290	