

NO. OF COPIES RECEIVED	
DISTRIBUTION	
SANTA FE	<input checked="" type="checkbox"/>
FILE	<input checked="" type="checkbox"/>
U.S.G.S.	<input checked="" type="checkbox"/>
LAND OFFICE	<input checked="" type="checkbox"/>
OPERATOR	<input checked="" type="checkbox"/>

NEW MEXICO OIL CONSERVATION COMMISSION

RECEIVED BY

OCT 22 1984

O. C. D.  
ARTESIA, OFFICE

Form C-101

Revised 1-1-85

30-015-25062

5A. Indicate Type of Lease

STATE ☒

FEE ☐

5. State Oil & Gas Lease No.

E-7179

# APPLICATION FOR PERMIT TO DRILL, DEEPEN, OR PLUG BACK

a. Type of Work

DRILL ☒

DEEPEN ☐

PLUG BACK ☐

b. Type of Well

OIL WELL ☒

GAS WELL ☐

OTHER ☐

SINGLE ZONE ☐

MULTIPLE ZONE ☐

c. Name of Operator

Arlen Dickson

d. Address of Operator

P.O. Box 50160, Midland, Texas 79710

e. Location of Well

UNIT LETTER J LOCATED 2260 FEET FROM THE South LINE

RD 1650 FEET FROM THE East LINE OF SEC. 18 TWP. 18S REC. 28E NMPM

7. Unit Agreement Name

8. Farm or Lease Name

Burmah

9. Well No.

1

10. Field and Pool, or Wildcat  
Artesia-Queen GR-SA

12. County  
Eddy

19. Proposed Depth

2700'

19A. Formation

San Andres

20. Rotary or C.T.

Rotary

f. Elevations (Show whether DF, RT, etc.)

3600' GL

21A. Kind & Status Plug. Bond

Blanket 5/10/84

21B. Drilling Contractor

Salazar Bros. Drilling

22. Approx. Date Work will start

Nov. 1, 1984

## PROPOSED CASING AND CEMENT PROGRAM

SIZE OF HOLE	SIZE OF CASING	WEIGHT PER FOOT	SETTING DEPTH	SACKS OF CEMENT	EST. TOP
12 1/4	8 5/8	24#	350'	350sxs	Surface
7 7/8	5 1/2	17#	2700'	650sxs	Surface

Plan to spud an Artesia San Andres well on Nov 1, 1984 with a 12 1/4" bit by Salazar Brothers Drilling Company and drill to 350' and set 350' of 8 5/8" 24# surface casing and cement with 350 sxs of Class "C" neat.

Then Continue to drill to a proposed depth of 2700' with a 7 7/8" bit. If commercial shows are present, run 5 1/2" 17# casing and set 650 sxs of Class "C" neat and circulate to surface.

If dry hole proper plugs will be set as perscribed by NM OCD.

APPROVAL VALID FOR 180 DAYS  
PERMIT EXPIRES 4-23-85  
UNLESS DRILLING UNDERWAY

BOP:

Rig 14: 10", 5000# SS Cameron series 1500- with Koomey 2 stage accumulator.

Posted ID!  
API - NL  
10 26-84

BELOW SPACE DESCRIBE PROPOSED PROGRAM: IF PROPOSAL IS TO DEEPEN OR PLUG BACK, GIVE DATA ON PRESENT PRODUCTIVE ZONE AND PROPOSED NEW PRODUCTION ZONE. GIVE BLOWOUT PREVENTER PROGRAM, IF ANY.

Operator hereby certify that the information above is true and complete to the best of my knowledge and belief.

Signature: Marlys Reynolds Title: Consultant

Date: 10/18/84

(This space for State Use)

ORIGINAL SIGNED  
BY LARRY BROOKS  
GEOLOGIST - NMOCDC

OCT 23 1984

APPROVED BY: \_\_\_\_\_ DATE: \_\_\_\_\_

CONDITIONS OF APPROVAL, IF ANY:

All distances must be from the outer boundaries of the Section. OCT 22 1984

Operator Dickson Petroleum		Lease Burmah State		O. C. D.		Well No. #1
Unit Letter J	Section 18	Township 18 S	Range 28 E	County ARTESIA, OFFICE Eddy		

Actual Footage Location of Well 2260		FSL		line and		1650'	FEL		line	
Ground Level Elev. 3600'	Producing Formation San Andres		Pool Potomac-Brown-Hoke SA		Dedicated Acreage 10		Acre			

1. Outline the acreage dedicated to the subject well by colored pencil or hatchure marks on the plat below.
2. If more than one lease is dedicated to the well, outline each and identify the ownership thereof (both as to working interest and royalty).
3. If more than one lease of different ownership is dedicated to the well, have the interests of all owners been consolidated by communitization, unitization, force-pooling, etc?  
☐ Yes ☐ No If answer is "yes," type of consolidation \_\_\_\_\_

If answer is "no," list the owners and tract descriptions which have actually been consolidated. (Use reverse side of this form if necessary.) \_\_\_\_\_

No allowable will be assigned to the well until all interests have been consolidated (by communitization, unitization, forced-pooling, or otherwise) or until a non-standard unit, eliminating such interests, has been approved by the Division

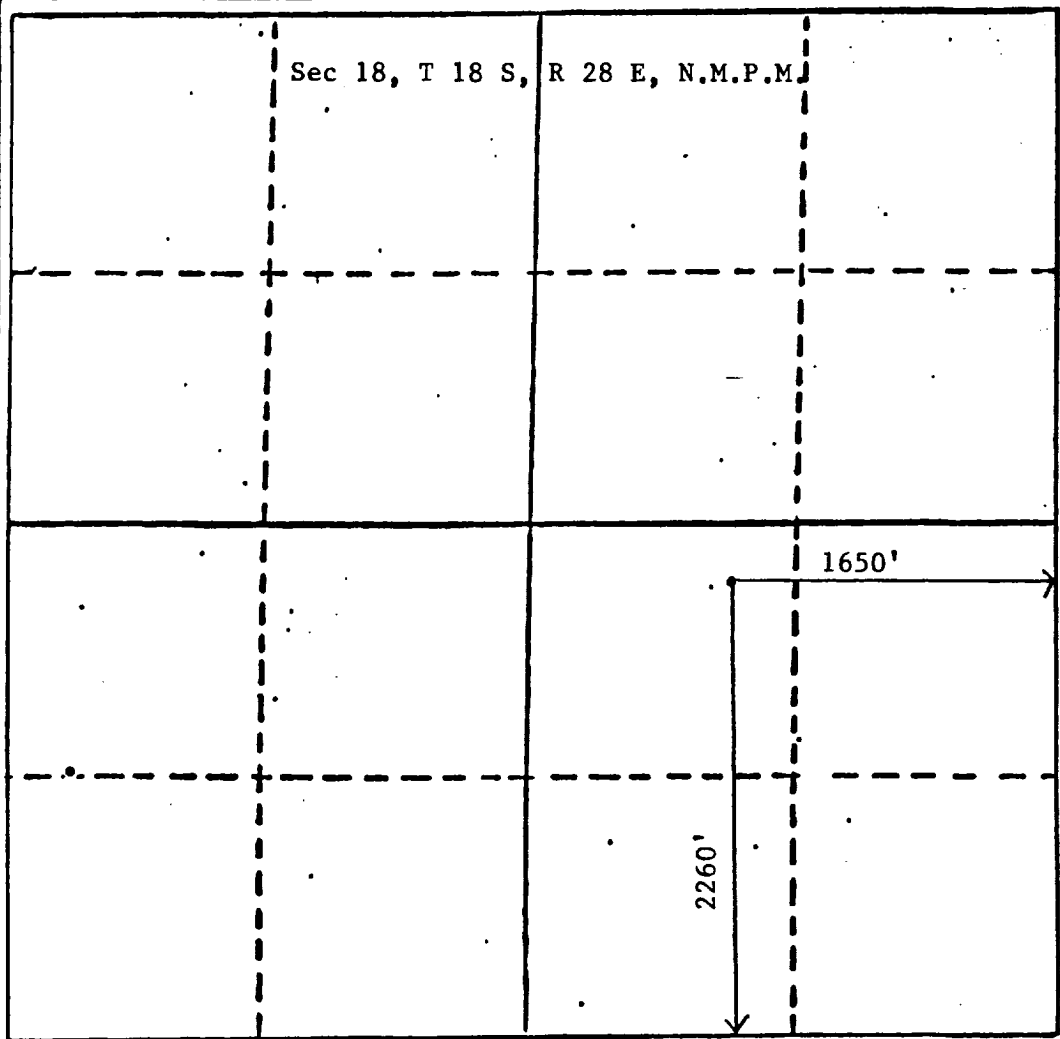

CERTIFICATION

I hereby certify that the information contained herein is true and complete to the best of my knowledge and belief.

Name Marlys Reynolds
Position Consultant
Company Dickson Petroleum, Inc.
Date 10/18/84

I hereby certify that the well location shown on this plat was plotted from field notes of actual surveys made by me or under my supervision, and that the same is true and correct to the best of my knowledge and belief.

Date Surveyed September 24, 1984
Registered Professional Engineer and/or Land Surveyor JAMES D. JACQUES, E.L. & L.S. 6290