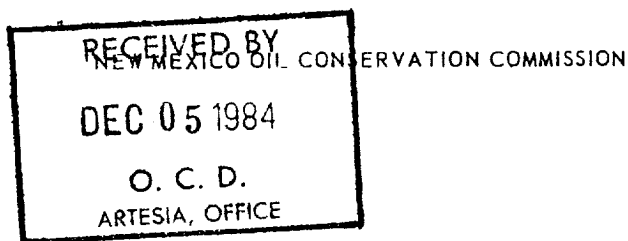

30-015-25129

NO. OF COPIES RECEIVED	
DISTRIBUTION	
SANTA FE	✓
FILE	✓
U.S.G.S.	2
LAND OFFICE	✓
OPERATOR	✓

Form C-101  
Revised 1-1-65

5A. Indicate Type of Lease STATE <input checked="" type="checkbox"/> FEE <input type="checkbox"/>
5. State Oil & Gas Lease No. B-11595

## APPLICATION FOR PERMIT TO DRILL, DEEPEN, OR PLUG BACK

1a. Type of Work DRILL <input checked="" type="checkbox"/> DEEPEN <input type="checkbox"/> PLUG BACK <input type="checkbox"/>	7. Unit Agreement Name
b. Type of Well OIL WELL <input checked="" type="checkbox"/> GAS WELL <input type="checkbox"/> OTHER <input type="checkbox"/> SINGLE ZONE <input checked="" type="checkbox"/> MULTIPLE ZONE <input type="checkbox"/>	8. Firm or Lease Name ARTESIA STATE CON
2. Name of Operator GULF OIL CORP ✓	9. Well No. 2
3. Address of Operator P.O. Box 670 Hobbs New Mexico	10. Field and Pool, or Well Unit TURKEY TRACK MORROW
4. Location of Well UNIT LETTER B LOCATED 660 FEET FROM THE NORTH LINE AND 1650 FEET FROM THE EAST LINE OF SEC. 23 TWP. 18S RGE. 28E NMPM	12. County EDDY
19. Proposed Depth 11000	19A. Formation MORROW
20. Rotary or Etc. ROTARY	
21. Elevations (Show whether DF, RI, etc.) 3522 GLE	21A. Kind & Status Plug, Bond BLANKET
21B. Drilling Contractor UNKNOWN	22. Approx. Date work will start DECEMBER 21, 1984

23.

## PROPOSED CASING AND CEMENT PROGRAM

SIZE OF HOLE	SIZE OF CASING	WEIGHT PER FOOT	SETTING DEPTH	SACKS OF CEMENT	EST. TOP
14 3/4	11 3/4	42	300	250 SCS	SURFACE
11	8 3/8	24 + 32	3000	1150 ft <sup>3</sup>	SURFACE
7 1/8	5 1/2	17	11000	~ 500 SCS	~ 7500'

BOP DRAWING FOR 2-3000 PSI WORKING PRESSURE W/ ANNUAL &amp; ROTATING HEAD

0-300 FLO SPUD MUD 8.6 ppq 9.5 pH

3000-3000 SATURATED BRINE 10.0 ppq NO CONTROL pH OR WL

3000-11000 CUT BRINE KCL DRISPAK STARCH 8.8-9.2 ppq WL 30-100

APPROVAL VALID FOR 180 DAYS  
PERMIT EXPIRES 5-12-85  
UNLESS DRILLING UNDERWAY

IN ABOVE SPACE DESCRIBE PROPOSED PROGRAM: IF PROPOSAL IS TO DEEPEN OR PLUG BACK, GIVE DATA ON PRESENT PRODUCTIVE ZONE AND PROPOSED NEW PRODUCTIVE ZONE. GIVE BLOWOUT PREVENTER PROGRAM, IF ANY.

I hereby certify that the information above is true and complete to the best of my knowledge and belief.

Signed Leslie A. Clements for PCA Title AREA PROD MGR Date 12-4-84

(This space for State Use)

APPROVED BY Leslie A. Clements TITLE Supervisor District II DATE DEC 13 1984

CONDITIONS OF APPROVAL, IF ANY:

NSL-1943

RECEIVED BY

DEC 10 1984

NEW MEXICO OIL CONSERVATION COMMISSION  
WELL LOCATION AND ACREAGE DEDICATION PLATForm C-102  
Supersedes C-128  
Effective 1-1-65

O. C. D.

All distances must be from the outer boundaries of the Section.

Operator <i>Gulf Oil Corp.</i>			Lease <i>Artesia State Com</i>			Well No. <i>2</i>		
Unit Letter <i>B</i>	Section <i>23</i>	Township <i>18S</i>	Range <i>28E</i>	County <i>El Paso</i>				
Actual Footage Location of Well: <i>660</i> feet from the <i>North</i> line and <i>1650</i> feet from the <i>East</i> line								
Ground Level Elev. <i>3522.0</i>	Producing Formation <i>Wash. Dew</i>		Pool <i>Wash. A. Junky. Tank</i>			Dedicated Acreage: <i>320</i> Acres		

1. Outline the acreage dedicated to the subject well by colored pencil or hachure marks on the plat below.
2. If more than one lease is dedicated to the well, outline each and identify the ownership thereof (both as to working interest and royalty).
3. If more than one lease of different ownership is dedicated to the well, have the interests of all owners been consolidated by communitization, unitization, force-pooling, etc?

☐ Yes ☐ No If answer is "yes," type of consolidation \_\_\_\_\_

If answer is "no," list the owners and tract descriptions which have actually been consolidated. (Use reverse side of this form if necessary.) \_\_\_\_\_

No allowable will be assigned to the well until all interests have been consolidated (by communitization, unitization, forced-pooling, or otherwise) or until a non-standard unit, eliminating such interests, has been approved by the Commission.

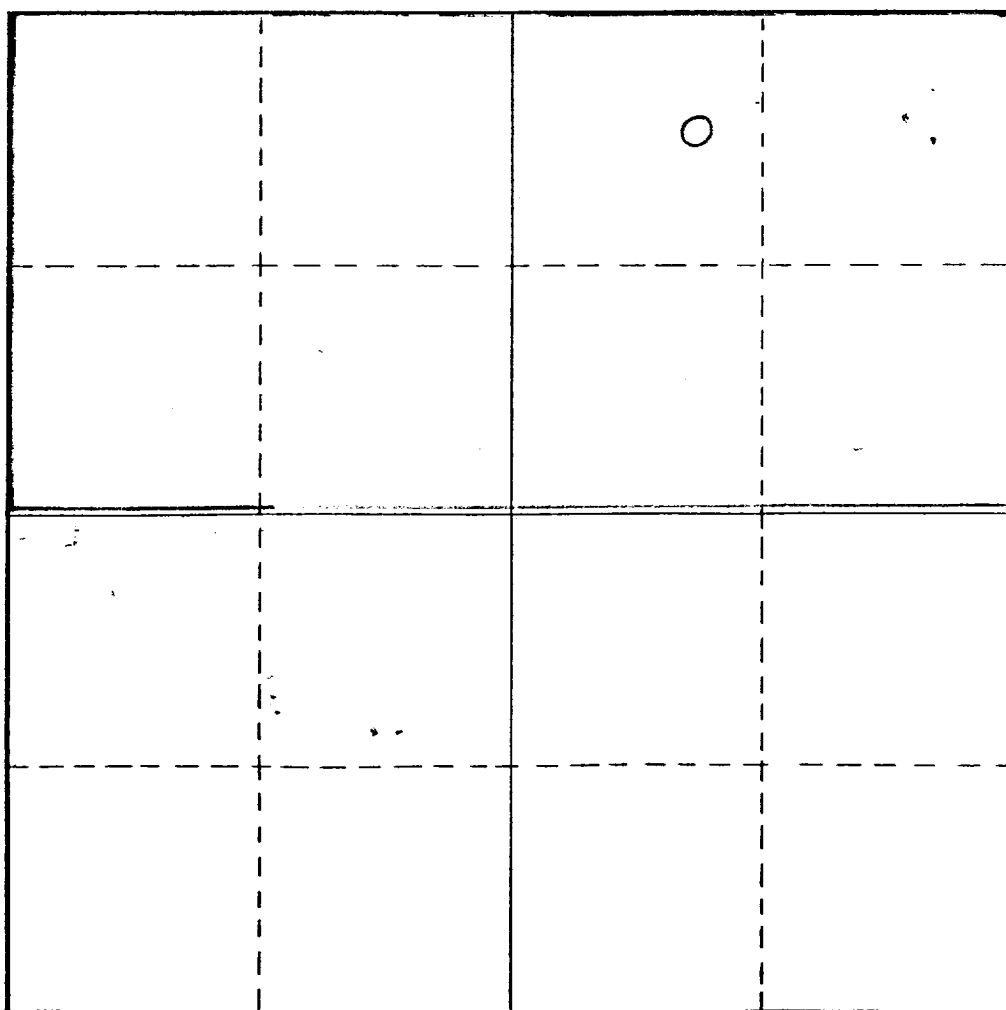

## CERTIFICATION

I hereby certify that the information contained herein is true and complete to the best of my knowledge and belief.

Name  
*for R.D. PITRE*  
Position  
*AREA ENGINEER*

Company  
*GULF OIL CORP*

Date  
*12-7-84*

I hereby certify that the well location shown on this plat was plotted from field notes of actual surveys made by me or under my supervision, and that the same is true and correct to the best of my knowledge and belief.

Date Surveyed

Registered Professional Engineer and/or Land Surveyor

Certificate No.

0 330 660 990 1320 1650 1980 2310 2640 2000 1500 1000 500 0

NEW MEXICO OIL CONSERVATION COMMISSION  
WELL LOCATION AND ACREAGE DEDICATION PLAT

Form C-102  
Supersedes C-128  
Effective 1-1-65

All distances must be from the outer boundaries of the Section

Operator GULF OIL CORP.		Lease ARTESIA STATE COM		Well No. 2
Unit Letter B	Section 23	Township 18S	Range 28E	County EDDY

Actual Footage Location of Well:

660 feet from the NORTH line and 1650 feet from the EAST line

Ground Level Elev. 3522.0	Producing Formation Morrow	Pool Tract N. Turkey Track Morrow	Dedicated Acreage: 80 Acres
------------------------------	-------------------------------	--------------------------------------	--------------------------------

1. Outline the acreage dedicated to the subject well by colored pencil or hachure marks on the plat below.
2. If more than one lease is dedicated to the well, outline each and identify the ownership thereof (both as to working interest and royalty).
3. If more than one lease of different ownership is dedicated to the well, have the interests of all owners been consolidated by communitization, unitization, force-pooling, etc?

☐ Yes ☐ No If answer is "yes," type of consolidation \_\_\_\_\_

If answer is "no," list the owners and tract descriptions which have actually been consolidated. (Use reverse side of this form if necessary.) \_\_\_\_\_

No allowable will be assigned to the well until all interests have been consolidated (by communitization, unitization, forced-pooling, or otherwise) or until a non-standard unit, eliminating such interests, has been approved by the Commission.

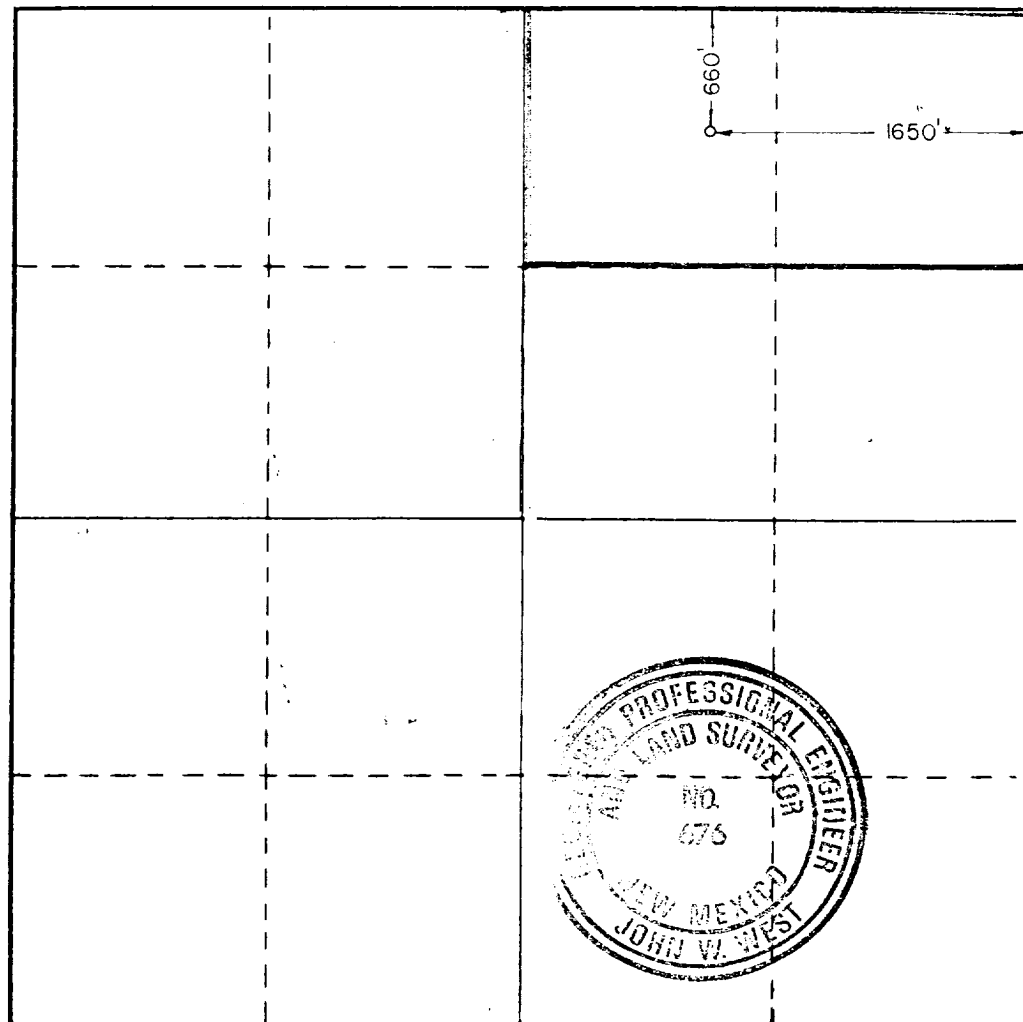

CERTIFICATION

I hereby certify that the information contained herein is true and complete to the best of my knowledge and belief.

*[Signature]*  
Name  
R.C. ANDERSON  
Position  
AREA PROD MGR  
Company  
GULF OIL CORP  
Date  
12-4-84

I hereby certify that the well location shown on this plat was plotted from field notes of actual surveys made by me or under my supervision, and that the same is true and correct to the best of my knowledge and belief.

Date Surveyed  
10/11/84

Registered Professional Engineer and/or Land Surveyor

*[Signature]*  
Certificate No. JOHN W. WEST, 676  
RONALD J. EIDSON, 3239

0 330 660 990 1320 1650 1980 2310 2640 2970 3300 3630 3960 4290 4620 4950 5280 5610 5940 6270 6600

**SPECIFY WORKING PRESSURE**

**VOIE WIEU REQUESTED**

The blowout preventer assembly shall consist of one blind ram preventer and one pipe ram preventer, both hydraulically operated, a hydraulic preventer, valves, chokes and connections, as illustrated. If a tapered drill string is used, a ram preventer shall be provided for each size of drill pipe. Coating and tubing rams to fit the preventers are to be available as needed. The ram preventers may be two tingers or a double type. If correct in size, the flanged outlets of the ram preventer may be used for connecting to the 4-inch I.D. choke flow line and to the kill line. The substructure height shall be sufficient to install a rotating blowout preventer.

**Minimum operating equipment for the preventers and hydraulically operated valves shall be as follows:** (1) multiple pumps, driven by a continuous source of power, capable of fluid charging the total accumulator volume from the nitrogen precharge pressure to its rated pressure within 2 minutes. Also, the pumps are to be connected to the hydraulic operating system which is to be a closed system. (2) accumulation with a precharge of nitrogen of not less than 750 PSI and connected so as to receive the aforementioned fluid charge. With the charging pumps shut down, the pressurized fluid volume stored in the accumulator shall be sufficient to close all the pressure-control devices simultaneously within 14 seconds after closure, the remaining accumulator pressure shall be not less than 1000 PSI with the remaining accumulator fluid volume at least 50 percent of the original. When required, either an additional source of power, remote and equivalent, is to be available to operate the above pumps, or there shall be additional pumps operated by separate power and equal in performance capabilities.

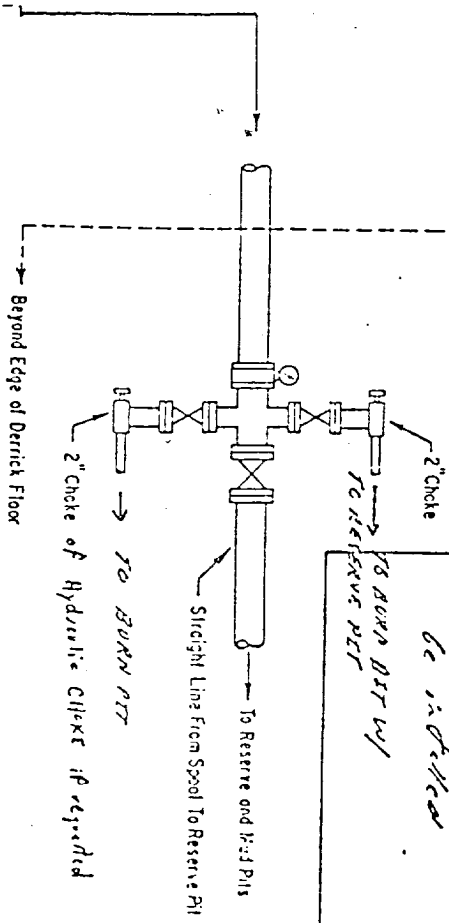

ADDITIONS - DELETIONS - CHANGES  
SPECIFY

NOTE "Under Reported" means  
at any time the Gulf System  
can, may, or will require the  
equipment to be installed during  
operations.

Rotating Board to  
be indicated

78 BORN AIR WJ  
ISSUES PER