

NO. OF COPIES RECEIVED	
DISTRIBUTION	
SANTA FE	✓
FILE	✓
U.S.G.S.	2
LAND OFFICE	
OPERATOR	✓

APPLICATION FOR PERMIT TO DRILL, DEEPEN, OR PLUG BACK

1a. Type of Work DRILL <input checked="" type="checkbox"/> DEEPEN <input type="checkbox"/> PLUG BACK <input type="checkbox"/>		7. Unit Agreement Name
b. Type of Well OIL WELL <input checked="" type="checkbox"/> GAS WELL <input type="checkbox"/> OTHER <input type="checkbox"/> SINGLE ZONE <input type="checkbox"/> MULTIPLE ZONE <input type="checkbox"/>		8. Farm or Lease Name Boykin "ACV" Com
c. Name of Operator Yates Petroleum Corporation ✓		9. Well No. 1
d. Address of Operator 207 South Fourth Street - Artesia, NM 88210		10. Field and Pool, or Wildcat Atoka Glorieta/Yeso
e. Location of Well UNIT LETTER D LOCATED 330 FEET FROM THE North LINE AND 990 FEET FROM THE West LINE OF SEC. 34 TWP. 18S RGE. 26E NMPM		12. County Eddy
19. Proposed Depth 3750'		19A. Formation Yeso
20. Rotary or C.T. Rotary		
1. Elevations (show whether DE, KI, etc.) 3377' GR	21A. Kind & Status Plug. Bond Blanket	21B. Drilling Contractor LaRue Drilling
22. Approx. Date Work will start ASAP		

PROPOSED CASING AND CEMENT PROGRAM

SIZE OF HOLE	SIZE OF CASING	WEIGHT PER FOOT	SETTING DEPTH	SACKS OF CEMENT	EST. TOP
12-1/4"	8-5/8"	24# K-55	Approx. 940'	400 sacks	Circulate
7-7/8"	5-1/2"	14# K-55	TD	500 sacks	Circulate

We propose to drill a Yeso test. 8-5/8" casing will be set to 100' below the Artesian Water zone, which will be approximately 940' and will be cemented to the surface to shut off gravel and cavings. A tapered oil string will be run and cemented, perforated and sand frac'd as needed for production.

MUD PROGRAM: Fresh water gel and LCM to 940' (or dry drill), fresh water to TD.

BOP PROGRAM: BOP's to be installed on 8-5/8" casing and tested daily for operational.

APPROVAL VALID FOR 80 DAYS
PERMIT EXPIRES 1-17-86
UNLESS DRILLING UNDERWAY

Posted Jan
APR 14 1985
7-19-85

ABOVE SPACE DESCRIBE PROPOSED PROGRAM; IF PROPOSAL IS TO DEEPEN OR PLUG BACK, GIVE DATA ON PRESENT PRODUCTIVE ZONE AND PROPOSED NEW PRODUCTIVE ZONE. GIVE BLOWOUT PREVENTER PROGRAM, IF ANY.

I hereby certify that the information above is true and complete to the best of my knowledge and belief.

Signed Cy Cowan Title Regulatory Agent Date July 12, 1985

(This space for State Use)

Original Signed By
Mike Williams

OIL AND GAS INSPECTOR

JUL 17 1985

APPROVED BY Oil & Gas Inspector

Notify N.M.O.C.C. in sufficient
time to witness cementing
the 8-5/8" casing

NEW MEXICO OIL CONSERVATION COMMISSION ON
WELL LOCATION AND ACREAGE DEDICATION PLAT

Form C-102
Supersedes C-128
Effective 1-1-65

All distances must be from the outer boundaries of the Section.

Operator YATES PETROLEUM CORP.		Lease BOYKIN ACV COM.		Well No. 1
Unit Letter D	Section 34	Township 18 South	Range 26 East	County EDDY
Actual Footage Location of Well: 990 feet from the West line and 330 feet from the North line				
Ground Level Elev. 3377.	Producing Formation YESO	Pool ATOKA GLORIETA/YESO	Dedicated Acreage: 40 Acres	

1. Outline the acreage dedicated to the subject well by colored pencil or hachure marks on the plat below.
2. If more than one lease is dedicated to the well, outline each and identify the ownership thereof (both as to working interest and royalty).
3. If more than one lease of different ownership is dedicated to the well, have the interests of all owners been consolidated by communitization, unitization, force-pooling, etc?

☒ Yes ☐ No If answer is "yes," type of consolidation Communitization

If answer is "no," list the owners and tract descriptions which have actually been consolidated. (Use reverse side of this form if necessary.) _____

No allowable will be assigned to the well until all interests have been consolidated (by communitization, unitization, forced-pooling, or otherwise) or until a non-standard unit, eliminating such interests, has been approved by the Commission.

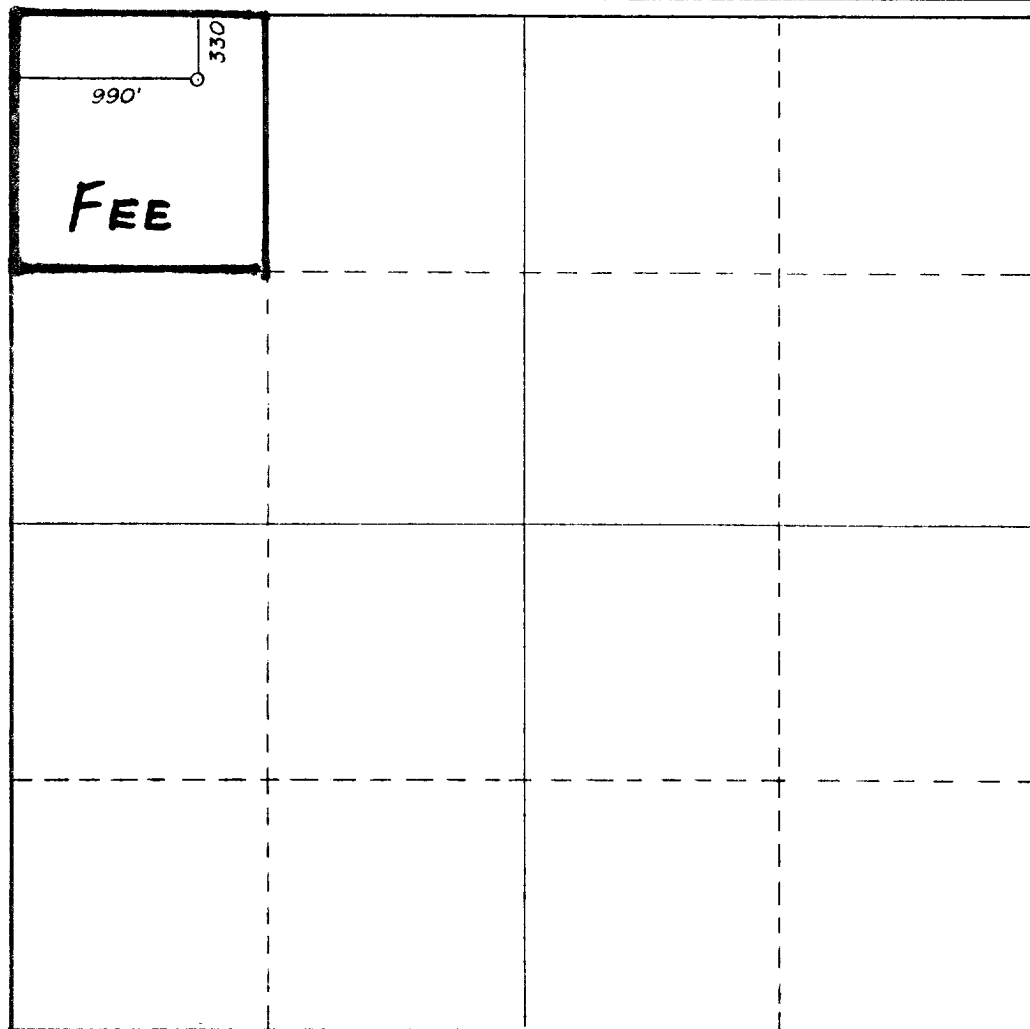

CERTIFICATION

I hereby certify that the information contained herein is true and complete to the best of my knowledge and belief.

Cy Cowan

Name

Cy Cowan

Position

Regulatory Agent

Company

Yates Petroleum Corporation

Date

July 12, 1985

DAN R. REDDY
NEW MEXICO
I hereby certify that the well location shown on this plat was plotted from field notes of actual surveys made by me or under my supervision, and that the same is true and correct to the best of my knowledge and belief.
REGISTERED PROFESSIONAL ENGINEER

Date Surveyed

JULY 10, 1985

Registered Professional Engineer and/or Land Surveyor

Dan R. Reddy

Certificate No.

NM PE and LS NO. 5412

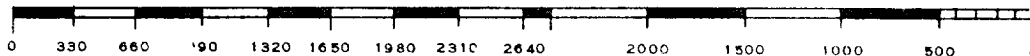

EXHIBIT B

BDP DIAGRAM

RATED 3000[#]

