

NO. OF COPIES RECEIVED	
DISTRIBUTION	
SANTA FE	<input checked="" type="checkbox"/>
FILE	<input checked="" type="checkbox"/>
U.S.G.S.	2
LAND OFFICE	<input checked="" type="checkbox"/>
OPERATOR	<input checked="" type="checkbox"/>

NEW MEXICO OIL CONSERVATION COMMISSION  
RECEIVED BY  
**JUL 26 1985**  
O. C. D.  
ARTESIA, OFFICE

Form C-101  
Revised 1-4-85

5A. Indicate Type of Lease  
STATE ☒ FEE ☐  
5. State Oil & Gas Lease No.  
E-9261

### APPLICATION FOR PERMIT TO DRILL, DEEPEN, OR PLUG BACK

1a. Type of Work b. Type of Well OIL WELL <input type="checkbox"/> GAS WELL <input checked="" type="checkbox"/> OTHER <input type="checkbox"/>		DEEPEN <input type="checkbox"/> PLUG BACK <input type="checkbox"/>		7. Unit Agreement Name	
2. Name of Operator Southland Royalty Company		8. Farm or Lease Name Midstream "16" State Co		9. Well No. 1	
3. Address of Operator 21 Desta Drive, Midland, Texas 79705		10. Field and Pool, or Wildcat Illinois Camp N (Morrow)			
4. Location of Well UNIT LETTER <u>L</u> LOCATED <u>2310</u> FEET FROM THE <u>South</u> LINE AND <u>990</u> FEET FROM THE <u>West</u> LINE OF SEC. <u>16</u> TWP. <u>18S</u> RGE. <u>28E</u> NMPM		11. County Eddy			
21. Elevations (Show whether DF, RT, etc.) 3617.1' GR		19. Proposed Depth 10,800'		19A. Formation Morrow	
21A. Kind & Status Plug. Bond <i>Blanket</i>		20. Rotary or C.T. Rotary		22. Approx. Date Work will start 8-1-85	
21B. Drilling Contractor					

### PROPOSED CASING AND CEMENT PROGRAM

SIZE OF HOLE	SIZE OF CASING	WEIGHT PER FOOT	SETTING DEPTH	SACKS OF CEMENT	EST. TOP
17 1/2"	13 3/8"	48#	400'	500 sx.	Circ.
11"	8 5/8"	28 & 24#	2300'	1100 sx.	Circ.
7 7/8"	5 1/2"	17#	10,700'	800 sx.	TOC @ + 7000'

Drill 17 1/2" hole to 400'. Set 13 3/8" csg @ 400'. Cmt w/500 sx. Circ cmt. Drill 12 1/4" hole to 2300'. Set 8 5/8" csg @ 2300'. Circ cmt. Drill 7 7/8" hole to 10,700' to test Morrow & intermediate horizons with shows. Run 5 1/2" csg to TD. Cmt w/sufficient volume to cover all prospective zones. Estimated TOC @ 7000'. Perf & stimulate Morrow for production.

MUD PROGRAM: 0-400' spud mud; 400-2800' brine; 2800-9900' clear H<sub>2</sub>O; 9900-TD cut brine, Drispac. MW 9.2-9.4, VIS 32-36, 6 cc. BHP @ TD anticipated to be 4600 psi, no abnormal pressures expected.

BOP PROGRAM: BOP to be tested after 8 5/8" csg and at 7800' - install gas separator, pit monitors and flow sensor @ 7800'.

APPROVAL VALID FOR 180 DAYS  
PERMIT EXPIRES 1-29-86  
UNLESS DRILLING UNDERWAY

IN ABOVE SPACE DESCRIBE PROPOSED PROGRAM; IF PROPOSAL IS TO DEEPEN OR PLUG BACK, GIVE DATA ON PRESENT PRODUCTIVE ZONE AND PROPOSED NEW PRODUCTIVE ZONE. GIVE BLOWOUT PREVENTER PROGRAM, IF ANY.

I hereby certify that the information above is true and complete to the best of my knowledge and belief.

Signed Daniell Roberts Title Operations Engineer Date 7/25/85

(This space for State Use)

Original Signed By

APPROVED BY Mike Williams DATE JUL 29 1985

CONDITIONS OF APPROVAL, IF ANY: Oil & Gas Inspector

NEW MEXICO OIL CONSERVATION COMMISSION  
WELL LOCATION AND ACREAGE DEDICATION PLAT

Form C-102  
Supersedes C-128  
Effective 1-1-65

All distances must be from the outer boundaries of the Section.

Operator <b>Southland Royalty Company</b>			Lease <b>Midstream 16 State Com.</b>		Well No. <b>1</b>
Unit Letter <b>L</b>	Section <b>16</b>	Township <b>18-South</b>	Range <b>28-East</b>	County <b>Eddy</b>	
Actual Footage Location of Well: <b>2310</b> feet from the <b>South</b> line and <b>990</b> feet from the <b>West</b> line					
Ground Level Elev. <b>3617.1'</b>	Producing Formation <b>Morrow</b>		Pool <b>Illinois Camp N (Morrow)</b>	Dedicated Acreage: <b>320</b> Acres	

1. Outline the acreage dedicated to the subject well by colored pencil or hachure marks on the plat below.
2. If more than one lease is dedicated to the well, outline each and identify the ownership thereof (both as to working interest and royalty).
3. If more than one lease of different ownership is dedicated to the well, have the interests of all owners been consolidated by communitization, unitization, force-pooling, etc?

☒ Yes ☐ No If answer is "yes," type of consolidation Communitization

If answer is "no," list the owners and tract descriptions which have actually been consolidated. (Use reverse side of this form if necessary.)

No allowable will be assigned to the well until all interests have been consolidated (by communitization, unitization, forced-pooling, or otherwise) or until a non-standard unit, eliminating such interests, has been approved by the Commission.

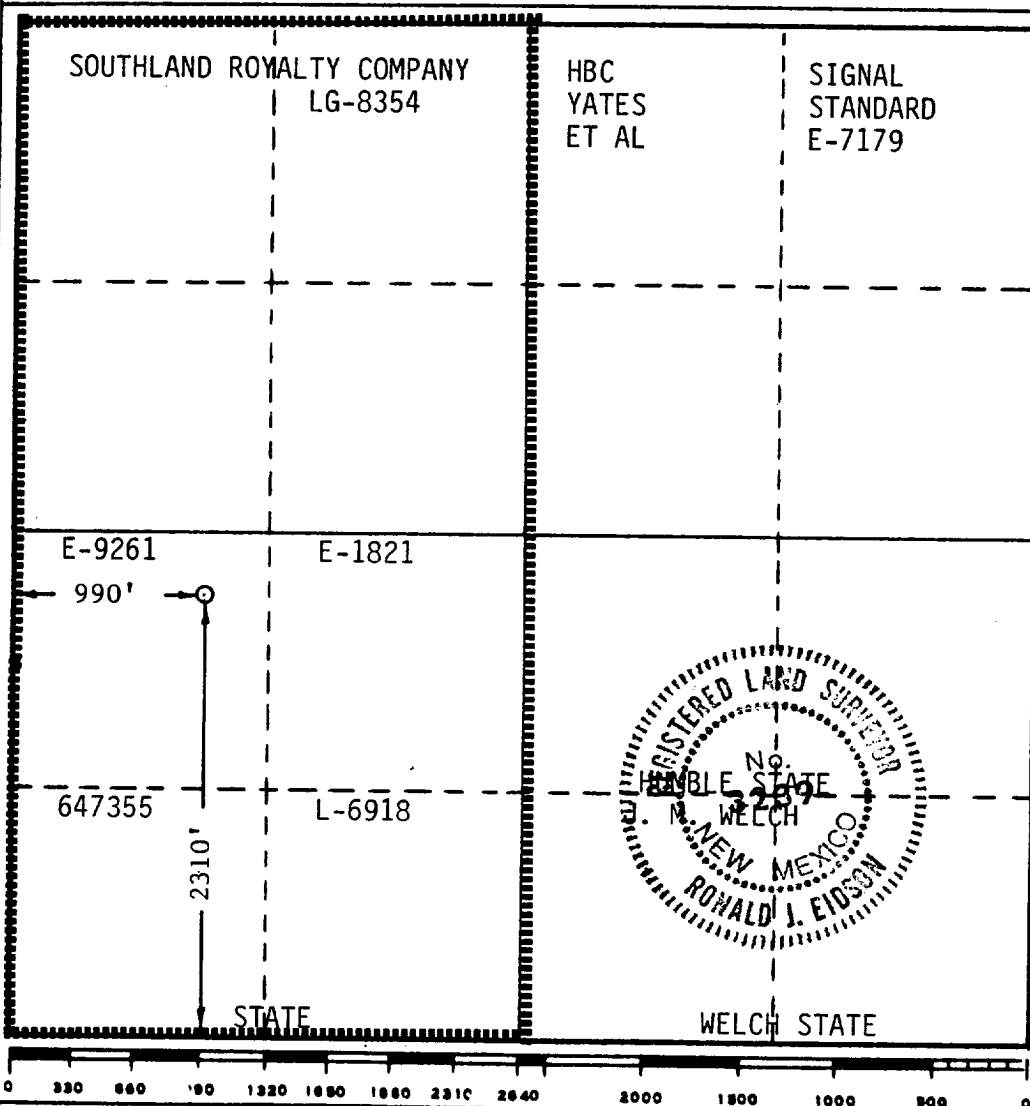

CERTIFICATION

I hereby certify that the information contained herein is true and complete to the best of my knowledge and belief.

*Darrell Roberts*

Name

**Darrell Roberts**

Position

**Operations Engineer**

Company

**Southland Royalty Company**

Date

**7/25/85**

I hereby certify that the well location shown on this plat was plotted from field notes of actual surveys made by me or under my supervision, and that the same is true and correct to the best of my knowledge and belief.

Date Surveyed

**July 24, 1985**

Registered Professional Engineer and/or Land Surveyor

*Ronald J. Eidson*

Certificate No. **JOHN W. WEST, 676**

**RONALD J. EIDSON, 3239**