

NO. OF COPIES RECEIVED	
DISTRIBUTION	
SANTA FE	✓
FILE	✓
U.S.G.S.	2
LAND OFFICE	
OPERATOR	✓

NEW MEXICO OIL CONSERVATION COMMISSION

RECEIVED BY
JUL 25 1985
O. C. D.
ARTESIA, OFFICEForm C-101
Revised 1-1-65

5A. Indicate Type of Lease STATE <input type="checkbox"/> FEE <input checked="" type="checkbox"/>
5. State Oil & Gas Lease No.
7. Unit Agreement Name
8. Farm or Lease Name WILLIAMS
9. Well No. 14
10. Field and Pool, or Wildcat Atoka Glo., Yeso
12. County Eddy
19. Proposed Depth 3750
19A. Formation Yeso
20. Rotary or C.T. Rotary
21. Elevations (Show whether DF, RT, etc.) 3288 GR
21A. Kind & Status Plug Bond State-Wide
21B. Drilling Contractor Artesia Fishing Tool
22. Approx. Date Work will start August 1, 1985

APPLICATION FOR PERMIT TO DRILL, DEEPEN, OR PLUG BACK

1a. Type of Work b. Type of Well OIL WELL <input checked="" type="checkbox"/> GAS WELL <input type="checkbox"/> OTHER <input type="checkbox"/> DRILL <input checked="" type="checkbox"/> DEEPEN <input type="checkbox"/> PLUG BACK <input type="checkbox"/> SINGLE ZONE <input type="checkbox"/> MULTIPLE ZONE <input type="checkbox"/>	2. Name of Operator H & S OIL COMPANY ✓	3. Address of Operator Suite 303, First National Bank Bldg. Artesia, NM 88210	4. Location of Well UNIT LETTER C LOCATED 660 FEET FROM THE North LINE AND 1980 FEET FROM THE West LINE OF SEC. 25 TWP. 18S RGE. 26E NMPM	7. Unit Agreement Name	8. Farm or Lease Name WILLIAMS	9. Well No. 14	10. Field and Pool, or Wildcat Atoka Glo., Yeso	12. County Eddy	19. Proposed Depth 3750	19A. Formation Yeso	20. Rotary or C.T. Rotary	21. Elevations (Show whether DF, RT, etc.) 3288 GR	21A. Kind & Status Plug Bond State-Wide	21B. Drilling Contractor Artesia Fishing Tool	22. Approx. Date Work will start August 1, 1985
---	--	--	---	------------------------	-----------------------------------	-------------------	--	--------------------	----------------------------	------------------------	------------------------------	---	---	--	--

PROPOSED CASING AND CEMENT PROGRAM

SIZE OF HOLE	SIZE OF CASING	WEIGHT PER FOOT	SETTING DEPTH	SACKS OF CEMENT	EST. TOP
12 1/2	8 5/8"	24#	960*	700	Circulate
7 7/8	5 1/2"	15#	3670	670	700'

APPROVAL VALID FOR 180 DAYS
PERMIT EXPIRES 1-31-86
UNLESS DRILLING UNDERWAY

*960' or 100' below last break.

Propose to drill and equip well in the Yeso formation. After reaching TD, logs will be run and evaluated; perforate and stimulate as necessary in attempting commercial production.

Mud Program: 0' - 960' Native mud & fresh water
960' - 3670' Commercial mud brine water with minimum properties for safe hold conditions.

BOP Program Attached

IN ABOVE SPACE DESCRIBE PROPOSED PROGRAM: IF PROPOSAL IS TO DEEPEN OR PLUG BACK, GIVE DATA ON PRESENT PRODUCTIVE ZONE AND PROPOSED NEW PRODUCTIVE ZONE. GIVE BLOWOUT PREVENTER PROGRAM, IF ANY.

I hereby certify that the information above is true and complete to the best of my knowledge and belief.

Signed Michael A. Spencer Title Partner Date 7/24/85

(This space for State Use)

Original Signed By
Mike WilliamsAPPROVED BY Oil & Gas Inspector TITLE DATE JUL 31 1985

CONDITIONS OF APPROVAL, IF ANY:

Notify N.M.O.C.C. in sufficient time to witness cementing the 8 5/8" casing

Postcard IOI
API & NL
8-2-85

NEW MEXICO OIL CONSERVATION COMMISSION
WELL LOCATION AND ACREAGE DEDICATION PLAT

RECEIVED BY

JUL 25 1985

30-015-25353

Form C-102
Supersedes C-128
Effective 1-1-65

All distances must be from the outer boundaries of the Section.

Operator H & S Oil Company		Lease Williams		O. C. D. ARTESIA OFFICE		Well No. 14	
Unit Letter C	Section 25	Township 18 South	Range 26 East	County Eddy			

Actual Footage Location of Wells:

660 feet from the North line and 1980 feet from the West line

Ground Level Elev. 3288	Producing Formation Yeso	Pool Atoka, Glorieta, Yeso	Dedicated Acreage: 40 Acres
----------------------------	-----------------------------	-------------------------------	--------------------------------

1. Outline the acreage dedicated to the subject well by colored pencil or hatchure marks on the plat below.
2. If more than one lease is dedicated to the well, outline each and identify the ownership thereof (both as to working interest and royalty).
3. If more than one lease of different ownership is dedicated to the well, have the interests of all owners been consolidated by communitization, unitization, force-pooling, etc?

☐ Yes ☐ No If answer is "yes," type of consolidation _____

If answer is "no," list the owners and tract descriptions which have actually been consolidated. (Use reverse side of this form if necessary.) _____

No allowable will be assigned to the well until all interests have been consolidated (by communitization, unitization, forced-pooling, or otherwise) or until a non-standard unit, eliminating such interests, has been approved by the Commission.

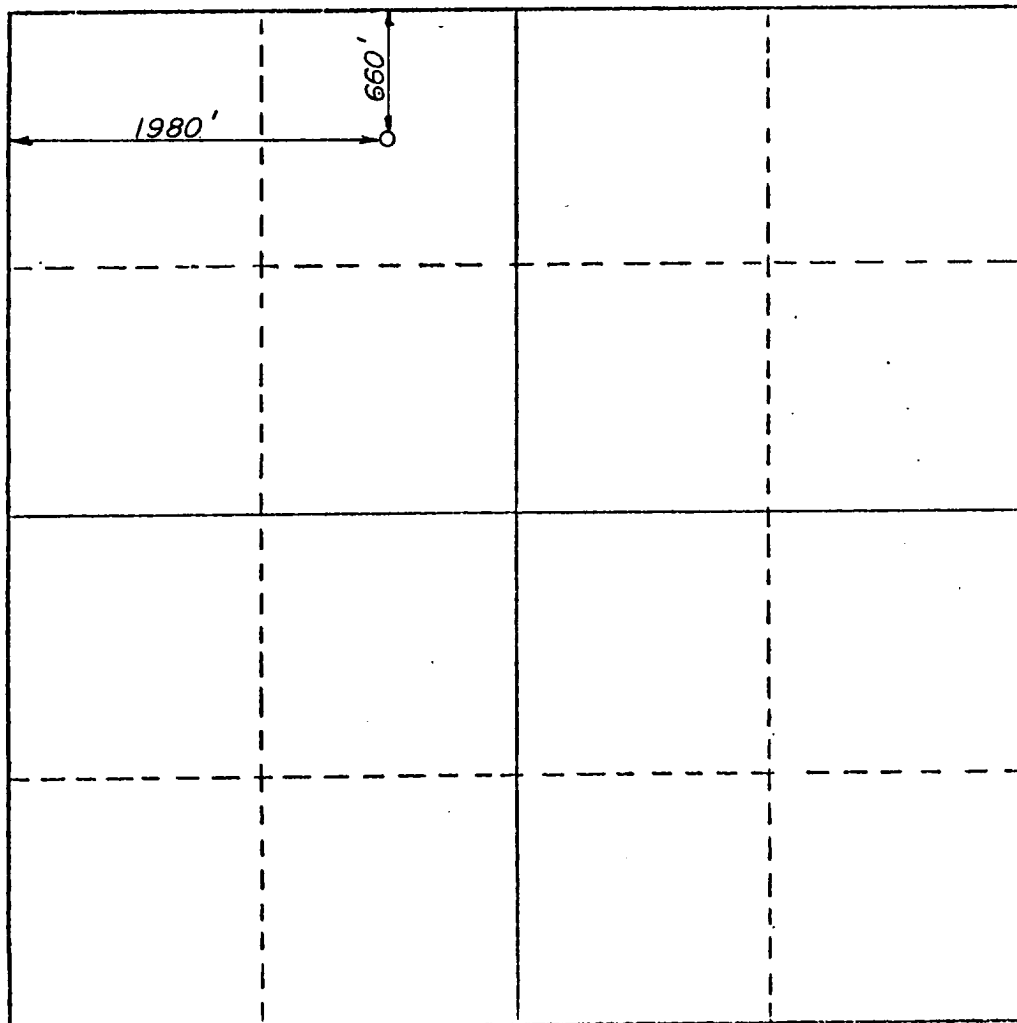

CERTIFICATION

I hereby certify that the information contained herein is true and complete to the best of my knowledge and belief.

Herbert R. Spencer

Name

Herbert R. Spencer

Position

Partner

Company

H & S Oil Company

Date

7/24/85

I hereby certify that the well location shown on this plat was plotted from field notes of actual surveys made by me or under my supervision, and that the same is true and correct to the best of my knowledge and belief.

July 19, 1985

Date Surveyed

P. R. Patton

Registered Professional Engineer and/or Land Surveyor

8112

Certificate No.

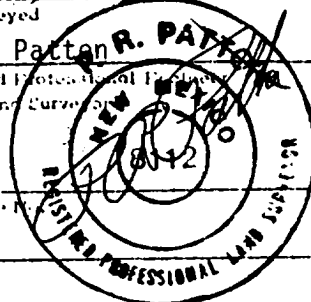

0 330 660 990 1320 1650 1980 2310 2640 2970 3300 3630 3960 4290 4620 4950 5280 5610 5940 6270 6600