

NEW MEXICO OIL CONSERVATION COMMISSION
WELL LOCATION AND ACREAGE DEDICATION PLAT

Form C-122
Supersedes C-128
Effective 1-1-85

All distances must be from the outer boundaries of the Section

Operator HARVEY E. YATES COMPANY		Lease HONDO 4 FEDERAL		Well No. 4
Tract Letter L	Section 4	Township 18 SOUTH	Range 31 EAST	County EDDY
Actual Footage Location of Well: 1980 feet from the SOUTH line and 330 feet from the WEST line				
Ground Level Elev. 2720.0'	Producing Formation Bone Springs	Pool North Shugart	Estimated Acreage: 40 Acres	

- Outline the acreage dedicated to the subject well by colored pencil or hachure marks on the plat below.
- If more than one lease is dedicated to the well, outline and identify the ownership thereof (both as to working interest and royalty).
- If more than one lease of different ownership is dedicated to the well, have the interests of all owners been consolidated by communitization, unitization, force-pooling, etc?

☐ Yes ☐ No If answer is "yes," type of consolidation

If answer is "no," list the owners and tract descriptions which have actually been consolidated. (Use reverse side of this form if necessary.)

No allowable will be assigned to the well until all interests have been consolidated (by communitization, unitization, forced-pooling, or otherwise) or until a non-standard unit, eliminating such interests, has been approved by the Commission.

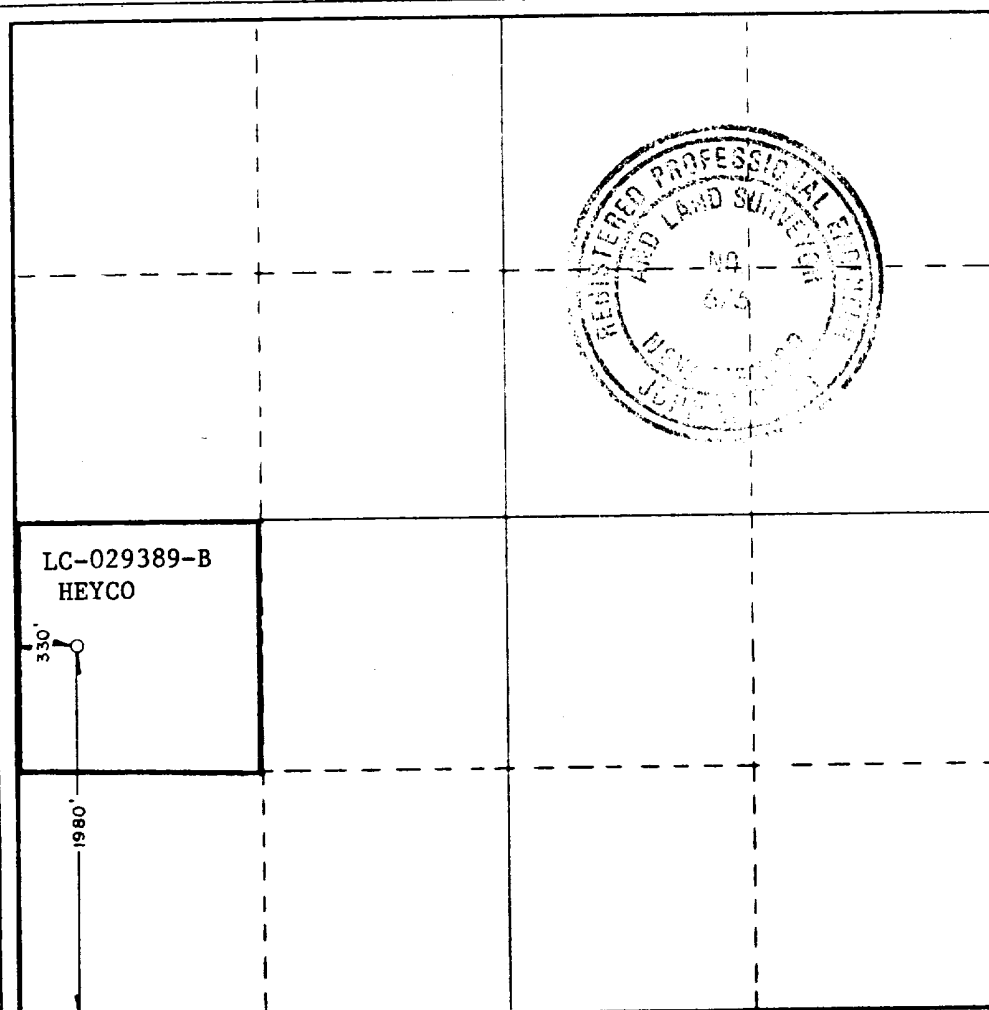
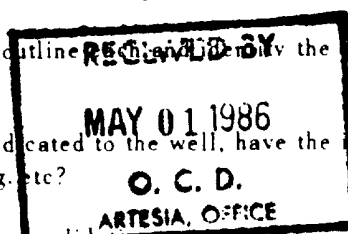

CERTIFICATION

I hereby certify that the information contained herein is true and complete to the best of my knowledge and belief

N.M. Young
Name

N.M. Young

Position

Drilling Superintendent

Company

Harvey E. Yates Company

Date

April 9, 1986

I hereby certify that the well location shown on this plat was plotted from field notes of actual surveys made by me or under my supervision, and that the same is true and correct to the best of my knowledge and belief.

Date Surveyed

MARCH 18, 1986

Registered Professional Engineer and/or Land Surveyor

Ronald J. Eidson

Certificate No. JOHN W. WEST, 676
RONALD J. EIDSON, 3239

30-015-25600

1/5F

UNITED STATES
DEPARTMENT OF THE INTERIOR
BUREAU OF LAND MANAGEMENT

APPLICATION FOR PERMIT TO DRILL, DEEPEN, OR PLUG BACK

1a. TYPE OF WORK

DRILL ☒

DEEPEN ☐

PLUG BACK ☐

b. TYPE OF WELL

OIL WELL ☒

GAS WELL ☐

OTHER

SINGLE ZONE ☐

MULTIPLE ZONE ☐

2. NAME OF OPERATOR

Harvey E. Yates Company

3. ADDRESS OF OPERATOR

P.O. Box 1933 Roswell, New Mexico 88201

4. LOCATION OF WELL (Report location clearly and in accordance with any State requirements.)

At surface

1980' FSL & 660' FWL

At proposed prod. zone SAME

RECEIVED BY

MAR 24 1986

O. C. D. X
ARTESIA, OFFICE

ut. L

5. LEASE DESIGNATION AND SERIAL NO.

LC-029389-B

6. IF INDIAN, ALLOTTEE OR TRIBAL NAME

7. UNIT AGREEMENT NAME

8. FARM OR LEASE NAME

Hondo 4 Federal

9. WELL NO.

4

10. FIELD AND POOL OR TRECANT

N. Sugar Bone Springs

11. SEC., T., R., M., OR BLM. AND SURVEY OR AREA

Sec. 4, T-18S, R-31E.

12. COUNTY OR PARISH

Eddy

13. STATE

NM

14. DISTANCE IN MILES AND DIRECTION FROM NEAREST TOWN OR POST OFFICE

6 1/4 Miles Southwest of Maljamar, New Mexico

15. DISTANCE FROM PROPOSED

LOCATION TO NEAREST

PROPERTY OR LEASE LINE, FT.

(Also to nearest drig. unit line, if any)

660'

16. NO. OF ACRES IN LEASE

480.08

17. NO. OF ACRES ASSIGNED TO THIS WELL

40

18. DISTANCE FROM PROPOSED LOCATION

TO NEAREST WELL, DRILLING, COMPLETED, OR APPLIED FOR, ON THIS LEASE, FT.

1320

19. PROPOSED DEPTH

8900'

20. ROTARY OR CABLE TOOLS

Rotary

21. ELEVATIONS (Show whether DF, RT, GR, etc.)

3720.0'

22. APPROX. DATE WORK WILL START

As soon as possible

23.

PROPOSED CASING AND CEMENTING PROGRAM

SIZE OF HOLE	SIZE OF CASING	WEIGHT PER FOOT	SETTING DEPTH	QUANTITY OF CEMENT
17 1/2	13 3/8	48 - 54.5	350	circ
11	8 5/8	24 - 32	2100	circ
7 7/8	5 1/2	15 - 20	8900	Suff to cover 600' above payzone.

MUD PROGRAM

0 - 350 Spud Mud

350 - 2100 Brine

2100 - 8900 FW

Posted I.D-1
APE-NL
3-28-86

IN ABOVE SPACE DESCRIBE PROPOSED PROGRAM: If proposal is to deepen or plug back, give data on present productive zone and proposed new productive zone. If proposal is to drill or deepen directionally, give pertinent data on subsurface locations and measured and true vertical depths. Give blowout preventer program, if any.

24.

SIGNED

N. M. Young

N.M. Young

TITLE Drilling Superintendent

DATE Feb. 17, 1986

(This space for Federal or State office use)

PERMIT NO.

Charles S. D. [unclear]

APPROVAL DATE

APPROVED BY

Area Manager

TITLE

DATE

3 20 86

CONDITIONS OF APPROVAL, IF ANY:

APPROVAL SUBJECT TO
GENERAL REQUIREMENTS AND
SPECIAL STIPULATIONS

*See Instructions On Reverse Side

Title 18 U.S.C. Section 1001, makes it a crime for any person knowingly and willfully to make to any department or agency of the United States any false, fictitious or fraudulent statements or representations as to any matter within its jurisdiction.

NEW MEXICO OIL CONSERVATION COMMISSION
WELL LOCATION AND ACREAGE DEDICATION PLAT

Form C-102
Supersedes C-128
Effective 1-1-65

All distances must be from the outer boundaries of the Section

Operator HARVEY E. YATES COMPANY		Lease HONDO 4 FEDERAL		Well No. 4
Unit Letter L	Section 4	Township 18 SOUTH	Range 31 EAST	County EDDY
Actual Footage Location of Well: 1980 feet from the SOUTH line and 660 feet from the WEST line				
Ground Level Elev. 3720.0'	Producing Formation Bone Springs	Pool Wildcat	Dedicated Acreage: 40 Acres	

1. Outline the acreage dedicated to the subject well by colored pencil or hachure marks on the plat below.
2. If more than one lease is dedicated to the well, outline each and identify the ownership thereof (both as to working interest and royalty).
3. If more than one lease of different ownership is dedicated to the well, have the interests of all owners been consolidated by communitization, unitization, force-pooling, etc?

☐ Yes ☐ No If answer is "yes," type of consolidation _____

If answer is "no," list the owners and tract descriptions which have actually been consolidated. (Use reverse side of this form if necessary.) _____

No allowable will be assigned to the well until all interests have been consolidated (by communitization, unitization, forced-pooling, or otherwise) or until a non-standard unit, eliminating such interests, has been approved by the Commission.

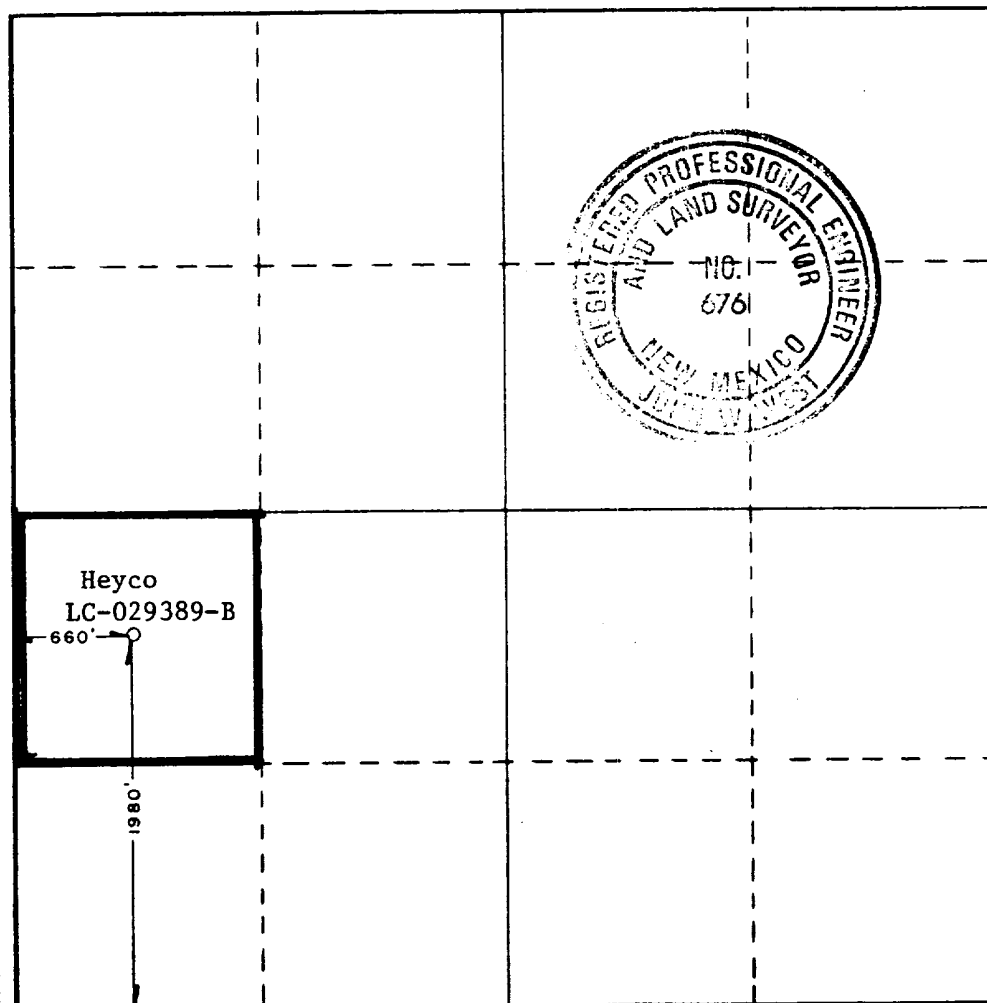

CERTIFICATION

I hereby certify that the information contained herein is true and complete to the best of my knowledge and belief.

Name
N.M. Young
Position
Drilling Superintendent
Company
Harvey E. Yates Company
Date
February 17, 1986

I hereby certify that the well location shown on this plat was plotted from field notes of actual surveys made by me or under my supervision, and that the same is true and correct to the best of my knowledge and belief.

Date Surveyed
FEBRUARY 13, 1986
Registered Professional Engineer and/or Land Surveyor

Certificate No. JOHN W. WEST, 676
RONALD J. EIDSON, 3239

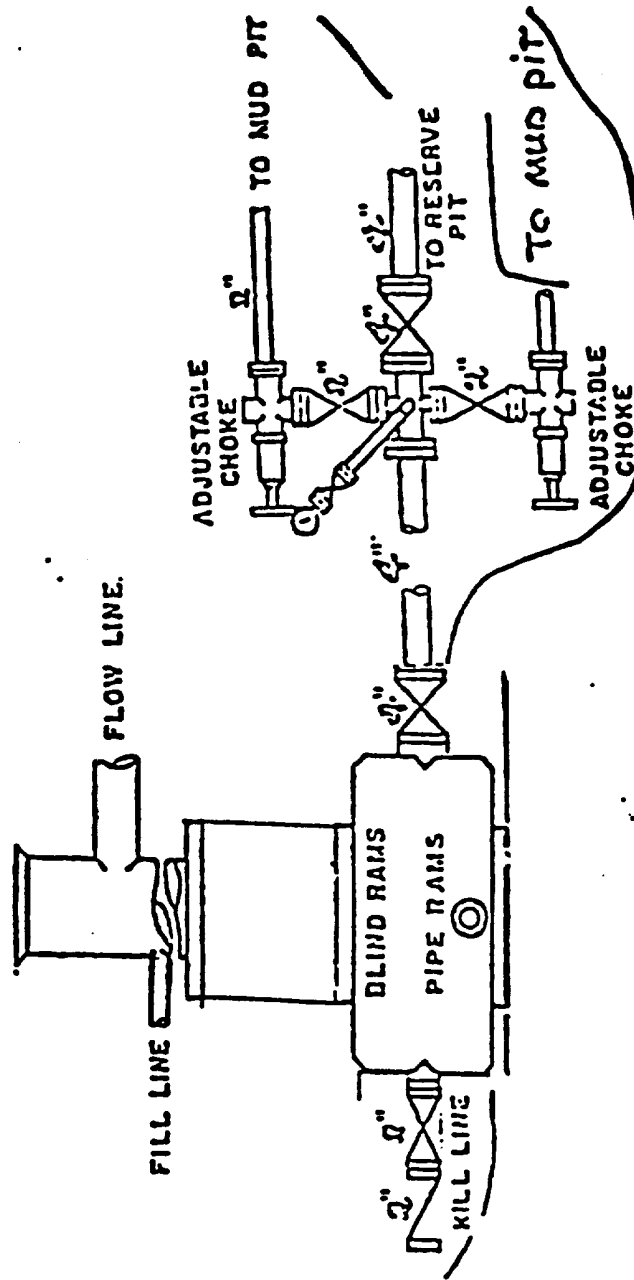

900 Series

EXHIBIT C

Harvey E. Yates Company
Hondo 4 Federal #4
Sec. 4, T-18S, R-31E
Eddy County, New Mexico

APPLICATION

HARVEY E. YATES COMPANY
Hondo 4 Federal #4
Sed. 4, T-18S, R-31E
Eddy County, New Mexico

In conjunction with Form 3160-3, Application for Permit to Drill the subject well in Section 4, Township 18 South, Range 31 East, Eddy County, New Mexico, Harvey E. Yates Company submits the following ten items of pertinent information in accordance with Bureau of Land Management requirements:

1. The geologic surface formation is quaternary alluvium and bolson deposits and other surficial deposits.

2. The estimated tops of geologic markers are as follows:

Rustler	640'	Cowden Anhy	1640'
Yates	2020'	Yates "A"	2080'
7 Rivers	2400'	Bowers	2847'
Queen	3120'	Penrose	3320'
Grayburg	3600'	San Andres	3920'
Bone Springs	5480'	TD	8900'

3. We do not anticipate finding water but have listed the formation in which we anticipate finding oil or gas.

Bone Springs 5480'.

4. Proposed casing program: See Form 3160-3.

5. Pressure control equipment: See Exhibit C.

6. Mud Program: See Form 3160-3.

7. Auxiliary equipment: Blowout preventer.

8. Testing, logging and coring programs: Two possible DST's; both in the Bone Springs. We are not planning to do any coring. Planned logs are DLL-Micro w/GR & Caliper, CN-Den w/GR & Caliper.

9. No abnormal pressures or temperatures are anticipated.

10. Anticipated starting date: As soon as possible.

T16S

T17S

T18S

T19S

T20S

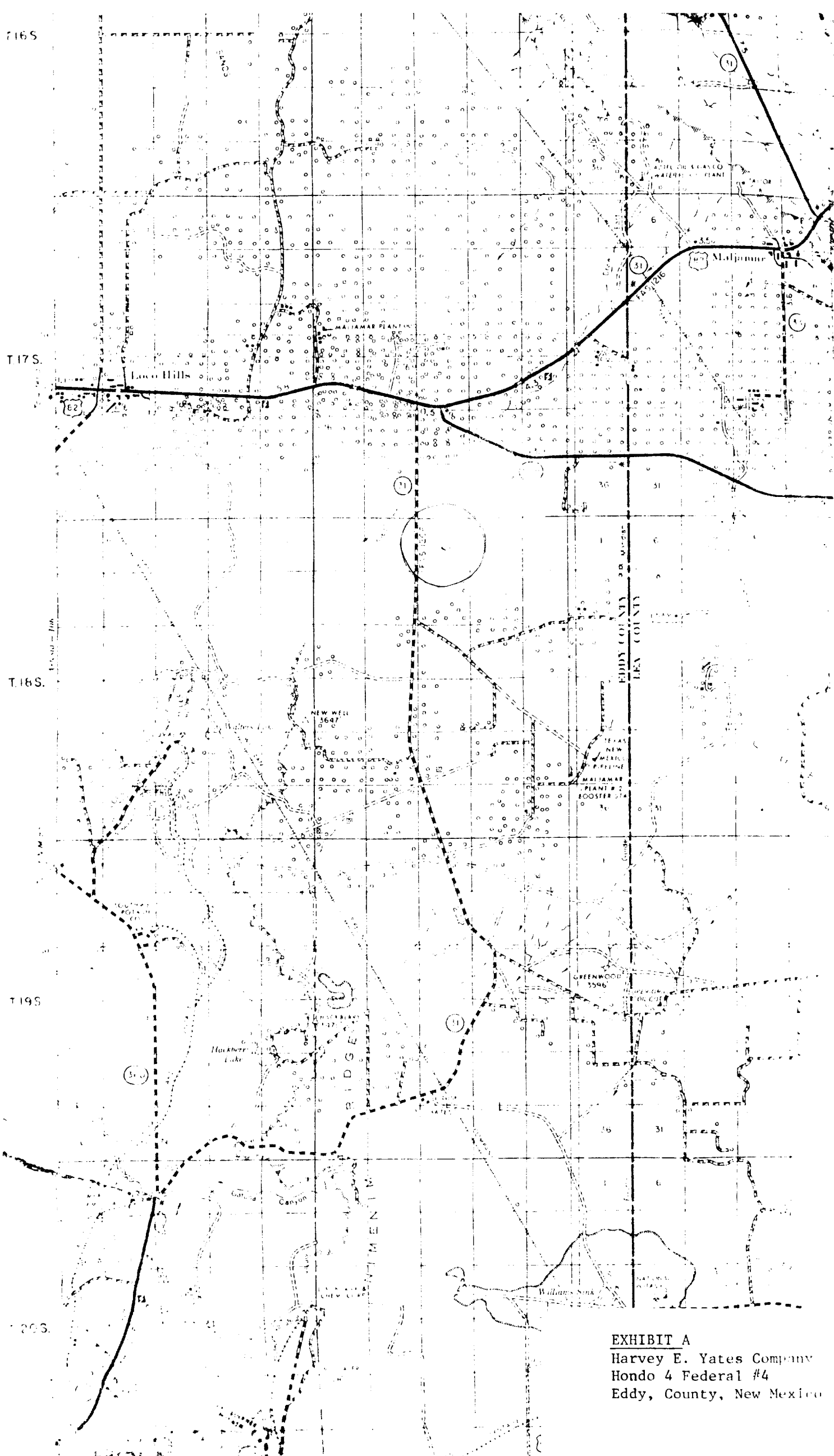

EXHIBIT A
Harvey E. Yates Company
Hondo 4 Federal #4
Eddy, County, New Mexico