

UNITED STATES DEPARTMENT OF THE INTERIOR
BUREAU OF LAND MANAGEMENT
Artesia, NM 88210

Budget Bureau No. 1004
Expires August 31, 1985

5. LEASE DESIGNATION AND SERIAL NO.

LC 029389 B

6. IF INDIAN, ALLOTTEE OR TRIBE NAME

7. UNIT AGREEMENT NAME

8. FARM OR LEASE NAME

Wilmar Federal

9. WELL NO.

4

10. FIELD AND POOL OR WILDCAT
Und. N. Shugart
Tamano (Bone Springs)

11. SEC., T., E., M., OR BLK. AND
SURVEY OR AREA

4-18S-31E

12. COUNTY OR PARISH 13. STATE

Eddy

NM

SUNDRY NOTICES AND REPORTS ON WELLS
(Do not use this form for proposals to drill or to deepen or plug back to a different reservoir.
Use "APPLICATION FOR PERMIT—" for such proposals.)

1. OIL WELL GAS WELL OTHER

2. NAME OF OPERATOR

Hondo Oil and Gas Company

3. ADDRESS OF OPERATOR

P. O. Box 1610, Midland, Texas 79702

4. LOCATION OF WELL (Report location clearly and in accordance with any State requirements.*
See also space 17 below.)
At surface

990' FNL & 2310' FWL (Unit Letter C)

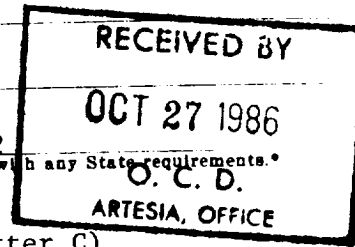

14. PERMIT NO.

15. ELEVATIONS (Show whether DF, RT, GR, etc.)

3734.9 GR

16.

Check Appropriate Box To Indicate Nature of Notice, Report, or Other Data

NOTICE OF INTENTION TO:

TEST WATER SHUT-OFF

FRACTURE TREAT

SHOOT OR ACIDIZE

REPAIR WELL

(Other)

PULL OR ALTER CASING

MULTIPLE COMPLETE

ABANDON*

CHANGE PLANS

SUBSEQUENT REPORT OF:

WATER SHUT-OFF

FRACTURE TREATMENT

SHOOTING OR ACIDIZING

(Other)

REPAIRING WELL

ALTERING CASING

ABANDONMENT*

NOTE: Report results of multiple completion on Well
(Completion or Recompletion Report and Log form.)

17. DESCRIBE PROPOSED OR COMPLETED OPERATIONS (Clearly state all pertinent details, and give pertinent dates, including estimated date of starting any proposed work. If well is directionally drilled, give subsurface locations and measured and true vertical depths for all markers and zones pertinent to this work.)*

Propose to move location.
C-102 attached.
Archaeological survey attached.

18. I hereby certify that the foregoing is true and correct

SIGNED

Ken W. Gosnell

TITLE

Engr. Tech. Spec.

DATE

10-15-86

(This space for Federal or State office use)

APPROVED BY

Orig. Sgd.

TITLE

DATE

10/23/86

CONDITIONS OF APPROVAL, IF ANY:

*See Instructions on Reverse Side

Postal ID-I
NK-
10-31-86

NEW MEXICO OIL CONSERVATION COMMISSION
WELL LOCATION AND ACREAGE DEDICATION PLAT

Form C-102
Supersedes C-128
Effective 1-1-65

All distances must be from the outer boundaries of the Section

| | | | | | |
|-----------------------------------|-------------------------------------|-------------------------------------|------------------|--------------------------------|---------------|
| Operator HONDO OIL & GAS | | Lease WILMAR FEDERAL | | | Well No. 4 |
| Tract Letter C | Section 4 | Township 18 SOUTH | Range 31 EAST | County EDDY | |
| Actual Fracture Location of Well: | | | | | |
| 990 feet from the NORTH line and | | 2310 feet from the WEST line | | | |
| Ground Level Elev. 3734.9 | Producing Formation Bone Springs | Pool Tamarito Und. N. Shugart-65 | | Dedicated Acreage: 40 Acres | |

1. Outline the acreage dedicated to the subject well by colored pencil or hachure marks on the plat below.
2. If more than one lease is dedicated to the well, outline each and identify the ownership thereof (both as to working interest and royalty).
3. If more than one lease of different ownership is dedicated to the well, have the interests of all owners been consolidated by communitization, unitization, force-pooling, etc?

Yes No If answer is "yes," type of consolidation _____

If answer is "no," list the owners and tract descriptions which have actually been consolidated. (Use reverse side of this form if necessary.) _____

No allowable will be assigned to the well until all interests have been consolidated (by communitization, unitization, forced-pooling, or otherwise) or until a non-standard unit, eliminating such interests, has been approved by the Commission.

RECEIVED BY
OCT 27 1986
O. C. D.
ARTESIA, OFFICE

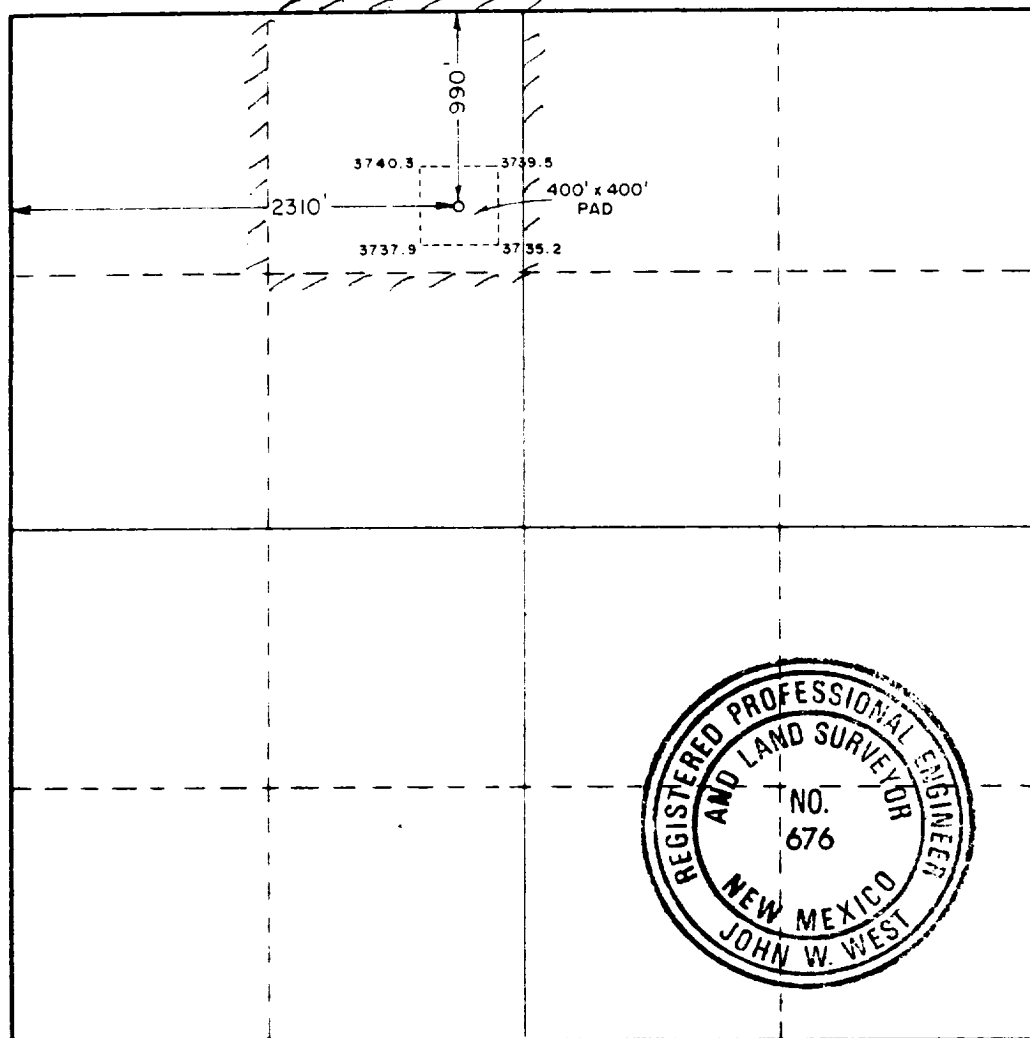

CERTIFICATION

I hereby certify that the information contained herein is true and complete to the best of my knowledge and belief.

Ken W. Gosnell

Name
Ken W. Gosnell

Position
Engr. Tech Spec.

Company
Hondo Oil and Gas Co.

Date
10-15-86

I hereby certify that the well location shown on this plat was plotted from field notes of actual surveys made by me or under my supervision, and that the same is true and correct to the best of my knowledge and belief.

Date Surveyed
OCTOBER 8, 1986

Registered Professional Engineer
and/or Land Surveyor

John W. West

Certificate No. JOHN W. WEST, 676
RONALD J. EIDSON, 3239

Archaeological Clearance Report

for

HONDO OIL AND GAS COMPANY

Wilmar Federal Well No. 4

Prepared

By

Dr. J. Loring Haskell

Submitted

By

Dr. J. Loring Haskell
Principal Investigator
New Mexico Archaeological Services, Inc.
Carlsbad, New Mexico

10 October 1986

Permit No. 14-2920-86-C

Report Number: NMAS-1986-9-0

ABSTRACT

New Mexico Archaeological Services, Inc., representing HONDO OIL AND GAS COMPANY, Hobbs, undertook a Class III survey of Bureau of Land Management lands scheduled to be impacted by the construction of a drill location. Field work was conducted under partly cloudy conditions with light winds in mid-day. The proposed location will measure 400 X 400 ft (actual area surveyed 4.44 acres). It will be situated in Section 4, T18S, R31E, NMPM, Lea County, New Mexico. No cultural properties were recorded during this survey; therefore, NMAS is suggesting clearance for HONDO OIL AND GAS COMPANY's proposed work.

Introduction

On 9 October 1986, New Mexico Archaeological Services, Inc., (NMAS), Carlsbad, undertook for HONDO OIL AND GAS COMPANY, Hobbs, an archaeological survey of federal lands administered by the Bureau of Land Management in Lea County, New Mexico. The reconnoitered area will be impacted by the construction of a drill location. This project was advanced by Mr. Dean McDaniels, HONDO OIL AND GAS COMPANY and administered by Dr. J. Loring Haskell, Principal Investigator, NMAS, Inc. This survey was undertaken by Dr. Haskell. Field work was conducted under partly cloudy conditions with light winds during mid-day. Ground visibility ranges between 70 and 85%. Field time one hour.

Survey Technique

For this investigation, HONDO OIL AND GAS COMPANY's proposed location was reconnoitered for evidence of man's past activities by walking it in a series of 25 ft wide, close interval (15° or less), zigzag transects. In addition, an added zone extending 20 ft on each side of the staked 400 X 400 ft location, and lying outside the bounds of the proposed work area was reconnoitered by a similar means. The proposed location is situated next to an existing lease road. Methodologically, this procedure served to promote optimal conditions for the visual examination of the area to be impacted by construction-related activities.

Wilmar Federal Well No. 4

Location

The proposed location will measure 400 X 400 ft (actual area surveyed 4.44 acres) on federal lands and will be situated 990 ft

from the north line and 2310 ft from the west line.

Section 4, T18S, R31E, NMPM, Lea County, NM

Thus it will be situated in the:

NE $\frac{1}{4}$ NW $\frac{1}{4}$, Section 4, T18S, R31E, NMPM, Lea County, NM

The proposed location is situated next to an existing lease road.

Map References: USGS LOCO HILLS QUADRANGLE, 7.5 Minute Series,
1985, Prov. Ed.
USGS MALJAMAR QUADRANGLE, 7.5 Minute Series,
1985, Prov. Ed.

Excepting where it borders the existing lease road on the west, the site of the proposed location has not been impacted by previous construction.

Terrrain

HONDO OIL AND GAS COMPANY's proposed location will be situated on an aeolian-mantled landform which in its broader context is coextensive with the Querecho Plains. Coppice dunes, generally well developed, and closed, typically hemispherically shaped, deflation basins are characteristic of the landform as a whole. Surficial deposits are composed of Holocene- and Pleistocene-aged of sandy laoms and loamy sands and harbor occasional cherty gravels. Taxonomically, soil individuals fall within the Typic Torripsamment subgroup/Kermit- Berino Series. Elevation is approximately 3740 ft. Local drainage is of an internal nature owing to the permeable condition of attendant soil individuals. Nearest potable water supply occurs in the form of seeps and springs along the base of the Loco Hills polje to the south-southwest and in the Laguna Valley to the south. Ephemeral sources are often available in areal dolines following heavy rains.

Floristics

Local soil individuals, falling with the Typic Torripsamment taxon, are supportive of a scrub vegetative cover. Principal plants of the floral community's overstory are Quercus havardii, Yucca glauca, and Artemisia filifolia, along with less prevalent Prosopis juliflora and Sapindus drummondii. Major forbs of this association are Eriogonum rotundifolium, Froelichia sp., Senecio spartioides, Machaeranthera linearis, Helianthus sp., Gillia sp., Dithyrea sp., Heliotropium sp., Shrankia occidentalis, Phyllanthus sp., Eriogonum annuum, Suaeda sp., Oenothera sp. and Dalea lachnostachys. Most commonly occurring grasses are Aristida sp., Andropogon spp., Cenchrus incertus, Bouteloua sp., Munroa squarrosa, Paspalum sp., Muhlenbergia porterii, Muhlenbergia arenaceous and Stipa neomexicana.

Cultural Resources

Prefield 12 September 1986, Diane Drobka, no archaeological sites

No cultural properties were recorded during the course of this survey. Reasons cited for their absence include the exceptionally thick deposit of aeolian material and its concomitant stability along with a deficiency of potable water. Land usage should have focused on hunting and gathering activities throughout prehistory. Most utilization should have occurred during Archaic and Eastern Jornada Mogollon times. Mammalian forms taken in the past should have included Antilocapra, Lepus, Sylvilagus and at times Bison.

Recommendations

NMAS recommends for HONDO OIL AND GAS COMPANY's proposed Willmar Federal Well No. 4 and suggests that work-related activities

proceed in accordance with company plans (Fig. 1). Clearance, of course, is granted by the Bureau of Land Management. If cultural properties are encountered during construction, the BLM and NMAS should be notified immediately. Duned settings are notorious for covering and uncovering cultural properties.

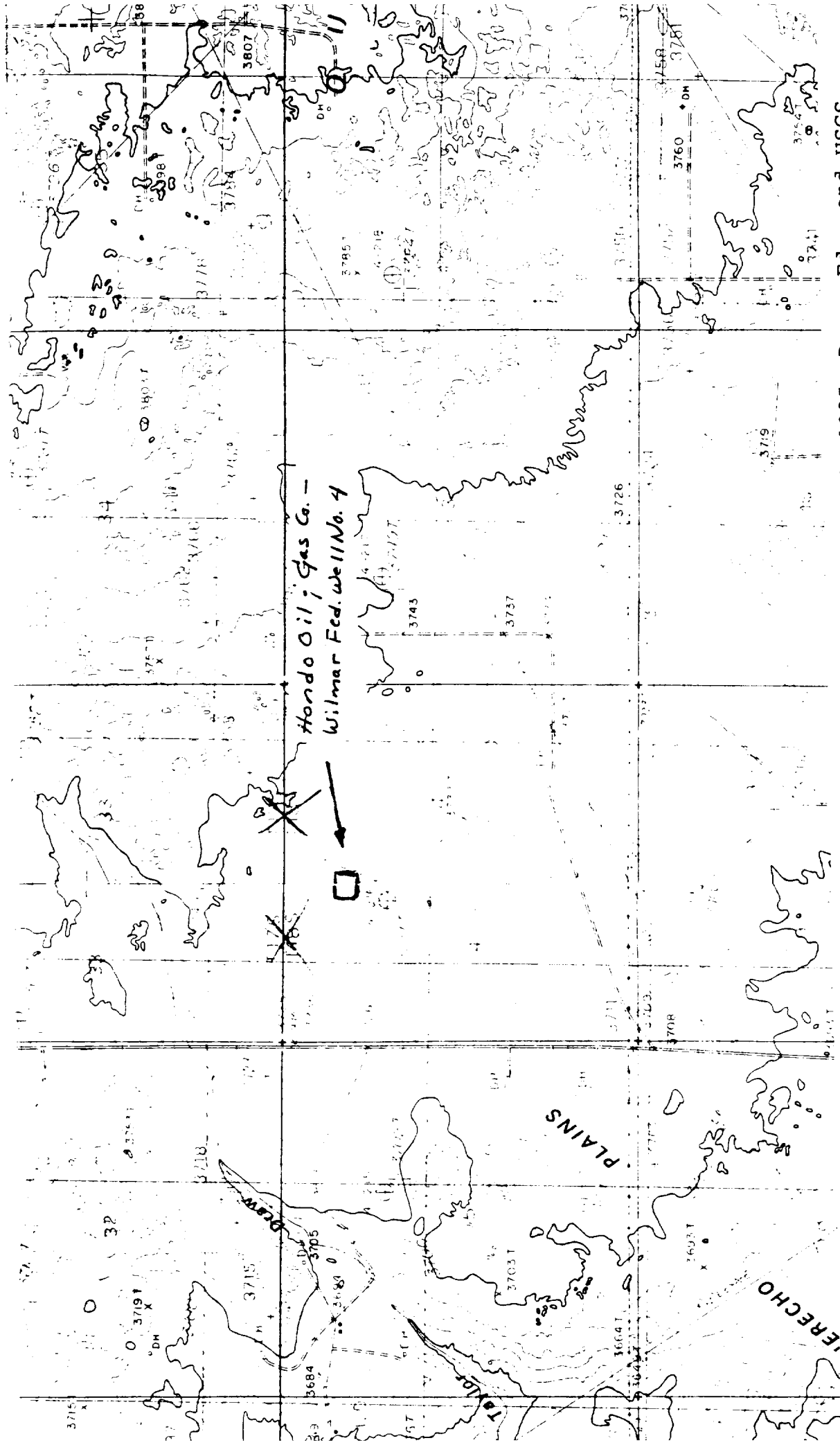

Fig. 1. USGS LOCO HILLS QUADRANGLE, 7.5 Minute Series, 1;24,000, 1985, Prov. Ed., and USGS MALJAMAR QUADRANGLE, 7.5 Minute Series, 1;24,000, 1985, Prov. Ed., showing HONDO OIL AND GAS COMPANY's proposed Wilmar Federal Well No. 4, 990 FNL, 2310 FWL, Section 4, T18S, R31E, NMPM, Lea County, New Mexico.