

Form 3160-3
(November 1983)
(formerly 9-331C)

NM OIL & GAS COMMISSION
Drewary PD

Artesia, NM 88210

UNITED STATES
DEPARTMENT OF THE INTERIOR
BUREAU OF LAND MANAGEMENT

SUBMIT BY
RECEIVED BY
(Other instructions on
reverse side)

MAY 29 1986

Form approved.
Budget Bureau No. 1004-0136
Expires August 31, 1985

30-015-25636

APPLICATION FOR PERMIT TO DRILL, DEEPEN, OR PLUG BACK

1a. TYPE OF WORK

DRILL ☒

DEEPEN ☐

PLUG BACK ☐

b. TYPE OF WELL

OIL
WELL ☒

GAS
WELL ☐

OTHER

SINGLE
ZONE ☒

MULTIPLE
ZONE ☐

2. NAME OF OPERATOR

Hondo Oil and Gas Company

3. ADDRESS OF OPERATOR

P.O. Box 1610 - Midland, Texas 79702

4. LOCATION OF WELL (Report location clearly and in accordance with any State requirements.)

At surface

1980' FNL and 660' FWL (Unit Letter E)

At proposed prod. zone

Same as above

14. DISTANCE IN MILES AND DIRECTION FROM NEAREST TOWN OR POST OFFICE*

7 miles Southeast of Loco Hills, New Mexico

15. DISTANCE FROM PROPOSED*

LOCATION TO NEAREST
PROPERTY OR LEASE LINE, FT.
(Also to nearest drig. unit line, if any)

660'

16. NO. OF ACRES IN LEASE

240

17. NO. OF ACRES ASSIGNED
TO THIS WELL

40

18. DISTANCE FROM PROPOSED LOCATION*

TO NEAREST WELL, DRILLING, COMPLETED,
OR APPLIED FOR, ON THIS LEASE, FT.

1867'

19. PROPOSED DEPTH

8700'

20. ROTARY OR CABLE TOOLS

Rotary

21. ELEVATIONS (Show whether DF, RT, GR, etc.)

GR 3726.8'

22. APPROX. DATE WORK WILL START*
As soon as permit is
approved

23.

PROPOSED CASING AND CEMENTING PROGRAM

SIZE OF HOLE	SIZE OF CASING	WEIGHT PER FOOT	SETTING DEPTH	QUANTITY OF CEMENT
17-1/2"	13-3/8"	48# H-40	680'	650 sx Circ
11"	8-5/8"	24# K-55	2150'	800 sx Circ
7-7/8"	5-1/2"	15.5# K-55	8700'	1700 sx TOC @ 1500'
		17#		

Propose to drill a Tamano (Bone Springs) development well and test for commercial production.

Blowout Preventer Program attached.

IN ABOVE SPACE DESCRIBE PROPOSED PROGRAM: If proposal is to deepen or plug back, give data on present productive zone and proposed new productive zone. If proposal is to drill or deepen directionally, give pertinent data on subsurface locations and measured and true vertical depths. Give blowout preventer program, if any.

24.

SIGNED

Gregory

TITLE Drilling Engineer

DATE 5-12-86

(This space for Federal or State office use)

PERMIT NO.

APPROVAL DATE

APPROVED BY

TITLE

DATE

5-28-86

CONDITIONS OF APPROVAL, IF ANY:

APPROVAL SUBJECT TO
GENERAL REQUIREMENTS AND
SPECIAL STIPULATIONS

*See Instructions On Reverse Side

Title 18 U.S.C. Section 1001. makes it a crime for any person knowingly and willfully to make to any department or agency of the

Form C-100
Supersedes C-100-1
Effective 1-1-83

HONDO OIL & GAS COMPANY		WILMAR FEDERAL		Well No. 5	
Section	Block	Range	County		
E	4	18 SOUTH	31 EAST	EDDY	
Approximate Location of Well:					
1980 feet from the NORTH line and		600 feet from the WEST line			
Ground Level Elev.	Producing Formation	Pool	Dedicated Area:		
3724.8'	Bone Springs	Und. H. St. Tamano			40

- Yes ☐ No ☐ If answer is "yes," type of consolidation _____

No allowable will be assigned to the well until all interests have been consolidated (by communitization, unitization, forced-pooling, or otherwise) or until a non-standard unit, eliminating such interests, has been approved by the Commission.

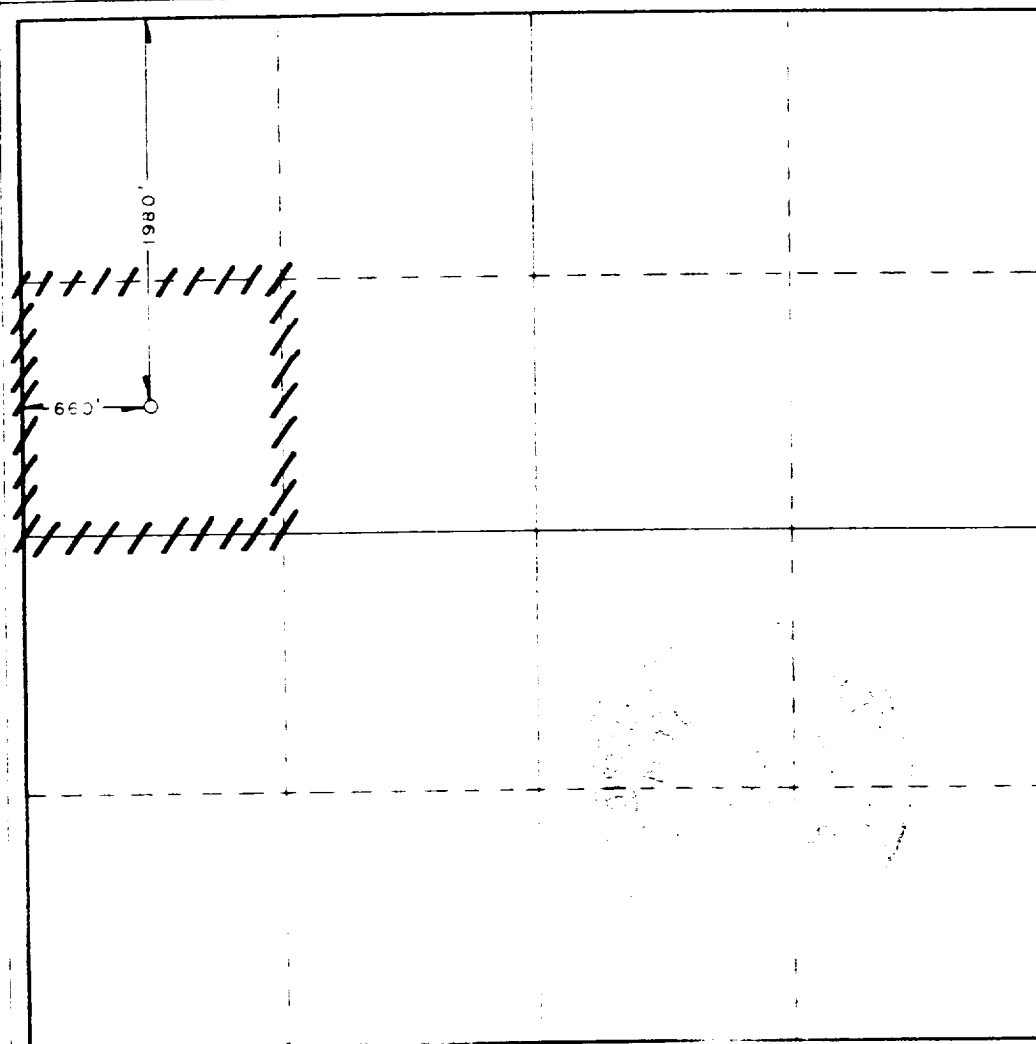

I hereby certify that the information contained herein is true and complete to the best of my knowledge and belief.

Drilling Engineer
ARCO Oil and Gas Co.
Div. of Atlantic Richfield Co.
May 12, 1986

I hereby certify that the well loca-
shown on this plat was plotted from field
notes of actual surveys made by me or
under my supervision, and that the same
is true and correct to the best of my
knowledge and belief.

Chief Surveyor
U.S. Coast and Geodetic Survey
Washington, D.C.

Certificate No	JOHN W. WEST,	474
	RONALD J. EIDSON,	103

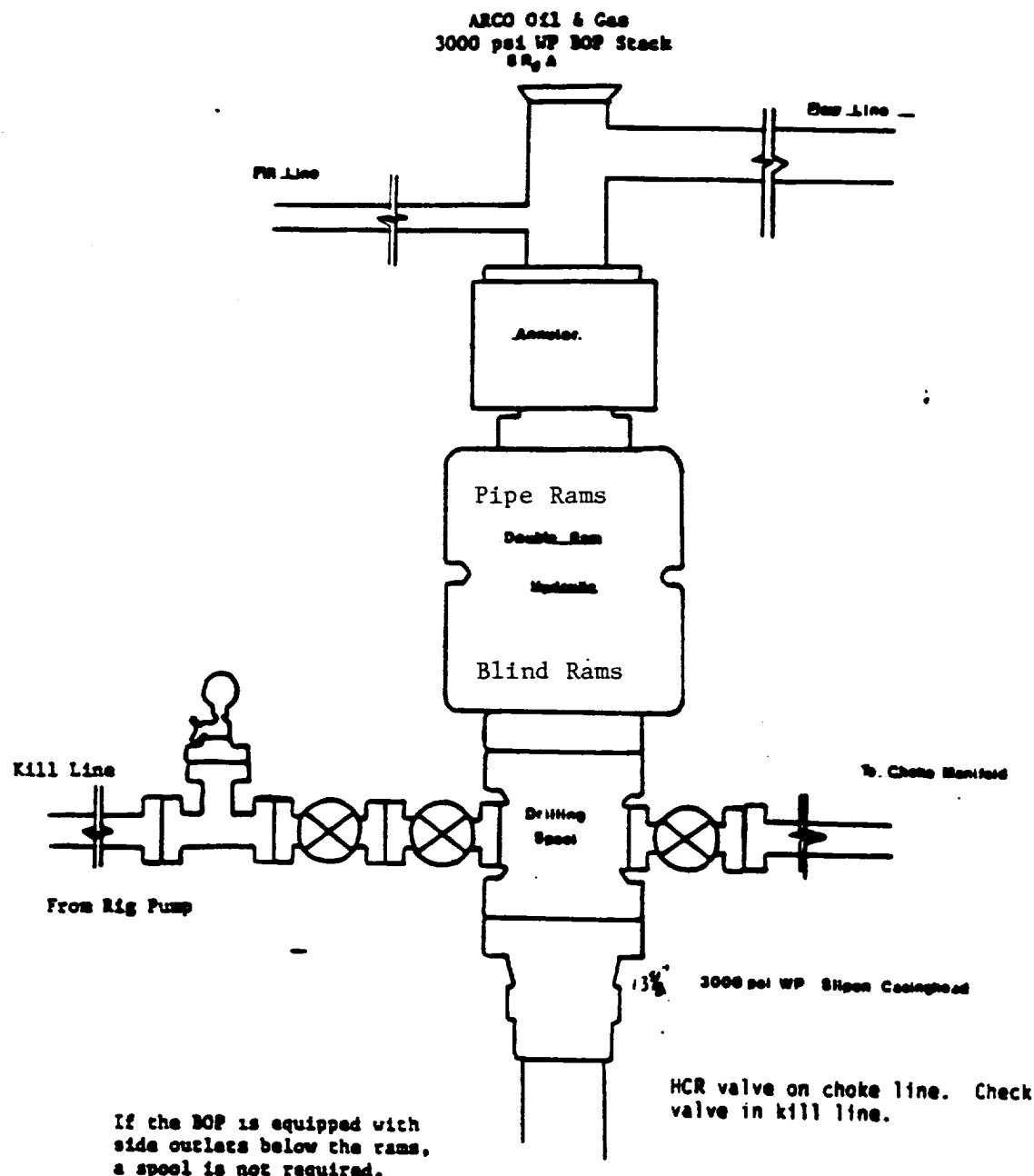

ARCO Oil & Gas Company

Division of Atlantic Richfield Company

Blow Out Preventer Program

Lease Name Wilmar Federal

Well No. #5

Location 1980' FNL & 660' FWL, Sec 4,
T-18-S, R-31-E, Eddy County, NM

BOP to be tested when installed on well and will be maintained in good working condition during drilling. All wellhead fittings to be of sufficient pressure to operate in a safe manner.

MEX 1/85

c

ARCO Oil & Gas
5700 psi WP BOP Stack
SR, AB

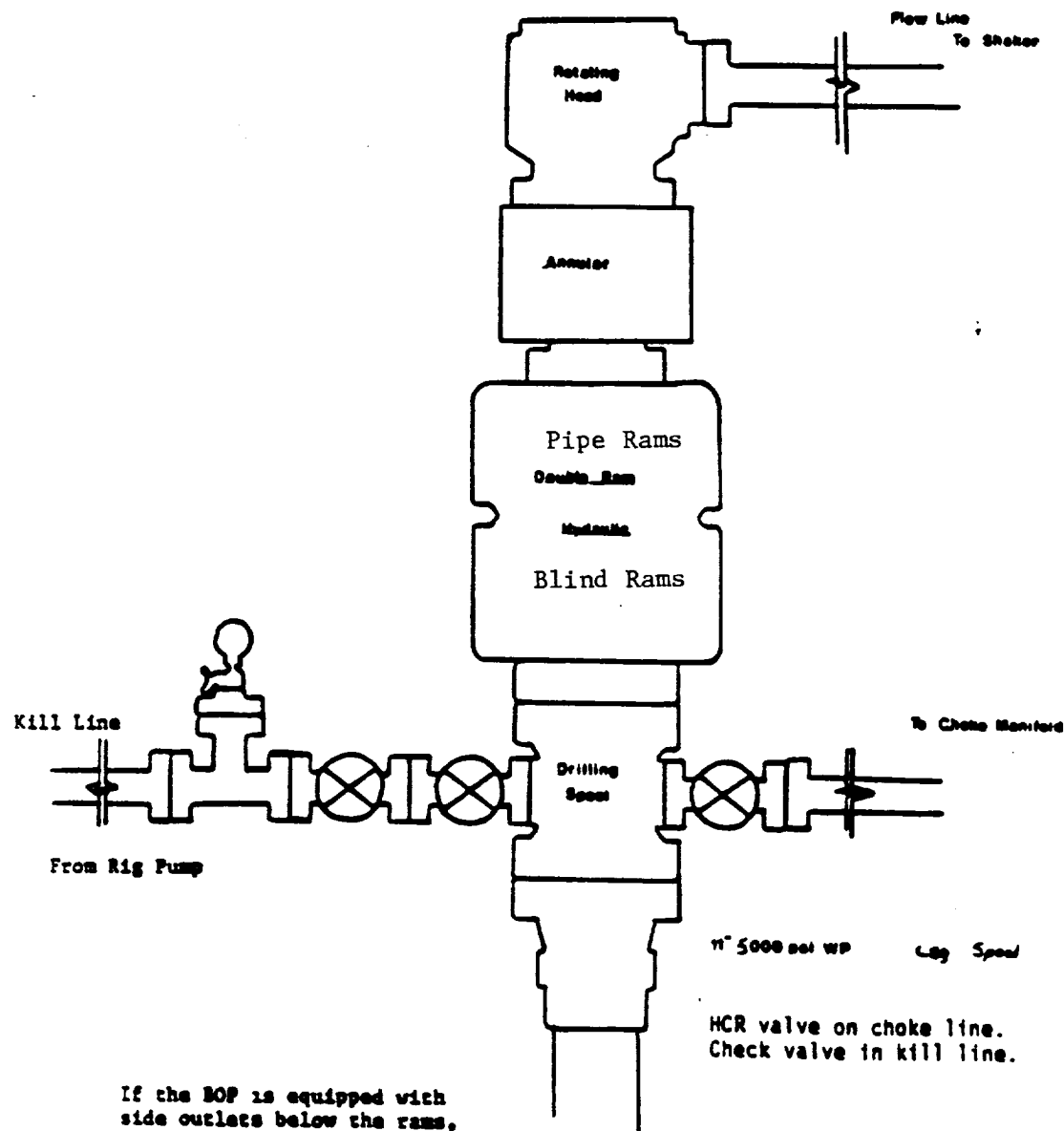

If the BOP is equipped with side outlets below the rams, a spool is not required.

11" 5000 psi WP Log Spool

HCR valve on choke line.
Check valve in kill line.

ARCO Oil & Gas Company

Division of Atlantic Richfield Company

Blow Out Preventer Program

Lease Name Wilmar Federal

Well No. #5

Location 1980' FNL & 660' FWL, Sec. 4,
T-18-S, R-31-E, Eddy Co., NM

BOP to be tested when installed on well and will be maintained in good working condition during drilling. All wellhead fittings to be of sufficient pressure to operate in a safe manner.

ARCO Oil & Gas
5000psi WP Choke Manifold

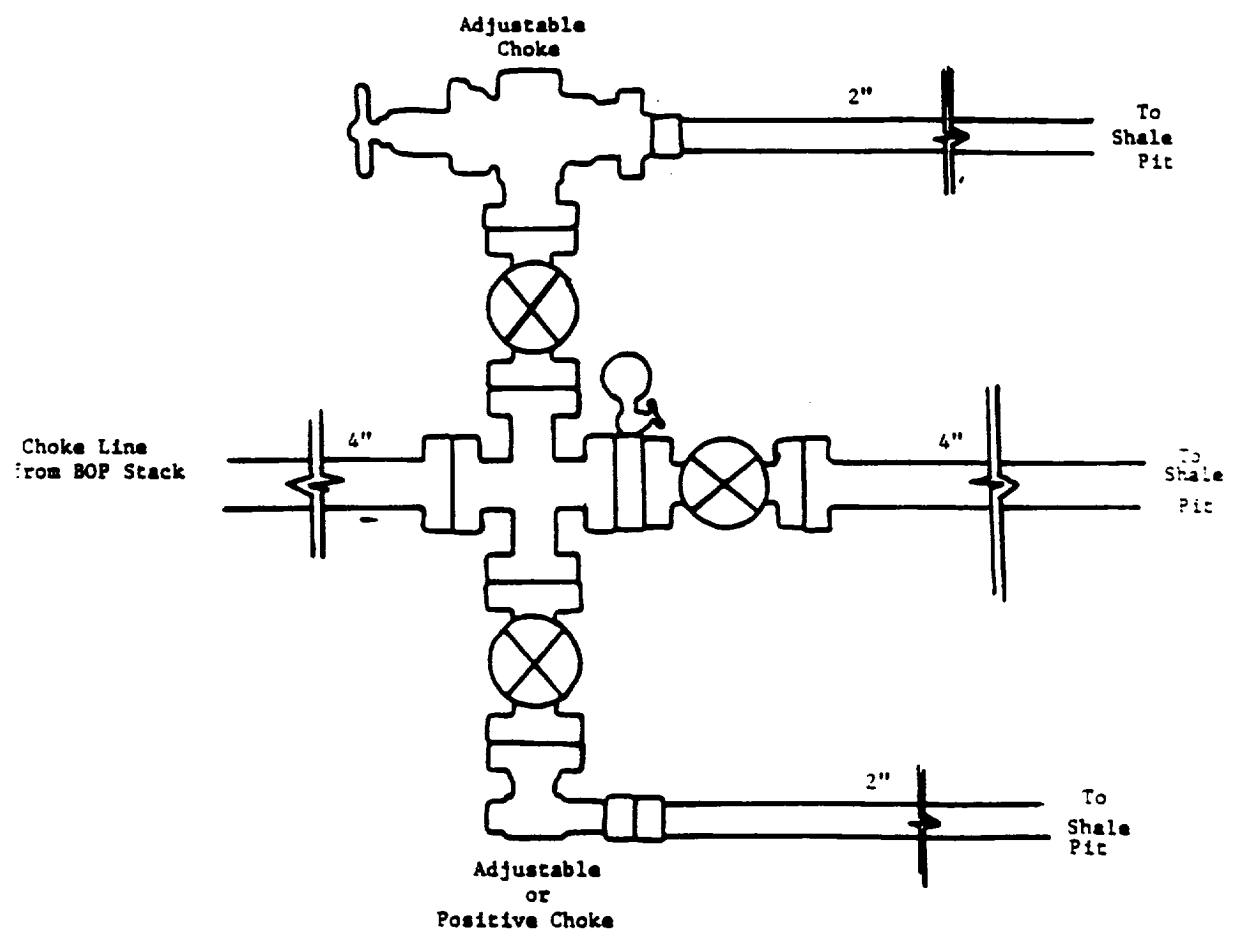

To supplement USGS Form 3160-3 " Application for Permit to Drill, Deepen or Plugback", the following additional information is submitted to comply with USGS Order NTL-6.

Operator: Hondo Oil and Gas Company

Lease & Well No: Wilmar Federal #5

Location: Unit Letter ^E
Section 4 - 18S - 31E

Eddy County, New Mexico

Lease, New Mexico LC-029389- b

Development well X Exploratory well

1. See Well Location and Acreage Dedication Plat Form C-102.
2. See Form 3160-3 for elevation above sea level of unprepared location.
3. The geologic name of the surface formation is: Querecho Plains Aeolian material with loose sandy loams and commonly harbor calcareous gravels.
4. The type of drilling tools and associated equipment to be utilized will be: Rotary
5. The proposed drilling depth will be 8700' .

6. The estimated tops of important geologic markers are:

Yates	2100'	San Andres	4010'
Queen	3160'	Bone Springs	5200'

7. The estimated depths at which anticipated water, oil, gas or other mineral bearing formations are expected to be encountered are:

Bone Springs 8200' Oil

8. The proposed casing program including the size, grade and weight-per-foot of each string has been indicated on Form 3160-3. All strings of casing will be: New X Used .

9. See Form 3160-3 for amount of cement.

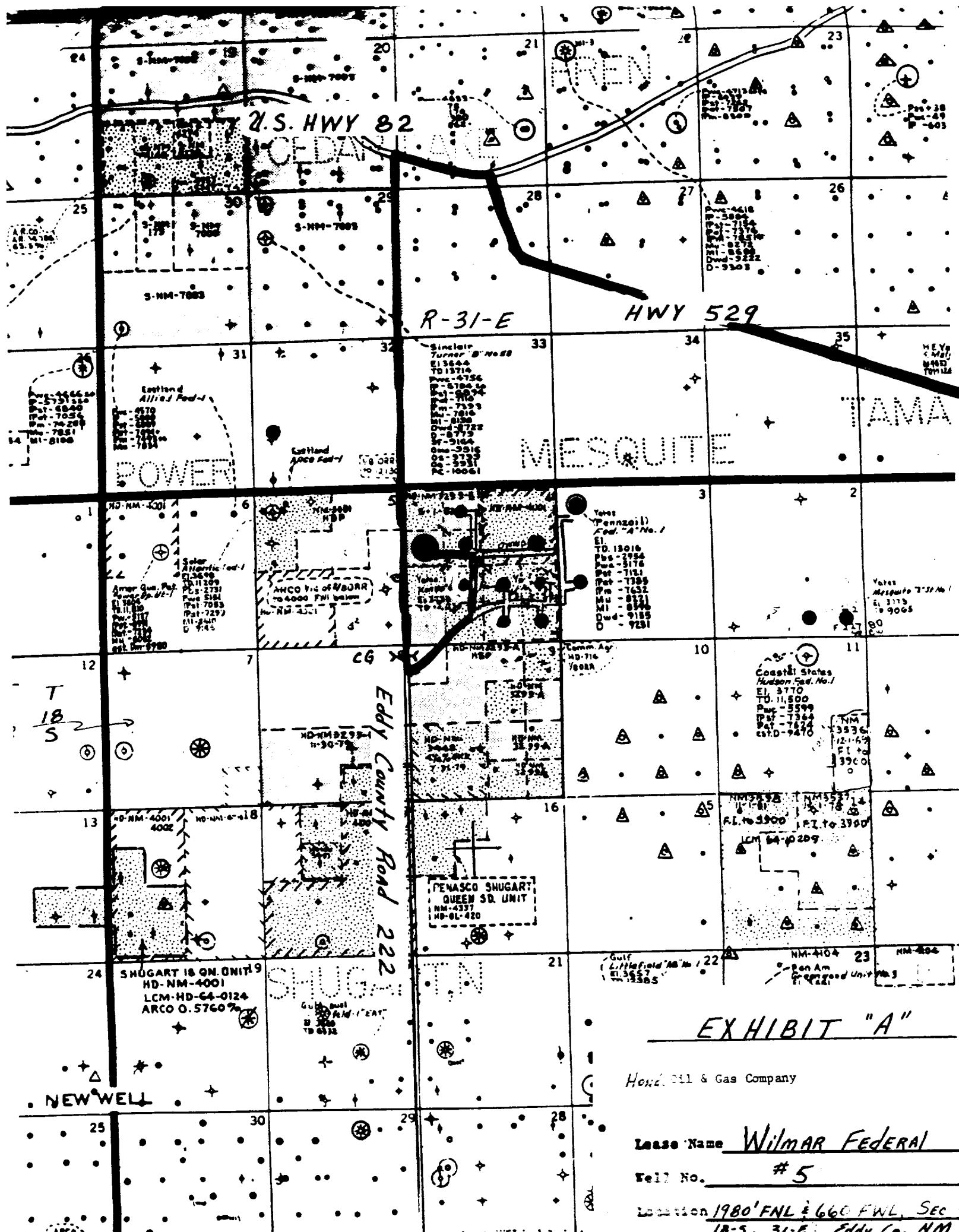

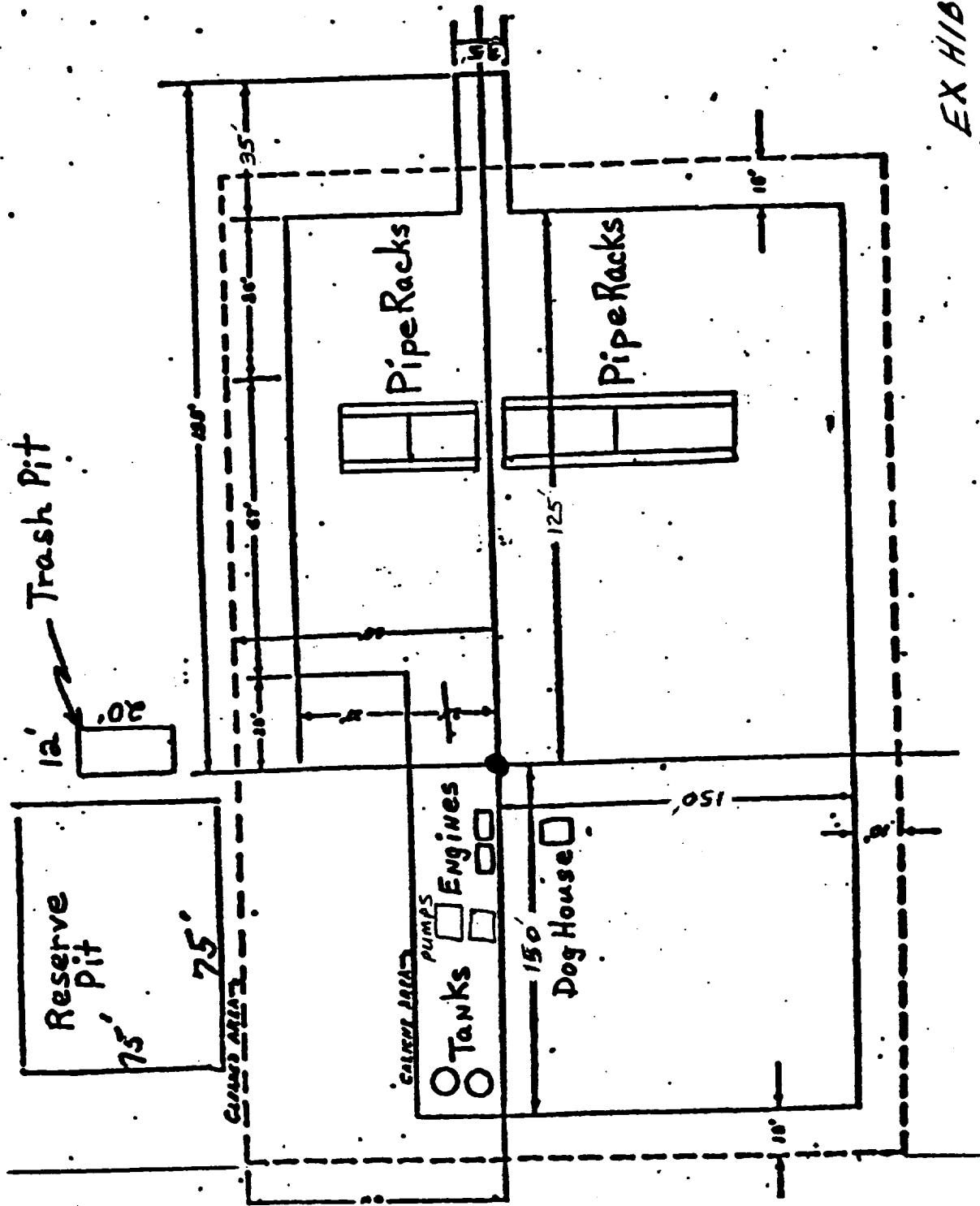

EXHIBIT "D"

Hondo Oil and Gas Company

Lease Name Wilmar Federal

Well No. # 5

Location 1980' ENL i 660' ENL, Sec 4
18-S, 31-E, Eddy Co, NM