

UNITED STATES  
DEPARTMENT OF THE INTERIOR  
GEOLOGICAL SURVEY30-015-26017  
5. LEASE DESIGNATION AND SERIAL NO.

NM 42410

6. IF INDIAN, ALLOTTEE OR TRIBE NAME

7. UNIT AGREEMENT NAME

8. FARM OR LEASE NAME

Comstock Federal

9. WELL NO.

10

10. FIELD AND POOL, OR WILDCAT

Artesia ON-G-SA

11. SEC., T., R., M., OR BLK.  
AND SURVEY OR AREA

Sec. 12-18S-27E

12. COUNTY OR PARISH 13. STATE

Eddy

NM

1a. TYPE OF WORK

DRILL ☒DEEPEN ☐PLUG BACK ☐

b. TYPE OF WELL

OIL  
WELL ☒GAS  
WELL ☐OTHER ☐SINGLE  
ZONE ☐MULTIPLE  
ZONE ☐

2. NAME OF OPERATOR

Fred Pool Drilling, Inc.

3. ADDRESS OF OPERATOR

P.O. Box 1393

Roswell, N.M. 88201

4. LOCATION OF WELL (Report location clearly and in accordance with any State requirements.)

At surface

990 FSL and 1650 FWL

At proposed prod. zone

14. DISTANCE IN MILES AND DIRECTION FROM NEAREST TOWN OR POST OFFICE\*

12 Air miles east-southeast from Artesia, N.M.

15. DISTANCE FROM PROPOSED\*

LOCATION TO NEAREST

PROPERTY OR LEASE LINE, FT.

(Also to nearest drlg. unit line, if any)

990

16. NO. OF ACRES IN LEASE

480

17. NO. OF ACRES ASSIGNED  
TO THIS WELL

40

18. DISTANCE FROM PROPOSED LOCATION\*

TO NEAREST WELL, DRILLING, COMPLETED,  
OR APPLIED FOR, ON THIS LEASE, FT.

660

19. PROPOSED DEPTH

1650 ft.

20. ROTARY OR CABLE TOOL

rotary

21. ELEVATIONS (Show whether DF, RT, GR, etc.)

3590 ft. Gr.

22. APPROX. DATE WORK WILL START\*

October 10th.

23.

## PROPOSED CASING AND CEMENTING PROGRAM

SIZE OF HOLE	SIZE OF CASING	WEIGHT PER FOOT	SETTING DEPTH	QUANTITY OF CEMENT
12 1/2	8 5/8	24#	350 ft.	sufficient to circulate
7 7/8	4 1/2 - 5 1/2	9.6# - 14#	1650 ft.	350 sx.

Pay zone will be completed in a prudent manner for optimum production.

Attached are: 1. Well location and acreage dedicated plat  
2. Supplemental drilling data  
3. Surface use plan

RECEIVED

OCT 11 9 47 AM '88

POST ID-1  
NL & API  
11-18-88

IN ABOVE SPACE DESCRIBE PROPOSED PROGRAM: If proposal is to deepen or plug back, give data on present productive zone and proposed new productive zone. If proposal is to drill or deepen directionally, give pertinent data on subsurface locations and measured and true vertical depths. Give blowout preventer program, if any.

24.

SIGNED

*Fred Pool*

TITLE Engineer

DATE 10/5/88

(This space for Federal or State office use)

PERMIT NO.

APPROVAL DATE

AREA MANAGER

APPROVED BY

*Sandra Pountney*

TITLE

CARLSBAD RESOURCE AREA

DATE

11-14-88

CONDITIONS OF APPROVAL, IF ANY:

**MEXICO OIL CONSERVATION COMMISSION  
WELL LOCATION AND ACREAGE DEDICATION PLAT**

Form C-102  
Supersedes C-128  
Effective 1-1-65

All distances must be from the outer boundaries of the Section.

Operator <b>FRED POOL DRILLING, INC.</b>			Lease <b>Comstock Federal</b>		Well No. <b>10</b>
Unit Letter <b>N</b>	Section <b>12</b>	Township <b>18 South</b>	Range <b>27 East</b>	County <b>Eddy County, N.M.</b>	
Actual Footage Location of Well: <div style="display: flex; justify-content: space-between;"> <span>990 feet from the</span> <span><b>South</b> line and</span> <span>1650 feet from the</span> <span><b>West</b> line</span> </div>					
Ground Level Elev. <b>3590.</b>	Producing Formation <b>Q-GB- SA</b>	Pool <b>Q-G- SA Artesia Oil Pool</b>		Dedicated Acreage <b>40</b> Acres	

1. Outline the acreage dedicated to the subject well by colored pencil or hachure marks on the plat below.
2. If more than one lease is dedicated to the well, outline each and identify the ownership thereof (both as to working interest and royalty).
3. If more than one lease of different ownership is dedicated to the well, have the interests of all owners been consolidated by communitization, unitization, force-pooling, etc?

☐ Yes    ☐ No    If answer is "yes," type of consolidation \_\_\_\_\_

If answer is "no," list the owners and tract descriptions which have actually been consolidated. (Use reverse side of this form if necessary.) \_\_\_\_\_

No allowable will be assigned to the well until all interests have been consolidated (by communitization, unitization, forced-pooling, or otherwise) or until a non-standard unit, eliminating such interests, has been approved by the Commission.

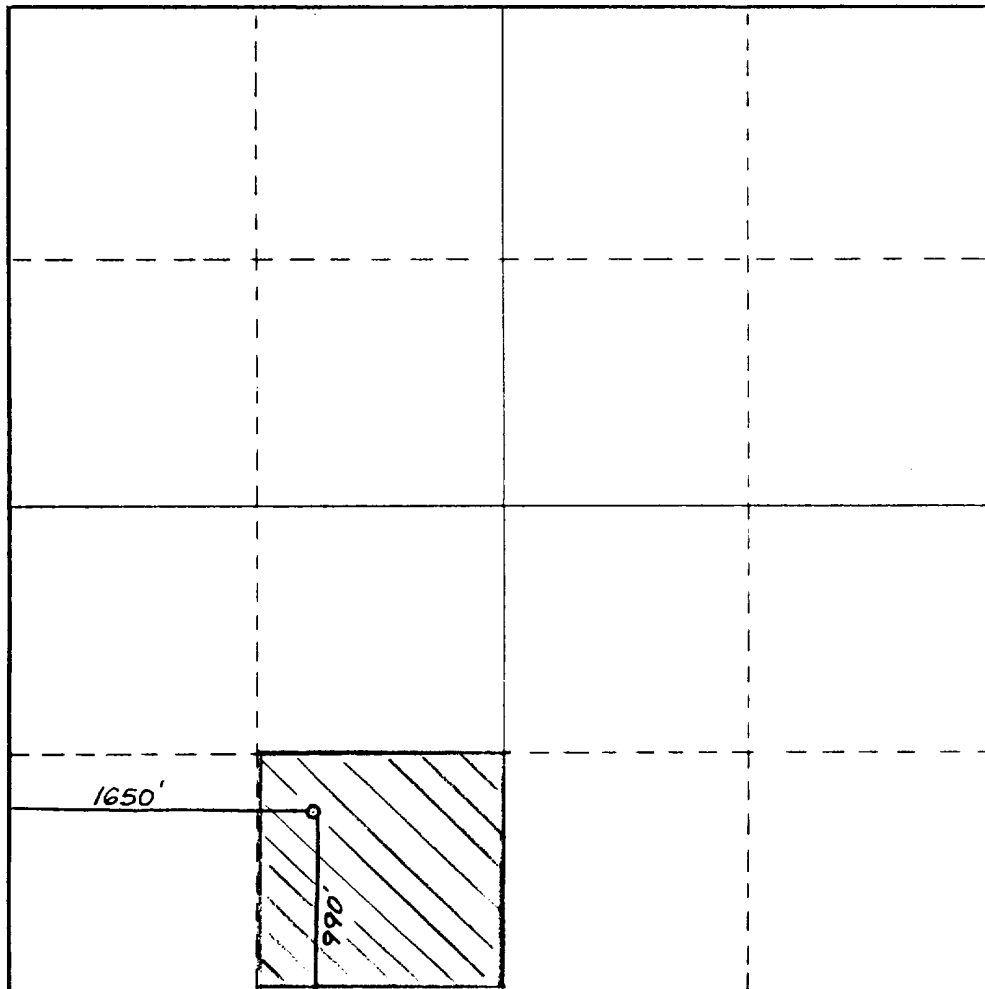

**CERTIFICATION**

I hereby certify that the information contained herein is true and complete to the best of my knowledge and belief.

**Fred Pool, Jr.**

Name

**President**

Position

**Fred Pool Drilling, Inc.**

Company

**9/13, 1988**

Date

*[Signature]*

I hereby certify that the well location shown on this plat was plotted from notes of actual surveys made by me or under my supervision, and that the same is true and correct to the best of my knowledge and belief.

Date Surveyed

**April 29, 1988**

Registered Professional Engineer  
and/or Land Surveyor

*[Signature]*

Certificate No.

**NM PE&LS NO. 5412**

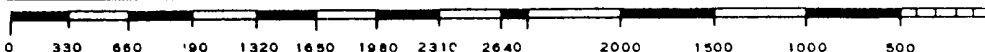

---

BLOWOUT PREVENTER ARRANGEMENT  
FRED POOL DRILLING, INC.  
WELL #10 COMSTOCK FEDERAL  
SE $\frac{1}{4}$ SW $\frac{1}{4}$  SEC. 12-18S-27E

---

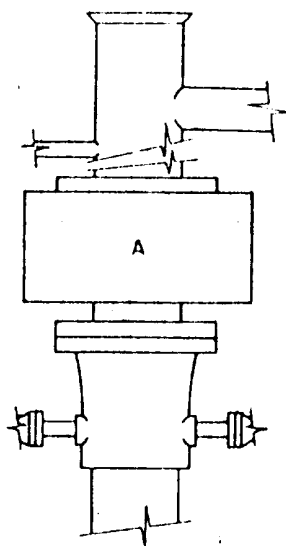

**ARRANGEMENT A**

SUPPLEMENTAL DRILLING DATA

Fred Pool Drilling, Inc.,  
Well #10 Comstock Federal  
SE $\frac{1}{4}$ SW $\frac{1}{4}$  Sec. 12-18S-27E  
Eddy County, New Mexico

1. SURFACE FORMATION: Artesia Group of Permian Age. (Elev. 3590 ft.)
2. ESTIMATED TOPS OF GEOLOGIC MARKERS:

Yates	272'	Grayburg	1645'
Seven Rivers	472'	Queen	1222'
3. ANTICIPATED POROSITY ZONES:

Water - Above 300'
Oil - 1500'
4. CASING DESIGN:

<u>SIZE</u>	<u>INTERVAL</u>	<u>WEIGHT</u>	<u>GRADE</u>	<u>JOINT</u>
8 5/8"	0 - 350'	24.0#	K-55	STC
5 1/2"	0 - 1650'	15.5#	K-55	STC
5. SURFACE CONTROL EQUIPMENT: A double ram-type or annular BOP will be used.
6. CIRCULATING MEDIUM: Fresh water mud conditioned as necessary for control of viscosity and water loss. Alternate medium - air-rotary.
7. AUXILIARY EQUIPMENT: None considered necessary on this shallow development well.
8. TESTING, LOGGING AND CORING PROGRAMS: No coring or DST's are planned. Electric logs will include a Compensated Neutron Log with Gamma Ray.
9. ABNORMAL PRESSURES, TEMPERATURES OR GASES: None anticipated.
10. ANTICIPATED STARTING DATE: It is planned that operations will commence about December 1, 1988. Duration of drilling, completion and testing operations should be one to five weeks.

SUP EXHIBIT "B"  
TOPOGRAPHIC MAP

Fred Pool Drilling, Inc.  
Well #10 Comstock Federal  
SE 1/4 SW 1/4 Sec. 12-18S-27E

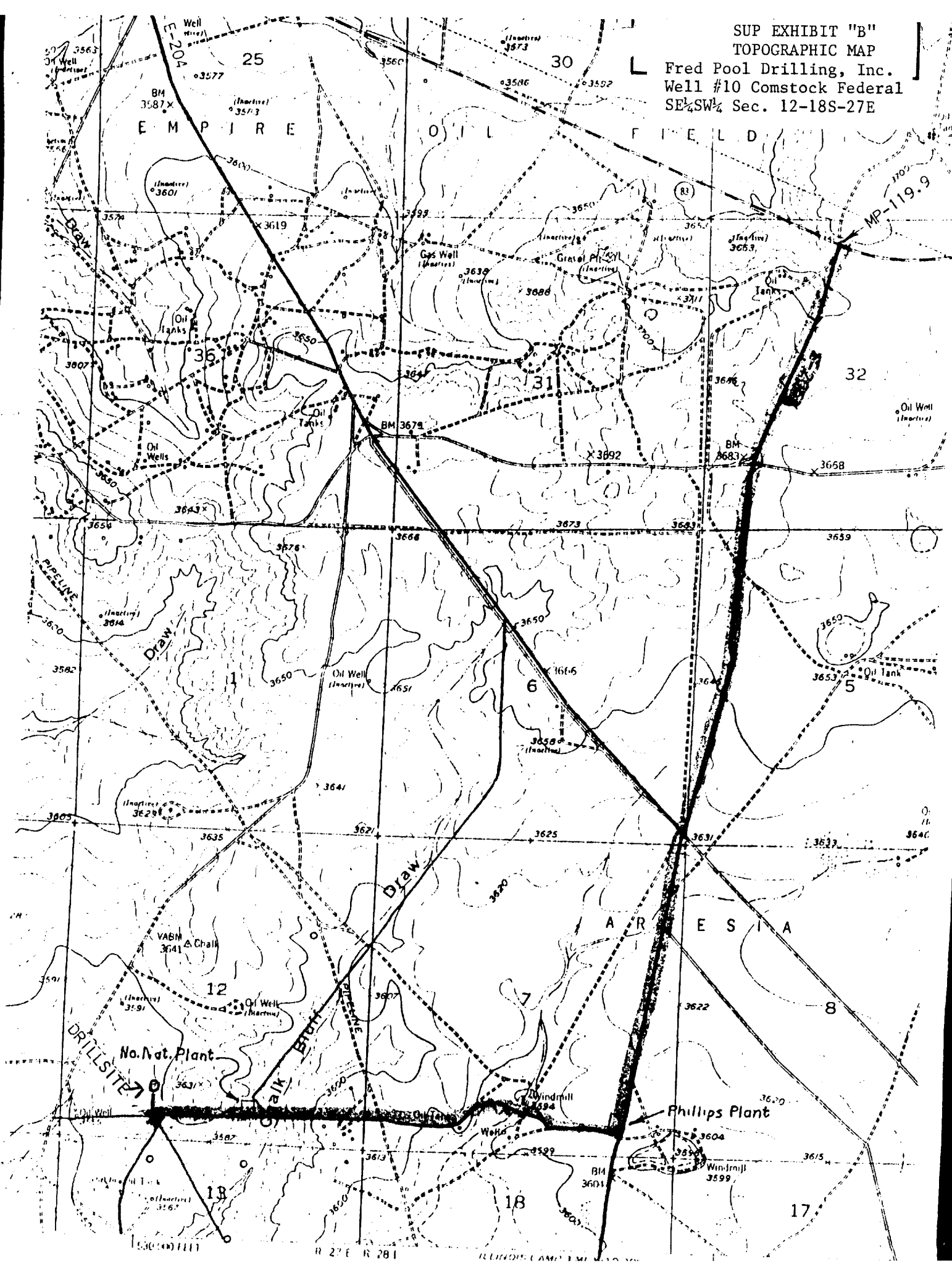

SUP EXHIBIT "D"  
WELL PAD LAYOUT  
Fred Pool Drilling, Inc.  
Well #10 Comstock Federal  
SE $\frac{1}{4}$ SW $\frac{1}{4}$  Sec. 12-18S-27E

