

Submit to Appropriate
District Office
State Lease - 4 copies
Fee Lease - 3 copies

State of New Mexico
Energy, Minerals and Natural Resources Department

Form C-102
Revised 1-1-89

OIL CONSERVATION DIVISION

DISTRICT I
P.O. Box 1980, Hobbs, NM 88240

P.O. Box 2088
Santa Fe, New Mexico 87504-2088

DISTRICT II
P.O. Drawer DD, Artesia, NM 88210

DISTRICT III
1000 Rio Brazos Rd., Aztec, NM 87410

WELL LOCATION AND ACREAGE DEDICATION PLAT

All Distances must be from the outer boundaries of the section

Operator Sun Exploration & Production Co.			Lease Scoggin Draw Fed. Comm. B		Well No. 1
Unit Letter I	Section 22	Township 18 South	Range 27 East	County Eddy	

Actual Footage Location of Well:

1980 feet from the south line and 660 feet from the east line

Ground level Elev. 3457.0'	Producing Formation Atoka	Pool Red Lake Atoka Morrow Gas	Dedicated Acreage: 320 Acres
-------------------------------	------------------------------	-----------------------------------	---------------------------------

1. Outline the acreage dedicated to the subject well by colored pencil or hatchure marks on the plat below.

2. If more than one lease is dedicated to the well, outline each and identify the ownership thereof (both as to working interest and royalty).

3. If more than one lease of different ownership is dedicated to the well, have the interest of all owners been consolidated by communitization, unitization, force-pooling, etc.?

☒ Yes ☐ No If answer is "yes" type of consolidation Communitization with 13987

If answer is "no" list the owners and tract descriptions which have actually been consolidated. (Use reverse side of this form if necessary.)

No allowable will be assigned to the well until all interests have been consolidated (by communitization, unitization, forced-pooling, or otherwise) or until a non-standard unit, eliminating such interest, has been approved by the Division.

OPERATOR CERTIFICATION

I hereby certify that the information contained herein is true and complete to the best of my knowledge and belief.

Signature

Printed Name
Maria L. Perez

Position
Accountant

Company
Sun Expl. & Prod. Co.

Date
4-17-89

SURVEYOR CERTIFICATION

I hereby certify that the well location shown on this plat was plotted from field notes actual surveys made by me or under supervision, and that the same is true correct to the best of my knowledge and belief.

Date Surveyed
April 4, 1989

Signature & Seal of Professional

REGISTERED PROFESSIONAL ENGINEER
LAND SURVEYOR
No. 1676
JOHN W. WEST
NEW MEXICO

Certified

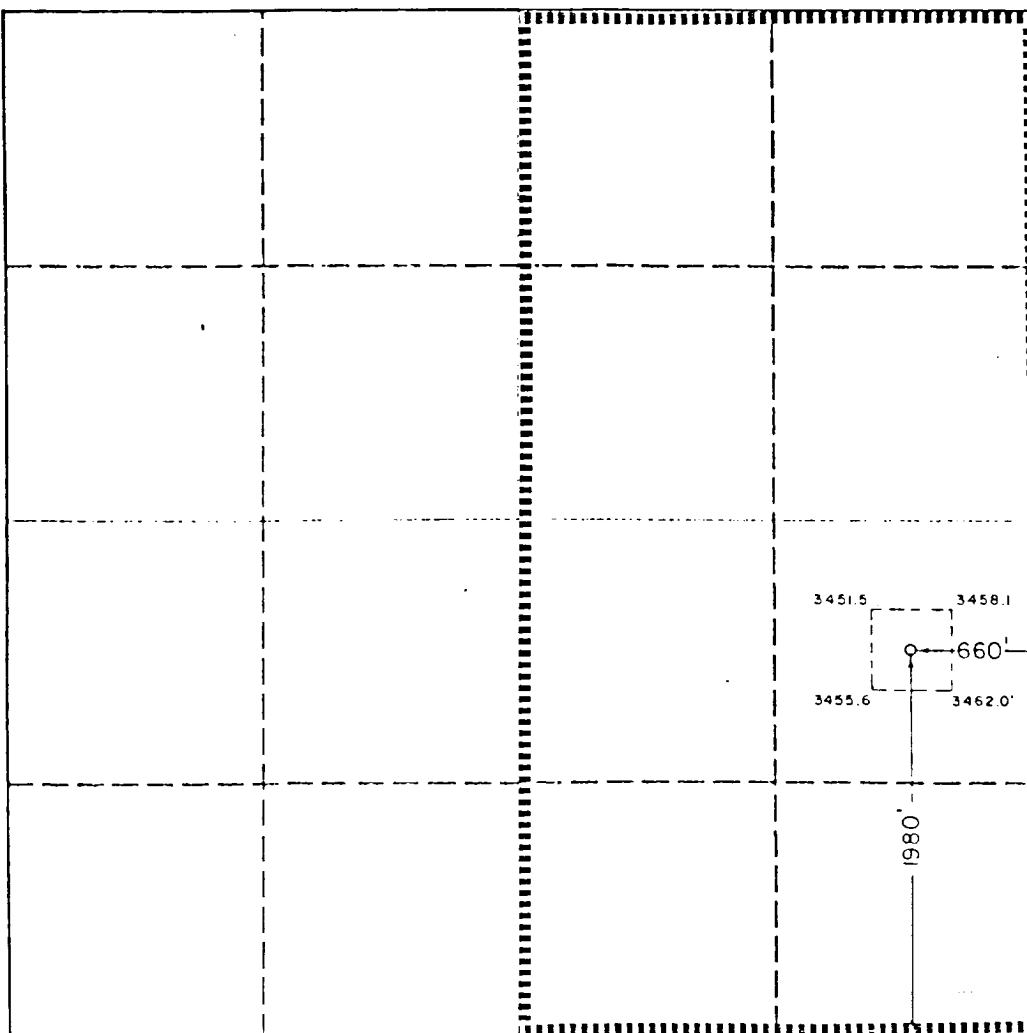

0 330 660 990 1320 1650 1980 2310 2640 2000 1000 1500 500 0



marbob
energy corporation

STATEMENT ACCEPTING RESPONSIBILITY FOR OPERATIONS

The undersigned accepts all applicable terms, conditions, stipulations, and restrictions concerning operations conducted on the leased land or portion thereof, as described below:

LEASE NO.: LC-060122

LEGAL DESCRIPTION OF LAND: Section 22-T18S-R27E
EDDY COUNTY, NEW MEXICO

FORMATION (S) (if applicable):

BOND COVERAGE: Statewide

BLM BOND FILE NO.: 585716

Diana J. Cannon
Production Analyst

Date: 4/17/02