

FIELD REPORT FOR CEMENTING OF WELLS

OIL CONSERVATION DIVISION

Operator <u>Gates Petr. Corp</u>		Lease <u>Desana Unit</u>		Well # <u>1</u>	
Location of Well	Unit <u>6</u>	Section <u>17</u>	Township <u>18</u>	Range <u>24</u>	County <u>Eddy</u>
Drilling Contractor	<u>Undesignated</u>		Type of Equipment <u>Rotary</u>		

* Witness APPROVED CASING PROGRAM

Size of Hole	Size of Casing	Weight Per Foot	New or Used	Depth	Sacks Cement
<u>17 1/2</u>	<u>13 3/8</u>	<u>54.5 # J-55</u>		<u>250</u>	<u>250 Circ</u>
<u>12 1/4</u>	<u>* 8 5/8</u>	<u>24 # J-55</u>		<u>1100</u>	<u>600 Circ</u>
<u>7 7/8</u>	<u>5 1/2</u>	<u>15+17 # J-55</u>		<u>TD</u>	<u>350</u>

Casing Data:

Surface 28 joints of 8 5/8 inch 24 # Grade J55
 (Approved) (Rejected)

Inspected by _____ date _____

Cementing Program

Size of hole 12 1/4 Size of Casing 8 5/8 Sacks cement required 600

Type of Shoe used Tex Float collar used insert Btm 3 jts welded Yes

TD of hole 1110 Set 1112 Feet of 8 5/8 Inch 24 # Grade J55

New used csg. @ 1110 with 400 sacks neat cement around shoe with 2% cc
 + 200 sack Lite additives 10 lbs gilsonite, 1/2 lb Flocele 197, CC.

Plug down @ 1:00 (AM) (PM) Date July 2, 1989

Cement circulated No No. of Sacks _____

Cemented by Halliborton Witnessed by _____

Temp. Survey ran @ 7:00 (AM) (PM) Date 7/3/89 top cement @ 780

Casing test @ _____ (AM) (PM) Date _____

Method Used _____ Witnessed by _____

Checked for shut off @ _____ (AM) (PM) Date _____

Method used _____ Witnessed by _____

Remarks: Lost circ. @ 750'. Run Temp. survey @ 7:00 AM

<u>1st Stage</u>	<u>100 sks</u>	<u>Class C</u>
<u>2nd Stage</u>	<u>100 sks</u>	<u>Class C</u>
<u>Circ 25 sks</u>		

Submit to Appropriate
District Office
State Lease - 6 copies
Fee Lease - 5 copies

State of New Mexico
Energy, Minerals and Natural Resources Department

Form C-101
Revised 1-1-89

DISTRICT I
P.O. Box 1980, Hobbs, NM 88240

DISTRICT II
P.O. Drawer DD, Artesia, NM 88210

DISTRICT III
1000 Rio Brazos Rd., Aztec, NM 87410

OIL CONSERVATION DIVISION

P.O. Box 2088 RECEIVED

Santa Fe, New Mexico 87504-2088

Santa Fe	
BLM	
Land Office	
B of M	
Operator	

JUN 15 '89

API NO. (assigned by OCD on New Wells)
V-1152
5. Indicate Type of Lease
STATE <input checked="" type="checkbox"/> FEE <input type="checkbox"/>
6. State Oil & Gas Lease No.

7. Lease Name or Unit Agreement Name
Desana Unit

8. Well No.
#1

9. Pool name or Wildcat
Wildcat Morrow

APPLICATION FOR PERMIT TO DRILL, DEEPEN, OR PLUG BACK

1a. Type of Work:
DRILL <input checked="" type="checkbox"/> RE-ENTER <input type="checkbox"/> DEEPEN <input type="checkbox"/> PLUG BACK <input type="checkbox"/>

b. Type of Well:
OIL WELL <input type="checkbox"/> GAS WELL <input checked="" type="checkbox"/> OTHER <input type="checkbox"/>
SINGLE ZONE <input type="checkbox"/> MULTIPLE ZONE <input type="checkbox"/>

2. Name of Operator
YATES PETROLEUM CORPORATION

3. Address of Operator
105 South Fourth Street, Artesia, New Mexico 88210

4. Well Location
Unit Letter <u>G</u> : <u>1980</u> Feet From The <u>North</u> Line and <u>1980</u> Feet From The <u>East</u> Line
Section <u>17</u> Township <u>18 South</u> Range <u>24 East</u> NMPM <u>EDDY</u> County

10. Proposed Depth
8300'
11. Formation
Morrow
12. Rotary or C.T.
Rotary <input checked="" type="checkbox"/>

13. Elevations (Show whether DF, RT, GR, etc.)
3808' GR
14. Kind & Status Plug. Bond
Blanket
15. Drilling Contractor
Undesignated
16. Approx. Date Work will start
ASAP

PROPOSED CASING AND CEMENT PROGRAM					
SIZE OF HOLE	SIZE OF CASING	WEIGHT PER FOOT	SETTING DEPTH	SACKS OF CEMENT	EST. TOP
17 1/2"	13 3/8"	54.5 # J-55	Approx. 250'	250 Sacks	Circulate
12 3/4"	8 5/8"	24 # J-55	Approx. 1100'	600 Sacks	Circulate
7 7/8"	5 1/2"	15 & 17 # J-55	TD	350 Sacks	

We propose to drill and test the Morrow and Intermediate formations. Approximately 250' of surface casing will be run and the cement circulated to shut off gravel and cavings. Intermediate casing will be set 100' below the Artesian Water Zone and cement circulated to the surface. If commercial pay is encountered, we will run 5 1/2" casing and cement with 600' of cover, perforate and stimulate as needed for production.

MUD Program: FW gel and LCM to 1100', fresh water to 3850', KCL water to 6000', Starch/Drispak/KCL to 7100', Flosal/Drispak/KCL mud to TD.

BOP: BOP's and Hydrill on 8 5/8" casing and tested, piperams daily for operational, Yellow jacket prior to drilling Wolfcamp.

GAS NOT DEDICATED:

APPROVAL VALID FOR 180 DAYS
PERMIT EXPIRES 12/16/89

IN ABOVE SPACE DESCRIBE PROPOSED PROGRAM: IF PROPOSAL IS TO DEEPEN OR PLUG BACK, GIVE DATA ON PRESENT PRODUCTIVE ZONE AND PROPOSED NEW PRODUCTIVE ZONE. GIVE BLOWOUT PREVENTER PROGRAM, IF ANY.

I hereby certify that the information above is true and complete to the best of my knowledge and belief.

SIGNATURE Clifton R. May TITLE PERMIT AGENT DATE 6-15-89

TYPE OR PRINT NAME CLIFTON R. MAY TELEPHONE NO. 748-1471

(This space for State Use) ORIGINAL SIGNED BY
MIKE WILLIAMS

APPROVED BY SUPERVISOR, DISTRICT II TITLE _____ DATE JUN 16 1989

CONDITIONS OF APPROVAL, IF ANY:

NOTIFY N.M.O.C.D. IN SUFFICIENT
TIME TO FINISH CEMENTING THE
8 5/8" CASING

**W MEXICO OIL CONSERVATION COMMISSION
WELL LOCATION AND ACREAGE DEDICATION PLAT**

Form C-102
Supersedes C-128
Effective 1-1-65

All distances must be from the outer boundaries of the Section.

Operator YATES PETROLEUM CORPORATION			Lease Desana Unit		Well No. 1
Unit Letter G	Section 17	Township 18 South	Range 24 East	County Eddy County, N. M.	
Actual Footage Location of Well: 1980 feet from the North line and 1980 feet from the East line					
Ground Level Elev. 3808.	Producing Formation MORROW	Pool WILDCAT MORROW		Dedicated Acreage: 320 Acres	

1. Outline the acreage dedicated to the subject well by colored pencil or hachure marks on the plat below.
2. If more than one lease is dedicated to the well, outline each and identify the ownership thereof (both as to working interest and royalty).
3. If more than one lease of different ownership is dedicated to the well, have the interests of all owners been consolidated by communitization, unitization, force-pooling, etc?

☐ Yes ☐ No If answer is "yes," type of consolidation **IS UNITIZATION**

If answer is "no," list the owners and tract descriptions which have actually been consolidated. (Use reverse side of this form if necessary.) _____

No allowable will be assigned to the well until all interests have been consolidated (by communitization, unitization, forced-pooling, or otherwise) or until a non-standard unit, eliminating such interests, has been approved by the Commission.

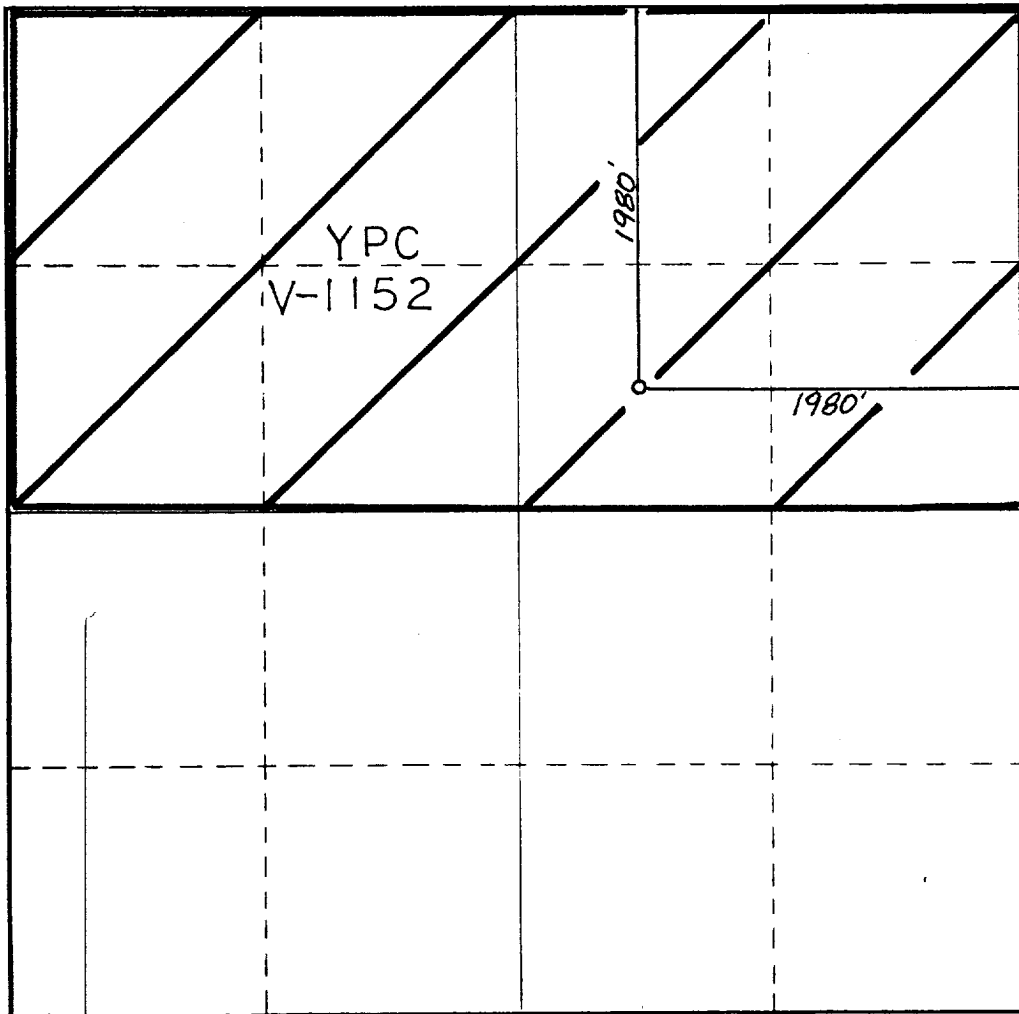

CERTIFICATION

I hereby certify that the information contained herein is true and complete to the best of my knowledge and belief.

Clinton R. May

Name
CLINTON R. MAY

Position
PERMIT AGENT

Company
YATES PETROLEUM CORPORATION

Date
6-15-89

I hereby certify that the well location shown on this plat was plotted from field notes of actual surveys made by me or under my supervision, and that the same is true and correct to the best of my knowledge and belief.

Date Surveyed
June 10, 1989

Registered Professional Engineer and/or Land Surveyor

Dan R. Reddy

Certificate No.
NM PE&LS NO. 5412

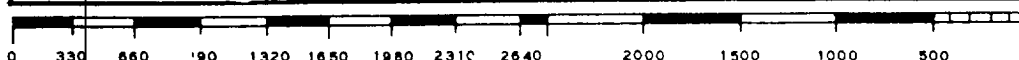

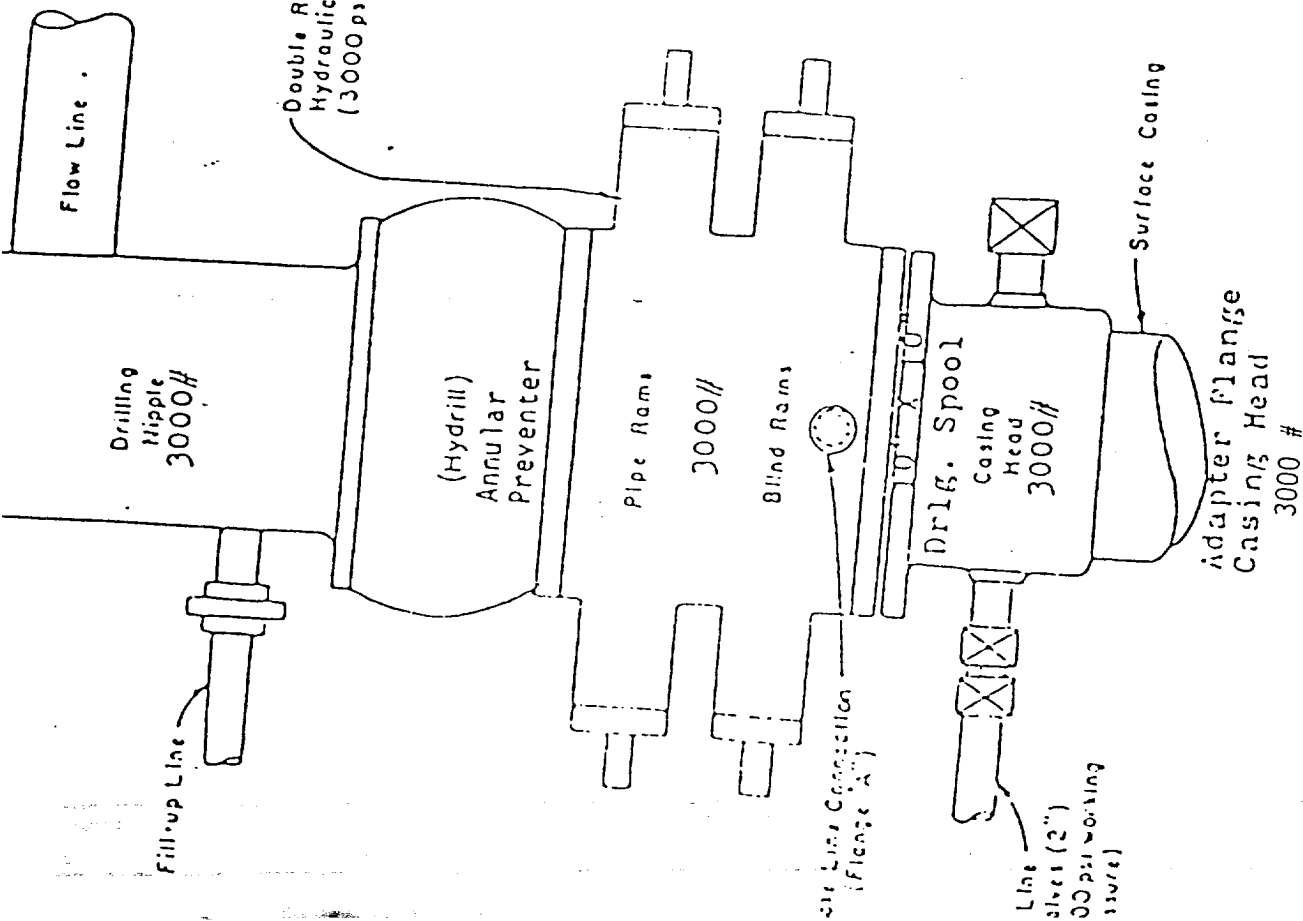

Double Ram Hydraulic BOP (3000 psi working pressure)

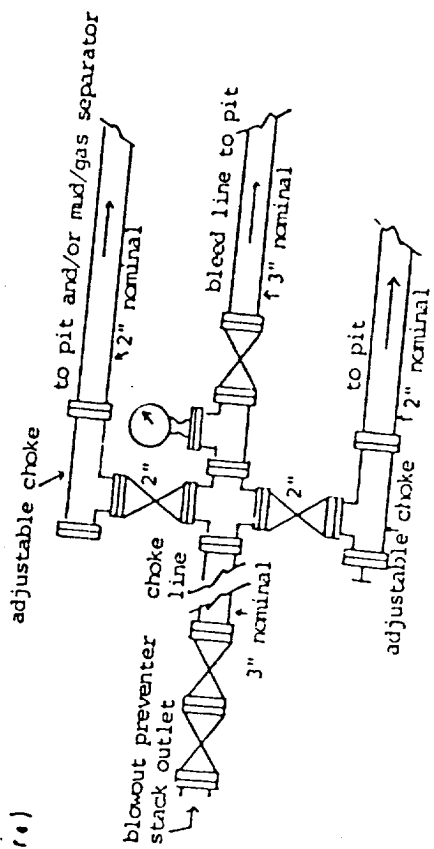

typical choke manifold assembly for 3M rated working pressure service-surface installation

EXHIBIT "B"
Blowout Preventer
Diagram