

1 Mile to Junction with U.S. Highway 82

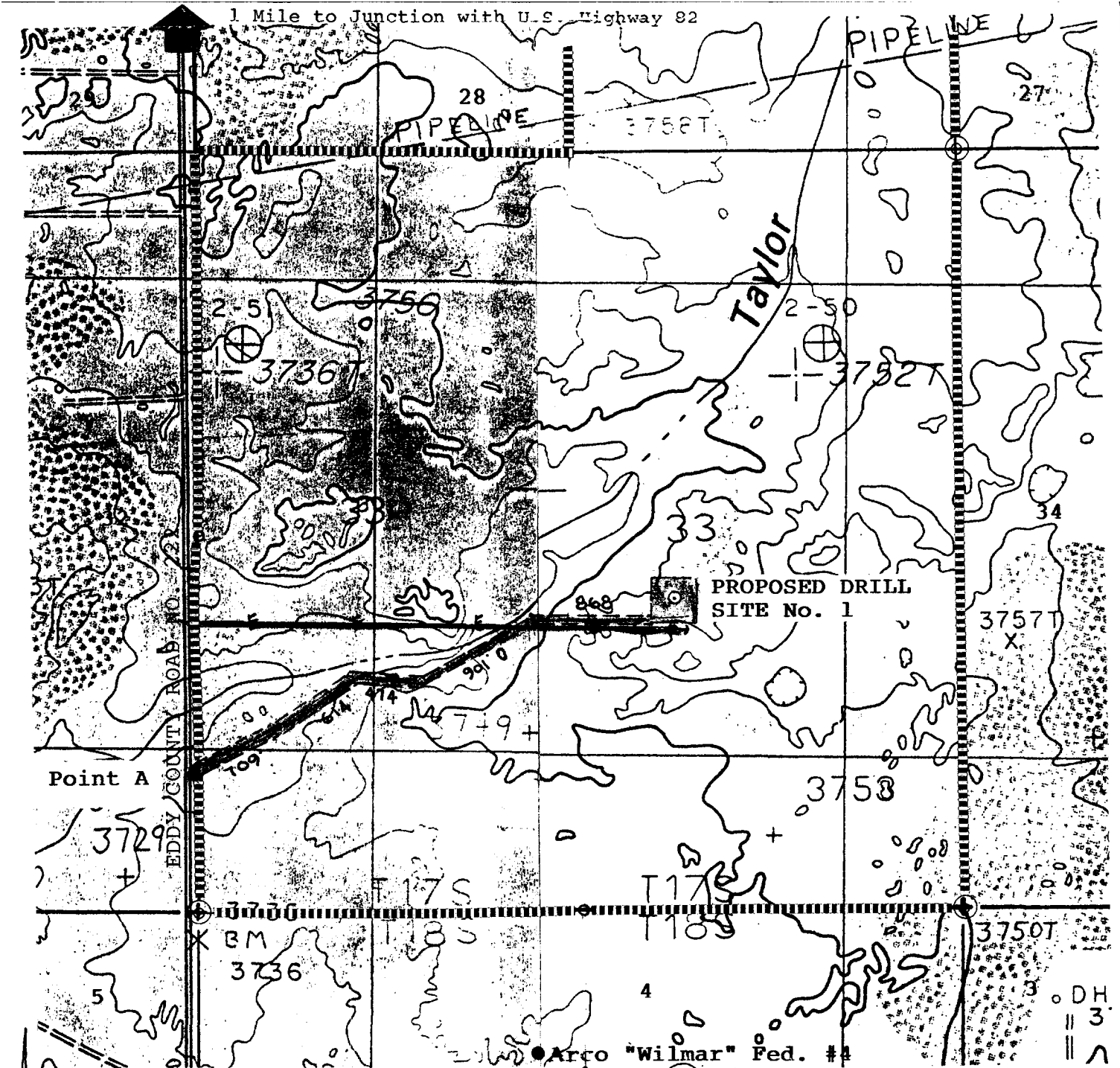

#### LEGEND OF SYMBOLS

- = Access Road (Yellow)
- = Resource Road Federal (Pink)
- = Resource Road on Subject Lease (Green)
- = Proposed Resource Road on Lease (Red)
- = Proposed Resource Road off Lease (Blue)
- = Proposed O.H. Electric Line (Orange)
- = Staked Location
- = Found 1" Iron Pipe W/GLO Brass Cap
- ⊙ = Found 2 or 3" Iron Pipe W/GLO Brass Cap
- = Lease Boundary Line

#### EXHIBIT "A"

#### ACCESS ROAD AND FACILITIES MAP

TEXACO EXPLORATION AND PRODUCTION, Inc.

DOW "B" 33 FEDERAL No. 1  
2180 FSL & 1980 FEL Section 33, T-17-S,  
R-31-E, NMPM, Eddy County, New Mexico

Drawn By: J.S. Piper

Scale: 1" = 1000 Feet

Date: June 17, 1992

Checked by: D. Balew

Supervisor R.D. Mariot

Sheet 6 of 9