

NM OIL CON. COMMISSION

DRAWER DD

ARTESIA, NM 88210

UNITED STATES

DEPARTMENT OF THE INTERIOR

BUREAU OF LAND MANAGEMENT

CONTACT LIVING
OFFICE FOR NUMBER
OF COPIES REQUIRED
(Other Instructions on
reverse side)

30-015-28009

BLM Roswell District
Modified Form No.
NM60-3160-2

APPLICATION FOR PERMIT TO DRILL, DEEPEN, OR PLUG BACK

1a. TYPE OF WORK

DRILL ☒

DEEPEN ☐

PLUG BACK ☐

b. TYPE OF WELL

OIL
WELL ☒

GAS
WELL ☐

OTHER ☐

SINGLE
ZONE ☐

MULTIPLE
ZONE ☒

2. NAME OF OPERATOR

SDX Resources, Inc. ✓

3a. Area Code & Phone No.

(505) 748-9724

3. ADDRESS OF OPERATOR

P.O. Box 5061, Midland, TX. 79704

4. LOCATION OF WELL (Report location clearly and in accordance with any State requirements.)*

At surface

1310' ENL. 1350' FEL. unit B. Sec. 10

At proposed prod. zone

Same

14. DISTANCE IN MILES AND DIRECTION FROM NEAREST TOWN OR POST OFFICE*

15 miles S.E. of Artesia, N.M.

15. DISTANCE FROM PROPOSED*

LOCATION TO NEAREST
PROPERTY OR LEASE LINE, FT.
(Also to nearest drlg. unit line, if any) 1310'

16. NO. OF ACRES IN LEASE

12.40

17. NO. OF ACRES ASSIGNED
TO THIS WELL

12

18. DISTANCE FROM PROPOSED LOCATION*
TO NEAREST WELL, DRILLING, COMPLETED,
OR APPLIED FOR, ON THIS LEASE, FT.

919'

19. PROPOSED DEPTH

4000'

20. ROTARY OR CABLE TOOLS

rot.

21. ELEVATIONS (Show whether DF, RT, GR, etc.)

3619

GR

22. APPROX. DATE WORK WILL START*

6/17/94

PROPOSED CASING AND CEMENTING PROGRAM

HOLE SIZE	CASING SIZE	WEIGHT/FOOT	GRADE	THREAD TYPE	SETTING DEPTH	QUANTITY OF CEMENT
12-1/4"	8-5/8"	24#	J-55	8rd.	350'	350' CIRCULATE
7-7/8"	5-1/2"	14#	J-55	8rd.	4000'	350' POZ CIRCULATE
						400' FILL

Plan to drill a 12-1/4" hole to approx. 350'; set 8-5/8" surface casing, Circulate "C" cement. Drill 7-7/8" hole to 4000'. Run open hole logs (DLT-CNL-GR & DLL). Run 5-1/2" casing and circulate cement. Perforate the San Andres-Grayburg-Queen and stimulate as necessary for optimum production. Specific programs as per Onshore Oil and Gas Order #1 are outlined in the following attachments:

Drilling Program:

Surface Use and Operating Plan

Exhibit #1 Blowout Preventer Equipment

#2 Location and Elevation Map

#3 Planned Access Roads

#4 One Mile Radius Map

#5 Planned Production Facilities and Access

Post FD-1
7-1-94
New Log & API

IN ABOVE SPACE DESCRIBE PROPOSED PROGRAM: If proposal is to deepen or plug back, give data on present productive zone and proposed new productive zone. If proposal is to drill or deepen directionally, give pertinent data on subsurface locations and measured and true vertical depths. Give blowout preventer program, if any.

24.

SIGNED

Chuck Morgan

TITLE

Engr.

DATE

4/30/94

(This space for Federal or State office use)

PERMIT NO.

APPROVAL DATE

APPROVED BY

19 Ron Dunton

TITLE

AREA MANAGER

CONDITIONS OF APPROVAL, IF ANY:

DATE

6/17/94

APPROVAL SUBJECT TO
GENERAL REQUIREMENTS AND
SPECIAL STIPULATIONS
ATTACHED

NON
STANDARD
LOCATION...
SUBJECT TO
LIKE APPROVAL
BY STATE

*See Instructions On Reverse Side

Submit to Appropriate
District Office
State Lease - 4 copies
Fee Lease - 3 copies

State of New Mexico
Energy, Minerals and Natural Resources Department

Form C-102
Revised 1-1-89

OIL CONSERVATION DIVISION

P.O. Box 2088
Santa Fe, New Mexico 87504-2088

DISTRICT I
P.O. Box 1980, Hobbs, NM 88240

DISTRICT II
P.O. Drawer DD, Artesia, NM 88210

DISTRICT III
1000 Rio Brazos Rd., Aztec, NM 87410

WELL LOCATION AND ACREAGE DEDICATION PLAT

All Distances must be from the outer boundaries of the section

Operator SDX RESOURCES, INC.			Lease DUNN B FEDERAL		Well No. 34
Unit Letter B	Section 10	Township 18 SOUTH	Range 28 EAST	County EDDY COUNTY, NM	
Actual Footage Location of Well: 1310 feet from the NORTH line and 1350 feet from the EAST line					
Ground level Elev. 3619.	Producing Formation Qn - Gb - SA.		Pool Artesia - Qn - Gb - SA.	Dedicated Acreage: 40 Acres	

1. Outline the acreage dedicated to the subject well by colored pencil or hachure marks on the plat below.
2. If more than one lease is dedicated to the well, outline each and identify the ownership thereof (both as to working interest and royalty).
3. If more than one lease of different ownership is dedicated to the well, have the interest of all owners been consolidated by communitization, unitization, force-pooling, etc.?
☐ Yes ☐ No If answer is "yes" type of consolidation _____
If answer is "no" list the owners and tract descriptions which have actually been consolidated. (Use reverse side of this form if necessary.) _____
No allowable will be assigned to the well until all interests have been consolidated (by communitization, unitization, forced-pooling, or otherwise) or until a non-standard unit, eliminating such interest, has been approved by the Division.

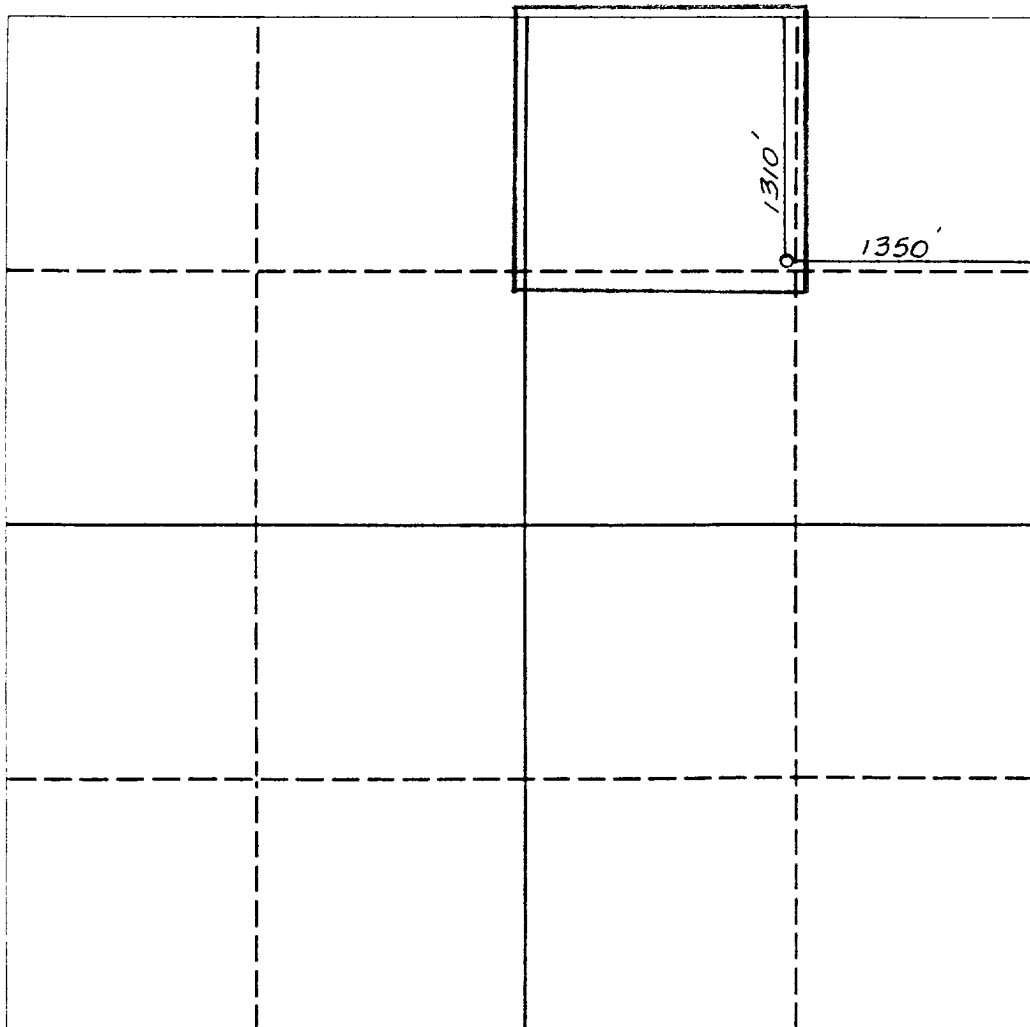

OPERATOR CERTIFICATION

I hereby certify that the information contained herein is true and complete to the best of my knowledge and belief.

Signature *Chuck Morgan*
Printed Name **Chuck Morgan**
Position **Engr.**
Company **SDX Resources**
Date **5/3/94**

SURVEYOR CERTIFICATION

I hereby certify that the well location shown on this plat was plotted from field notes of actual surveys made by me or under my supervision, and that the same is true and correct to the best of my knowledge and belief.

Date Surveyed **APRIL 25, 1994**
Signature and Seal of Professional Surveyor

Certification No. **5412**
NM REGS NO. **5412**
PROFESSIONAL ENGINEER

0 330 660 990 1320 1650 1980 2310 2640 2000 1500 1000 500 0

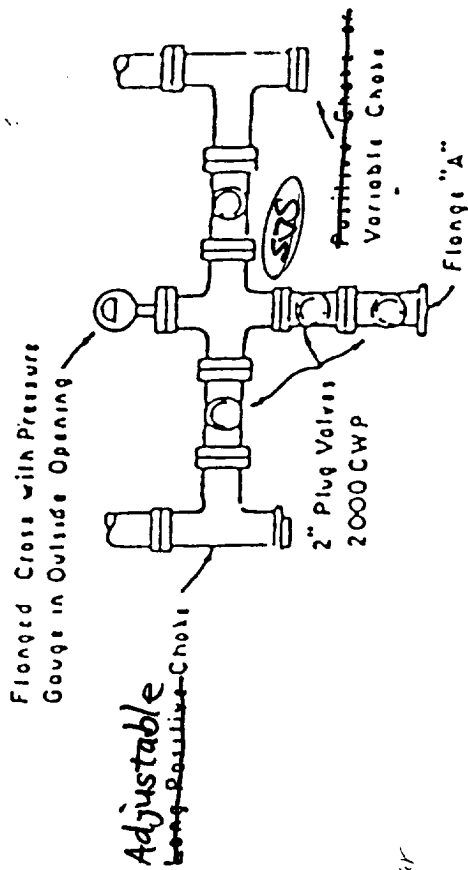
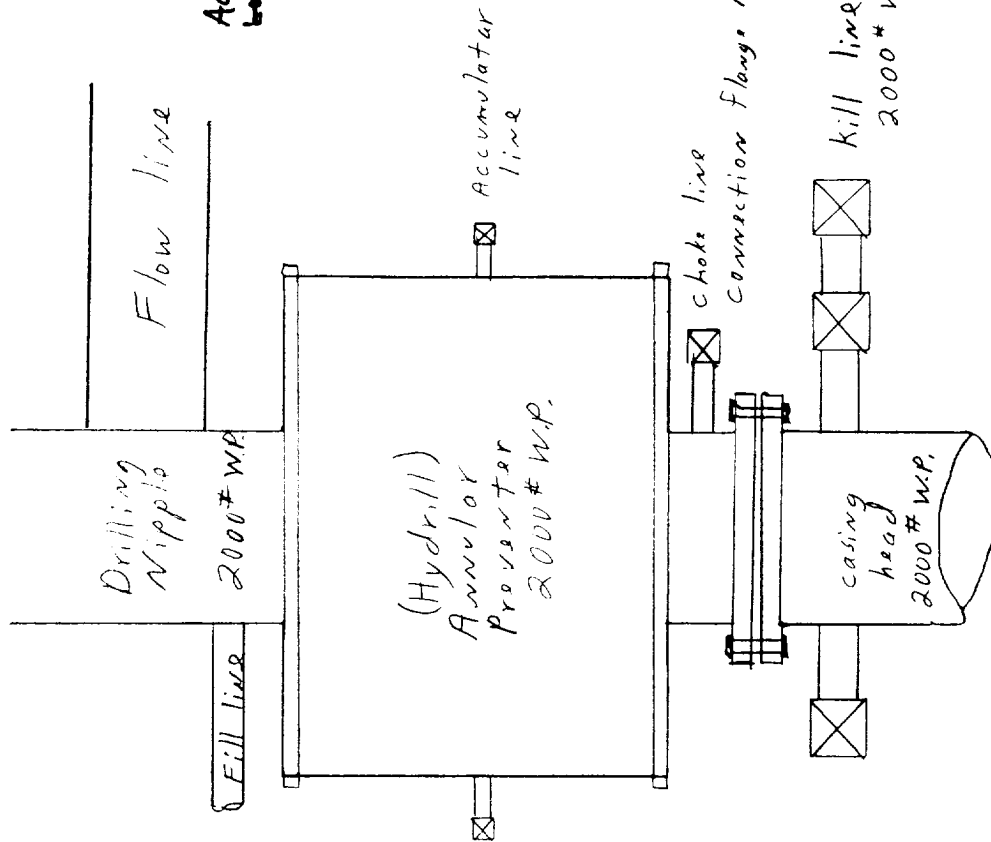

PLAN VIEW - CHOKE MANIFOLD

Exhibit # /